

WI-FI&BLUETOOTHÐERNET
CEILING SPEAKER

SPK-C6-FLBS

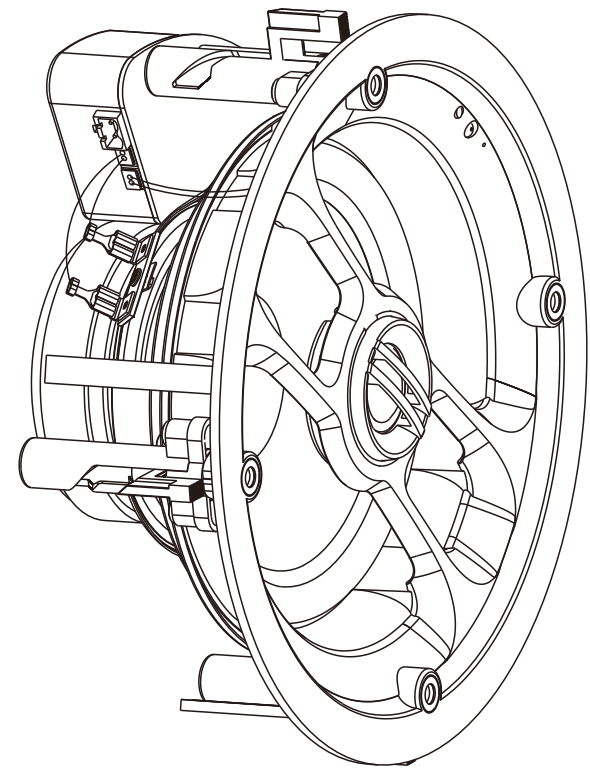

SAFETY INSTRUCTIONS

- 1) Please read the instructions carefully before installation and use. Keep the manual safe for future reference.
- 2) Prior to installing the speakers into any ceiling/wall, check the structure for weight bearing ability and avoid contact with any wiring or plumbing that might be behind the surface area. Installing on soft materials or in areas incapable of supporting the speakers' weight may cause personal injury or damage to the speaker.
- 3) Make sure the speaker is properly secured to the ceiling/wall. Please use the proper screws, bolts, or anchors. Failure to do so may cause the speaker to become unsecured and cause potential damages/injuries.
- 4) Damage to the woofer and tweeter may occur if the speaker is dropped or hit-resulting in no sound or distorted sound.
- 5) Never overdrive your speakers to the point of distortion and always reduce volume prior to switching input sources.
- 6) Use only approved and certified wiring in your installation, do not stretch or place the wire in contact with sharp objects.
- 7) Prior to removing cables ensure all power to your amplifier and other components is turned off.

PREPARATION

The hardware equipment listed below is needed to install the speaker.

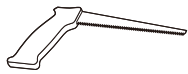

Cutting Saw



Wire Strippers

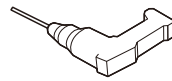

Power Drill



Pencil



Tape Measure



Stud Finder



Safety Goggles



Ladder

PACKING LIST

Ensure that you have received all parts according to the component checklist prior to installation. If any parts are missing or faulty, contact your place of purchase for a replacement.

Model FLF-6WB

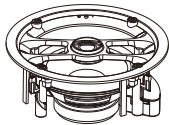

Active Speaker



User Manual



Remote Control

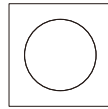

Cutout Template

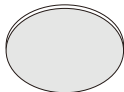

Grill



Power Cord with Adapter



Installation Tool

Pair Model FLF-6WBS Also Includes

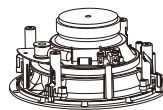

Passive Speaker



Grill

SPEAKER OVERVIEW

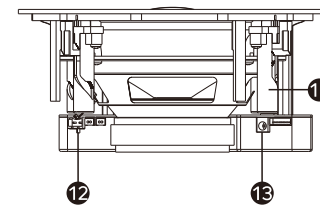
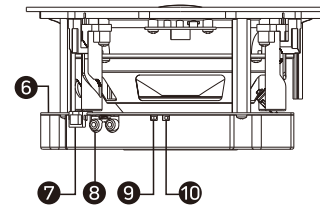
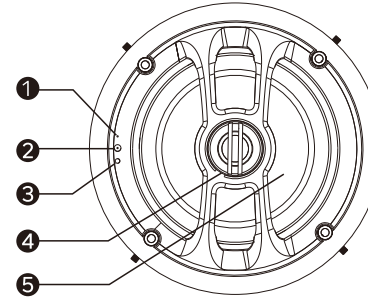

100mm ceiling depth required

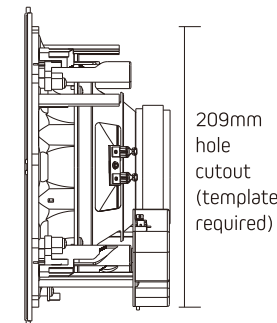

209mm hole cutout (template required)

- 1 LED Indicator**
 Slowly flashing red: power on or reset.
 Steady red: the Internet module is ready to connect.
 Slowly flashing green: Wi-Fi is connecting.
 Steady green: Wi-Fi is connected.
 Fast flashing blue: Bluetooth is connecting.
 Steady blue: Bluetooth is connected.
 Steady cyan: Current audio source is RCA.
 Flashing red, green and blue: The system is updating or resetting.
- 2 IR Receiver**
- 3 Reset Button**
 1. Press it to switch play mode.
 2. Press it for 3 seconds to start connecting to the Internet.
 3. Press it for more than 10 seconds to start resetting with flashing red, green and blue light..
- 4 Pivoting Tweeter**
- 5 Woofer**
- 6 Built-in Amplifier & Bluetooth Driver**
- 7 RJ45 Ethernet Port**
- 8 RCA Jack**
- 9 Stereo/Mono Switch**
 Switch to the "stereo" position when a passive speaker is attached. If not, keep in "mono" position.
- 10 Volume Limiter**
 - Limiter Enabled(50%): The volume will be limited to the max. output 15W@8Ω.
 - Limiter Disable(100%): The volume can be adjusted to the max. output 30W@8Ω.
- 11 Quick-Install Dog Leg Fixings**
- 12 Speaker Output**
- 13 Power Inlet (DC 24V/2.5A)**

INSTALLATION

1. Cut the Speaker Hole

Position the cutout template where you are installing the speaker. Trace the template to mark out the speaker location with a pencil. Drill a pilot hole and cut all of the way around the circular outline with a cutting saw.

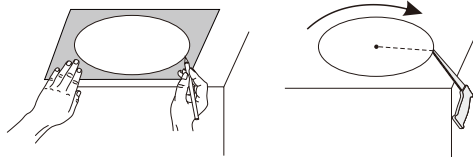

2. Wire the Speaker

Connect the adapter and RCA cables (if needed) to the corresponding ports.

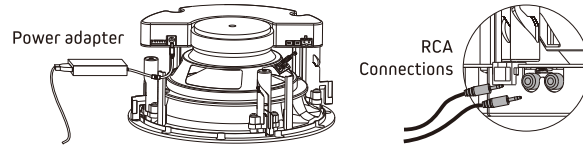

3. Install the Speaker

Adjust the dog leg with the installation tool as shown and insert the speaker into the hole.

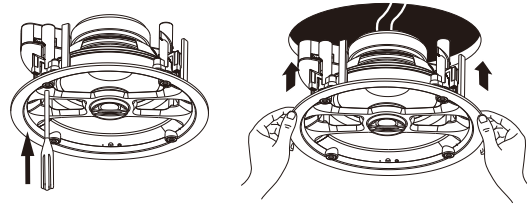

4. Lock the Speaker

Lock the speaker by pressing the buttons located on the front face of the speaker and the dog leg will engage automatically.

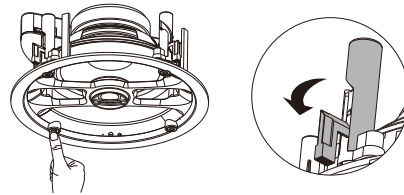

5. Attach the Grill

Paint the speaker grill to match your room décor before you attach them to the speaker. As several magnets are on the speaker frame, attach the grill to the rim of the speaker directly. Ensure the grill is attached to the speaker securely to keep the grill from falling.

Note: Paints and spray gun are not included.

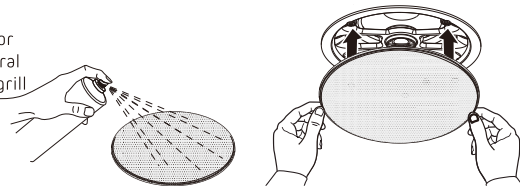

CONNECTION

1) Wi-Fi Connecting

• Installing Controller App

Please search "Smartsonix" to download controller app from Google Play (Android) or Apple App Store (IOS).

• Connecting the Wi-Fi Speaker

Ensure the speaker is connected to the power supply. Press the WPS button to start the speaker, then you will hear an instruction "Enter the setup mode, follow the instructions in the app to finish the setup", and the power indicator flashes green indicating that the speaker is ready to connect. Any wireless device (such as phones, tablets, laptops etc.) is available for connecting. Once connected successfully, the power indicator will become steady green.

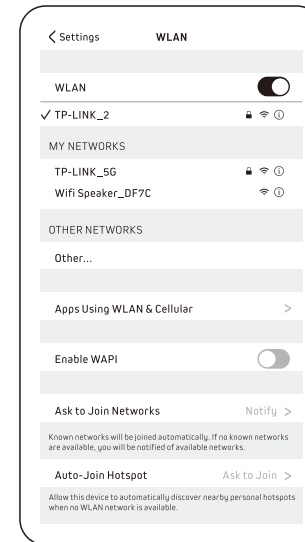

1. Turn on the Wi-Fi function and connect your phone to an available Wi-Fi network that you want.

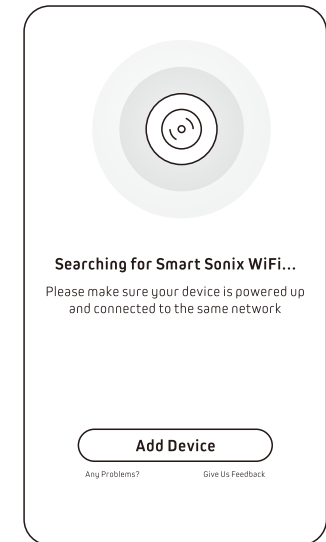

2. Start the controller App Smart Sonix and click Add Device

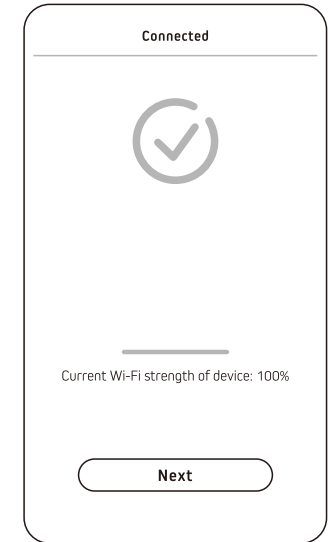
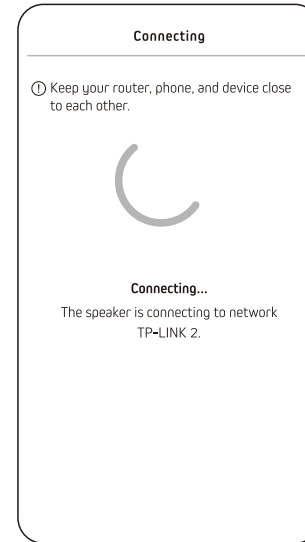
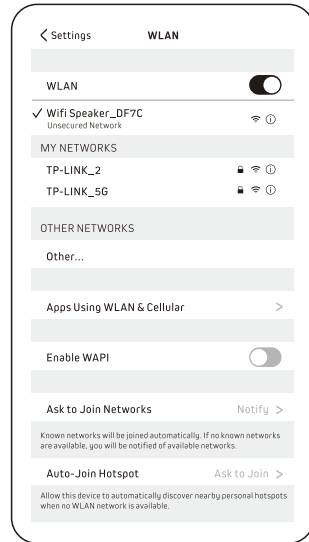
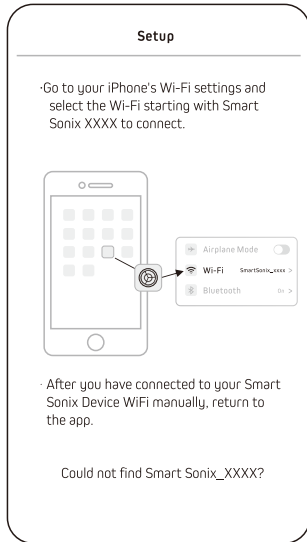

3. Follow the instructions in the app and get to your phone Wi-Fi settings to find the “Wi-Fi Speaker_****” in the network list and connect it.

5. Wait for a few seconds, the device will be connected to the Wi-Fi automatically. After connecting successfully, click Next.

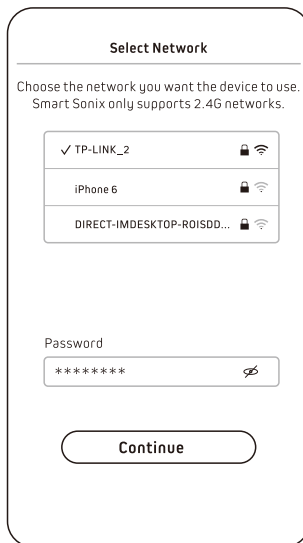

4. Return to the Smart Sonix. Choose the Wi-Fi the same as the one connected in step 1, type the password of the Wi-Fi and click Continue.



6. Name the device according to the room you will install and click >.

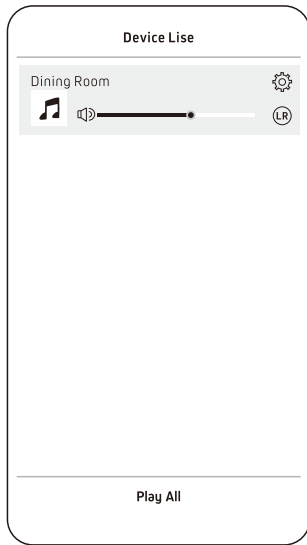

7. After finishing above settings, the Wi-Fi speaker will be in the device list, if you have more than one Wi-Fi speakers, press + to add devices and name them accordingly. After these steps, your multi-room music network is successfully established.

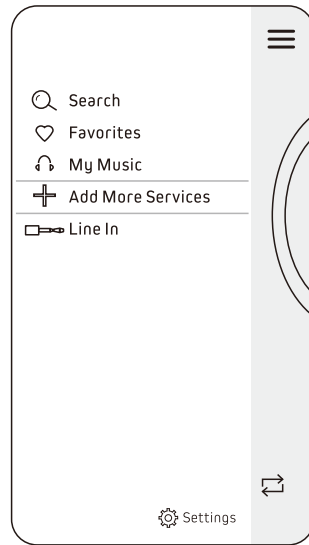

8. Choose a device and play a song in your phone to test whether the device works. If ok, testing is finished and you can forward to use the speaker.

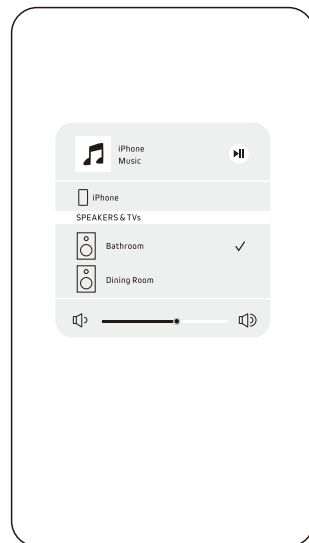
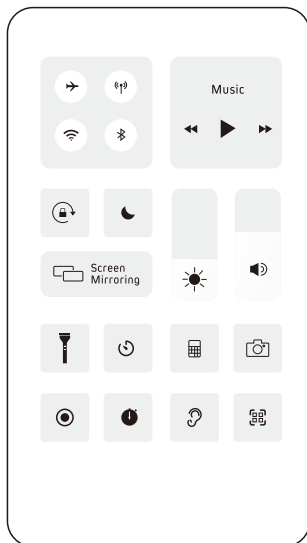

Note:

For iPhone, iPad and iMac smart device with ios operating system, you can use the Wi-Fi speaker with Airplay function. Connect your device to the speaker Wi-Fi. In the pull-up or pull-down menu, click Airplay and choose the Wi-Fi speaker, then the sound can be steamed from your smart device. (Below is the operation interface of IOS13 system shown for your reference)

- When using an Ethernet cable to connect the speaker to the Router, the router must not have any special setting such as assigned IP or banned UPNP.
- The Wi-Fi ceiling speaker executes the Wi-Fi connecting first, when the speaker is powered up.
- Wi-Fi input has the priority when Wi-Fi input and RCA input are connected simultaneously.
- If the multi-room network fails the first time, restart all the equipment and then follow the above instructions. If trouble persists, press the "WPS button" located on the front of the speaker.
- The wireless connection will be lost if the distance between the speaker and the wireless device exceeds 80m(262.5 ft.).

2) Bluetooth Pairing

Ensure the speaker is connected to the power supply and turned on. Once the speaker has powered up for 10 seconds, the power indicator flashes blue indicating that the speaker is ready to pair. Any Bluetooth device (such as phones, tablets, laptops etc.) is available for pairing. Once paired successfully, the power indicator will become steady blue.

1. Open the setting menu and select Bluetooth.
2. Turn on Bluetooth and search devices.
3. Click "BT Speaker" to pair with your device.

Note:

- One device can only connect or control one Bluetooth speaker at a time.
- If your device prompts a pairing code, type in initial code.
- If pairing fails the first time, restart all the equipment and then follow the above instructions. If trouble persists, press the "reset button" located on the front of the speaker or on the remote control.
- If you are unable to reconnect a previously connected device, remove the "BT Speaker" form the list of paired devices, and then follow the above instructions again.
- The Bluetooth connection will be lost if the distance between the speaker and the Bluetooth device exceeds 10m(32.8 ft.).

3) RCA Connecting

1. Connect to the speaker using a dual RCA left/right cable.
2. Use the remote or SmartSonix APP to choose RCA mode. (Wi-Fi or Bluetooth Input has the priority when 3 audio inputs are connected simultaneously.)
3. The RCA mode will be activated when the indicator light shows cyan.

4) Create Stereo Pair

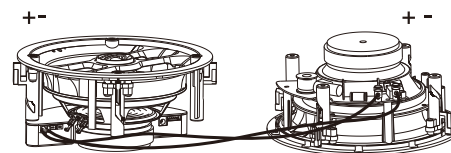

1. Connect the passive speaker to the phoenix connector output.
2. Slide the mono-stereo switch **S** to the stereo position.

5) Switch 3 Audio Sources

- **Wi-Fi Mode**
After connecting with Wi-Fi, use SmartSonix App to play audio and the speaker will automatically work in Wi-Fi mode. Or press "MODE" button of the remote for several times until the LED light turns green to switch audio source to "Wi-Fi".
- **Bluetooth Mode**
Press the "MODE" button of the remote several times until the LED light turns blue or use SmartSonix App to switch the audio source to "Bluetooth".
- **RCA Mode**
Connect the speaker with an audio device like a phone or a computer by RCA cable, and press the "MODE" button on the remote several times until the LED light turns cyan, or use SmartSonix App to switch the audio source to "Line in" to switch to RCA mode.

6) Remote Control

Note: CR2025 lithium coin cell battery included.

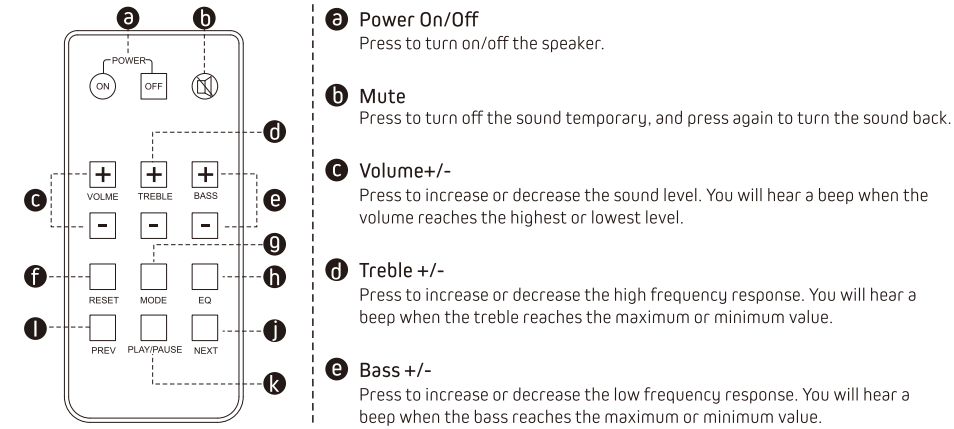

- a Power On/Off**
Press to turn on/off the speaker.
- b Mute**
Press to turn off the sound temporary, and press again to turn the sound back.
- c Volume +/-**
Press to increase or decrease the sound level. You will hear a beep when the volume reaches the highest or lowest level.
- d Treble +/-**
Press to increase or decrease the high frequency response. You will hear a beep when the treble reaches the maximum or minimum value.
- e Bass +/-**
Press to increase or decrease the low frequency response. You will hear a beep when the bass reaches the maximum or minimum value.
- f Reset**
Press and hold to resume the speaker to default setting. All parameters will be reset to default values: volume is 26; sound effect is flat; treble and bass is 0.
- g MODE**
Press to switch the audio source. Press it several times until the LED light turns green (Wi-Fi mode), blue (Bluetooth mode), or cyan (RCA mode).
- h EQ**
Press to switch sound effects in order as Flat, Classical, Pop, Rock, Jazz, Vocal Enhanced.
- i Previous**
Press for previous track.
- j Next**
Press for next track.
- k Play/Pause**

Note:

Only if the Bluetooth or Wi-Fi input is activated, the PREV, NEXT and RESET keys can work.

Tips:

The infrared remote control has effective scope of operating range which is less than 3m(10 ft.)and at 60 degrees angle left or right away from the system.

CARE AND MAINTENANCE

- Turn off the power to the speaker when unused for long periods of time.
- Ensure all equipment is turned off prior to cleaning. Surfaces only need occasional dusting/cleaning. Never use chemicals or solvents as they may damage the surface. Always clean using a dry cloth.
- Never touch the speaker drivers.

SPECIFICATIONS

Wi-Fi & Bluetooth & Ethernet Ceiling Speaker Pair (Active+Passive)

Speaker	Active Speaker(Master)	Passive Speaker(Slave)
Woofers	6.5" Polypropylene Cone	6.5" Polypropylene Cone
Tweeter	0.75" Silk Dome	0.75" Silk Dome
Frequency Response	70Hz-20kHz	70Hz-20kHz
Sensitivity(1M/1W)	87dB	87dB
Nominal Impedance	8Ω	8Ω
RMS Power	/	60W
Amplifier Power	2x30W/8Ω	/
Wireless Connection System	Wi-Fi 802.11b/g/n	/
Wireless Transmission Distance	80m (262.5 ft.)	/
Bluetooth Version	V5.0	/
Bluetooth Distance	10m (32.8 ft.)	/
Power Supply	DC 24V/2.5A	/
Dimensions	Ø233x105mm(Ø9.2"x4.1")	Ø233x105mm(Ø9.2"x4.1")
Cutout Size	Ø209mm (Ø 8.2")	Ø209mm (Ø 8.2")