

Description

This adapter consists of a C20 plug on one end and a C13 receptacle on the other. It is primarily used to adapt or convert an existing power cable.

Physical Characteristics

Connector Plating	Nickel
Color	Black
Electrical Rating	Up to 10A at 250V
Insulation Resistance	100MΩ
Dielectric Voltage	2000V/sec

Connectors

Connector A	C20 Plug
Connector B	C13 Receptacle

Approvals/Environmental

CE	Yes
RoHS	Yes
Reach	Yes
ISO	ISO14001:2015, ISO9001:2015

Packaging Information

Packaging Quantity	1
Product Weight	0.10 lbs [0.04kg]



IEC 60320 C13 to IEC 60320 C20 Plug

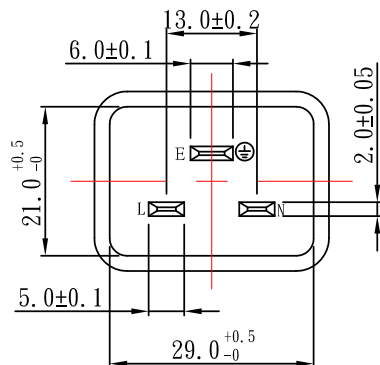
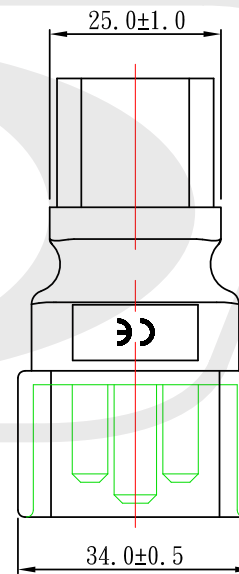
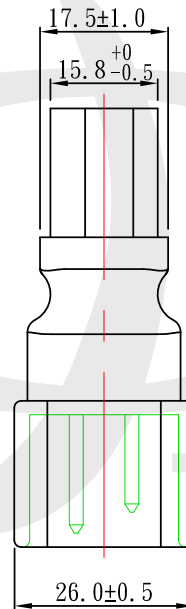
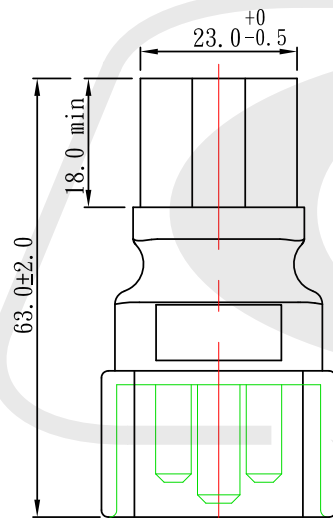
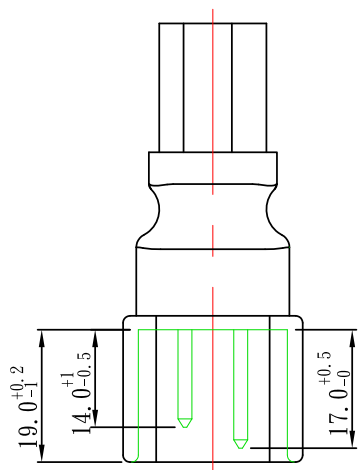
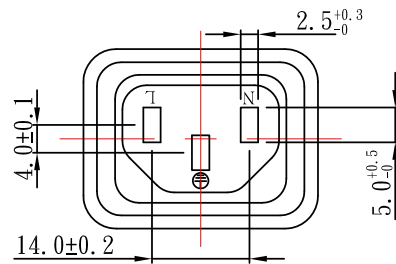

60MM

CAUTION: This plug adapter does NOT transform voltage or current. Verify that your device can safely operate at the voltage supplied by the source before connecting. Assure voltage and current are less than or equal to the rating listed on the adapter. Voltage mismatch can cause damage to your device or even bodily harm.

60MM

TOLERANCE

- >0±0.30
- >1.0±0.50
- >10.0±1.0
- >20.0±2.0

Angle:

±1°