



ST/ST Fiber Coupler F/F SM/MM Duplex Ceramic, Panelmount Metal

FO-AD200-PM - Specifications

Description

This coupler consists of a ST duplex female on one end and a ST duplex female on the other end. It is typically used to connect two ST duplex male cable assemblies.

Physical Characteristics

Color	Nickel
Housing	Metal
Sleeve	Ceramic
Mounting Style	Panel Mount
Mode	Singlemode/Multimode

Connectors

Connector A	ST Female Duplex
Connector B	ST Female Duplex

Performance

Insertion Loss	<0.2dB
----------------	--------

Packaging Information

Package Quantity	1
Product Weight	0.04 lbs [0.018kg]

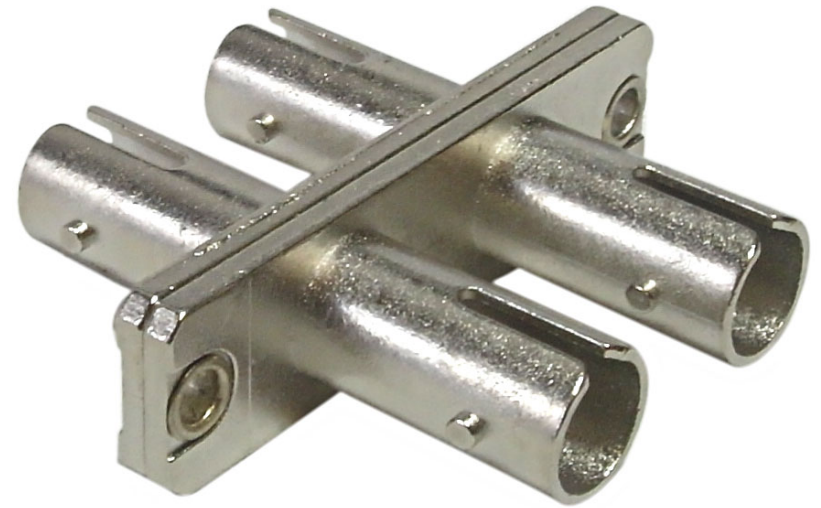



ST/ST Fiber Coupler F/F SM/MM Duplex Ceramic, Panelmount Metal

FO-AD200-PM - Line Drawing

