



Description

This SMA female reverse polarity bulkhead crimp connector is meant to be terminated on RG58 (LMR-195) bulk cable.

Physical Characteristics

Connector	SMA
Gender	Female
Body Style	Bulkhead
Polarity	Reverse
Cable Type	RG58 (LMR-195)
Connector Plating	Nickel
Contact Plating	Gold
Attachment Method	Crimp Sleeve, Crimp or Solder Pin

Performance

Impedance	50 Ohm
-----------	--------

Product Support

RoHS	Yes
Country of Origin	Taiwan

Packaging Information

Package Quantity	1
Product Weight	0.02 lbs [0.01kg]

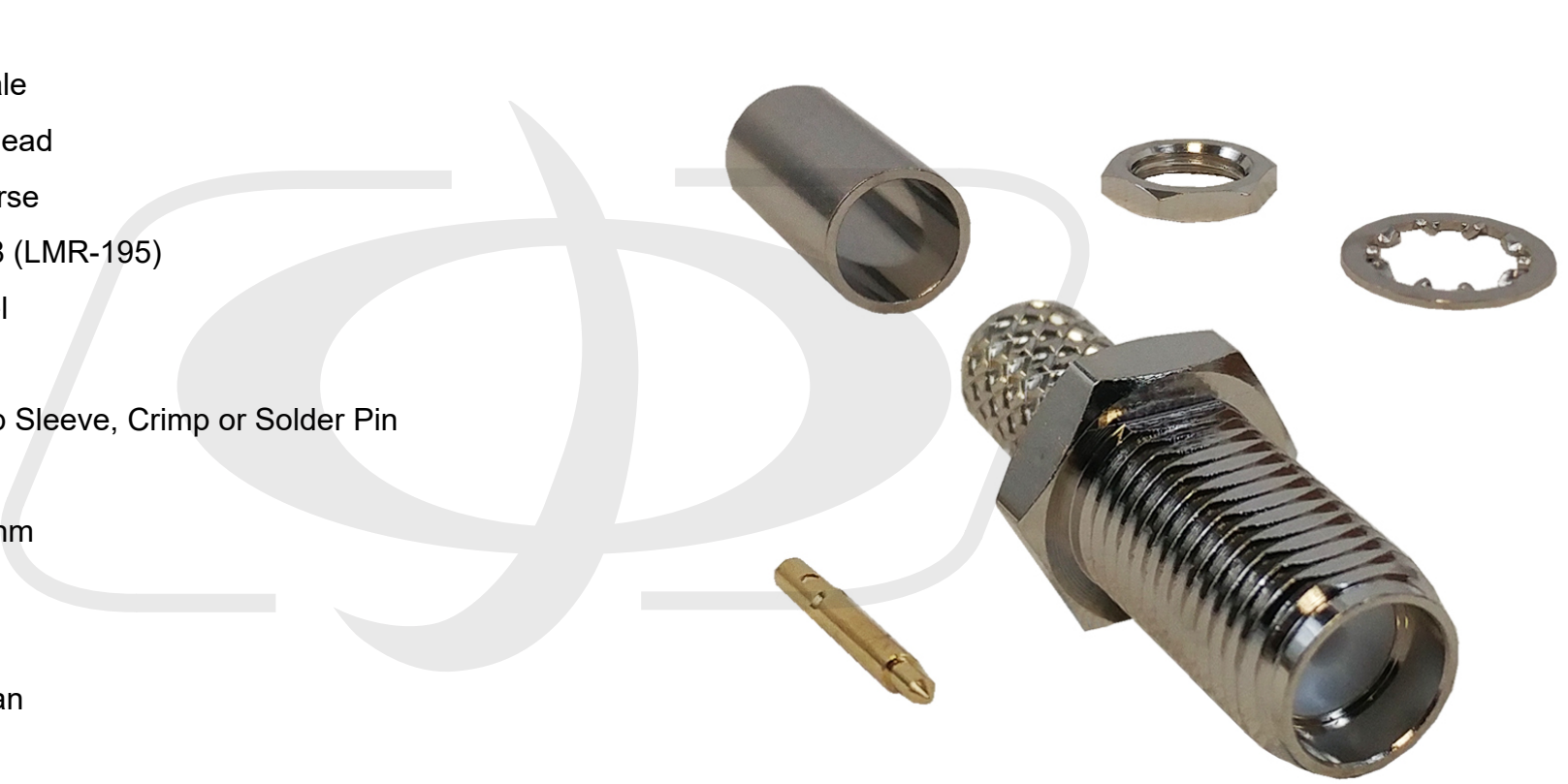

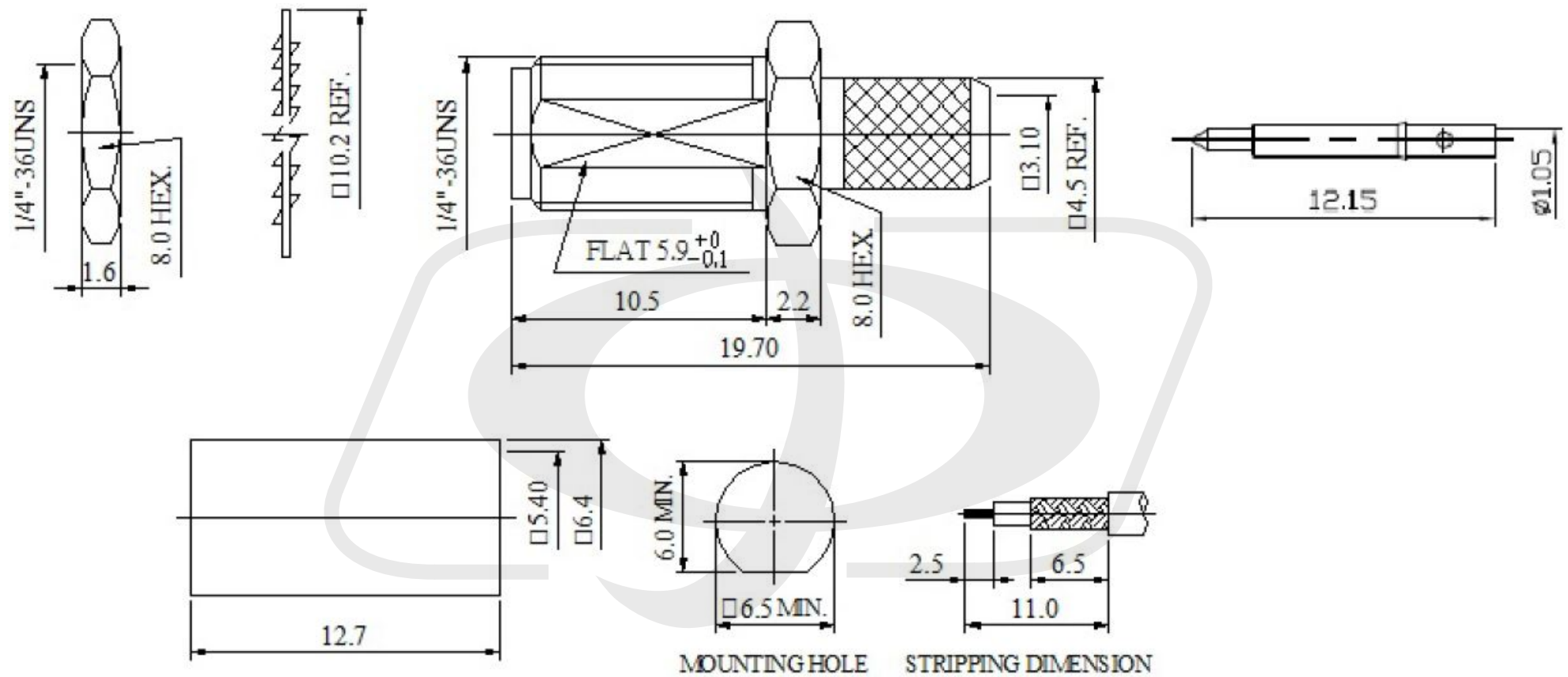

Tolerance

x.	±0.2
xx.	±0.1
xxx.	±0.05
Angle	±0.5°