



# SMA Male Crimp Connector for RG58 (LMR-195) 50 Ohm

CN-10-195 - Specifications

## Description

This SMA male crimp connector is meant to be terminated on RG58 (LMR-195) bulk cable.

## Physical Characteristics

Connector	SMA
Gender	Male
Cable Type	RG58 (LMR-195)
Connector Plating	Nickel
Contact Plating	Gold
Attachment Method	Crimp Sleeve, Crimp or Solder Pin

## Performance

Impedance	50 Ohm
Maximum Frequency	18GHz

## Product Support

RoHS	Yes
Country of Origin	Taiwan

## Packaging Information

Package Quantity	1
Product Weight	0.02 lbs [0.01kg]

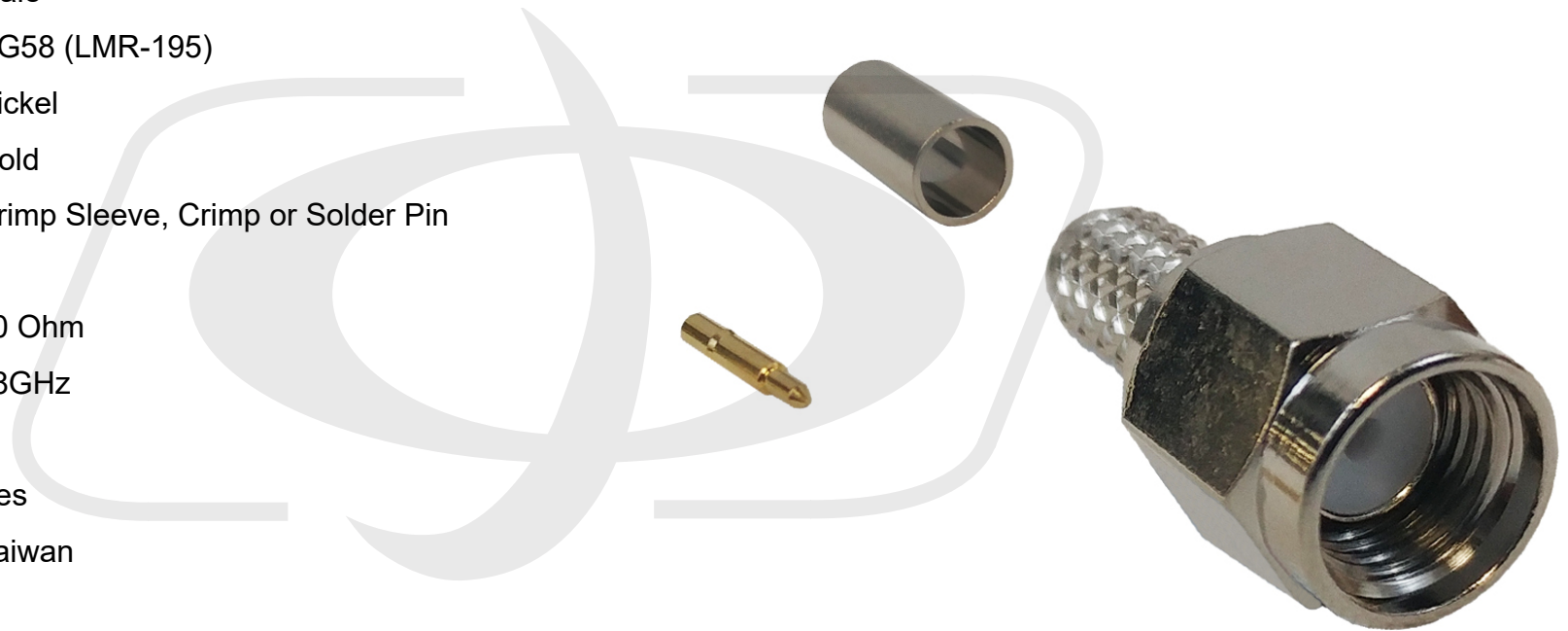

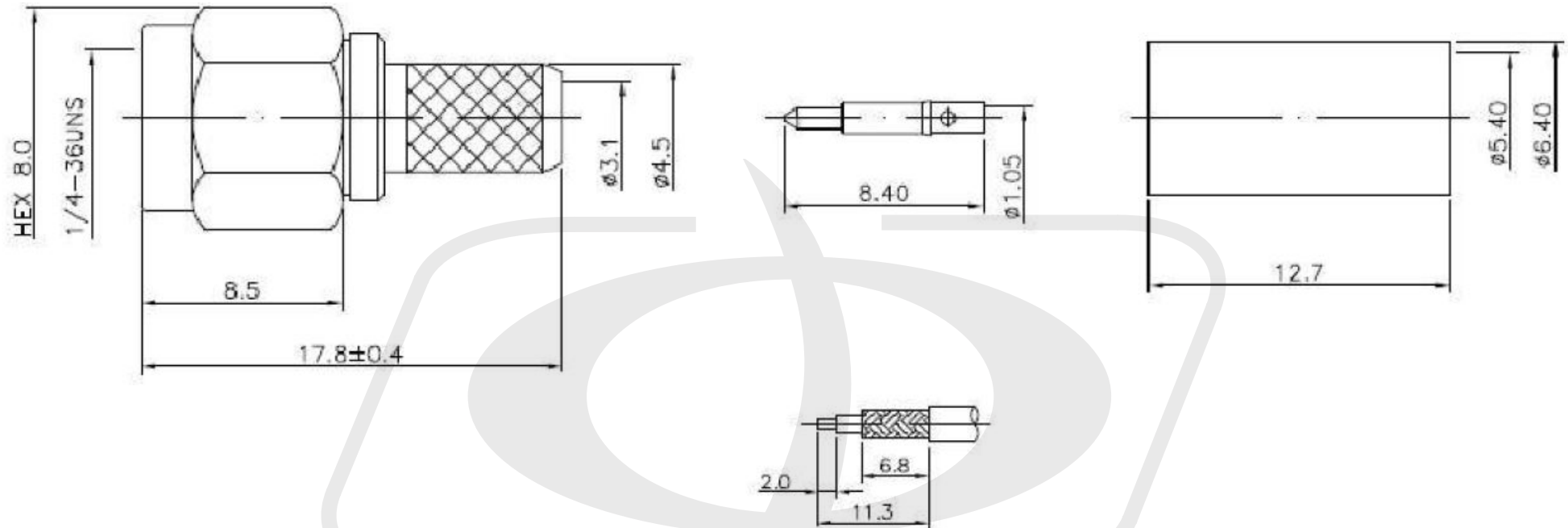

### Tolerance

x.	±0.2
xx.	±0.1
xxx.	±0.05
Angle	±0.5°