



# SMA-RP Female to TNC-RP Male Adapter

## AD-1322 - Specifications

### Description

This adapter consists of a SMA-RP (reverse polarity) female on one end and a TNC-RP (reverse polarity) male on the other. It is typically used to convert a SMA-RP male cable to a TNC-RP male cable.

### Physical Characteristics

Connector Plating Nickel

### Connectors

Connector A SMA-RP Female

Connector B TNC-RP Male

### Performance

Impedance 50 Ohm

### Product Support

Country of Origin Taiwan

### Packaging Information

Package Quantity 1

Product Weight 0.02lbs

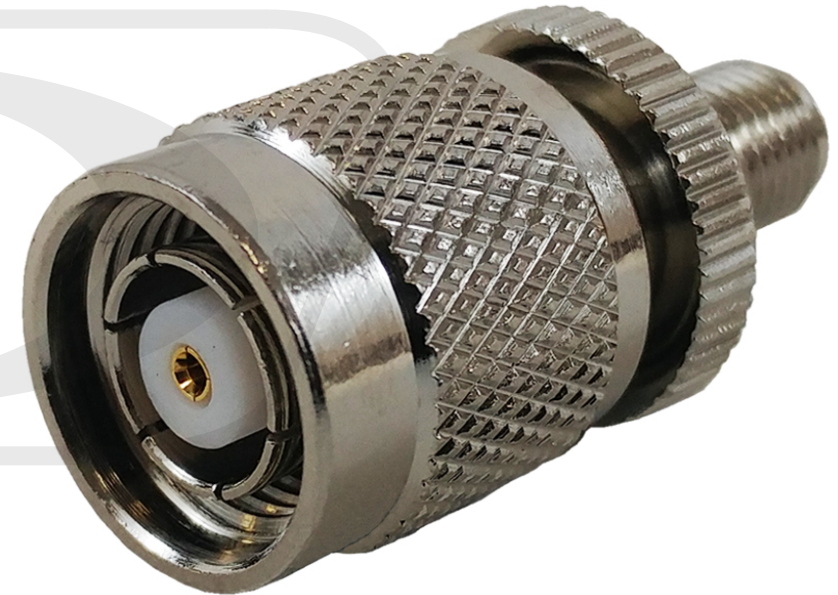

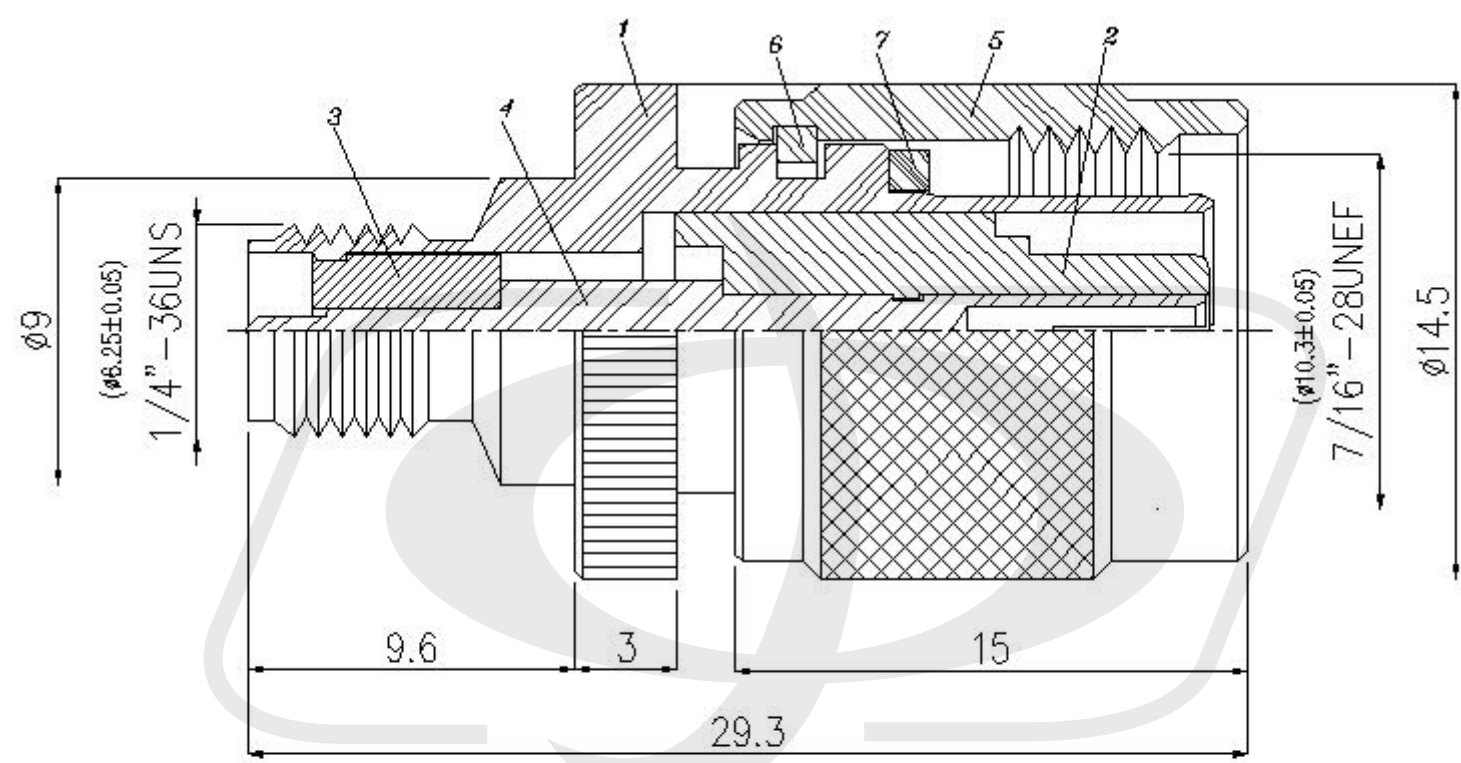

### Tolerance

x.	$\pm 0.2$
xx.	$\pm 0.1$
xxx.	$\pm 0.05$