



SMA Male to 2 x SMA Female - Tee Adapter

AD-10-MFF - Specifications

Description

This adapter consists of a SMA Male on one end and 2 x SMA females on the other. It is typically used to covert a SMA female cable to dual SMA male cables.

Physical Characteristics

Connector Plating	Nickel
Body Style	Tee Shaped

Connectors

Connector A	SMA Male
Connector B	SMA Female
Connector C	SMA Female

Performance

Impedance	50 Ohm
-----------	--------

Product Support

Country of Origin	Taiwan
-------------------	--------

Packaging Information

Package Quantity	1
Product Weight	0.02 lbs

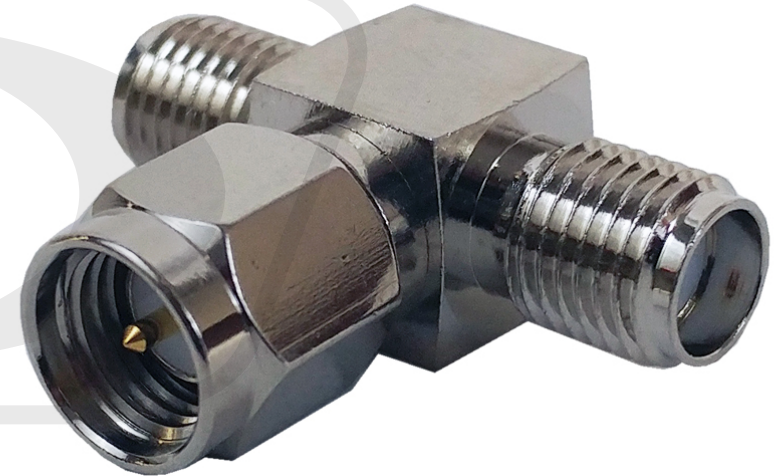

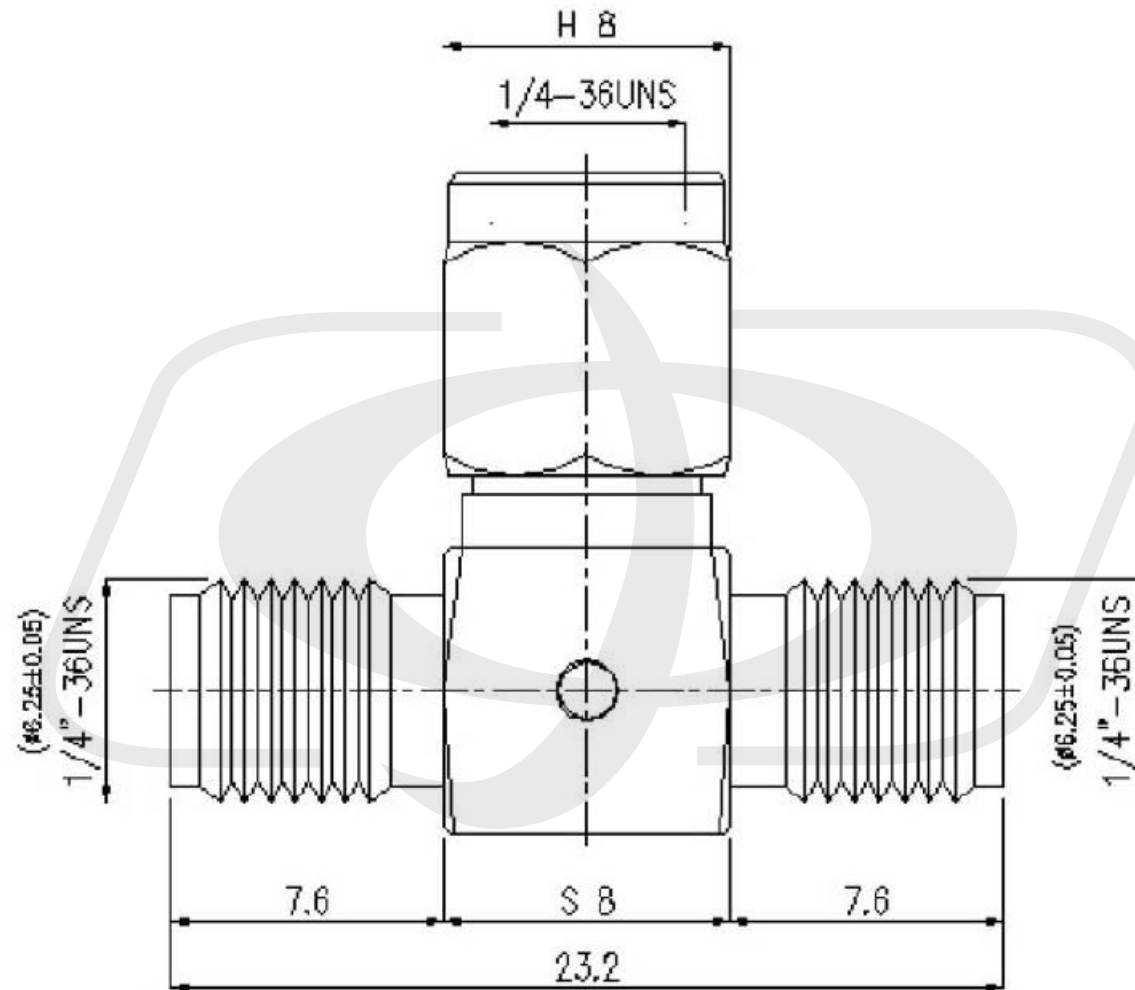

Tolerance

x.	± 0.2
xx.	± 0.1
xxx.	± 0.05
Angle	$\pm 0.5^\circ$