



N-Type Female to SMA Female Adapter - Bulk Head

AD-0111-BH - Specifications

Description

This adapter consists of a bulk head N-Type female on one end and a bulk head SMA female on the other. This adapter is typically used to convert a N-Type male cable to a bulk head SMA female cable.

Physical Characteristics

Connector Plating Nickel

Connectors

Connector A N-Type Female Bulk Head

Connector B SMA Female Bulk Head

Performance

Impedance 50 Ohm

Product Support

Country of Origin Taiwan

Packaging Information

Package Quantity 1

Product Weight 0.02 lbs



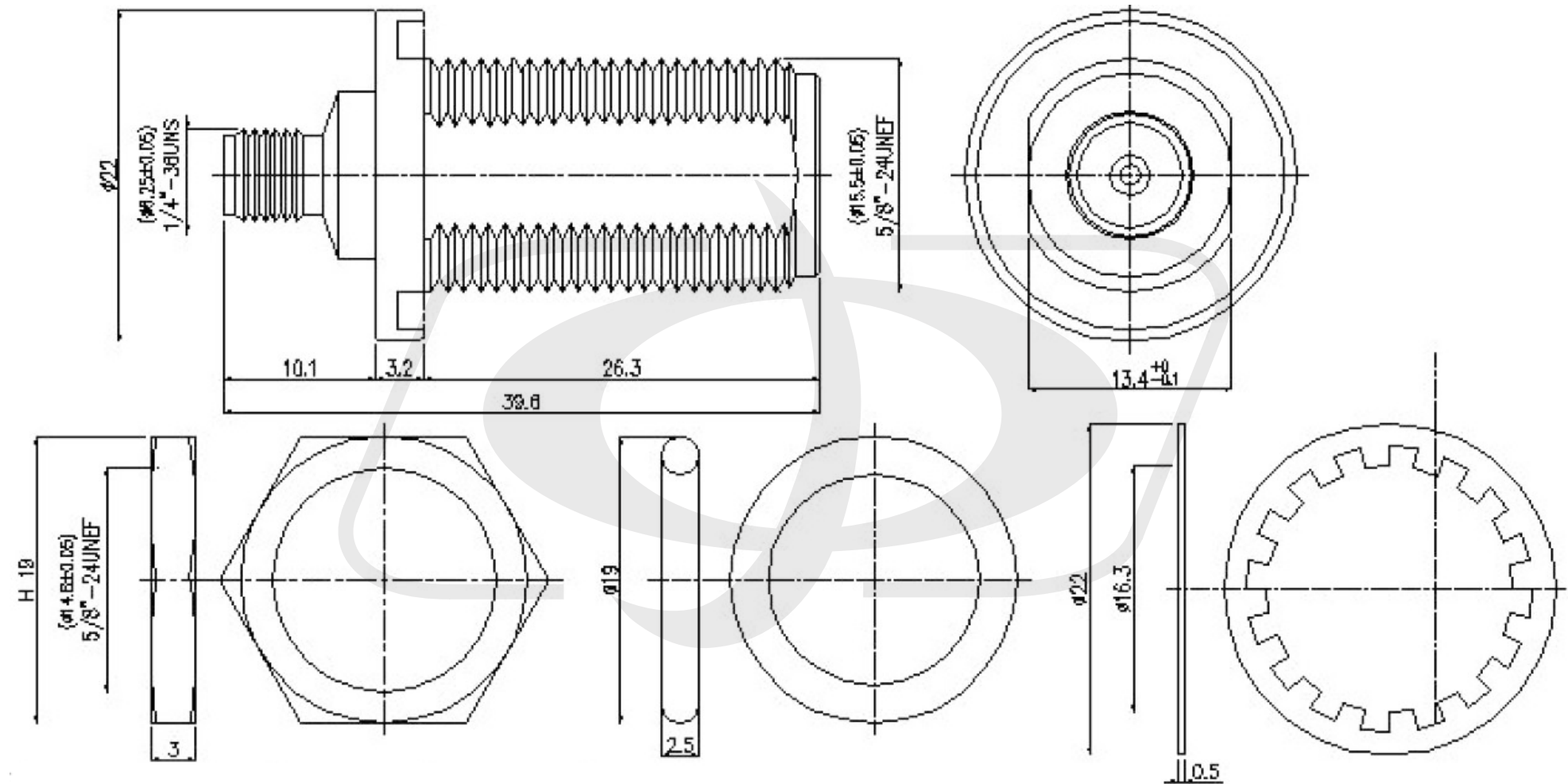

Tolerance

x.	± 0.2
xx.	± 0.1
xxx.	± 0.05
Angle	$\pm 0.5^\circ$