



EVER ADVANCED

INSTRUCTIONS | Camping Table(TA-21407)

Set Up the Camping Folding Table



① Unlock the latch, open the table, and remove the interior storage pocket.

② Open the table legs and lock them.

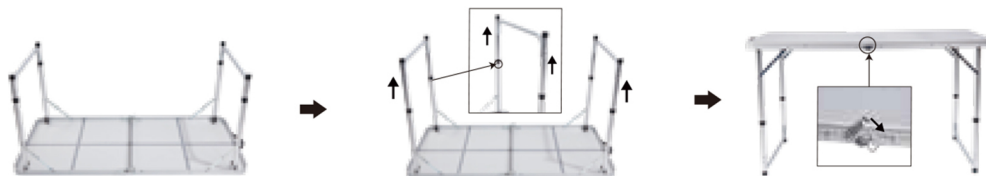

③ Pull out the table legs, stand the table upright, and lock the tabletop.

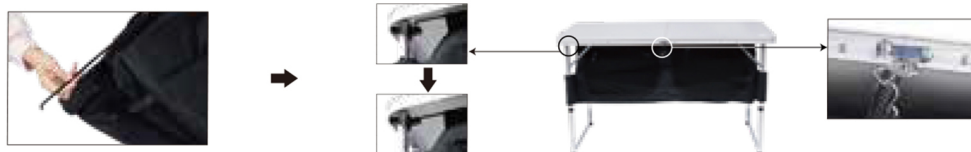

④ Install the storage bag: The steel poles on both sides pass through the fabric and hang on the plastic parts under the table, and then connect to the hook in the middle.



⑤ Attach the hook-and-loop fasteners that secure the storage bag, then insert the MDF board into it.

Fold the table

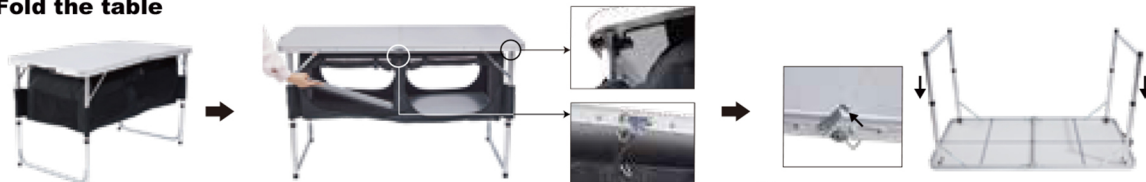

① Remove the storage bag: take out the MDF board, undo the hook-and-loop fasteners on the table legs, and remove the hooks and steel rods.

② After unlocking the desktop, turn the desktop over and retract the leg tubes.



③ Unlock the table legs and fold them inward.

④ Finally, place the storage bag and accessories inside the table and close the table

Warranty

The EA Directors Chair is covered by 12-month quality warranty.

Contact Us

Website: www.everadvanced.com

Email: info@everadvanced.com

@everadvanced

@everadvanced

Safety Tips

- This folding chair holds a maximum weight of 130 lbs. Do not exceed.
- Don't sit on the table.
- Do not put fragile things on the top of the table.
- At the end of use, take out the contents of the storage organizer in time.
- Please use this product on even ground.
- To avoid injuries to fingers, use care when setting it up.

**EVER ADVANCED,
EVER FEARLESS**