



DUALLY® / D2®

DUALLY / D2-FLUSH MOUNT INSTALLATION INSTRUCTIONS



KIT INCLUDES

- Light
- Hardware
- Wiring
- Gasket
- Instructions & Template

IMPORTANT

Thank you for purchasing the Rigid Industries® products. Installation is fairly simple with the right tools and good mechanical abilities. If you are not confident in your mechanical skills, please seek the help of a professional to perform the installation. Please read through all of these instructions and tips before proceeding with installation. **It is strongly recommended that this product be installed by a professional.**

INSTALLATION INSTRUCTIONS

Always disconnect any power sources connected to your vehicle before servicing fuses or electrical systems.

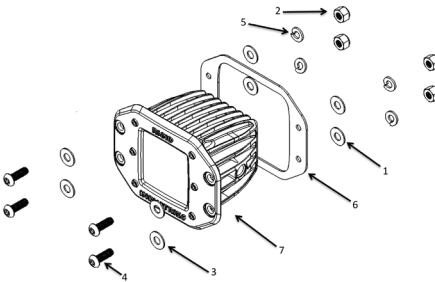

WARNING

The Flush Mounted Dually D2 allows for a wide range of mounting options with the light embedded into the surface of your application. Unlike the normal Dually D2, this does not include a rear bracket, which means the angle of the light beam depends on the surface it is mounted to. The Dually D2 is 3-3/16" in depth and you will need to be sure your surface will allow the light behind it.

SINGLE - Switch Wiring (NOT SHOWN)

- **Black** wire to gold prong (switch ground)
- **Red** with **Black** Strip wire to middle prong (switch output)
- **Red** wire to remaining prong (switch power)

PAIR - Switch Wiring (SHOWN BELOW)

- **Black** wire to gold prong (switch ground)
- **Blue** wire to middle prong (switch output)
- **Red** wire to remaining prong (switch power)

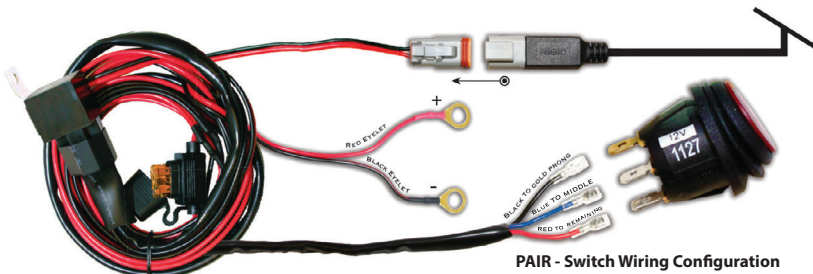

PAIR - Switch Wiring Configuration

STEP 1

Follow the instructions that are listed on the supplied mounting template.

STEP 2

Begin wiring harness installation. Attach red terminal eyelet to battery positive. Secure black terminal eyelet to a suitable ground or battery negative. Route harness from the battery to the desired switch mounting location, and again from the battery to the light. Secure loose wiring with zip ties. Beware of sharp edges, abrasive surfaces and heat sources when routing wires. Reference the wiring diagram on page 1 to assist your wiring installation.

STEP 3

Rigid Industries LED Lights have a variable voltage input range of 9-36 DC. If required, be sure to use an adequate relay that corresponds to your system. When installing multiple lights, fusing should be adjusted to match. Test your new light to ensure proper operation.

**Your installation is now complete.
Welcome to the Rigid Nation!**

WARRANTY INFORMATION

For warranty information, visit www.rigidindustries.com/about/warranty

Follow us on facebook at
[Facebook.com/RigidIndustries](https://www.facebook.com/RigidIndustries)

779 N Colorado St, Gilbert, AZ 85233 • 855-760-5337 • www.rigidindustries.com

IS-D2-FM-C

Rigid Industries, Dually and D2 are registered and/or common law marks owned by JST Performance, LLC, a Delaware limited liability company d/b/a Rigid Industries.

MOUNTING TEMPLATE

If printing from a printer, make sure to use ACTUAL SIZE option

***Rigid Industries highly recommends using a certified professional to install and wire your light.**

****Only install light onto flat surface***

- 1) Cut out the mounting template making cuts only on the dotted lines.
- 2) Ensure your flat surface allows for 3-3/16" x 3-3/16" of depth.
- 3) Tape the template, or secure by other means, to your surface.
- 4) Mark all four drill holes and center area of template with marker.
- 5) Remove your template and double check your markings by placing rubber gasket over area. Adjust accordingly.
- 6) After complete check is done to ensure proper alignment, remove marked surface material by using pneumatic tools.
- 7) Remove or file down rough edges and excess trimmings to allow for light to correctly be placed inside.
- 8) Place gasket over light so it rests behind the face of the flush mounted light. Insert light into opening.
- 9) Insert your 4 bolts into light and through your surface, tighten nuts onto bolts evenly to allow for a proper gasket seal.
- 10) Wire light according to provided instructions.

Drill Holes to
5/16"

Drill Holes to
5/16"

TAPE HERE

TAPE HERE

TAPE HERE

TAPE HERE