

The dental lights incorporate the latest advances in dental lighting technology. The light is color matched to natural daylight, is easily cleaned, has a dual intensity on-off control and smooth easy positioning.

SPECIFICATION

Input voltage	115V, 220V, (115V, 220V)
Output voltage	12V HIGH, 10.5V Low
Power Output	55w High, 50w Low
Bulb Type	tungsten Halogen Type JA 12V-55W
Focal Distance	725mm
Light Output	20,000 Lux High 10,000 Lux Low
Color temperature	4300 Kelvin
Light Pattern	180×75 at 725mm

The Dichroic Reflector allows heat(infrared) and ultraviolet to pass harmlessly through the back of the lamp housing. Only white light is focused on the patient for reduced eyestrain and comfort.

DICHROIC REFLECTOR

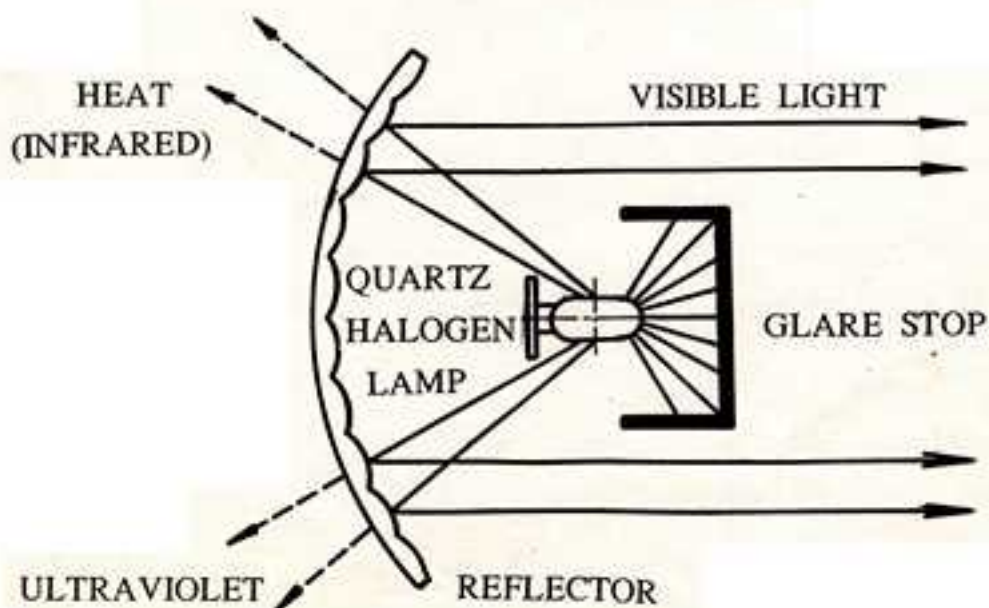

(087) UNIT DIMENSIONS

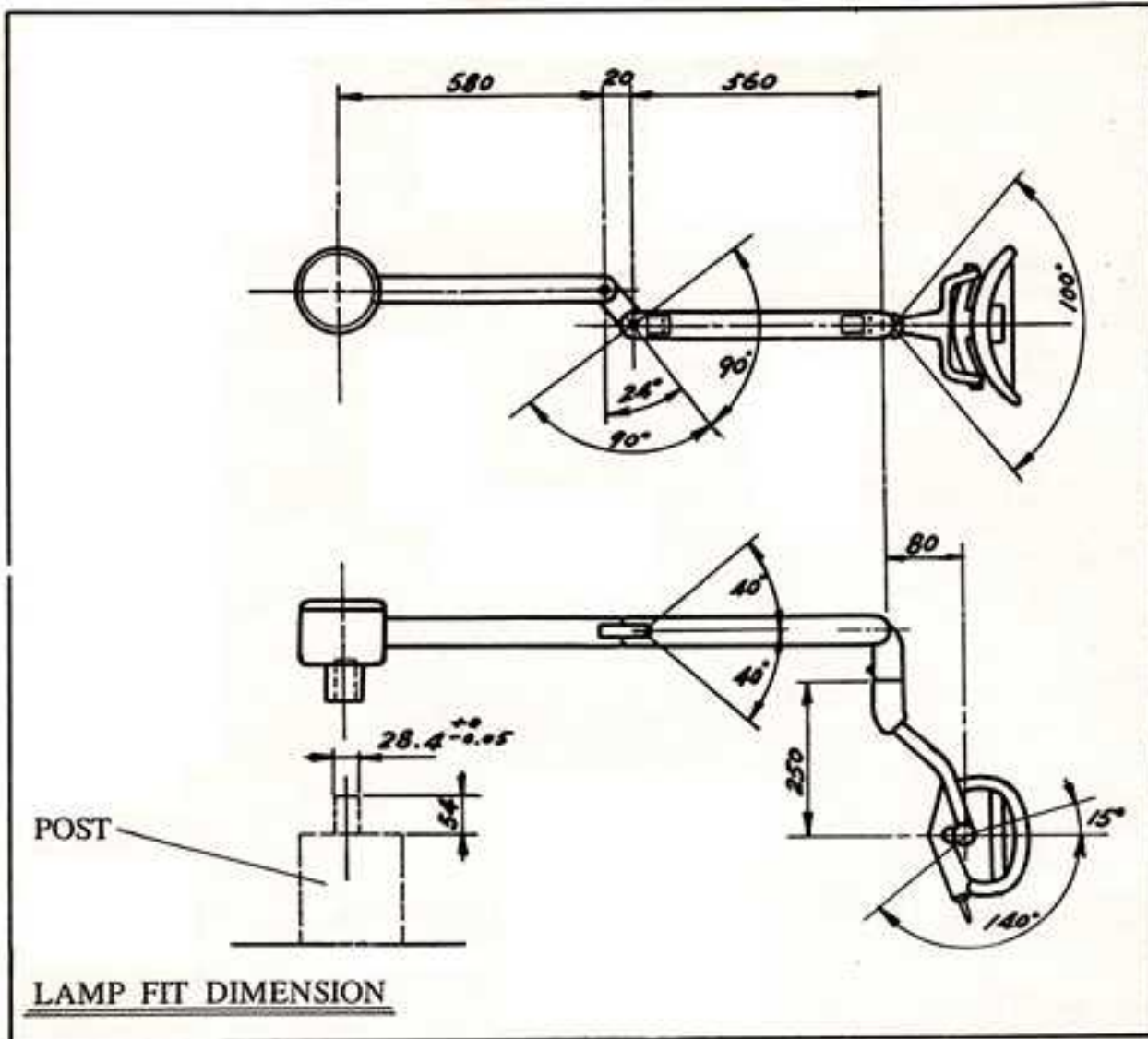

LAMP FIT DIMENSION

LAMP INSTALLATION:

Lamp assembly has to mount and fixed on the post after unpack. Refere to the above figure for fit dimension. Extend and swivel the lamp arm to desired direction after installation. The figure above also detailed the arm dimension, swivel angles, and required space. The lamp provide ultimate illuminate function when adjust to the proper position.

LAMP HEAD ASSEMBLING:

- (1) Assemble the electrical plug together security (caution with the shape of the plugs).
- (2) Guide the lamp head to the end of the lamp arm. Position the groove at the lamp head end toward the thread hole. Tighten the bolt to secure the lamp head.

Plug Shape plug groove Bolt Lamp head

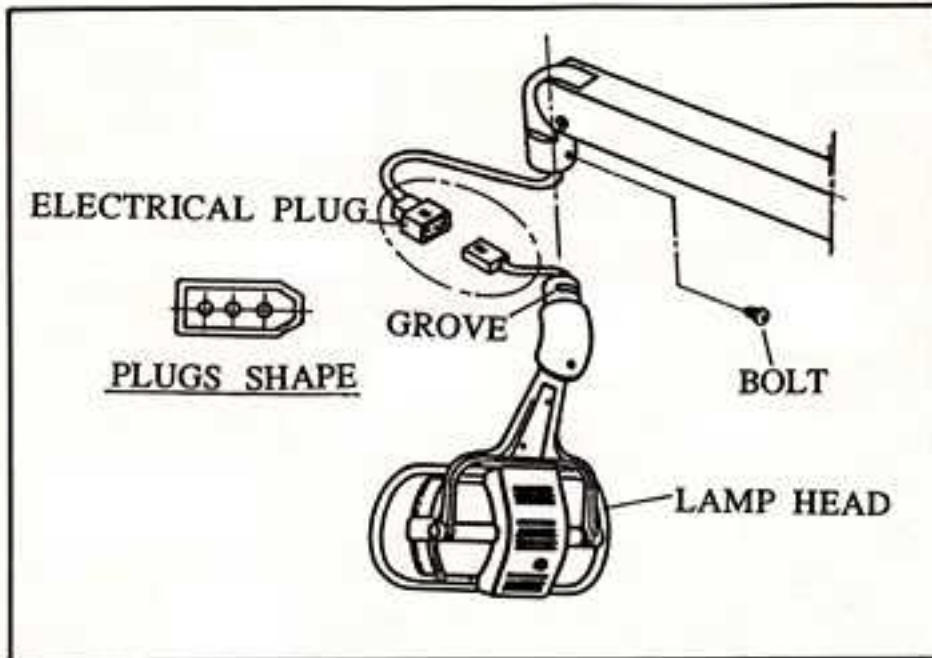

OPERATION & SERVICE INSTRUCTION

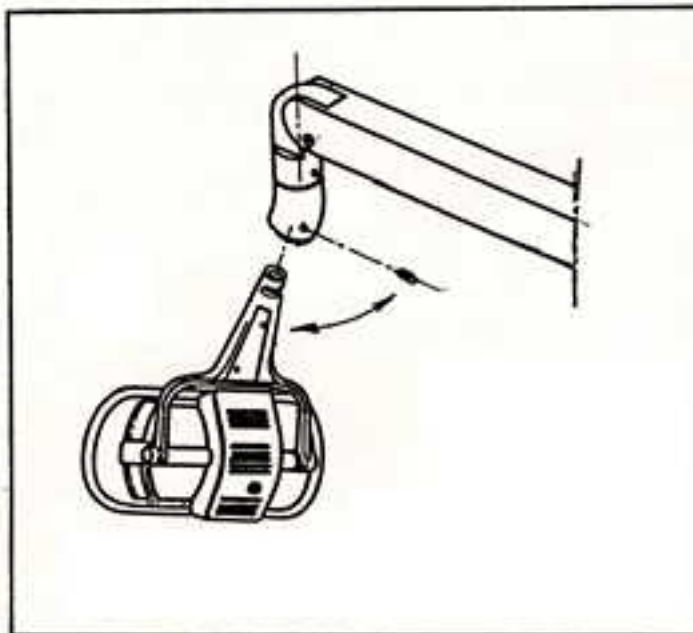

DUAL INTENSITY ON/OFF SWITCH

1. High Beam: push toggle to left
2. Low Beam: push toggle to right

Switch is conveniently located in light head enabling intensity to be changed from seated position.

Low intensity-for longer lamp life and examining facial surfaces.

High Intensity-for color matching and examining lingual surfaces.

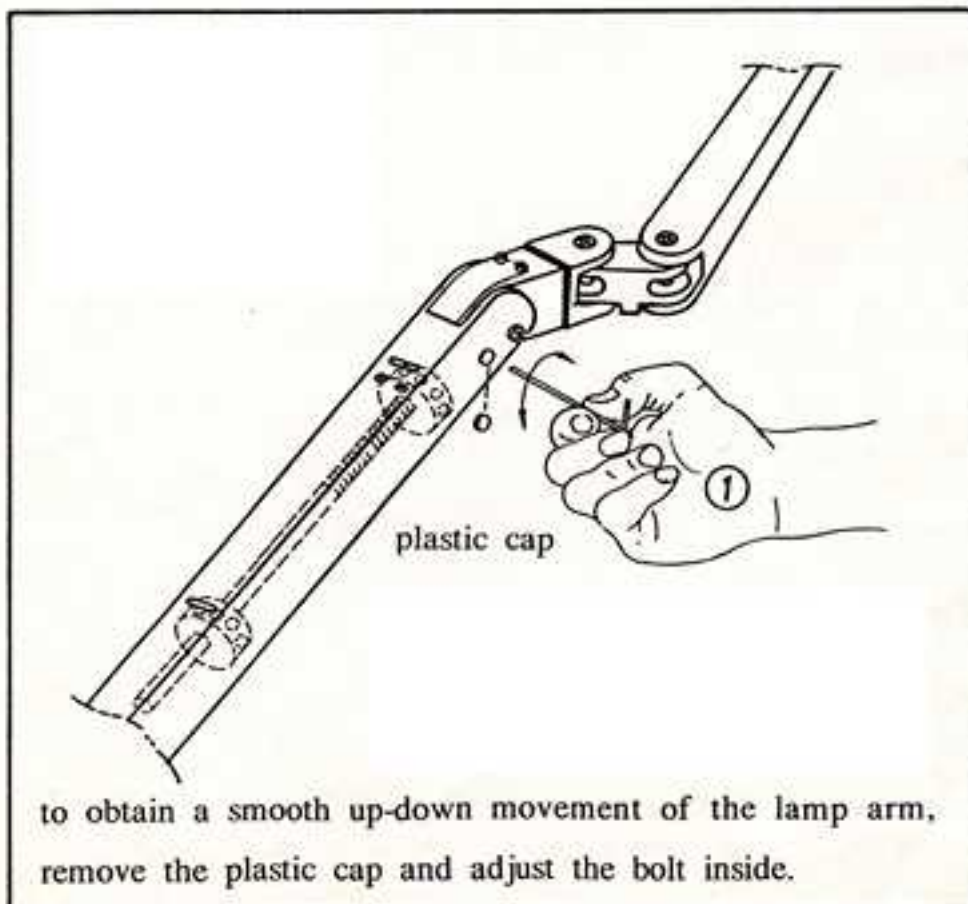
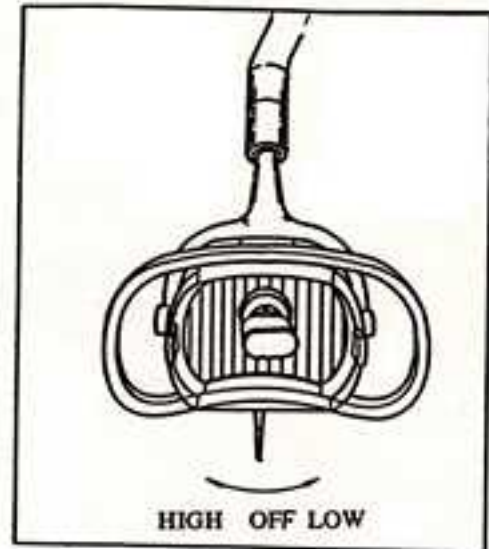

BALANCE ARM ADJUSTMENT(Should drifting occur)

IMPORTANT: Use slot closest to head when making adjustment for drifting of balance arm. Insert adjusting bar into slot on top of balance arm. turn spring adjustment nut clockwise for more tension; counterclockwise for less tension.

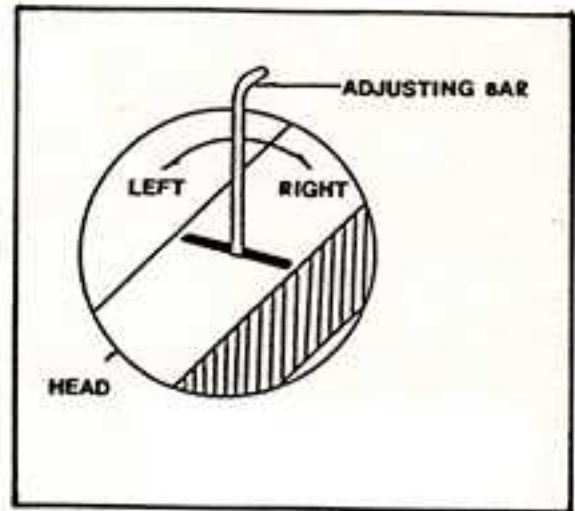

to adjust the spring tension of the lamp arm; insert the tool thru slot ② then turn the round nut to obtain proper balance.

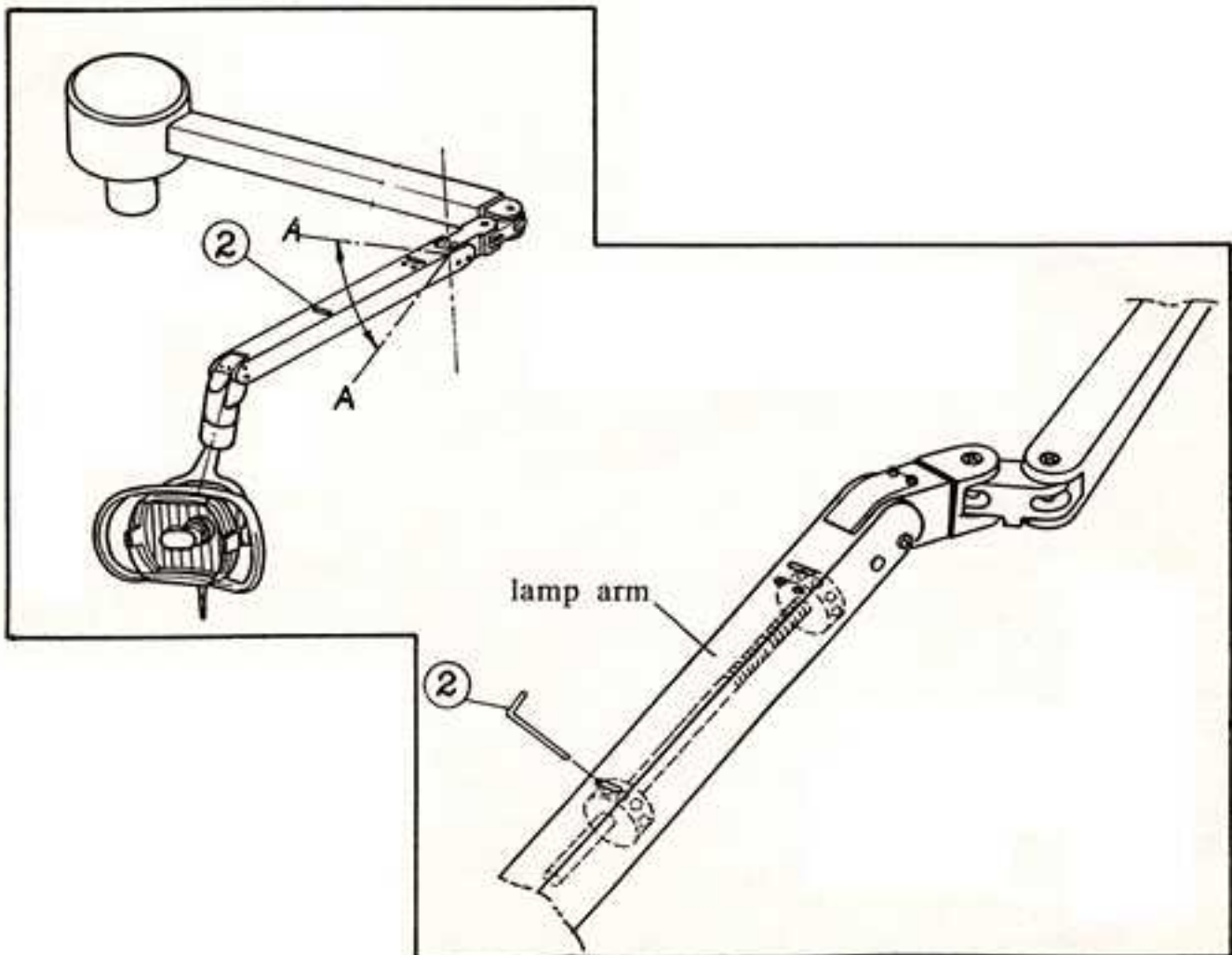

ADJUSTING ANGLE OF HEAD FROM VERTICAL POSITION

IMPORTANT: Use slot closest to H-shaped casting bracket when adjusting angle of head. Insert adjusting bar into slot on top of balance arm, turn spring adjustment nut clockwise for downward angle; counterclockwise for upward angle.

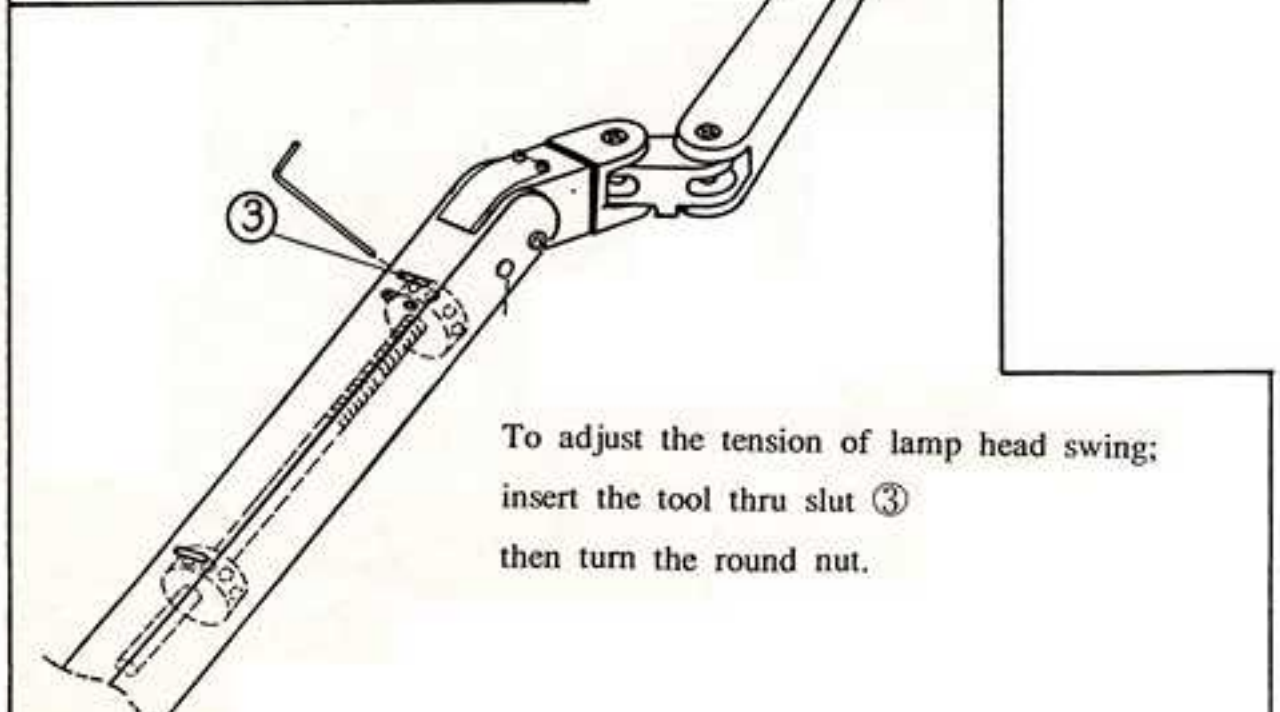
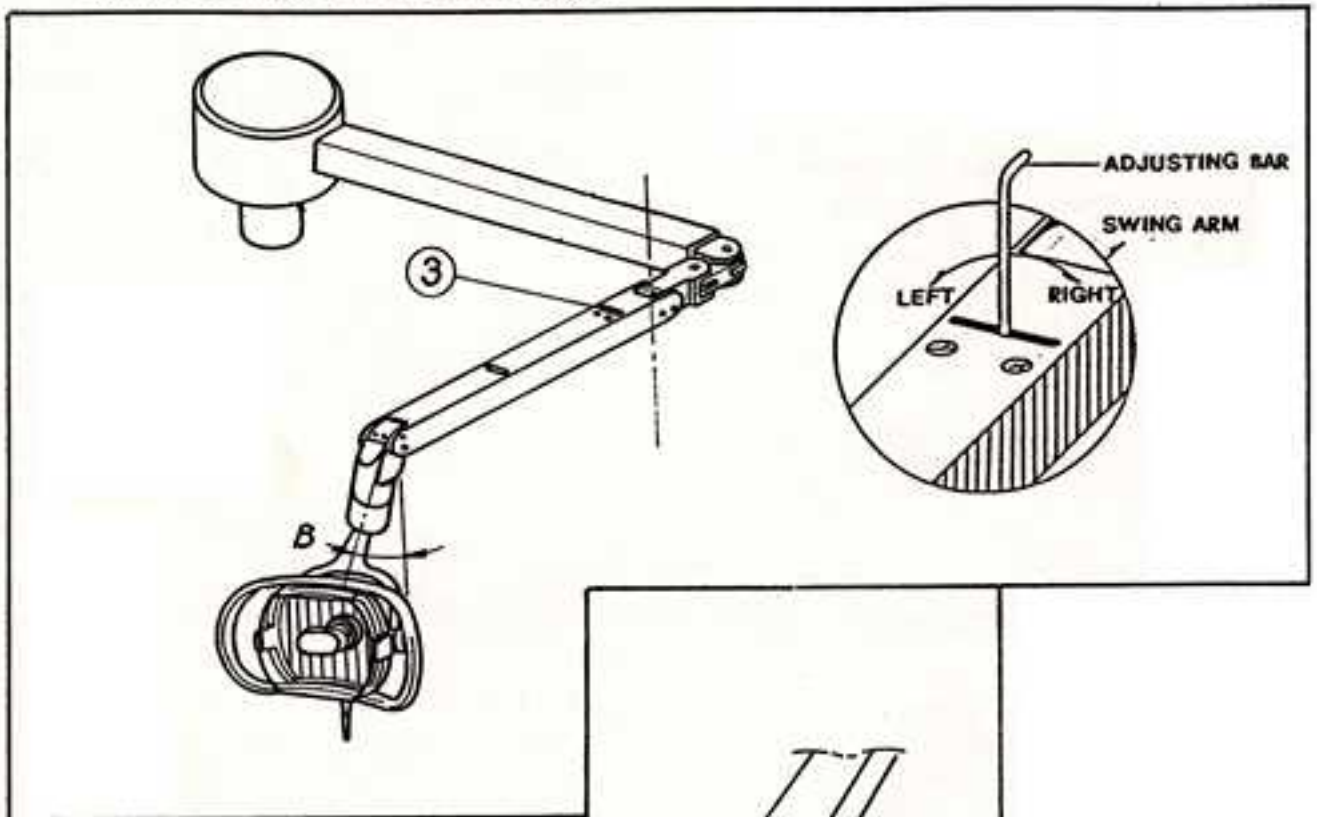

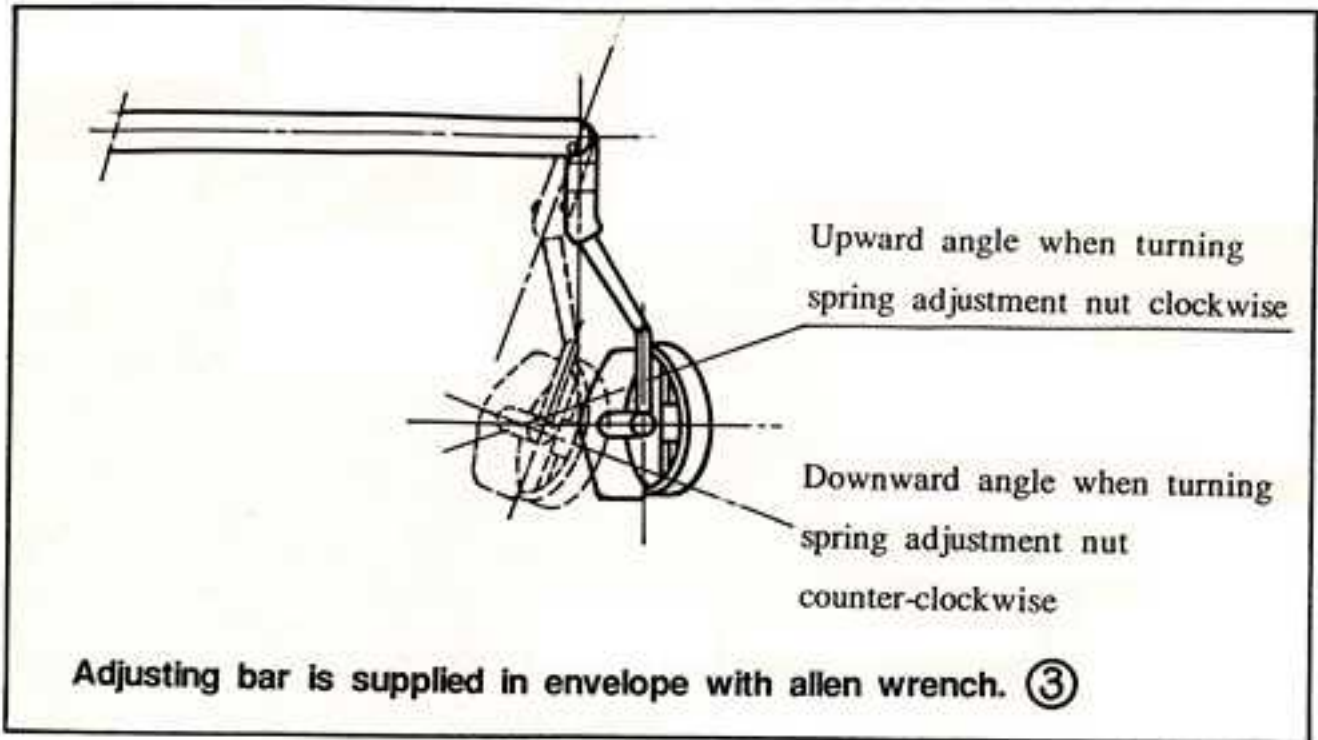

Lamp head to target distance at 725mm will provide optimum effect with a square illuminated area.

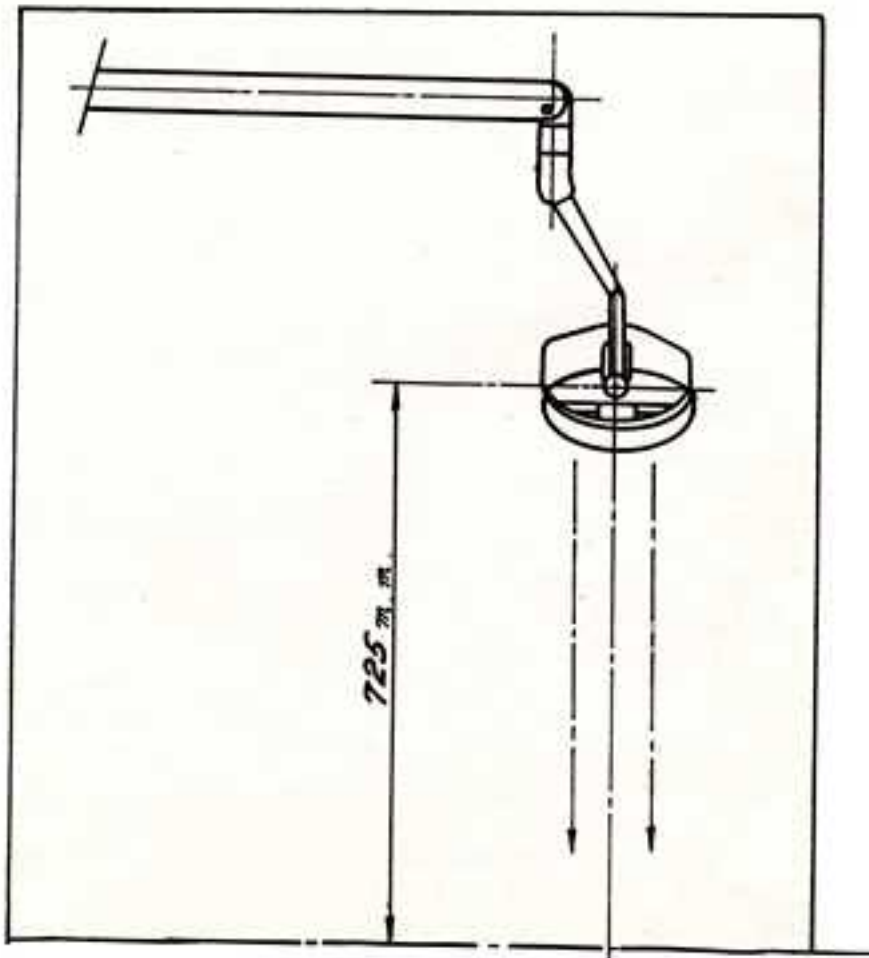

OPERATION & SERVICE INSTRUCTIONS

BULB CHANGING

1. To install replacement bulb (12V,55W), turn unit off and remove back cover. (Recommend using 37r E1 00621 abgh3)
2. Push in and turn spring clip counterclockwise to remove spring assembly.
3. Remove bulb by grasping lead wire and pull bulb from housing.
Disconnect lead wire when bulb is completely removed.
4. Clean new replacement bulb with alcohol. attach lead wire and insert new bulb into housing.
5. After new bulb is seated in housing, insert and lock spring clip into position.

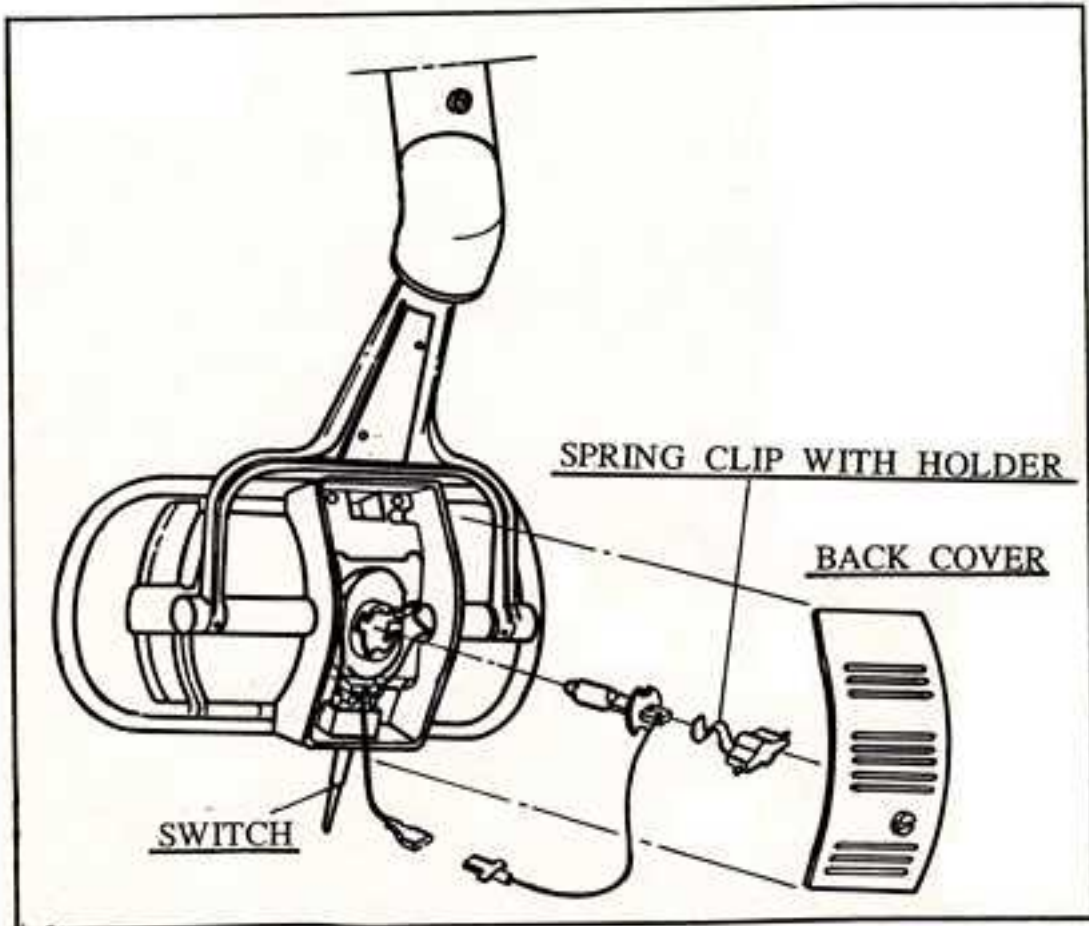

Important: Do not touch glass with bare hand.
Light bulb surface must be clean.
Oil or body moisture will affect light
Intensity. If glass surface is touched,
clean with alcohol.

CLEANING

Use soft cloth or cotton only. Soak with alcohol. Clean both sides of lens. Insided surface of reflector can be cleaned with a soft damp or dry cloth. Back side of the reflector should be wiped gently with a soft cloth. Extreme care should be taken not to scratch surface or mar appearance of painted surfaces. Exterior cleaning is all that should be necessary unit after many months of use.

LUBRICATION

A drop of oil once a year at pivot points will provide ample lubrication.

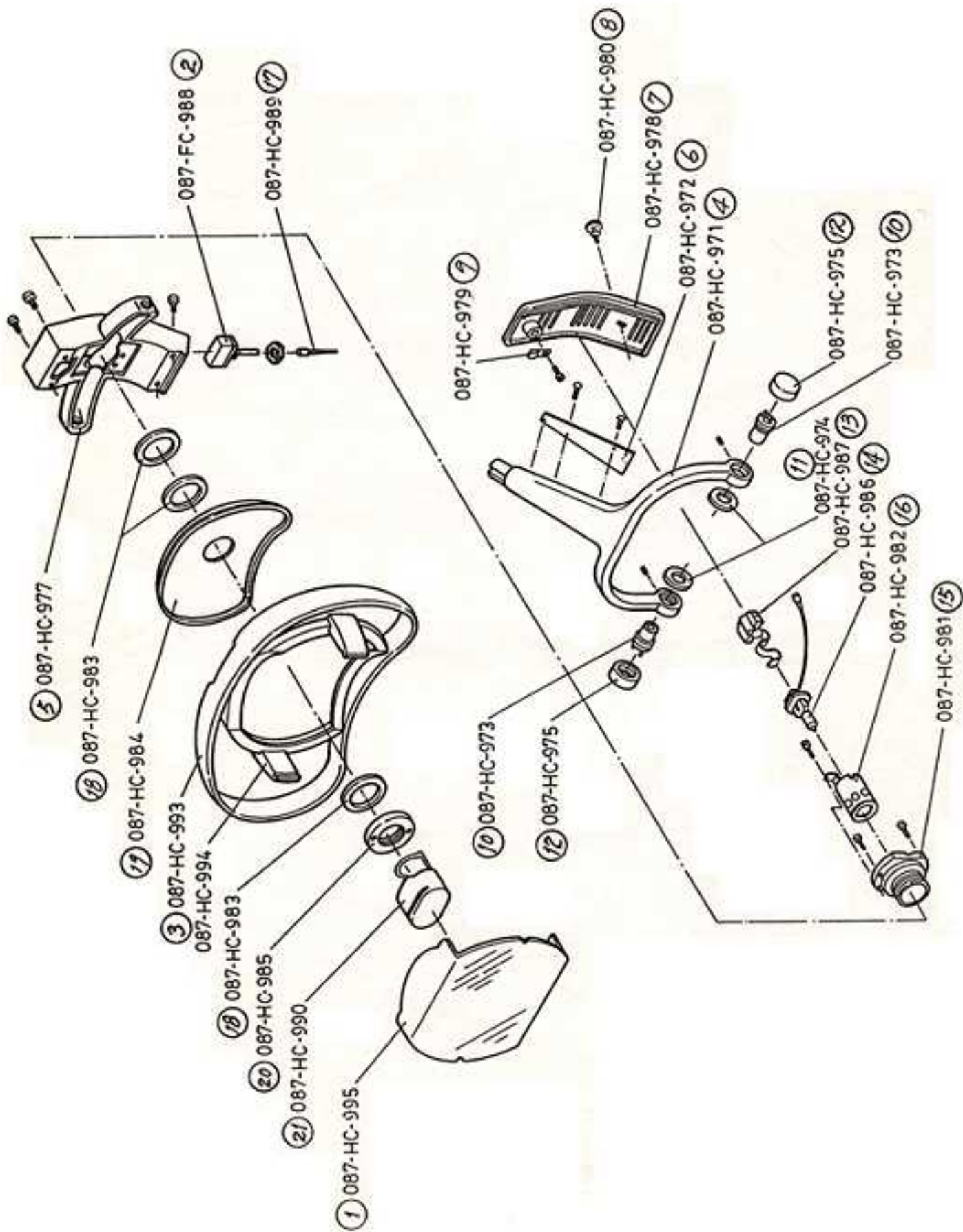

087 DENTAL LIGHT PARTS LIST

INDEX #	PART #	DESCRIPTION	QUANTITY
1	087-HC-995	FRONT SHIELD	1
2	087-HC-988	SWITCH	1
3	087-HC-993	HANDLE	1
4	087-HC-971	YOKE	1
5	087-HC-977	FRAME	1
6	087-HC-972	YOKE COVER	1
7	087-HC-978	BACK COVER	1
8	087-HC-980	SCREW	1
9	087-HC-979	SWIRE	2
10	087-HC-973	SHAFT	4
11	087-HC-974	WASHER	2
12	087-HC-975	CAP	1
13	087-HC-987	SPRING CLIP	1
14	087-HC-986	HALOGEN LAMP	1
15	087-HC-981	LAMP SOCKET	1
16	087-HC-982	LAMP SET	1
17	087-HC-989	ROD.	1
18	087-HC-983	RUBBER WASHER	2
19	087-HC-984	REFLECTOR	1
20	087-HC-985	NUT	1
21	087-HC-990	GALRE STOP	1

