

## Screw-On Tip Style SE Valve Installation

(Model #03-78- Autoclavable)

**Step 1-** Turn off vacuum.

**Step 2-** Cut tubing directly below existing valve.

**Step 3-** Attach the valve to the tubing by inserting the barbed base into your tubing. Dipping the end of your tubing in hot water will make it easier to slide over the barb.

**NOTE:** Prior to sterilization - completely disassemble (as shown to the right) by pushing the valve cylinder and lever out. Clean & rinse thoroughly with water and lubricate all moving parts with a silicone based lubricant.

- **DO NOT USE BLEACH ON THIS PRODUCT.**
- **DO NOT CLEAN BY SONIC METHODS.**

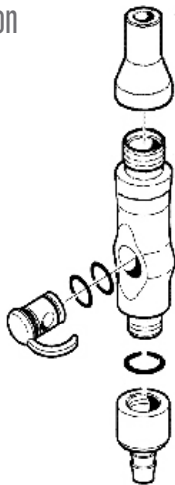

 **AMERICAN**dental  
accessories

7310 Oxford Street • St. Louis Park, MN • 55426

Phone (800) 331-7993 • Fax (888) 729-1016

[www.amerdental.com](http://www.amerdental.com)