

Lever Style SE Valve Installation

(Model #'s 03-23, 03-231, 03-232- Autoclavable)

- Step 1-** Shut off the vacuum.
- Step 2-** Cut tubing and remove existing valve.
- Step 3-** Attach the valve to the tubing. Inserting tubing ends in hot water and/or the use of soap will aid in this process.

Note: After each disinfection- disassemble, clean & thoroughly flush with water & lubricate all moving parts with a silicone based lubricant.

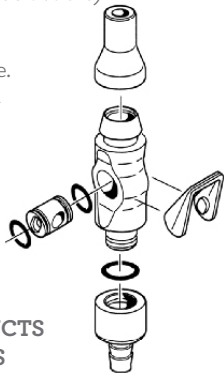

DO NOT USE BLEACH ON THESE PRODUCTS
DO NOT CLEAN BY SONIC METHODS



AMERICANdental
accessories

7310 Oxford Street • St. Louis Park, MN • 55426

Phone (800) 331-7993 • Fax (888) 729-1016

www.amerdental.com