

Lever Style HVE Valve Installation

(Model #'s 03-09, 03-091 & 03-10, 03-101- Autoclavable)

- Step 1-** Turn off vacuum.
- Step 2-** Cut existing valve from tubing.
- Step 3-** Attach the valve to the tubing by inserting the barbed base into your tubing. Dipping the end of your tubing in hot water will make it easier to slide over the barb.

NOTE: Prior to sterilization- completely disassemble (as shown to the right) by prying the lever off and pushing the valve cylinder out. Clean & rinse thoroughly with water and lubricate all moving parts with a silicone based lubricant weekly.

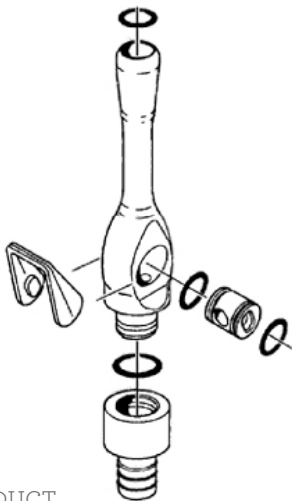

- DO NOT USE BLEACH ON THIS PRODUCT.
- DO NOT CLEAN BY SONIC METHODS.



AMERICANdental
accessories

7310 Oxford Street • St. Louis Park, MN • 55426
Phone (800) 331-7993 • Fax (888) 729-1016
www.amerdental.com