

PINGuard wings for
Push Button Locks &
Door Access PIN pads



PINGuard™

PINGuard™

PINGuard wings for Push Button Locks & Door Access PIN pads

Important Information Please Read First

- **Warning! Do not fit when surface temperature is below 10°C/50°F (see Adhesive information)**
- All safety equipment to be provided by installer
- For all Material Safety Data Sheets please email support@pinguard.com
- For full details on warrant liability please refer to Espier Ltd terms and conditions
- For full terms and conditions please email support@pinguard.com

Adhesive Information

The VHB tape adhesive takes 3 days to reach full 100% strength. The VHB adhesive is covered in microscopic bubbles filled with liquid adhesive. When the tape is pressed onto the payment terminal, the pressure bursts the bubbles and releases the liquid adhesive that bonds to the payment terminal. When the environment is cold (which is why we say not to fit below 10°C/50°F) the liquid doesn't flow correctly which makes the bond weak. Also if there is any grease, moisture or dirt on the surfaces this will greatly reduce the bond strength and may cause the bond to fail (this can be seen if there is no adhesive residue left over on the payment terminal).

For other translations of this instruction sheet please email support@pinguard.com

www.PINGuard.com

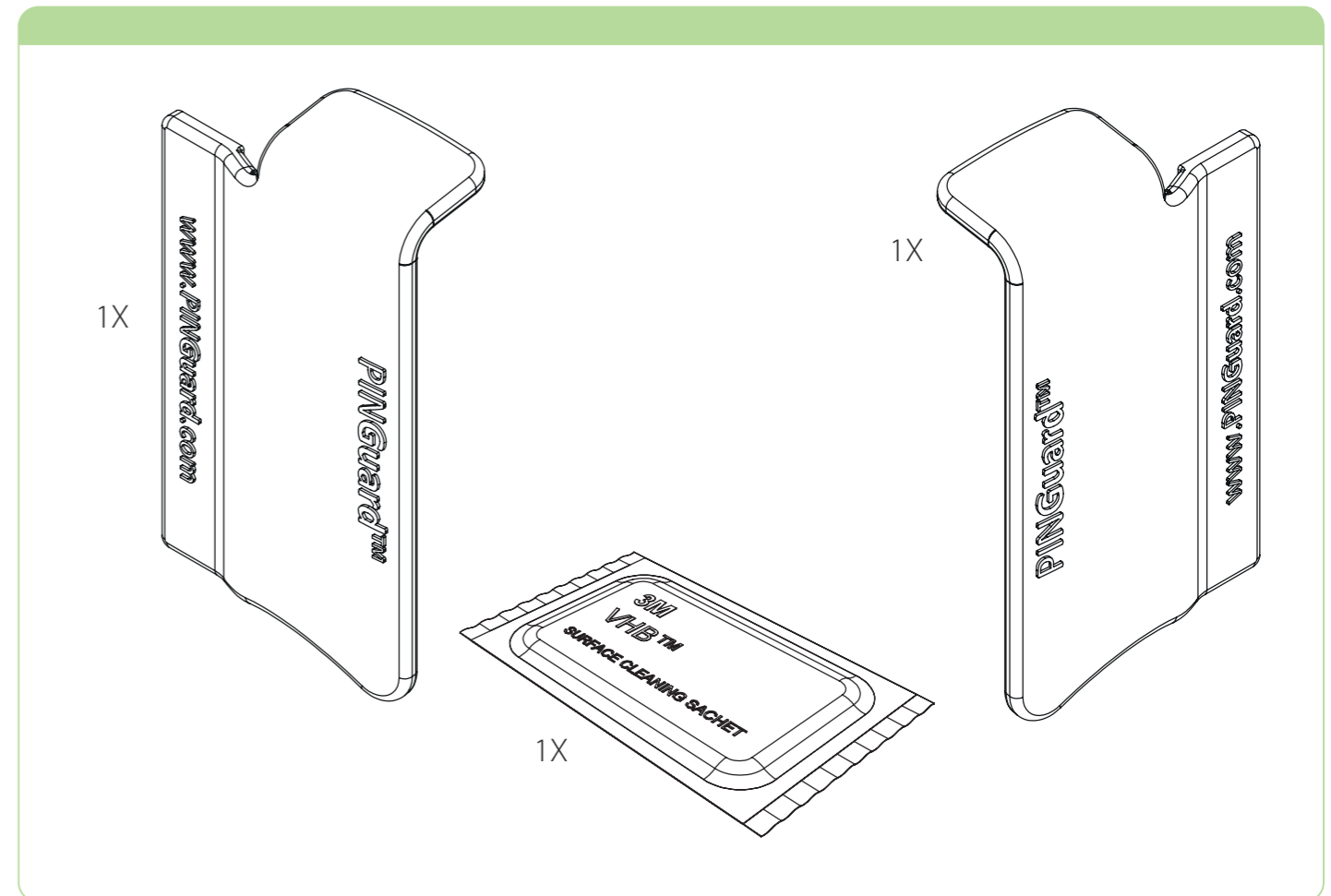

Fitting Instructions

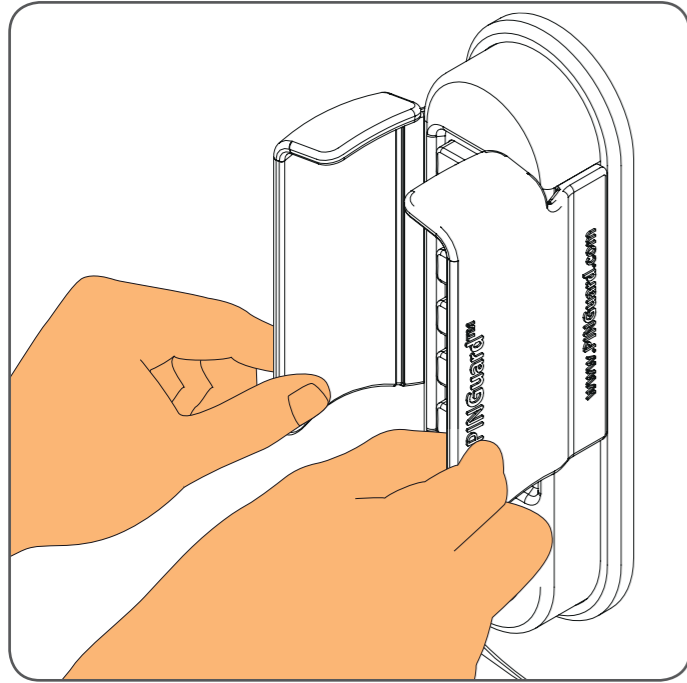

Step 1: Take both the left and right PINGuard® wings and offer them up to the PIN pad as shown. Making sure they are in a good position to bond to the terminal. Ensure that the wings are positioned for the good access for the user.

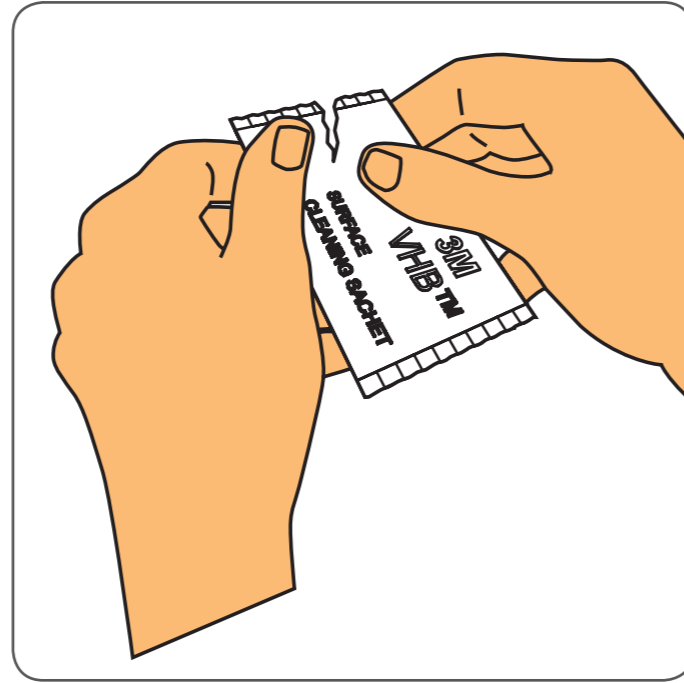

Step 2: Open cleaning sachet.

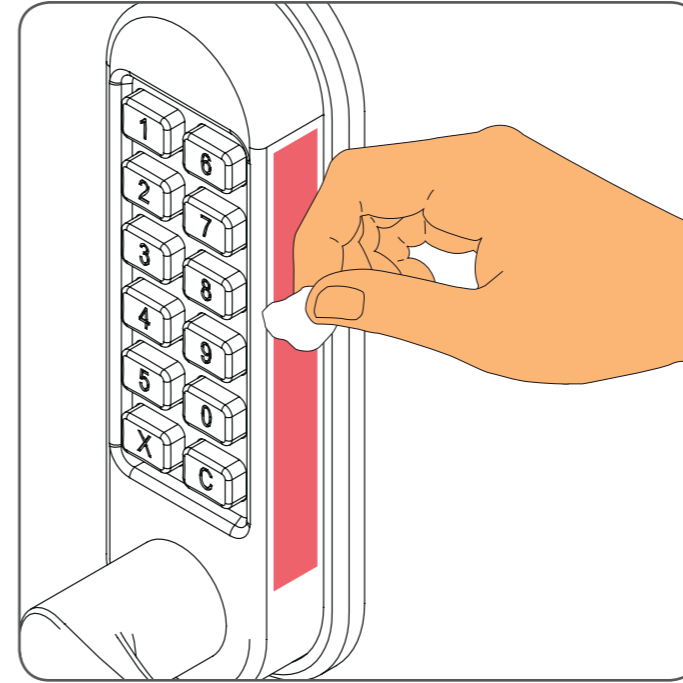

Step 3: Thoroughly clean the area shown using cleaning sachet provided. Ensure that it is absolutely clean. Allow to dry for 1 to 2 minutes.

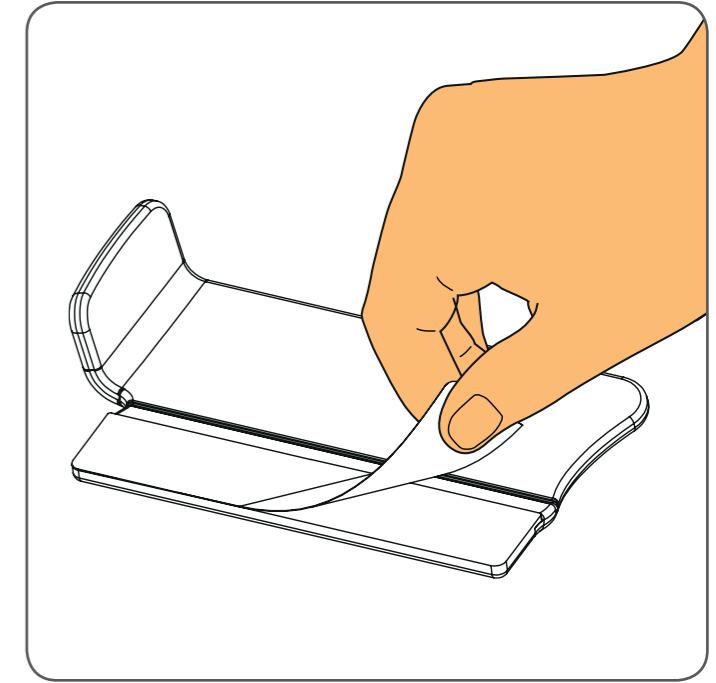

Step 4: Peel off the tape backing.

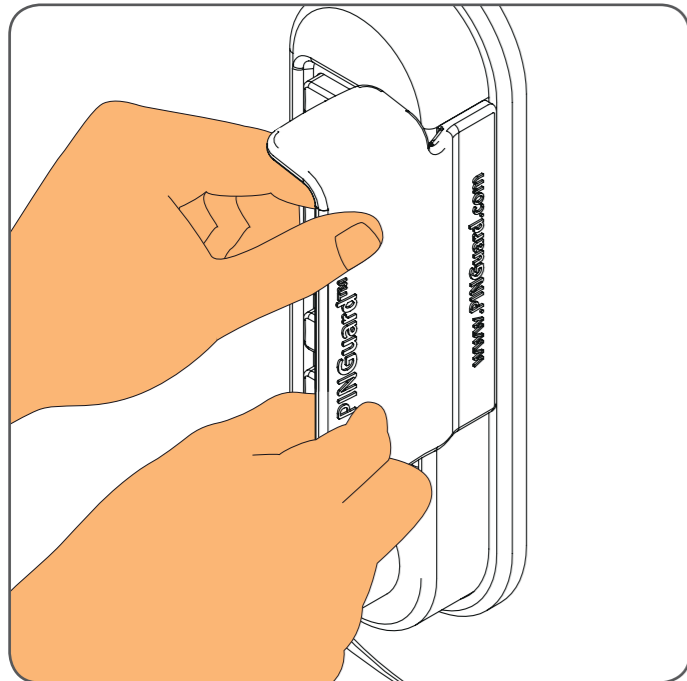

Step 5: Then carefully align the PINGuard® wings as before and gently press into position (if they are not in the correct position gently peel them off and reapply in the correct position).

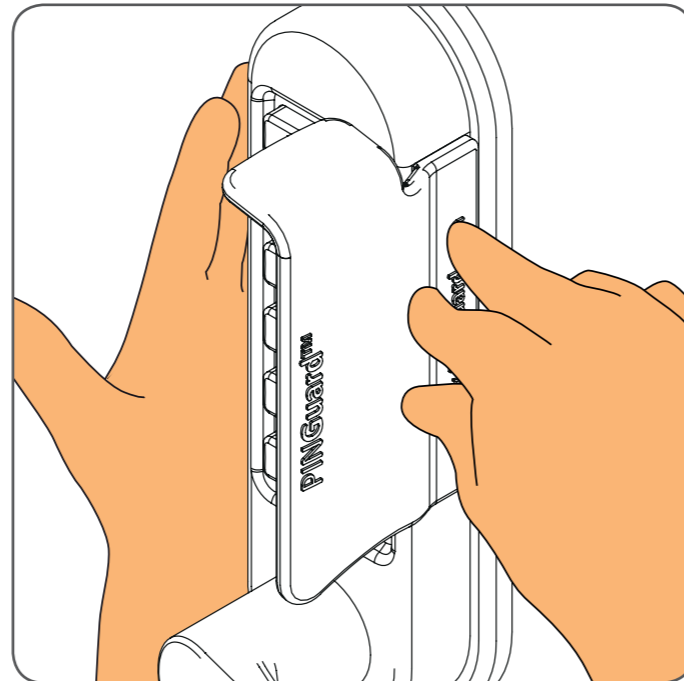

Step 6: Once correctly aligned and fitted, **apply heavy pressure to the base for at least 2 minutes!** This will remove any air bubbles and is vital for good adhesion. Leave for 5 minutes for bond to cure.

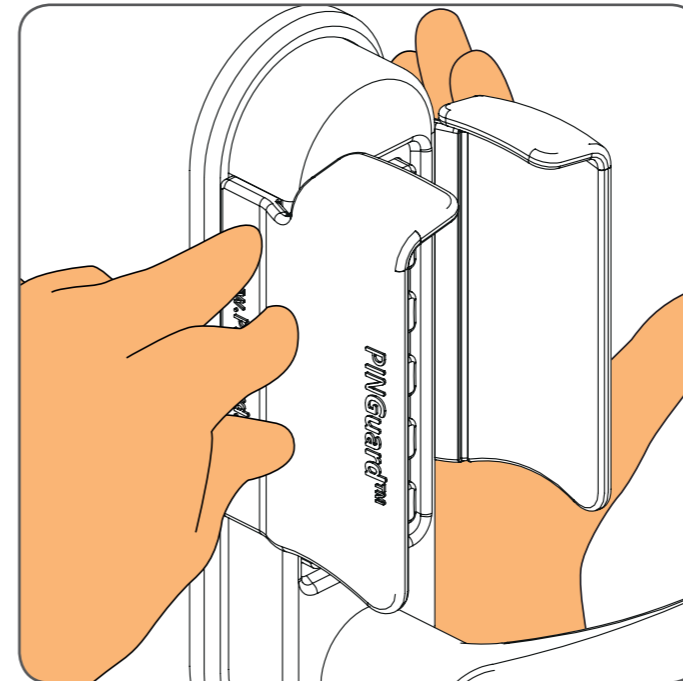

Step 7: Follow the procedure on the left hand side. Fitting complete.