

Important Information Please Read First

- **Warning! Do not fit when surface temperature is below 10°C/50°F (see Adhesive information)**
- Battery drill required for installation
- All safety equipment to be provided by installer
- Fitting template is a guide and for some ATMs may not be needed
- For all Material Safety Data Sheets please email support@pinguard.com
- For full terms and conditions please email support@pinguard.com
- For other version of the PINGuard® (EVO3, EVO5 and the EVO3 Compact) follow the relevant standard instruction manual to step 8 then use then start from step 8 from the physical fixing manual
- Check manufacturers warranty before fitting

Optional Physical Fixing Manual

PINGuard™

Additional Components Required for the Installation

PINGuard™

Optional Physical Fixing Manual

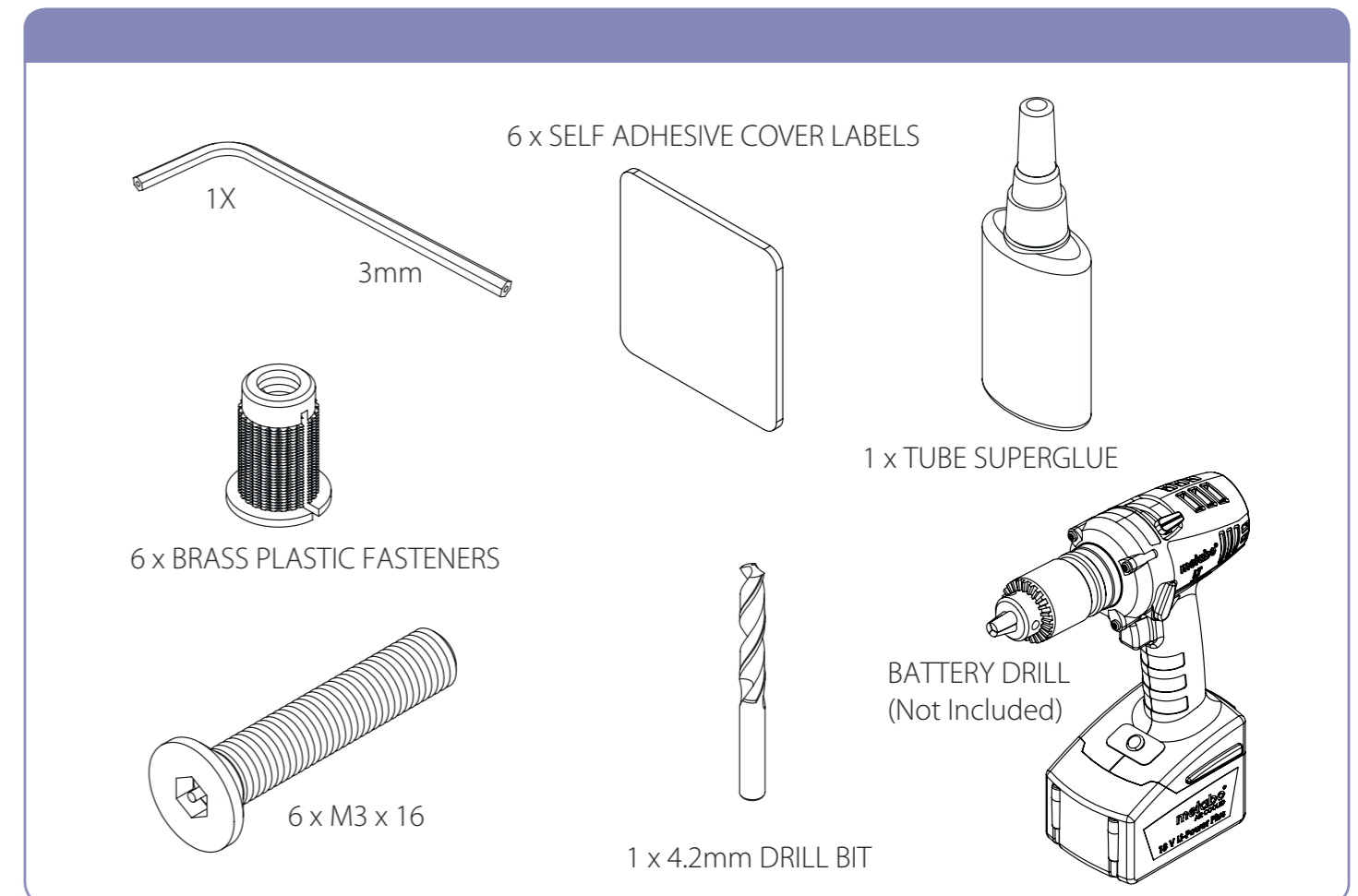

Fitting Instructions

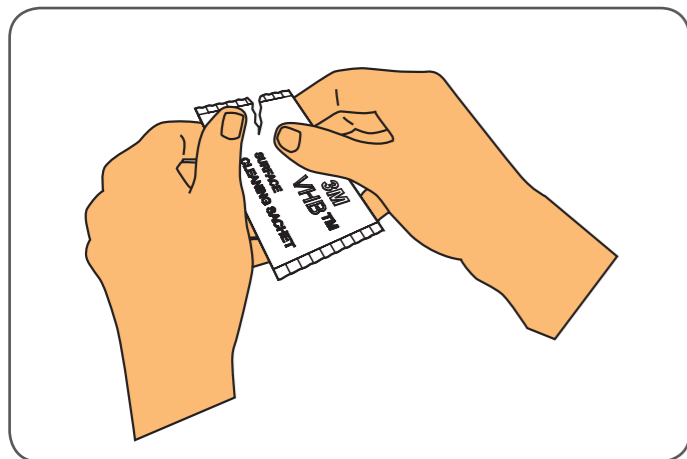

Step 1: Open cleaning sachet.
For a retrofit installation go to step 8.

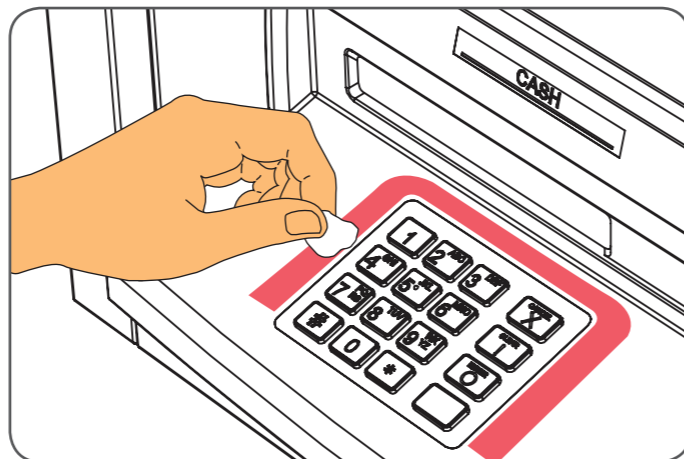

Step 2: **Thoroughly clean the area shown** using cleaning sachets provided. All three sachets may be required to ensure that it is absolutely clean. The area around the PIN Pad must be completely clean for the best adhesion. Allow to dry for 5 minutes.

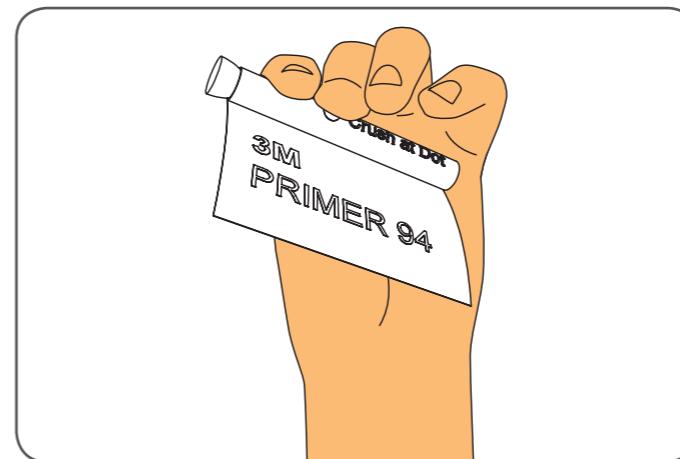

Step 3: Break primer ampoule by pressing firmly on the black dot in the middle. Keep squeezing the dot until liquid appears on the application pad at the end of the ampoule.

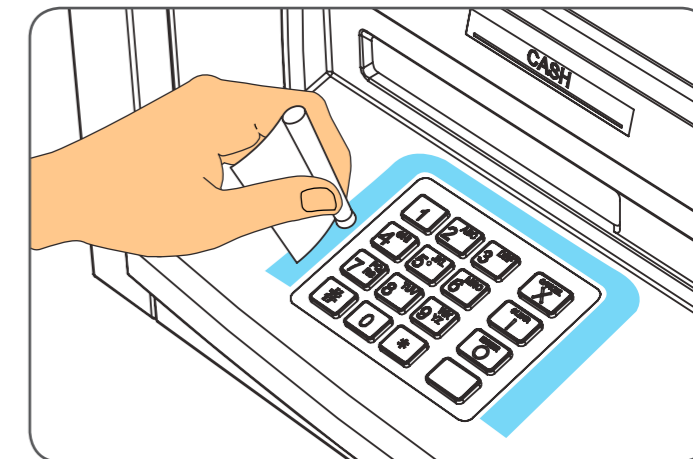

Step 4: Brush the primer onto the area shown. Ensure complete coverage of PINGuard® footprint area. Allow to dry for 5 minutes.

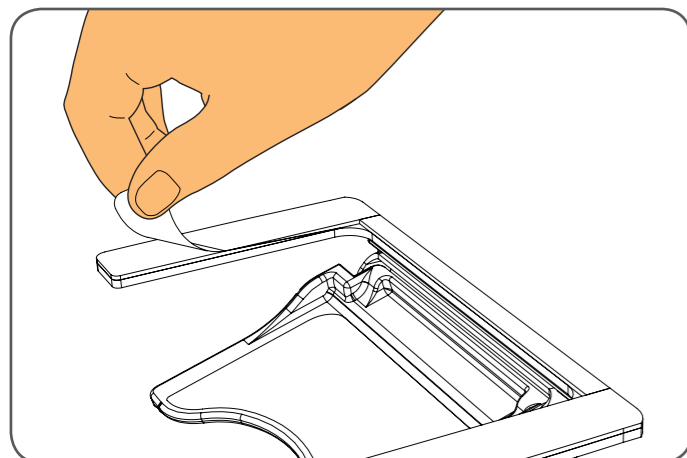

Step 5: Peel tape from the base of the PINGuard® ensuring that you do not touch the adhesive surface.

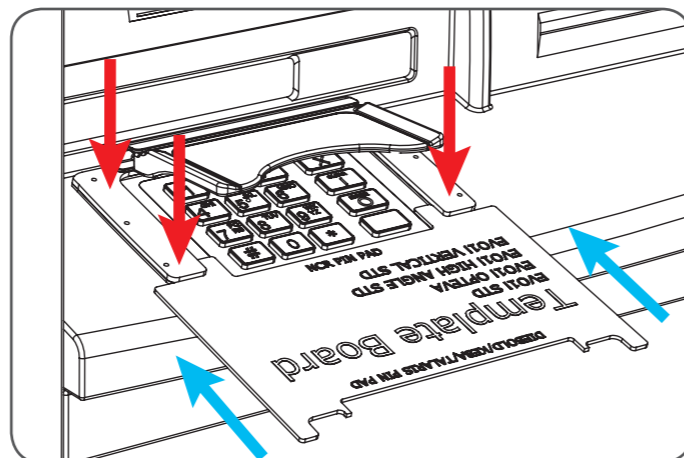

Step 6: Place the PINGuard® onto the ATM so that the base lines up with the template board as shown.

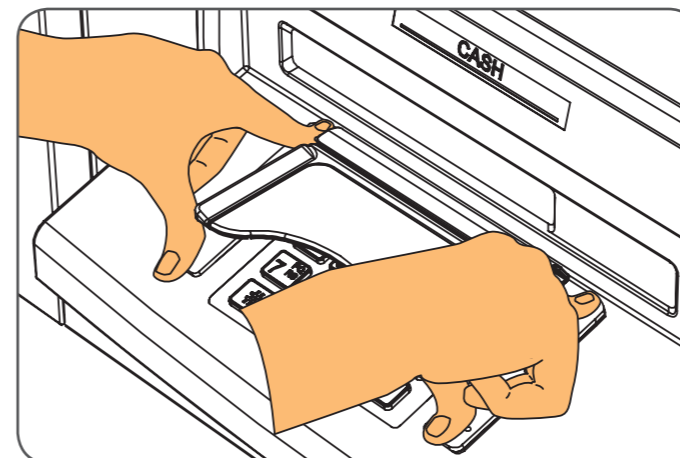

Step 7: Once correctly aligned and fitted, **apply heavy pressure to the base for at least 2 minutes!** This will remove any air bubbles and is vital for good adhesion. Leave for 5 minutes for bond to cure.

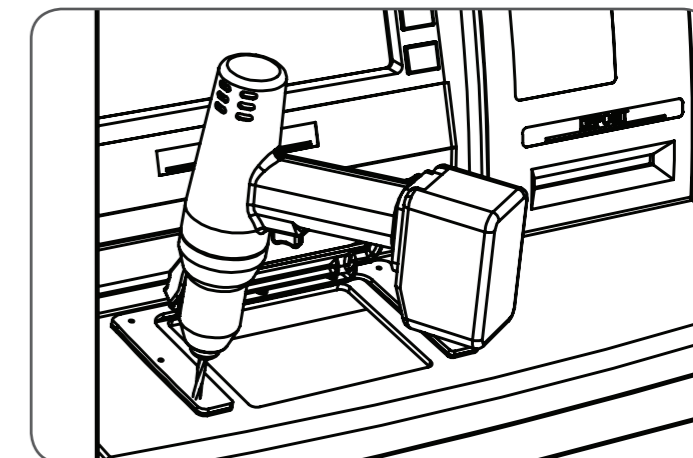

Step 8: **Remove ATM PIN pad.** Then using the 4.2mm drill bit, drill through the 6 holes in the base plate. Clean anyway any swarf.

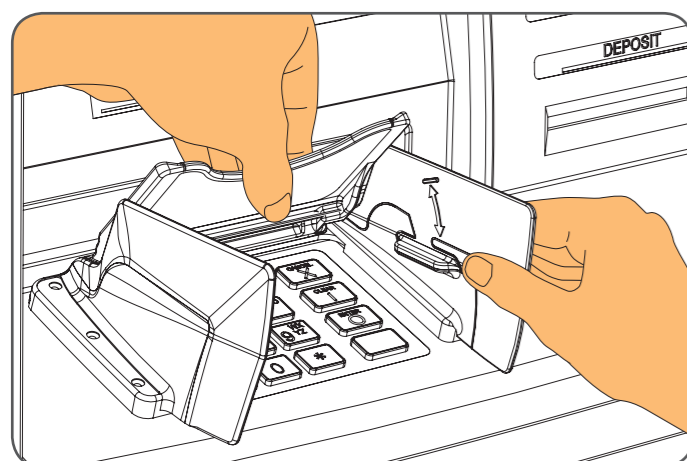

Step 9: Lift the lens up and slide the wings as shown.

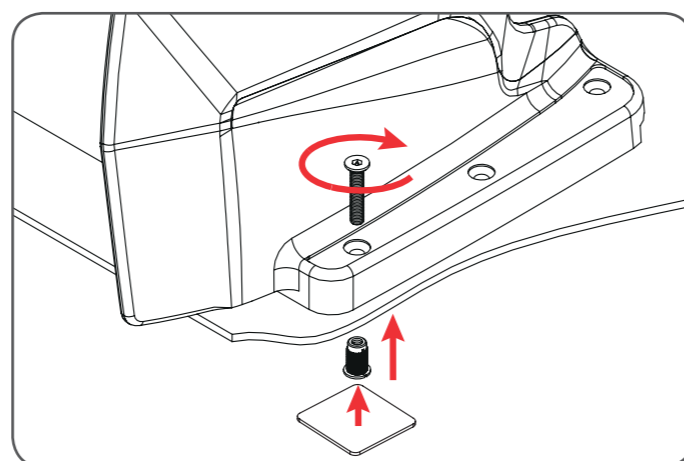

Step 10: Insert the brass plastic fastener into the drilled holes, pushing up from the underside of the ATM Fascia. Keep pressing your finger on the brass plastic fastener as you screw the M3 X 16 screws. Complete this process on all 6 screws.

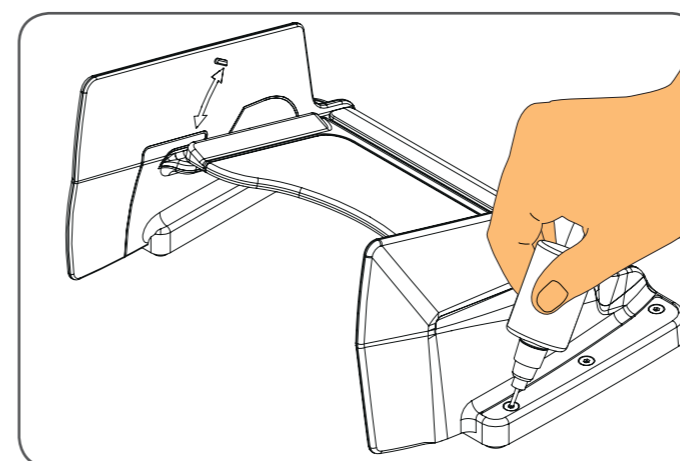

Step 11: Optional. To ensure that the screws cannot be removed easily there is the option of gluing the hexagonal socket screw head. This will mean that the allen key will not locate into the screw head. **Using this will mean that the screw heads will have to be drilled out if the PINGuard® is repaired in the future.**

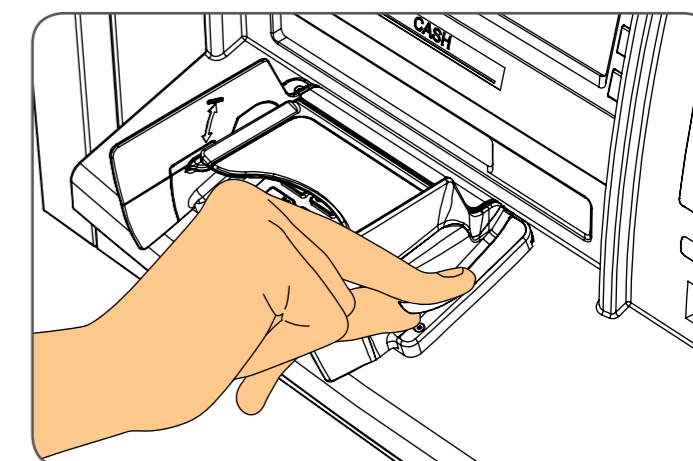

Step 12: Fit the cover labels.