

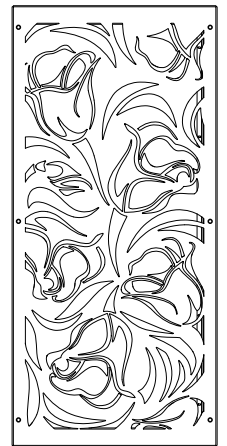

METAL
Garden Screen

FLAT SCREEN INSTALLATION

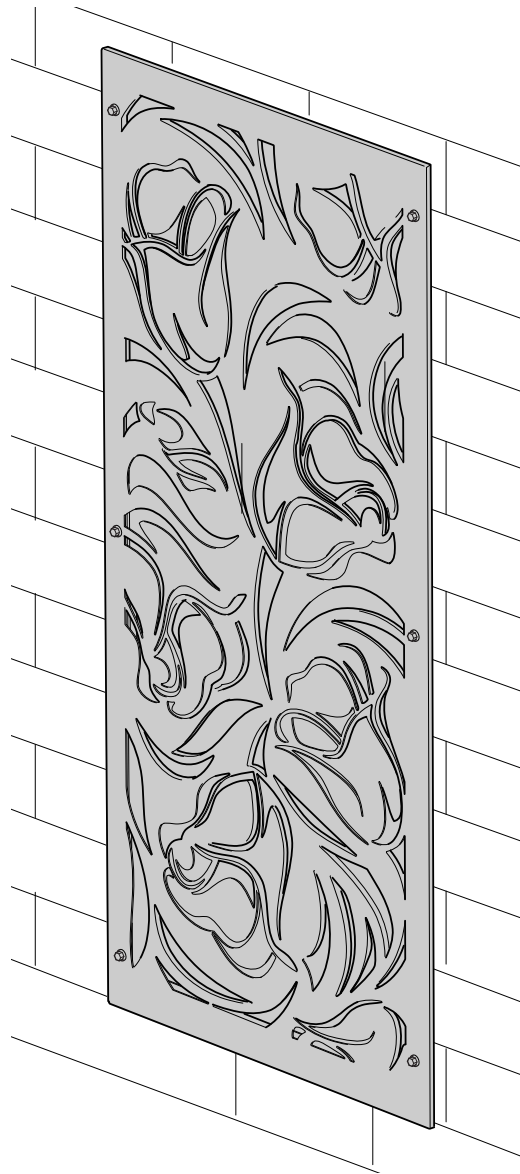

TOOLS REQUIRED

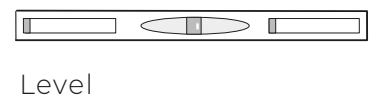
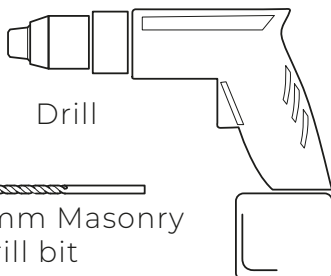



INSTALLATION

- 1** Position the screen on the wall. Level it, then mark hole positions (Along the sides of the screen.)

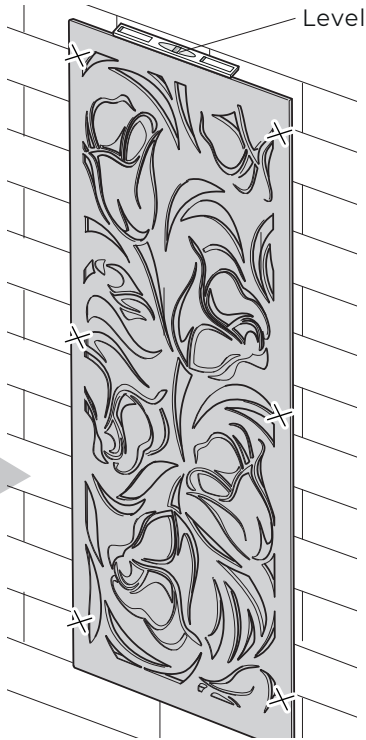

- 2** Drill holes on the marks.

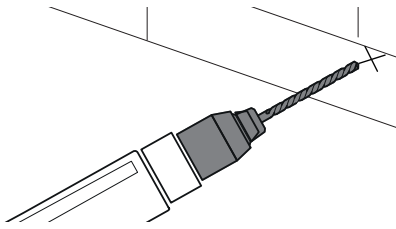

Parts

	Screen	x 1
	Anchor bolt	x 6

- 3** Screw the screen to the wall using 6 anchor bolts.

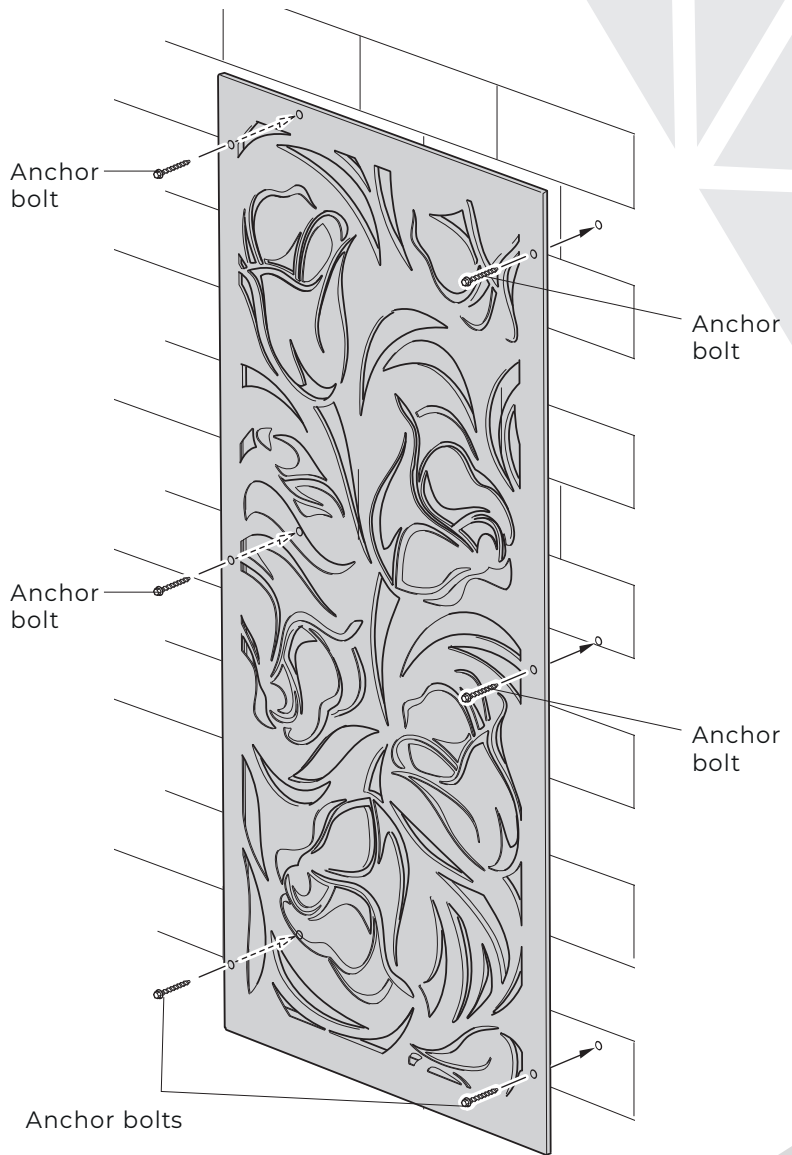

PRO TIPS

Leave mounted anchor bolts loose until all bolts are attached. Slowly tighten. **Do not over-tighten to avoid damage to powder coating.**



METAL
Garden Screen

Metal Garden Screen Ltd.

Metal Garden Screen, Unit 2381
37 Westminster Buildings, Theatre Square
Nottingham. NG1 6DQ

Tel: +44 800 044 8412

Email: [sales@metalgardenscreen.co.uk/](mailto:sales@metalgardenscreen.co.uk)

Website: <https://metalgardenscreen.co.uk/>

REGISTERED IN ENGLAND
Company number: 9270750

