

**G57JAS03XX** Series Stainless Steel

18" Center on center stainless steel grab bar with concealed flange plates. 1.25" diameter, 1.2mm wall thickness, 304 stainless steel.

Mounting hardware supplied for wood stud installation.

**Product Data**

Overall Dimensions (Inch.)	21-1/8x2-3/4x3-1/8
Net Weight (lbs.)	1.37

**Installation Hardware Details**

Stainless steel screw and dowels

**Packaging Details**

Package	Polyethylene package
Package dimensions (Inch.)	21-1/8 x 2-13/16 x 3-1/8
Weight with Packaging (lbs.)	1.37

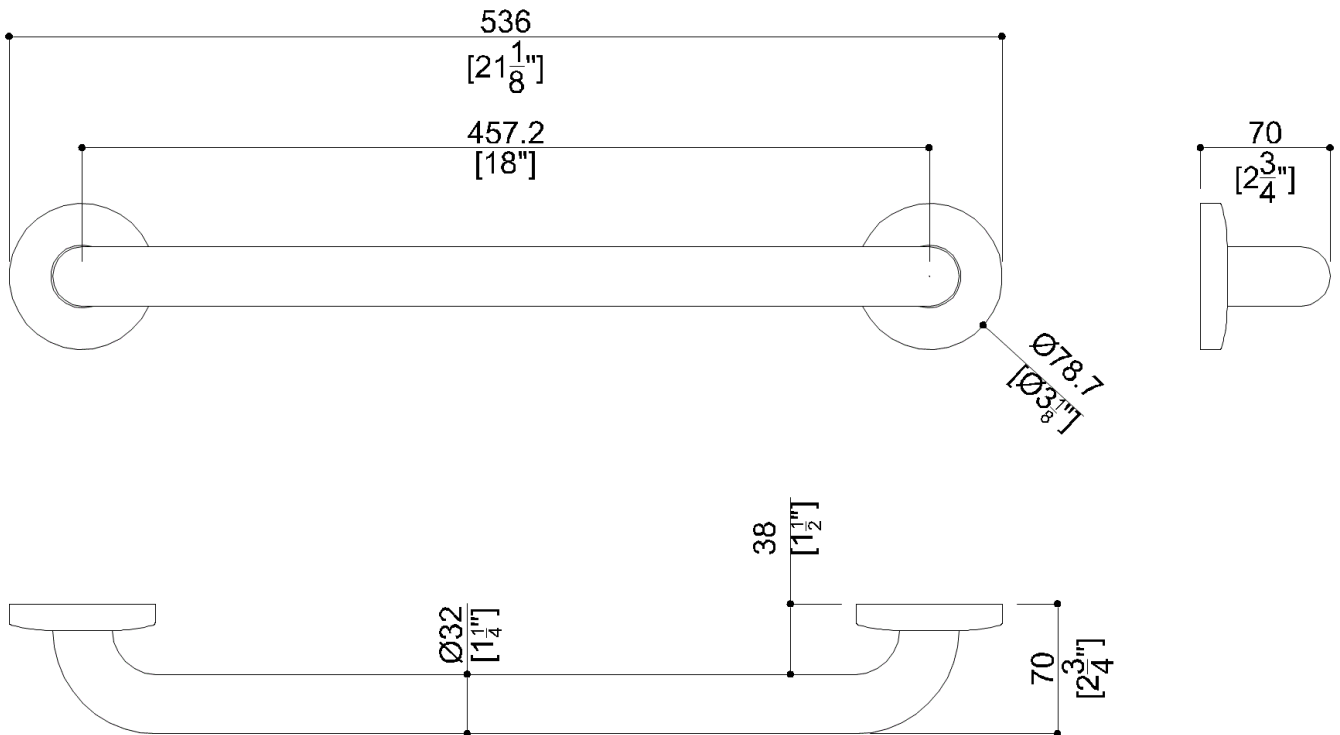

**G57JAS03XX** Series Stainless Steel

AISI304 stainless steel fixing plate

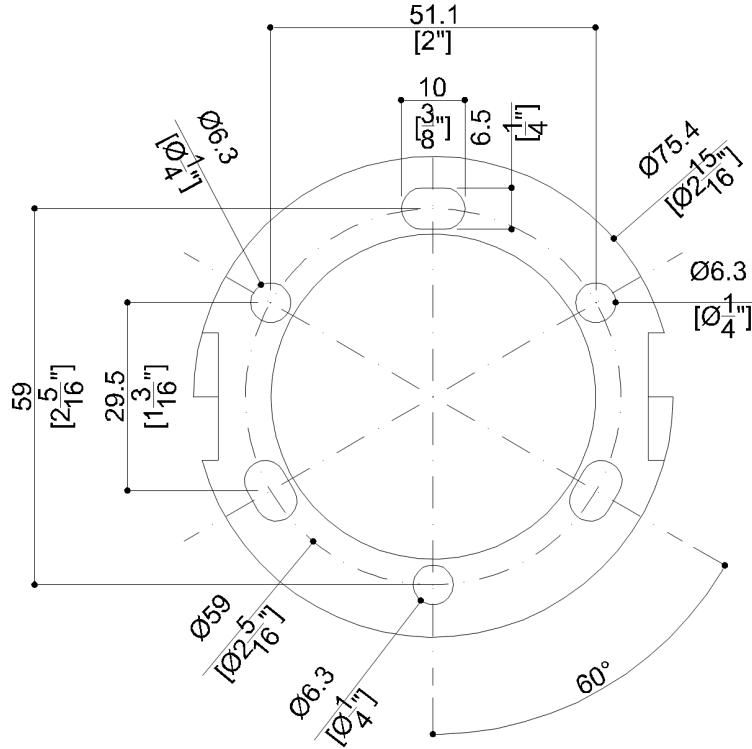

**Available Finishes (xx)**

N1	Satin	N2	Bright
----	-------	----	--------

**Load Capacity**

Vertical	450 lbs.
----------	----------

**Warning**

Before installation and use, read the installation and use instructions in their entirety. If questions arise please contact Ponte Giulio company.

**Cleaning**

Product can be cleaned with a cloth and warm soapy water. Non abrasive, solvent free cleaners can also be used.

**Warranty**

Please visit [www.pontegiulio.com](http://www.pontegiulio.com) for complete warranty details.

**Materials and finishes**

Stainless Steel	N/A.
-----------------	------