



# EPT20-15EHJ

## Semi Electric Truck 1.5t

- Light service weight, large loading capacity, suitable for narrow working space;
- Latest integrative handle design makes reachable control;
- Modularized structure more convenient for troubleshooting and maintenance.

EP EQUIPMENT CO.,LTD  
[www.ep-ep.com](http://www.ep-ep.com)



## ▣ FEATURE

---

### ■ Light Weight, Great Capacity, Excellent Passingability:

1500KG capacity, light weight and compact size equivalent to hand pallet trucks.

### ■ External Control System:

The external control system not only protects controller in place but also provides easy access for maintenance.

### ■ Operation :

Ergonomically-designed tiller head helps increase efficiency;  
Internal Charger for Easy Charging.

### ■ Safety :

Handy Emergency Disconnect Button & Durable Driving Unit ensure safety under any situation.

### ■ Maintenance :

Modular design of electrical components, Easy for Diagnosis and Replacing.

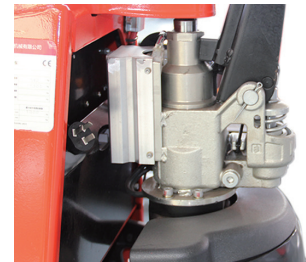
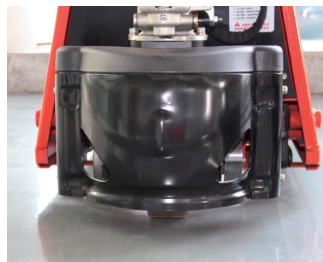
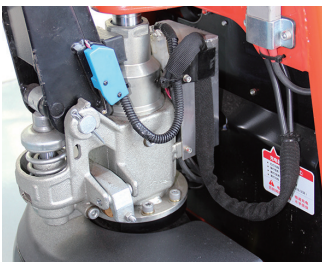

# Semi Electric Truck 1.5t

## EPT20-15EHJ

Distinguishing mark				
1.1	Manufacturer			EP
1.2	Model designation			EPT20-15EHJ
1.3	Drive unit			Electrics
1.4	Operator type			pedestrian
1.5	rated capacity	Q	kg	1500
1.6	Load center distance	c	mm	600
1.8	Load distance	x	mm	882/946
1.9	Wheelbase	y	mm	1147/1211
Weight				
2.1	Service weight (include battery)		kg	155
2.2	Axle loading, laden driving side/loading side		kg	547/1108
2.3	Axle loading, unladen driving side/loading side		kg	118/37
Types,Chassis				
3.1	Tyre type driving wheels/loading wheels			PU/PU
3.2	Tyre size, driving wheels (diameter×width)		mm	Φ210x70
3.3	Tyre size, loading wheels (diameter×width)		mm	2x Φ80x60 (Φ74x88)
3.4	Tyre size, caster wheels (diameter×width)			
3.5	Wheels, number driving, caster/loading (x=drive wheels)		mm	1x /4(1x /2)
3.6	Track width, front,driving side	b10	mm	
3.7	Track width,rear,loading side	b11	mm	410 (535)
Dimensions				
4.4	Lift height	h <sub>3</sub>	mm	115
4.9	Height drawbar in driving position min./max.	h <sub>14</sub>	mm	715/1280
4.15	Lowered height	h <sub>13</sub>	mm	85(75)
4.19	Overall length	l <sub>1</sub>	mm	1588
4.20	Length to face of forks	l <sub>2</sub>	mm	438
4.21	Overall width	b <sub>1</sub> / b <sub>2</sub>	mm	560(685)
4.22	Fork dimensions	s/ e/ l	mm	50/150/1150
4.25	Outside width of the forks	b <sub>5</sub>	mm	560/685
4.32	Ground clearance, center of wheelbase	m <sub>2</sub>	mm	35(25)
4.34.1	Aisle width for pallets 1000 × 1200 crossways	Ast	mm	1629
4.34.2	Aisle width for pallets 800 × 1200 lengthways	Ast	mm	1829
4.35	Turning radius	Wa	mm	1375
Performance data				
5.1	Travel speed, laden/ unladen	km/ h	km/h	3.5/4
5.2	Lifting speed, laden/ unladen		m/ s	10mm/time
5.3	Lowering speed, laden/ unladen		m/ s	manual lowering
5.8	Max. gradeability, laden/unladen		%	5/10
5.10	Service brake type			Electromagnetic
Electric-engine				
6.1	Drive motor rating S2 60 min		kW	0.65
6.2	Lift motor rating at S3 15%		kW	Manual Lifting
6.3	The maximum allowed size battery		mm	185/125/190
6.4	Battery voltage/nominal capacity K20		V/ Ah	12*2/30Ah
6.5	Battery weight		kg	9.5*2
Addition data				
8.1	Type of drive control			DC
10.5	Steering type			Mechanical
10.7	Sound pressure level at the driver's ear		dB (A)	74

If there are improvements of technical parameters or configurations, no further notice will be given.  
The diagram shown may contain non-standard configurations.

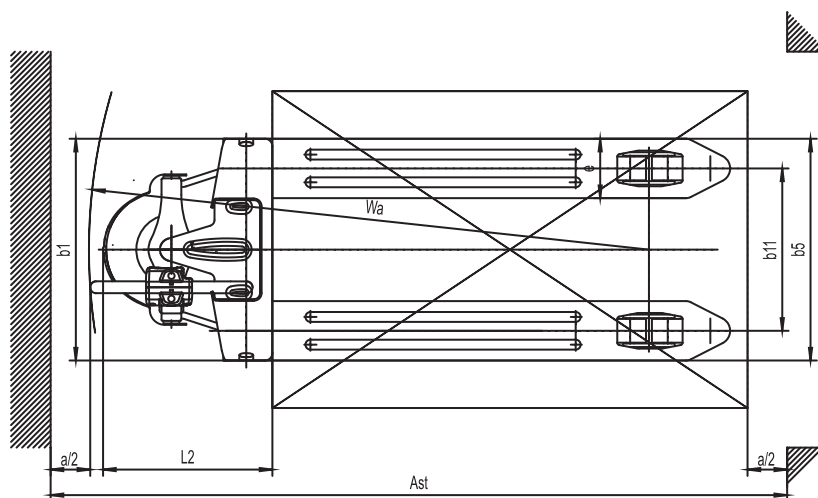
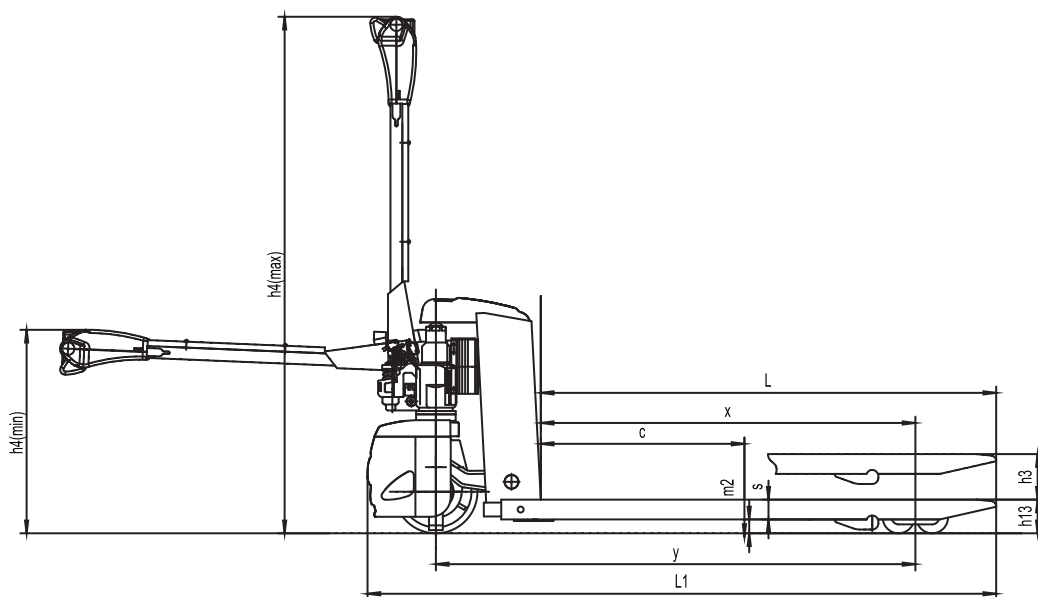

## Option

Options	type	EPT20-15EHJ
Fork length		○700 ~ 1500
Fork width		○520/600
Single load wheel	ground clearance 75mm	○
Fork lowered height		○40(capacity < 1000Kg)
Driving wheel		○PU wheel with Pattern
Balance wheel		Regular: ○ Fork length > 1400: ●
Note: Fork length < 1400, capacity 1.5T; Fork length ≥1400, capacity 1.0T.		
Note: ● standard ○ option — NA		