

Line graph

EFL253/303/353(S)

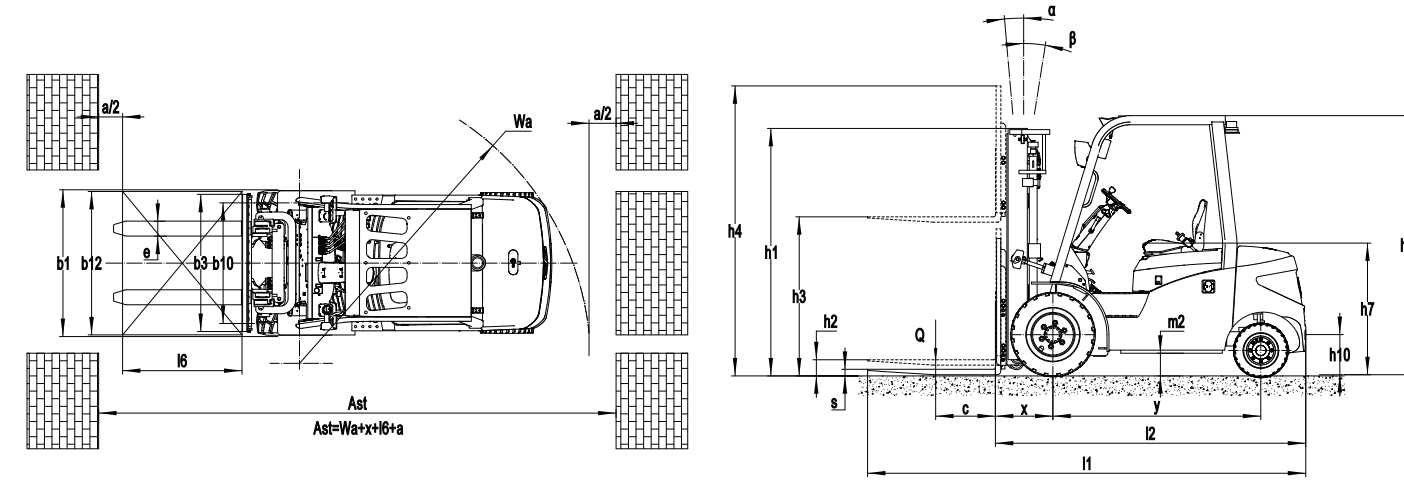

Option

EFL253/303/353(S)

No.	Optional items	EFL253	EFL253(S)	EFL303	EFL303(S)	EFL353	EFL353(S)
1.1	Fork dimension	O 122*40*920 ● 122*40*1070 O 122*40*1150 O 122*45*1070 O 122*45*1150 O 122*45*1220 O 122*45*1370 O 122*45*1520 O 122*45*1600 O 122*50*1070 O 122*50*1150 O 122*50*1220 O 122*40*1220 O 122*40*1370 O 122*40*1500 O 122*40*1600 O 122*40*1700 O 122*40*1820 O 122*45*1700 O 122*45*1820 O 122*45*2000 O 122*50*1700 O 122*50*1820 O 122*50*2000 O 122*40*1900 O 122*40*2000 O 122*40*2200 O 122*45*2200 O 122*45*2400 O 122*50*2200 O 122*50*2420					
1.4	Fork carriage width	● 1040mm O Yes and can be customized		● 1100mm O Yes and can be customized			
1.5	Fork carriage height	● 1025mm O Yes and can be customized		● 1095mm O Yes and can be customized			
2.5	Front wheel material	O Pneumatic O Solid O Non-marking					
2.6	Rear wheel material	O Pneumatic O Solid O Non-marking					
2.7	Battery capacity	O 80V205AH O 80V280AH O 80V410AH	O 80V230AH O 80V280AH O 80V410AH	O 80V205AH O 80V280AH O 80V410AH	O 80V230AH O 80V460AH	O 80V280AH O 80V410AH	O 80V280AH O 80V460AH
2.8	Charger	O 80V35A O 80V65A O 80V130A O 80V200A (only for 410Ah battery) O 80V35A (internal) O 80V60A (internal)	O 80V35A O 80V65A O 80V130A O 80V200A (only for 460Ah battery)	O 80V35A O 80V65A O 80V130A O 80V200A (only for 410Ah battery)	O 80V65A O 80V35A O 80V130A O 80V200A (only for 460Ah battery)	O 80V35A O 80V65A O 80V130A O 80V200A (only for 410Ah battery)	O 80V65A O 80V35A O 80V130A O 80V200A (only for 460Ah battery)
2.9	Battery indicator	● With time					
2.10	Seat type	O Regular O Premium O Suspension O Suspension + seatbelt logic switch					
2.11	Attachments	● No O Built-in sideshifter O External shifter O Fork positioner					
2.13	Traction pin	● Yes					
3.5	Front lamp	● LED					
3.6	Rear lamp	● No O LED					
3.7	Warning lamp	● Yes					
3.8	Steering lamp	● Yes					
3.9	Blue lamp	● No O 2 front O 1 rear O 2 front + 1 rear					
3.10	Area warning lamp	● No O 1 left + 1 right (red)					
3.11	Rearview mirror	● 1 in the middle O Add 1 on both sides					
3.12	Buzzer	● Yes					
3.17	OPS system	● Yes					
3.23	Telematics	● Yes and not customized					
4.3	Cabin	● No O Basic semi-enclosed cabin O Upgrade semi-enclosed cabin O Full cabin					
4.9	Heater	● No O Yes and not customized					

Note: ● Standard O Optional - Inconformity



# New EFL Series

Both advantages of lithium and diesel in one truck



**EFL253/303/353(S)**  
Stronger Faster Easier

Parameters

EFL253/303/353(S)

Distinguishing mark	EP EP EP EP EP EP EP						
	EFL253	EFL303	EFL353	EFL253S	EFL303S	EFL353S	
1.1	Manufacturer	EP	EP	EP	EP	EP	EP
1.2	Model designation	EFL253	EFL303	EFL353	EFL253S	EFL303S	EFL353S
1.3	Drive	Electric	Electric	Electric	Electric	Electric	Electric
1.4	Operator type	Seated	Seated	Seated	Seated	Seated	Seated
1.5	Load capacity	Q kg 2500	3000	3500	2500	3000	3500
1.6	Load center distance	c mm 500	500	500	500	500	500
1.8	Load distance, centre of drive axle to fork	x mm 495	481	486	495	481	486
1.9	Wheelbase	y mm 1740	1740	1740	1740	1740	1740
2.1	Service weight	kg 3940	4280	4600	3890	4305	1625
2.2	Axle loading, laden front/rear	kg 5810/630	6595/685	7395/725	5795/660	6575/730	7355/770
2.3	Axle loading, unladen front/rear	kg 1880/2060	1900/2380	1890/2710	1865/2090	1880/2425	1870/2755
3.1	Tyre type	Solid rubber	Solid rubber	Solid rubber	Solid rubber	Solid rubber	Solid rubber
3.2	Tyre size, front	7.00-12	28x9-14	28x9-14	7.00-12	28x9-14	28x9-14
3.3	Tyre size, rear	18X7-8	18X7-8	18X7-8	18X7-8	200/50-10	200/50-10
3.5	Wheels, number front/rear (x=drive wheels)	mm 2X-2	2X-2	2X-2	2X-2	2X-2	2X-2
3.6	Tread width, front	b10 mm 975	1010	1010	975	1010	1010
3.7	Tread width, rear	b11 mm 955	955	955	955	955	955
4.1	Tilt of mast/fork carriage forward/backward	α/β ° 6/10	6/10	6/10	6/10	6/10	6/10
4.2	Retracted mast height	h1 mm 2090	2070	2070	2090	2070	2070
4.3	Free lift	h2 mm 120	135	135	120	135	135
4.4	Lift height	h3 mm 3000	3000	3000	3000	3000	3000
4.5	Height, mast extended	h4 mm 4025	4095	4095	4025	4095	4095
4.7	Height of overhead guard (cabin)	h6 mm 2165	2180	2180	2165	2180	2180
4.8	Seat height/standing height	h7 mm 1095	1110	1110	1095	1110	1110
4.12	Tow coupling height	h10 mm 330	345	345	330	345	345
4.19	Overall length	l1 mm 3600	3610	3688	3600	3610	3688
4.20	Length to face of forks	l2 mm 2530	2540	2618	2530	2540	2618
4.21	Overall width	b1/b2 mm 1054	1210	1210	1054	1210	1210
4.22	Fork dimensions	s/e/l mm 40X122X1070	45X122X1070	50X122X1070	40X122X1070	45X122X1070	50X122X1070
4.23	A,B Fork carriage class/type A, B	2A	3A	3A	2A	3A	3A
4.24	Fork carriage width	b3 mm 1040	1100	1100	1040	1100	1100
4.31	Ground clearance, laden, below mast	m1 mm 125	130	130	125	130	130
4.32	Ground clearance, center of wheelbase	m2 mm 170	185	185	170	185	185
4.34.1	Aisle width for pallets 1000x1200 crossways	Ast mm 4000	4028	4091	4000	4028	4091
4.34.2	Aisle width for pallets 800x1200 lengthways	Ast mm 4200	4228	4291	4200	4228	4291
4.35	Turning radius	Wa mm 2305	2347	2405	2305	2347	2405
5.1	Travel speed, laden/unladen	km/h 11/12	11/12	11/12	16/17	16/17	16/17
5.2	Lifting speed, laden/unladen	m/s 0.29/0.36	0.29/0.36	0.28/0.36	0.4/0.5	0.4/0.5	0.4/0.5
5.3	Lowering speed, laden/unladen	m/s 0.4/0.43	0.4/0.43	0.4/0.43	0.4/0.43	0.4/0.43	0.4/0.43
5.5	Drawbar pull, laden/unladen	N —	—	—	—	—	—
5.6	Max. drawbar pull, laden/unladen	N —	—	—	—	—	—
5.8	Max. gradeability, laden/unladen	% 15/15	15/15	15/15	20/25	20/25	18/25
5.10	Service brake	Hydraulic	Hydraulic	Hydraulic	Hydraulic	Hydraulic	Hydraulic
5.11	Parking brake	Mechanical	Mechanical	Mechanical	Mechanical	Mechanical	Mechanical
6.1	Drive motor rating S2 60 min	kW 10	10	10	16	16	16
6.2	Lift motor rating at S3 15%	kW 16	16	16	24	24	24
6.4	Battery voltage/nominal capacity	V/Ah 80V205AH	80V205AH	80V280AH	80V230AH	80V230AH	80V280AH
6.5	Battery weight	kg —	—	—	—	—	—
8.1	Type of drive control	AC	AC	AC	AC	AC	AC
10.5	Steering design	Hydraulic	Hydraulic	Hydraulic	Hydraulic	Hydraulic	Hydraulic
10.7	Sound pressure level at the driver's ear	dB(A) <74	<74	<74	<74	<74	<74

EP EP EQUIPMENT CO., LTD www.ep-ep.com

Tel: 86-571-28035656/28878695 Fax: 86-571-28035665 Email: info@ep-ep.com

NO.121 Yonghua Street, Shi Qiao Road, Xia Cheng Qu, Hangzhou, China

### High performance

1. Max travel speed (laden) 17km/h (option) to cover diverse intralogistics application needs
2. Max battery capacity 80V/460Ah and max charging current 200A for longer uptime and fast charging
3. Max gradeability (laden/ unladen) 20/25% to deliver better stability on ramps
4. Max lifting speed 0.5m/s for greater efficiency



### Lithium technology to replace internal combustion engine

The lithium technology has proven itself as an emission-free and maintenance-free alternative to diesel. The new generation of EFL series handles loads with consistently high performance due to opportunity charging even for the most demanding applications.

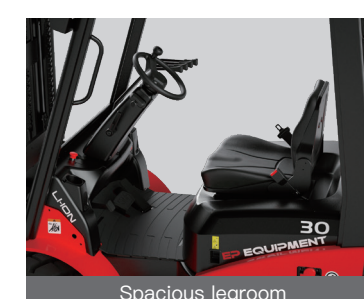

### Multi-functions for safe operation and easy fleet management

The new EFL series is equipped with a variety of functional configurations, such as OPS system, Telematics and card/ fingerprint system, which not only takes security as priority but also reinforce easier fleet management.



### The truck structure integrates aesthetics and practical design

Both practicality and beauty are reflected in the design of the second EFL series. It inherits the robust chassis of the T8 IC truck series and features a more streamlined and compact counterweight, to better fit in confined space. Plus, the rain-proofed charging port protects the port from water splash and ensures charging safety.



### Ergonomic improvements for comfortable operation

The workspace of the new EFL series is more spacious with a simplified panel and a comfortable pedal. The series features a new LCD display that clearly shows speed, working hours, battery status, mileage and parking status so the operator can easily grasp the truck conditions just with a glance.

### Optimized overhead guard for usage of a full cabin

The brand new overhead guard is bolted, instead of welded, to the truck frame and this is more suitable for usage of a full cabin to cope with all weathers. For flexible strategy, it is easy to install or detach a cabin across different trucks.



Full Cabin (option)

