

**BECCA FEEKEN GARDEN SHUTTERS
5x7" CARD BASE ASSEMBLY**

Supplies

- DIES: Butterfly Bliss Garden Shutters 5x7" Card Base S6-183 • CARDSTOCK: Color Essentials Cardstock, 100lb Heavyweight
- ADHESIVES: Best Ever Craft Tape SCS-123, Extra strength double sided tape • FINISHED SIZE: 5" X 7"



1. Die cut chosen cardstock to 5x7", three times.

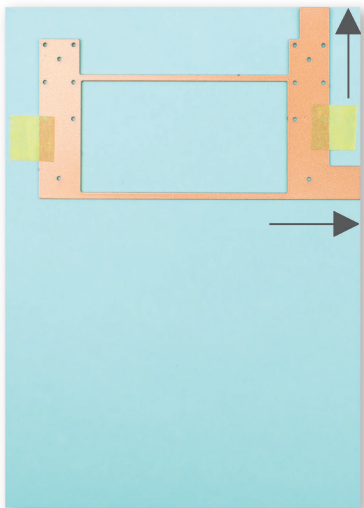

2. On first piece of cardstock, align the kinetic layer die to the corners using the 2 guides. Die cut.

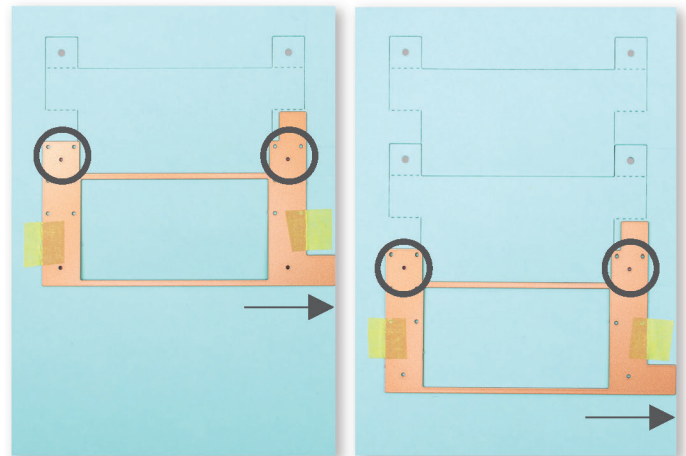

3. Realign the kinetic layer die again, using the circles on the dies (circled) as a guide to align with the holes cut out the first time. Repeat a third time so there are 3 sets of die cuts on the 5x7" cardstock.

**BECCA FEEKEN GARDEN SHUTTERS
5x7" CARD BASE ASSEMBLY**

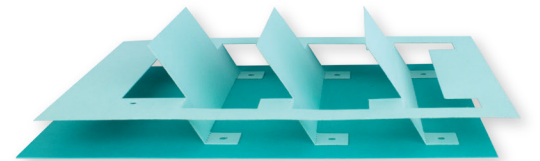
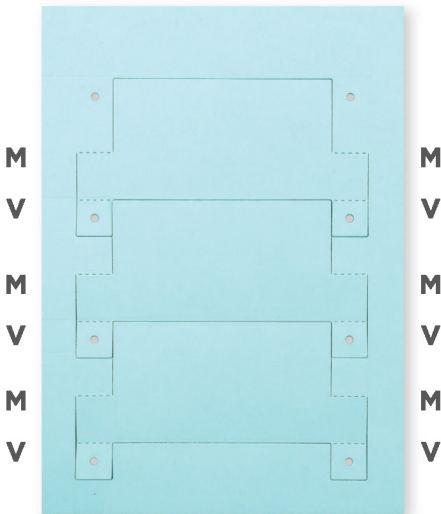

4. Fold the die cut kinetic layer as noted. It will create what looks like "feet". Flatten out and add glue or adhesive to the bottom of the "feet" (shown in yellow) and adhere to the 5x7" base that you already cut out. Let dry. The top of the card will be with flaps facing up (but it can also be created with the flaps facing down).

V = Valley Fold (V) M = Mountain Fold (Λ)

5. Create a frame for the top of the card with the third piece of 5x7" cardstock by centering window die cut using notch guides inside of the die. Add glue or adhesive to the top of kinetic layer only where noted in yellow and attach frame to top. Add pull tab to the back of the bottom frame piece (or if having the flaps facing down, tab goes to the top of the card). Note that the S6-184 Frame was made to also work as a frame on this card.

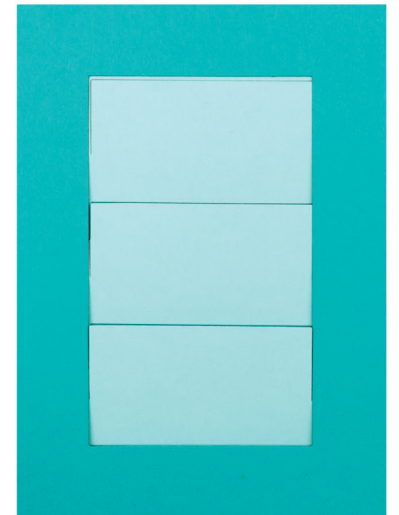
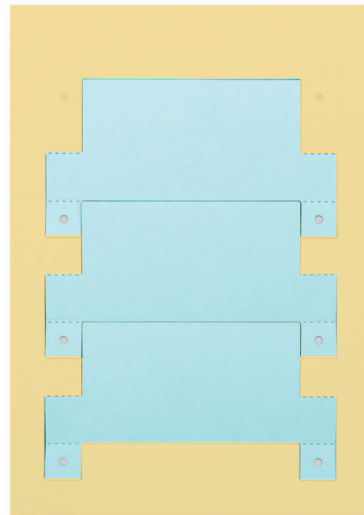

6. Decorate the frame and kinetic layer flaps (on both sides), but make sure that the decorative pieces do not go beyond the sides and bottom of the flap pieces or the card will not open and close properly.