

# **DROYD**

## **ZYPSTER OWNER'S MANUAL**



SKU number: XZ03

Read instructions before using your new DROYD Zypster electric ride-on toy.

# TABLE OF CONTENTS

Table of contents .....	2
Important battery and charging instructions .....	3
Important warnings and safety instructions .....	6
Getting to know your Zypster .....	9
Packaging contents .....	10
Assembly .....	11
How to adjust the steering column angle .....	17
How to adjust the steering wheel height .....	18
Parental control and safety mechanisms .....	19
Riding and accelerator pedal control instructions .....	20
Stopping and braking instructions .....	22
Reading the battery level indicator .....	23
Maintenance .....	24
Technical specifications .....	25
Warranty .....	27
Customer support .....	28
Recycling .....	28

Note that all images and diagrams in the manual are for illustrative purposes only. They may not reflect the actual appearance of the product.

The appearance and specifications of the product are subject to change without notice.

Ensure that ALL WARNINGS AND INSTRUCTIONS on the packaging box, in the owner's manual, and on the product itself are fully read and understood prior to first use of the product.

Have an issue? Please don't return this product. Our friendly customer support staff can help. Call toll-free +1-800-333-3729, or email [support@go-droyd.com](mailto:support@go-droyd.com).

# IMPORTANT BATTERY AND CHARGING INSTRUCTIONS



## **Warnings for lithium-ion battery pack and charger:**

- 1) If there is evidence of **DAMAGE, BREAKAGE, OR LEAKAGE** on either the battery pack or charger, **DO NOT USE OR ATTEMPT TO FIX** and contact customer support immediately.
- 2) **TO AVOID FIRE OR EXPLOSION, DO NOT PLACE OR LEAVE** battery pack or charger near any heat or water sources (such as generators, gas / electric heaters, water boilers, large appliances, lit cigarettes), or anything labeled flammable, explosive, caustic, or volatile (such as gasoline, kerosene, propane).
- 3) **TO AVOID ELECTRIC SHOCK OR POISONING, DO NOT ATTEMPT TO OPEN** the battery pack. Doing so will also void the manufacturer's warranty.
- 4) **TO AVOID ELECTRIC SHOCK OR FIRE, DO NOT TOUCH** the battery pack or charger with wet hands or uninsulated metal.
- 5) **TO AVOID ELECTRIC SHOCK, DO NOT SUBMERGE**, soak, or wash the battery pack or charger. **THESE ACTIONS MAY CAUSE SHORT CIRCUITING OR PERMANENT DAMAGE.**

# IMPORTANT BATTERY AND CHARGING INSTRUCTIONS (Cont.)

## Charging instructions:

The unit includes a smart charger.

1) To charge the product:

- Connect the charging cable to the charger.
- Locate the charging port on the rear of the Zypster.
- Remove the charging port cover. Connect the charger to the charging port.



- Then plug the charger into an appropriate and functional electrical outlet.
  - To prevent fire risk and suboptimal charging, DO NOT plug the charger into an extension cord or any other indirect power sources.
- 2) Charge the battery to 100% prior to first use of the product.
- Please leave it charging for about 6 hours (even when the charger light turns solid green prior), to ensure optimal battery performance going forward.
  - All future charging cycles will only take up to 5 hours each, until the battery has reached end of life.
- 3) Charge the battery immediately after each use of the product.
- 4) How to determine charging progress:
- Each full battery charging cycle (from 0% to 100%) will take approximately 5 hours.
  - While the battery is charging, the charger light will be solid red.
  - When the battery is fully charged (100%), the charger light will turn solid green, and the charger will automatically stop charging.
- 5) Whenever the battery is NOT being charged:
- Ensure the charger is fully unplugged from the electrical outlet.
  - Ensure the charger is fully disconnected from the charging port. (Put charging port cover back on.)
  - Ensure the charger is safely placed out of reach from children and pets.
- 6) To prevent battery degradation:
- Charge the battery to at least 30% before storing away the product.
  - Charge every 30 days if product is not being regularly used.

# IMPORTANT BATTERY AND CHARGING INSTRUCTIONS (Cont.)

## Charging safety warnings:

- 1) Always charge the product in a SAFE, DRY, AND ENCLOSED location.
- 2) DO NOT STORE OR CHARGE the product in any place that is exposed to the outdoors or potentially adverse environmental elements.
- 3) DO NOT STORE OR CHARGE the product in an environment that is below 32°F/0°C or above 113°F/45°C.
- 4) To keep the battery pack in optimal condition, DO NOT LEAVE IT CHARGING for over 6 hours per charging cycle.
- 5) Prior to charging, ensure that the product is NOT placed on an elevated or uneven surface.
- 6) DO NOT STRETCH the charging cord between the battery and the electrical outlet in such a way that it creates a tripping hazard.
- 7) Before performing any maintenance on the product, ensure charger is fully unplugged from the electrical outlet and fully disconnected from the charging port.
- 8) Charge ONLY with the provided battery pack and charger.
  - Using a battery pack or charger other than those provided by Droyd voids the manufacturer's warranty.
  - The provided battery pack and charger are intended for use ONLY with the Droyd Zypster.
  - See Technical Specifications page in this manual for more charger details.

# IMPORTANT WARNINGS AND SAFETY INSTRUCTIONS

PARENTAL/ADULT SUPERVISOR MUST READ AND COMPREHEND ALL WARNINGS AND INSTRUCTIONS AS LABELED ON THE PRODUCT PACKAGING BOX, ON THE PRODUCT ITSELF, AND IN THE OWNER'S MANUAL.

IMPORTANT: FAILURE TO FOLLOW ALL WARNINGS AND INSTRUCTIONS WILL VOID YOUR WARRANTY. PLEASE FULLY READ AND COMPREHEND BEFORE FIRST USING THIS PRODUCT.

WHEN THE ELECTRIC RIDE-ON PRODUCT IS IN USE, ADHERE TO THE FOLLOWING REQUIREMENTS AT ALL TIMES:

- **The minimum required age for use of this product is 3 YEARS OLD**, or of equivalent physical and mental competency.
- In the event that local / county / state / provincial / federal laws and regulations specify a different minimum age and/or specify a maximum age, those laws and regulations supersede the instructions in this manual.
- **Parental or adult supervision is necessary** for any rider below the age of an adult (as defined by law).
- Check the presence, condition, and functionality of ALL PARTS before each use, including: body, frame, steering wheel, steering column, accelerator pedal, wheels, cable connections, and all other electric parts. If you have any doubts about the condition or functionality of a part, DO NOT USE the product and call customer support immediately.
- Rider and parental/adult supervisor must exercise caution and situational awareness.
- Rider must always wear a helmet & other protective safety gear such as goggles, elbowpads, kneepads, and secure footwear. Ensure that there are no loose articles of clothing, such as a scarf or loose shoelaces. (Safety gear is NOT included with this product.)
- **Maximum weight capacity is 120 LBS (54 KG)**, which includes the rider, all safety gear worn by the rider, and any accessories that the rider may be carrying. Attempts to exceed this limitation may result in bodily injury and/or permanent damage to the product.
- **Ensure only ONE rider at a time.** Do not ever allow multiple riders at the same time.
- As electric ride-on products may operate more quietly than other motorized products, the rider must exercise SAFE CONDUCT while the product is in use and emit audible warnings (e.g. a hand bell – not included) when appropriate in the vicinity of others who may have difficulty hearing the rider's approach.
- Keep hands, face, feet, hair, limbs, clothing, and jewelry AWAY from all moving parts while product is in use (or immediately after riding), including motor and wheels.
- It is strongly recommended that while the product is in use, both the rider and adult supervisor use additional lighting, reflectors, and/or any other method to increase conspicuous visibility to others. (Not included with this product.)

# IMPORTANT WARNINGS AND SAFETY INSTRUCTIONS (Cont.)

- Persons with the following conditions are cautioned not to operate this product: persons with heart conditions; pregnant persons; persons with head, back, or neck ailments, or prior surgeries to those areas of the body; and persons with any mental or physical conditions that may make them susceptible to injury or impair their physical dexterity or mental capabilities to recognize, understand, and perform all of the safety instructions and to be able to assume the hazards inherent in product use.
- This product does NOT conform to Federal Motor Vehicle Standards and is NOT INTENDED for operation on public streets, roads, or highways.
- Check and obey all local / county / state / provincial / federal laws and regulations regarding electric ride-on product usage, permitted location of usage, safety requirements, age requirements, and any other pertinent information.
- This product is for RECREATIONAL purposes ONLY. It is NOT INTENDED to carry or haul any loads, be used for stunts or tricks, or be used in any other capacity other than described in this manual.
- DO NOT OPERATE this product in traffic; on or near steps or stairs; on surfaces that are uneven, elevated, have sharp bumps, and/or include steep ascents and descents; on wet, frozen, icy, oily, muddy, or unpaved surfaces; on any surfaces with sudden surface changes; on damaged surfaces such as those with potholes or cracks; on or near drainage grates; or near areas that are undergoing maintenance such as power lines, fuse boxes, or road construction.
- DO NOT OPERATE this product during adverse or extreme weather conditions, including rain, hail, snow, thunder, and lightning.
- AVOID streets and surfaces with water, sand, gravel, dirt, leaves, and other debris. Wet weather impairs traction, braking, and visibility.
- DO NOT OPERATE this product at times or in areas of low to no visibility, including fog, mist, areas with obstructions or blind spots, and dusk / nighttime.
- DO NOT OPERATE this product while under the influence of medication, drugs, alcohol, or any other substance that impairs physical or mental competency in any way.
- DO NOT OPERATE this product while using headphones, mobile phones, or any other device that prevents total focus and total control of all physical and mental faculties.
- TO AVOID ELECTRIC SHOCK, DO NOT submerge, soak, or wash any part of the product. THESE ACTIONS MAY CAUSE SHORT CIRCUITING OR PERMANENT DAMAGE.

# IMPORTANT WARNINGS AND SAFETY INSTRUCTIONS (Cont.)

- When not in use, the product must be POWERED OFF to prevent unintentional starts.
- If transporting the product by plane, first check with the airline and federal aviation laws on proper transport regulations regarding an electric ride-on product that includes a lithium-ion battery pack.
- If transporting the product by ground vehicle, first ensure that it is POWERED OFF, fully disconnected from the charger, and safely stowed and properly secured. (NEVER hitch or attempt to hitch the product to a vehicle.)
- This product should ALWAYS be operated, maintained, and kept in serviceable condition on a regular basis in accordance with the warnings and instructions in this manual.
- Any attempts at modification or other forms of tampering with the original specifications of the product are NOT permitted and will automatically VOID the warranty.

As an electric ride-on product, the Zypster can and is intended to move. Even when using safety gear and taking all necessary precautions, the rider and adult(s) responsible for supervision may still encounter dangerous situations in which serious injury or death may occur.

Droyd is not responsible for any injuries, damage, or legal disputes that may result from improper usage, the rider's and/or supervisor's inexperience, extenuating circumstances, and/or failure to follow all warnings and instructions provided in this manual.



## Getting to know your Zypster

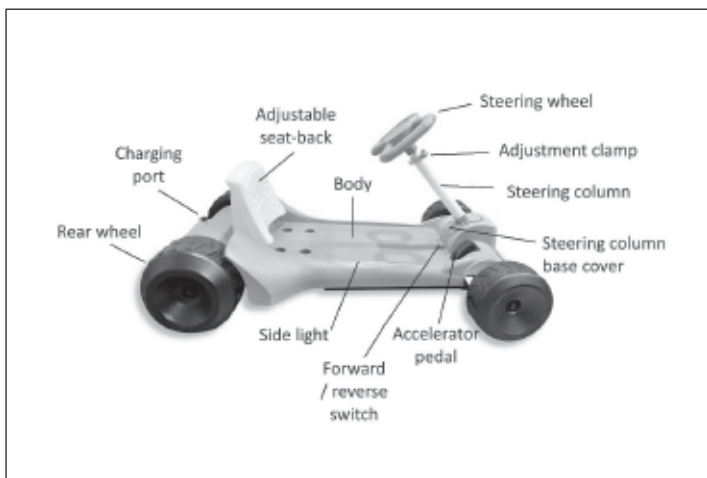
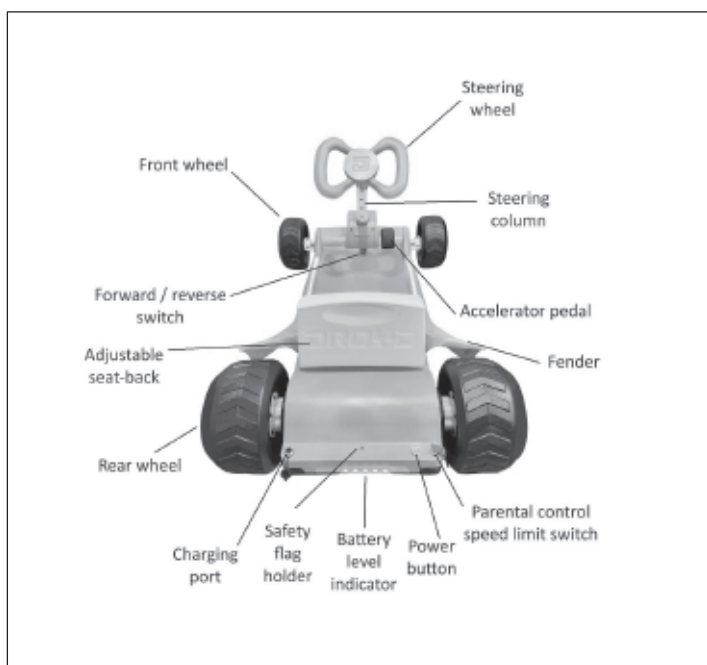

# Packaging contents

The Zypster comes with the following items in the packaging box.

Please identify and locate all of the following prior to assembly:

- 1) Zypster electric ride-on toy:
  - a) Body (with pre-installed wheels, motors, battery pack, accelerator pedal, and steering column)
  - b) Steering wheel (with rivet (x 1) and screw (x 1))
  - c) Steering column base cover (with pre-installed screws (x 2))
  - d) Adjustable seat-back
  - e) Set of identical speed limit keys (x 2)
  - f) Safety flag with pole
- 2) Battery charger & charging cable
- 3) Owner's manual

# Assembly

## **IMPORTANT SAFETY WARNINGS**

- Assembly must be conducted by an adult.
- Ensure power remains OFF at all times during assembly.
- Ensure that assembly is conducted in a space where neither children nor pets have access, as assembly contains small and/or sharp parts that may present choking or otherwise dangerous hazards.
- Do NOT leave the product partially assembled and unsupervised, as assembly contains small and/or sharp parts that may present choking or otherwise dangerous hazards to children and pets.
- Do NOT attempt to charge the product until it is fully assembled.
- If any parts are damaged or missing, DO NOT proceed with assembly, and contact customer service for assistance.
- The front wheels and rear wheels are NOT interchangeable.

# Assembly (Cont.)

## 1) Step one: Installing the steering wheel

a) First, locate the following parts:

- Steering wheel (x 1)
- Steering wheel rivet (x 1)
- Steering wheel screw (x 1)

b) Next, insert the bottom of the steering wheel onto the top of the steering column. Ensure the holes are aligned.

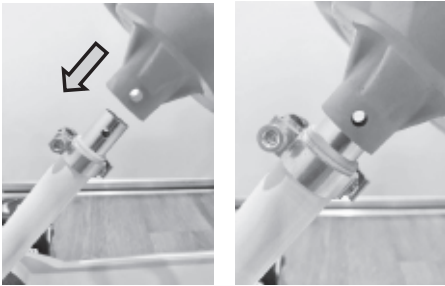

c) Next, insert the rivet all the way through the aligned holes. Then insert the screw into the rivet with a Philips screwdriver (not included), and turn clockwise until it is fully tightened. Gently pull on the steering wheel to ensure there is no looseness.



## Assembly (Cont.)

### 2) Step two: Installing the steering column base cover

a) First, locate the following parts:

- Steering column base cover (x 1)
- Steering column base cover screws (x 2)

b) Next, insert the base cover onto the base of the steering column. Ensure the tabs on the bottom of the base cover are fully inserted, and the screw holes are aligned.



c) Next, insert each base cover screw into each screw hole with a Philips screwdriver (not included). Turn clockwise until each screw is fully tightened. Gently pull on the base cover to ensure there is no looseness.

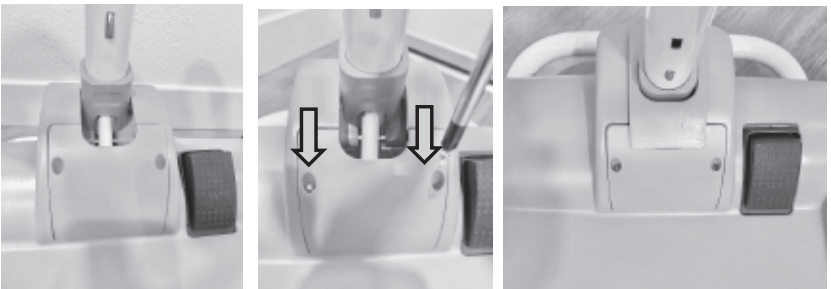

## Assembly (Cont.)

### 3) Step three: Installing the seat-back

a) First, locate the following parts:

- Seat-back (x 1)
- Body (x 1)



b) Next:

- Orient the seat-back so that the curved side is facing the front. (See diagram above.)
  - There are 3 options for the seat-back position, which are designated by the 3 pairs of seat-back installation holes on the rear of the body.
    - o Each position is 2 inches (5 cm) apart.
  - Determine which position will best suit the child who will be riding the product.
  - Align the pegs on the bottom of the seat-back to the desired position's installation holes.
  - Install the seat-back by firmly pressing downward, until the pegs are securely inserted into the holes.
- c) Grasp the seat-back and shake it to ensure it is securely installed. There should be no looseness.
- d) If you wish to change the position of the seat-back, grasp the handle on the back of the seat-back.
- Press onto the body with your other hand for leverage, wiggle the seat-back back and forth several times to loosen it, and pull the seat-back upwards until it is fully detached from the body.
    - o **WARNING:** Do NOT use your foot to press onto the body, as it may cause damage and/or injury.
  - Repeat steps b) and c) for the desired position.

## Assembly (Cont.)

### 4) Step four: Installing the safety flag

- a) First, locate the following parts:
  - Safety flag (x 1)
  - Safety flag pole (in 4 connectable sections: top, middle (x 2), and bottom)
  - Body (x 1)
- b) Next, locate the top section of the pole (marked by the ball on top), and slide the flag onto it.
- c) Next, continue assembling the pole by inserting one of the middle sections into the top section.

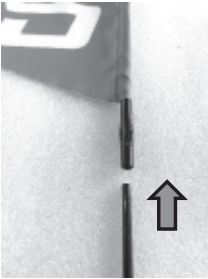

- d) Repeat with the next middle section. (This step can be skipped, if a shorter safety flag is preferred.)
- e) Next, locate the bottom section of the pole (marked by the narrow bottom end).
- f) Next, insert the bottom section of the pole into the safety flag holder (on the rear end of the body) until it is fully inserted into the bottom of the body.



- g) Gently pull upwards on the bottom section of the pole. There should be no looseness.
- h) Finish installation by connecting the rest of the pole.

# Assembly (Cont.)

## Step four: Installing the safety flag (Cont.)

### IMPORTANT SAFETY WARNINGS:

- Do NOT leave safety flag pole partially assembled and unattended, as it may create a safety hazard.
- If removing safety flag pole from the product body, firmly pull the bottom section of the pole upwards and remove the ENTIRE pole. Leaving the bottom section of the pole installed may create a safety hazard.
- Do NOT apply pressure onto the safety flag pole, as it may cause breakage, damage, and/or serious injury.
- If safety flag pole breaks at any time, be sure to remove ALL sections of the pole from the product body to prevent potential safety hazards.



# How to adjust the steering column angle

## 1) How to adjust the steering column angle:

- a. First, locate the adjustment mechanism at the base of the steering column.
- b. Next, with your thumb and index finger, pinch the adjustment mechanism where the grooves are located, and pull upwards to release the steering column lock.
- c. Next, while still pulling the adjustment mechanism upwards, shift the steering column angle to the desired position.
  - o There are total 3 steering column angle positions:
    - Position 1: Uppermost position
    - Position 2: Middle position
    - Position 3: Flat position.
      - o Only use this position when the steering column needs to be folded all the way down, and product is intended to be stored away.
      - o Steering wheel and steering column base cover must be uninstalled prior to folding the steering column down into this position.
- d. After selecting the desired position, release the adjustment mechanism and ensure the steering column is locked in position. (There should be a click sound when the steering column is locked in position.)



# How to adjust the steering wheel height

1) How to adjust the steering wheel height:

- a. First, locate the adjustment clamp on the steering column.
- b. Next, open the clamp (to allow the steering wheel height to be adjusted).
- c. Next, locate the inner rod lock (where it's protruding from the steering column), and use your thumb to fully press it in. (See diagrams below.)

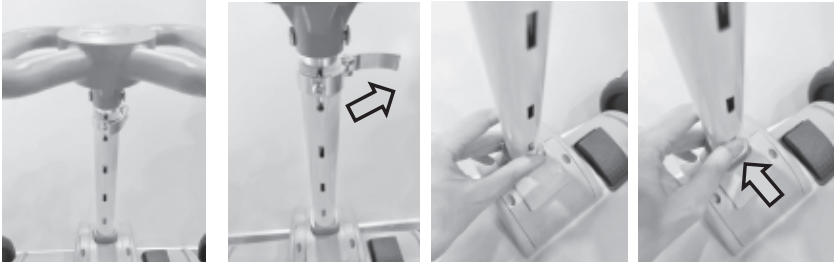

- e. Next, while still pushing in the inner rod lock, use your other hand to hold the base of the steering wheel. Push the steering wheel upwards until the inner rod lock has locked into the desired position.
  - o There are total 3 steering wheel height positions:
    - Position 1: Shortest position
    - Position 2: Middle position
    - Position 3: Tallest position
- f. Ensure the inner rod is locked in position – the lock should be protruding from the steering column.
- d. Lastly, fully close the clamp to secure the steering wheel in position. Gently pull on the steering wheel – there should be no looseness.



# Parental control and safety mechanisms

## 1) Parental control speed limit key:

The speed limit key should be in the parent or adult supervisor's possession at all times. The speed limit key is used to set the maximum speed limit desired by the parent or adult supervisor.

There are two maximum speed limit settings included in the Zypster:

High speed limit: 6 mph (9.7 km/h)

Low speed limit: 3 mph (4.8 km/h)

To set the desired maximum speed limit, the parent or adult supervisor must:

- First ensure the product is powered off.
- Locate the speed limit key.
- Insert the speed limit key into the speed limit switch (located on the control panel).
- Turn the speed limit key to desired maximum speed limit setting:
  - Turn the key to "Hi" and remove the key to set the maximum speed limit to 6 mph.
  - Turn the key to "Lo" and remove the key to set the maximum speed limit to 3 mph.

After the desired maximum speed limit has been set, and the product is powered on, the rider will not be able to exceed that speed limit while the product is in use.

To prevent any rider from being able to adjust the speed limit, the parent or adult supervisor must ensure the speed limit key is REMOVED from the speed limit switch before the product is used.

Note that the HIGH maximum speed limit is the built-in maximum speed limit. The product is not able to exceed this speed limit. DO NOT attempt to modify or tamper with the product in any way to try and override this speed limit. Doing so will automatically void the manufacturer's warranty.

## 2) Slow-start safety mechanism:

When the product is powered on and the pedal is engaged, the slow-start mechanism will automatically begin:

- The product will proceed to move forward at the slowest possible speed for approximately 3 to 5 seconds.
- While the slow-start mechanism is active, the motor and accelerator pedal are both locked to the slowest possible speed.
- After 3 to 5 seconds, the slow-start mechanism will be automatically turned off, thus enabling the rider to begin using the accelerator pedal to gradually increase speed (up to the desired maximum speed limit set by the parent or adult supervisor).

The slow-start mechanism is a safety feature implemented to minimize the risk of sudden onset of speed or accidental lurches / launches / falls.

There is no way to bypass or remove the slow-start mechanism. DO NOT attempt to modify or tamper with the product in any way to try and override this safety feature. Doing so will automatically void the manufacturer's warranty.

# Riding and accelerator pedal control instructions

## **Pre-ride checklist:**

Before each use of the product, the rider and any parent or adult supervisor must follow the pre-ride checklist below.

- 1) Check the presence, condition, and functionality of ALL PARTS before use, including: body, frame, steering column, steering wheel, accelerator pedal, wheels, cable connections, and other electric parts.
- 2) Make sure that all of the exposed nuts, screws and bolts are tightened.
- 3) Check to make sure the battery is sufficiently charged.
- 4) Ensure that there are no obstacles or obstructions ahead in the intended riding path.
- 5) Ensure that there is only ONE rider at a time, who is wearing sufficient safety gear, does not exceed the maximum weight limit (including any gear/accessories worn), and is using the product in the presence of parental or adult supervision (if rider is below the age of an adult as defined by law).
- 6) Ensure that the seat-back is adjusted to a comfortable and appropriate position for the rider.
- 7) Ensure that the parent or adult supervisor is in possession of the speed limit key at all times, and has used it to set the desired maximum speed limit prior to each use of the product.

# Riding and accelerator pedal control instructions (Cont.)

## Riding instructions:

Parental or adult supervision is required AT ALL TIMES when the product is in use and the rider is following the riding instructions below.

- 1) Hold the product steady while rider is being seated.
- 2) Ensure the rider is seated securely, wearing safety gear and secure footwear, and has both feet resting on the footwells, on both sides of the steering column.
- 3) Press the power button once to turn it ON. (Power button will remain in while on. Power button will pop back up when pressed again to turn off the product.)
- 4) Locate the forward/reverse switch, and ensure the switch is in the forward (“F”) position.
- 5) Ensure the intended riding pathway ahead is clear of obstacles, obstructions, uneven surfaces, and other factors that may be hazardous.
- 6) To engage the accelerator, the rider should use their right foot to gently press the accelerator pedal.
- 7) When the accelerator is first engaged, the slow-start safety mechanism will automatically start. Then after 3 to 5 seconds the slow-start safety mechanism will automatically turn off. When the slow-start safety mechanism is automatically turned off, the accelerator can then be fully engaged.
- 8) When the rider presses the accelerator pedal, the speed will increase (up to the maximum desired speed limit set by the parental control speed limit key).
- 9) When the rider releases the accelerator pedal, the speed will decrease until the product comes to a complete stop.
- 10) While powered on with the accelerator engaged, the product will continuously move, until the accelerator pedal is released.
- 11) In the event the rider needs to move the product in reverse, first ensure the product has come to a complete stop. Then check that the intended reverse pathway is clear of obstacles, obstructions, uneven surfaces, and other factors that may be hazardous. Then move the forward/reverse switch to the reverse (“R”) position. (Note that the product only moves in reverse at a constant automatic 3 mph, regardless of which setting the parental control speed limit switch is in.)
- 12) While the product is powered on and in motion, the rider should **KEEP HANDS ON STEERING WHEEL AT ALL TIMES**, and **BOTH FEET IN THE FOOTWELLS AT ALL TIMES** while the product is in use.

It is strongly recommended that the rider and parental / adult supervisor first conduct multiple short practice runs (how to safely ride and stop) in a safe location at the low speed limit, only increasing the speed to the high speed limit when all parties are comfortable doing so.

# Stopping and braking instructions

Parental or adult supervision is required AT ALL TIMES when the product is in use and the rider is following the stopping and braking instructions below.

- 1) To stop the product safely, engage the automatic brake by releasing the accelerator pedal.
- 2) Releasing the accelerator pedal will automatically disengage power to the motor, and the product will roll to a stop.
- 3) Once the product has come to a complete stop at a safe location, and if the rider is disembarking:
  - First POWER OFF the product (by pressing the power button), to prevent unintended motion and prevent the battery from continuously draining. (Note: the product does NOT automatically turn off on its own.)
  - Ensure product is in a stable position.
  - Rider can then gradually lower their feet from the footwells to the ground, and disembark.
- 4) After each use of the product, ensure that battery is charged by following the Charging Instructions page in this manual.

## IMPORTANT SAFETY WARNINGS:

- Note that stopping and braking distance are affected by the speed of the product, conditions of the riding surface, variable environmental elements, and other potential factors.
- DO NOT RIDE ON STEEP ASCENTS OR DESCENTS, as the product is not designed to accelerate or brake on such inclines.

# Reading the battery level indicator

The battery level indicator is located on the rear of the product, beneath the safety flag holder. When the product is powered on, the battery level indicator will automatically turn on.



The battery level indicator has 5 LED lights that indicate the amount of battery life remaining.

- 5 simultaneous green lights indicate the battery level is full (100%).
- 5 simultaneous yellow lights indicate the battery level is getting lower.
- 5 simultaneous red lights indicate the battery level has dropped to 10% and the battery should be charged soon.
- 5 simultaneous red flashing lights indicate the battery level has dropped to 0%, and the battery must be charged.

When the product is powered off, the battery level indicator will automatically turn off.

The battery level indicator does NOT turn on when the battery pack is being charged. Monitor charging status using the charger light indicator (on the charger).

# Maintenance

Maintenance of the product must always be conducted by an adult.

Proper care and maintenance of the product will ensure optimal performance.

Daily maintenance:

- 1) Clean the exterior of the product manually with a soft, damp rag. And while wearing protective gloves, carefully remove any debris that may have been caught in the product, such as leaves, dirt, and/or other small objects.
  - DO NOT WASH WITH A HOSE OR ANY OTHER SPRAYING DEVICE.
  - DO NOT USE any caustic, harsh, or otherwise potentially damaging cleaning solution.
- 2) Check that the body, frame, steering column, steering wheel, accelerator pedal, wheels, seat-back, and all other parts are securely in place.
- 3) Check that all cables, nuts, screws, and bolts are securely tightened.
- 4) Check battery pack cover (on the bottom of body) for any signs of battery damage or exposure. (If any signs of damage or exposure found, DO NOT USE OR CHARGE the product and contact customer support immediately.)



# Technical Specifications

<b>General features</b>	Model name	Zypster
	SKU number	XZ03-TL (Teal) XZ03-PK (Pink)
	Description	Electric ride-on toy
	Minimum required age of rider *	3+ years old
	Maximum weight capacity **	120 lbs (54 kg)
	Parental control enabled?	Yes (speed limit key)
	Number of max speed settings ***	Two (high and low)
	High max speed setting ****	6 mph (9.7 km/h)
	Low max speed setting	3 mph (4.8 km/h)
	Built-in safety mechanism	Automatic slow-start
	Brake type	Automatic (electro-mechanical)
<b>Assembled product</b>	Dimensions (LxWxH)	35.5" L x 21.6" W x 25.2" H (90 x 55 x 64 cm)
<b>Control</b>	Parental control type	Speed limit key
	User control type	Power button
		Forward/reverse switch
		Accelerator pedal
<b>Seat</b>	Seat type	Adjustable seat-back
	Dimensions of seat-back (L x H)	9.8" x 7.1" (25 x 18 cm)
	# of adjustability positions	3
	Increments of adjustability positions	2" (5 cm)
<b>Motor</b>	Motor type	Brushed DC
	Total number of motors	2
	Motor voltage	2 x 12 V
	Motor wattage	2 x 50 W
<b>Battery *****</b>	Battery type	Lithium-ion battery
	Battery voltage	25.2 V
	Battery amp-hours	2 Ah
	Battery watt-hours	50.4 Wh
	Max ride time per full charge	Up to 30 minutes
	Max operating range per full charge	Up to 3 miles (4.8 km)
	Total charging time from 0% to 100%	Up to 5 hours
	LED battery level indicator?	Yes (taillight)

# Technical Specifications (Cont.)

<b>Charger *****</b>	Charger model number	YLT-CD294050US
	Charger input	AC 100-240V~ 50/60Hz 0.5A
	Charger output	DC 29.4V = 0.5A
	Type of charging indicator	Charger light (Solid red light = in progress) (Solid green light = charging completed)
	Charger manufacturer	Shenzhen Yongletong Electronic Technology Co., Ltd

<b>Wheels</b>	Total number of wheels	2 front + 2 rear
	Front wheel size (diameter)	6.5" (16.5 cm)
	Rear wheel (diameter)	8" (20.3 cm)
	Wheel material	Plastic

<b>Certificates of compliance &amp; testing</b>	Toy product safety	ASTM F963 UL2272
	Battery	UN38.3

\* The minimum required age for use of this product is 3 years old, or of equivalent physical and mental competency. However, in the event that local / county / state / provincial / federal laws and regulations specify a different minimum age and/or specify a maximum age, those laws and regulations supersede this manual's instructions.

\*\* Maximum weight capacity includes the rider AND any safety gear or accessories that the rider may be wearing or carrying.

\*\*\* The parental control speed limit key can set and lock in the desired maximum speed setting (high or low). To change the maximum speed setting, the speed limit key must be used to reset the speed limit prior to next use of the product.

\*\*\*\* Note that the HIGH maximum speed limit is the maximum possible built-in speed limit. The product is not able to exceed this speed limit. DO NOT attempt to modify or tamper with the product in any way to try and override this speed limit. Doing so will automatically void your warranty.

\*\*\*\*\* Total battery lifespan, maximum range, and length of ride time will all be affected by frequency of usage, proper charging maintenance, variable usage of the speed settings, and usage over various surfaces.

\*\*\*\*\* Charge ONLY with the provided battery pack and charger, which are specifically provided for the Droyd Zypster (XZ03).

- DO NOT use battery packs or chargers that are: from other brands; for other products/models; aftermarket; and/or provided by unauthorized resellers. (Doing so will void your warranty.)

# Warranty



To activate the warranty, please register your product as soon as possible.

Register via website: [www.go-droyd.com/registration](http://www.go-droyd.com/registration)

Or register by scanning the QR code with your mobile device.

Unless a different warranty period is expressly provided with your Droyd product, Droyd warrants this product for a period of 6 months for the battery pack, motor, and all other electrical components; and limited 1 year for all other parts when the product is delivered to you in new condition, in original packaging, from a Droyd authorized reseller and used in normal conditions and as described in the owner's manual – is free from any defects in manufacturing, materials, and workmanship.

This warranty gives you specific rights and you may also have other rights, which vary from state to state. Droyd provides a limited warranty on all eligible Droyd products purchased in the United States and Canada.

The limited warranty covers failures due to defects in material or workmanship on the product.

Wheels, keys, and other parts subject to normal wear and tear are not covered under the limited warranty.

The limited warranty starts from the original date of purchase and is only applicable to the original purchaser of the product.

Proof of purchase is required to receive any services guaranteed as part of the limited warranty.

The limited warranty does not apply to refurbished products or products that were resold by unauthorized resellers.

The limited warranty does not cover defects found to result from improper or unreasonable use or maintenance of the product, failure to follow warnings and instructions, or unauthorized alterations or modifications to the original product.

The limited warranty does not provide refunds, returns, or exchanges under most conditions.

Product replaced under the limited warranty may be replaced with a brand new or factory refurbished product. If the defective product is discontinued, end of life, or out of stock, Droyd will issue a replacement product of equivalent value or features. Product warranty periods do not renew with replacement products.

Note that in the event of accidents, injuries, property damage, or death while using a Droyd product, insurance coverage is not guaranteed. Check with your insurance provider for more details.

# Customer support

**Have an issue? Please don't return this product.**  
Our friendly customer support staff can help.

If your Droyd product should require service, contact customer support to:

- Obtain information about replacement parts.
- Ask any questions regarding the limited warranty.

Toll free number: +1-800-333-3729

Email: [support@go-droyd.com](mailto:support@go-droyd.com)

Customer support hours: Monday – Friday, 9 A.M. – 5 P.M. U.S. PST

Droyd is designed and based in California.

Visit [www.go-droyd.com](http://www.go-droyd.com) to learn more about our products, upcoming news, and special deals and offers.

## Recycling



This symbol on the product or on its packaging indicates that this product (as a whole or in part) cannot be treated as everyday household waste.

DO NOT dispose of the product OR the battery pack into the trash or municipal recycling bins. Instead, it should be taken to the appropriate collection point for recycling electric products.

For more information about your local electric waste collection program, contact your local certified electronics recyclers, participating retailers and recyclers in electronics takeback services, or the authorized retailer from which you purchased your product.