

## Four door, 11 story shoe cabinet with shoe positions

The installation methods for the 8th and 11th floors are the same

8-layer boot board x2 narrow layer board x3 backboard x7

Small screw door iron sheet x8

Medium screw magnetic suction x8

Large screw mounting board x49

Pin mounted door x8

Door iron sheet x8

7-character wrench x1

Magnetic X4

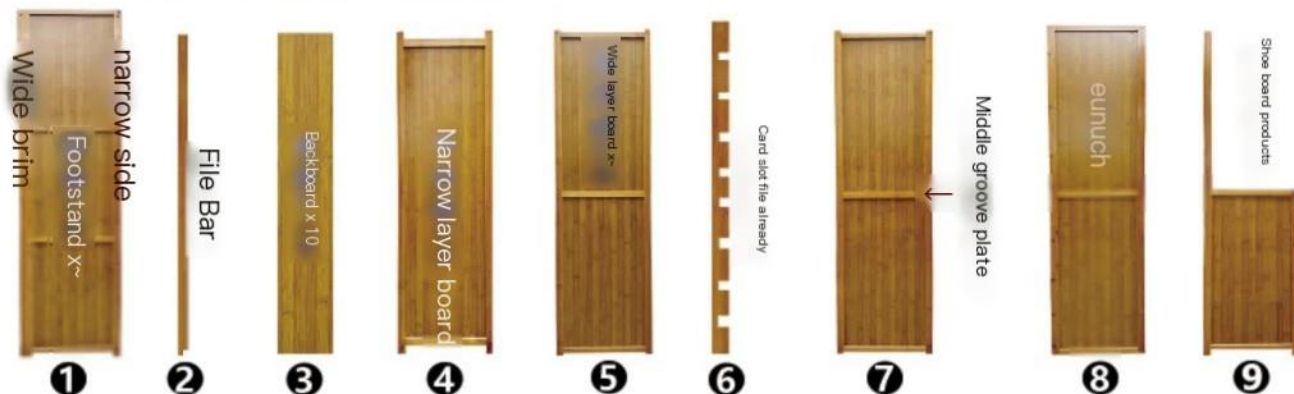

The following is the installation method for flat doors, lower doors, Changhong doors, and plastic rattan doors. The installation method is the same, and it is more convenient for two people to install them on the ground together

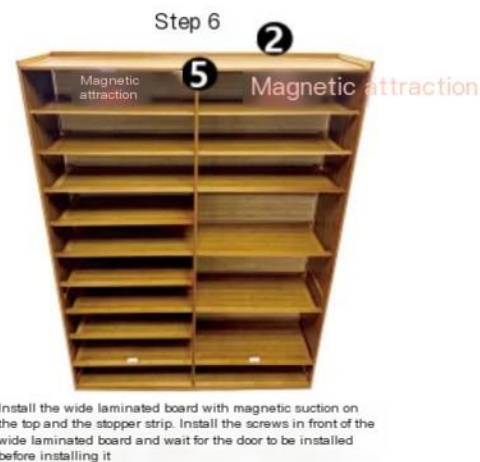
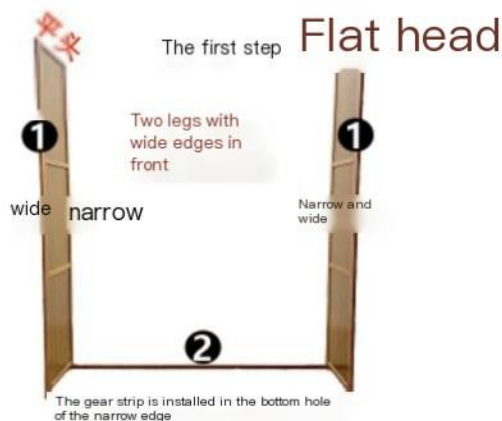

### Step Seven

Install the door to the middle groove plate and the top wide layer plate with a latch, with the handle facing outward in the middle. Finally, install the door iron sheet and complete the installation

Bottom layer open shoe placement

