

FASTLANE COMPONENT DIAGRAM

- HYDRAULIC SUB-HOSES RUN THROUGH CONDUIT BENEATH THE POOL DECK TO THE JUNCTION BOX, IF EQUIPMENT IS LOCATED GREATER THAN 25' FROM THE PROPULSION UNIT.
- SECURE CONDUIT TO JUNCTION BOX PRIOR TO BURYING CONDUIT.
- JUNCTION BOX FOR HYDRAULIC HOSE CONNECTIONS MUST BE ABOVE POOL COPING LEVEL TO AVOID DRAINAGE OF OVERFULL POOL WATER THROUGH THE PVC CONDUIT.
- CONDUIT IS OFTEN BURIED BENEATH THE YARD/GARDEN BETWEEN THE JUNCTION BOX & POWER UNIT.

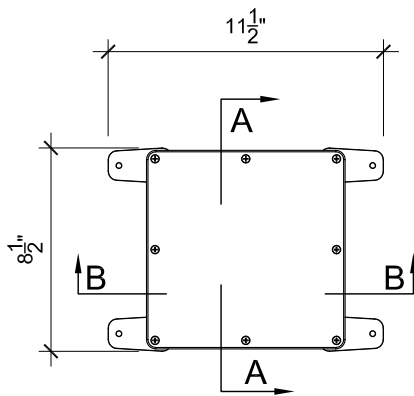

PLAN

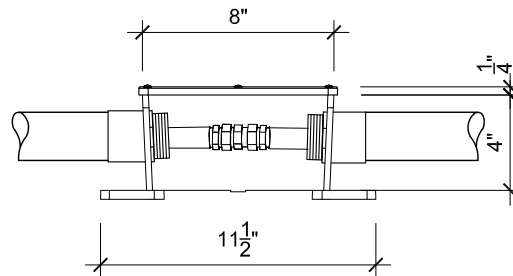

SECTION B-B

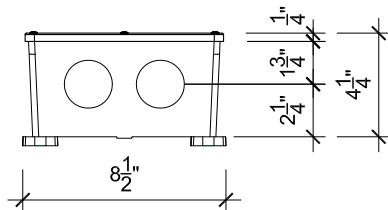

SECTION A-A

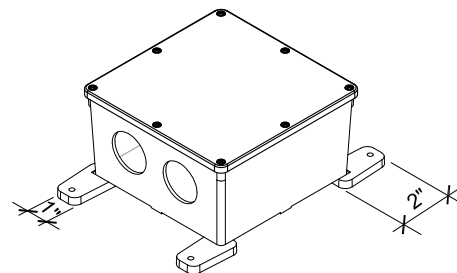

JUNCTION BOX



ENDLESS POOLS®
SWIMMING MACHINES

1601 Dutton Mill Road, Aston PA 19014
www.endlesspools.com
swim@endlesspools.com 800-732-8660

**FASTLANE COMPONENT DIAGRAM
UNIT ANCHORED TO POOL WALL
HYDRAULIC LINES RUNNING THROUGH WALL**

FASTLANE DETAIL

DETAIL NUMBER:

EP-15.0

01/15/15