

Four function pet shower

To protect the surface from scratches, wrap a cloth around the product during installation.

Parts included

Fittings for indoor installation

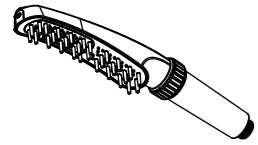

Four function pet shower (*1)



Switch Valve (*1)



Hook (*1)



The Gasket (1/2 *4)



The Gasket (3/4 *1)



Hose (*1)



Screw Package (*1)



Teflon Tape (*1)

Outdoor Installation Accessories

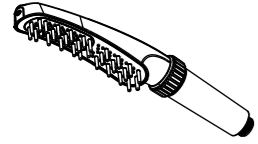

Four function pet shower (*1)



Crossover sub (*1)



Hook (*1)



The Gasket (1/2 *4)



The Gasket (3/4 *1)



Hose (*1)



Screw Package (*1)



Teflon Tape (*1)

Tools you may need

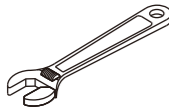

Wrench

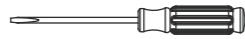

The Screwdriver



The Pencil

Indoor Installation Procedure

1



The faucet has been installed

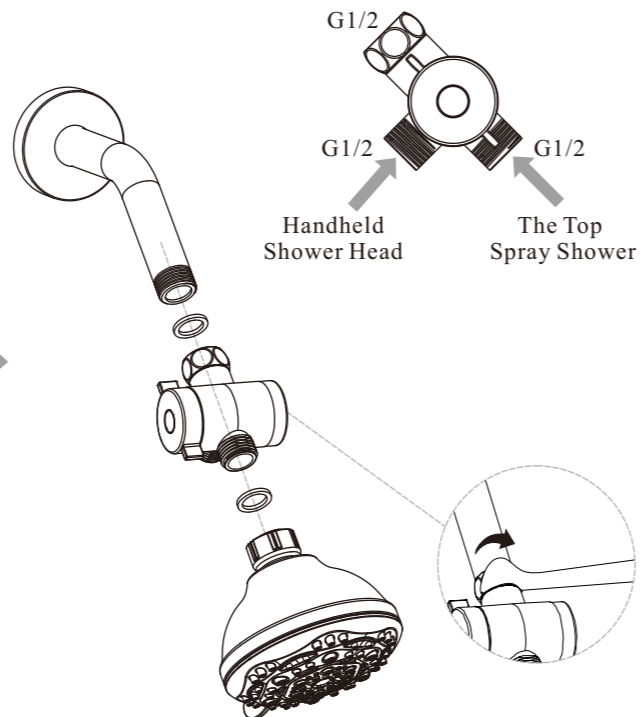

Indoor Installation Procedure

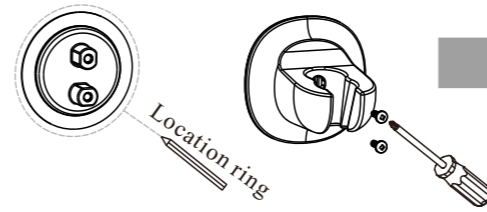

Add our on-off valve to the existing shower, install the shower seat, and connect the pet shower with the on-off valve using a shower chain.

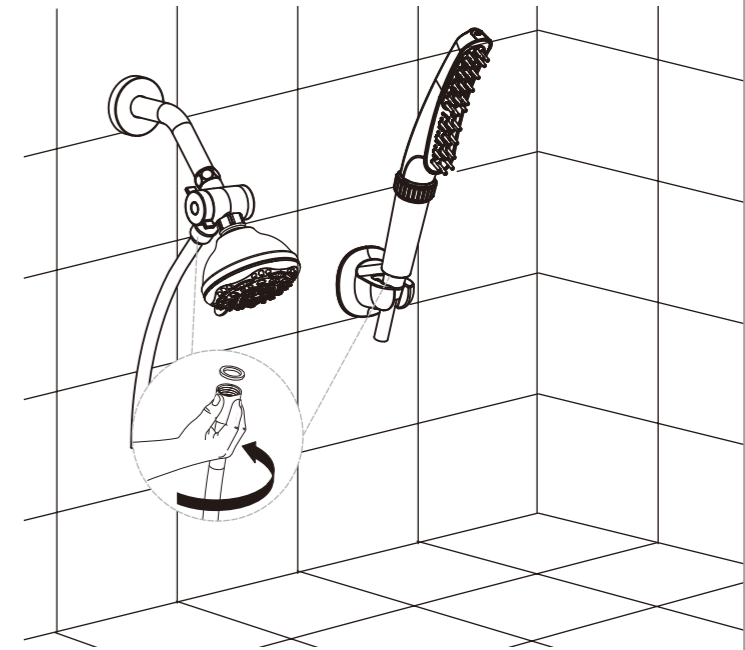

Outdoor Installation Process

1

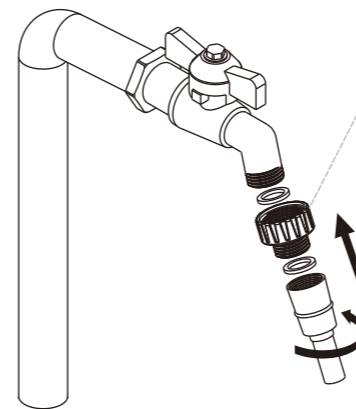

Transfer connector from G3/4 to G1/2

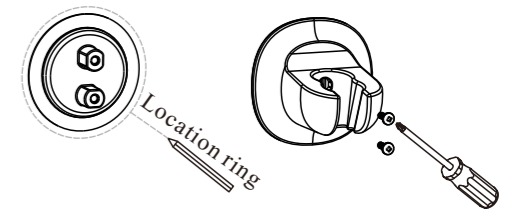

2

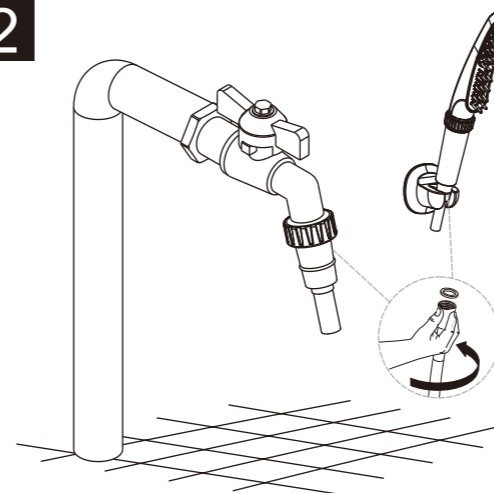

Install our adapter in the original faucet, install the pet shower seat in the appropriate position, and connect our adapter with the pet shower with the shower chain.

Product usage

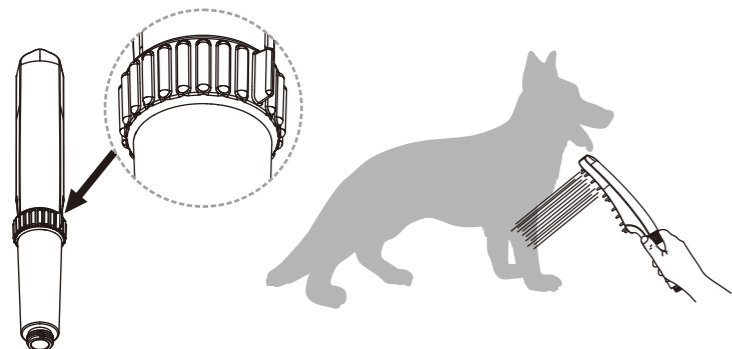
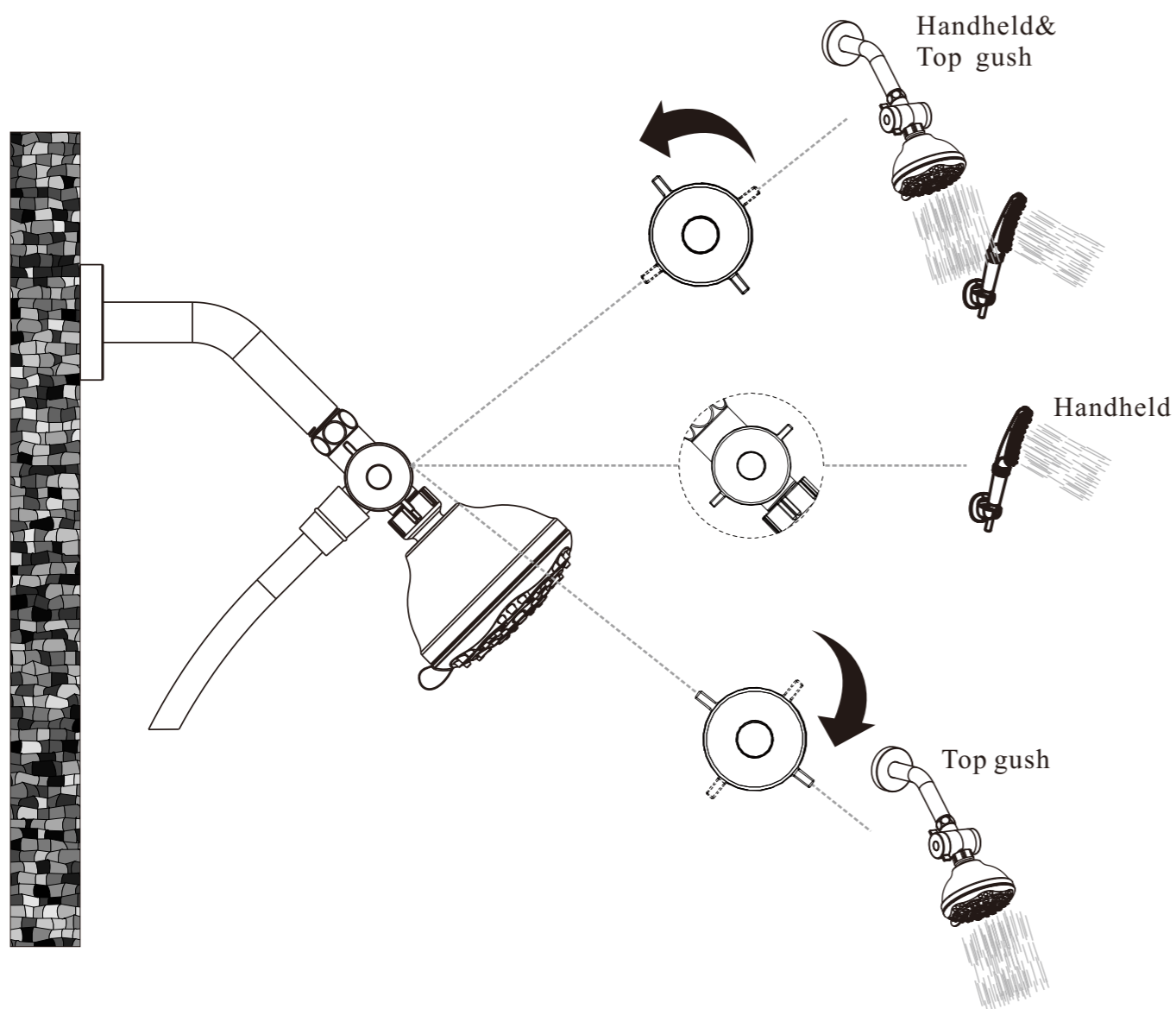

Local cleaning can be performed by reducing the water pressure when the paddles are rotated to the right.

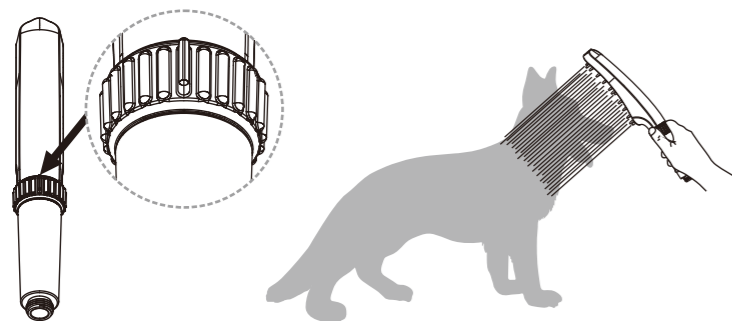

When the paddles are rotated to the middle clamp, to increase the water pressure for a wide rinse.

Product usage

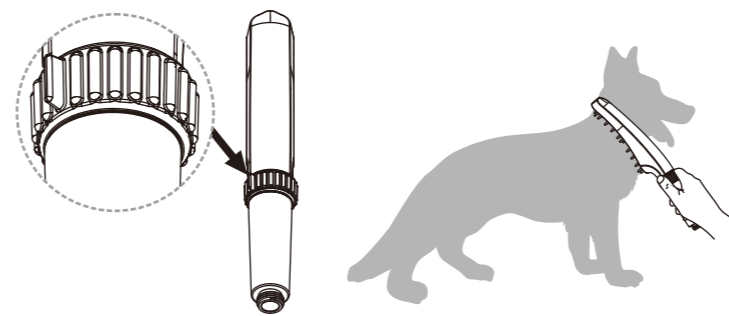

When the control valve of the pet shower turns to the left, the drainage is suspended for grooming the pet hair .

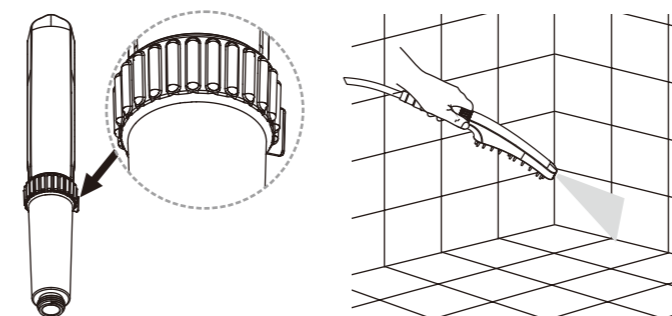

When the pet shower control valve rotates to the right, the top of the shower head is used to clean the floor (length: 118 ").

Cleaning

1. To maintain proper working conditions , cleaning is required when mineral deposits appear on spray nozzles . To clean mineral deposits , gently rub rubber nozzles on face of shower head to dislodge.
2. To clean heavier deposits , remove shower head and soak face down in a cup of white vinegar for 2-3 hours . Replace shower head and run in each spray settings to flush out vinegar . **DO NOT** use harsh chemicals , heavy-duty cleaners or abrasives . This may damages parts or finish and may void warranty.

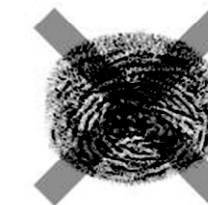
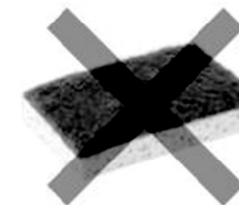

Contact Us

If you have any question, do not hesitate to contact us through email Service.us@rainovo.net