



Strut *Foot*

Universal Flat Roof Support System



About Us

Formed in 2012, based on a demand placed on our fabrication division for a high quality but economically alternative for flat roof support systems to the HVAC, mechanical and electrical sectors.

As a company we pride ourselves in excellent customer service with unrivalled lead times on quotations, manufacture and delivery. All of our standard and bespoke products are manufactured 'in house' giving us total control over the design and production schedule.

StrutFoot have a solution for the installation of all rooftop HVAC, M&E services and safe access.

Contents

| | |
|---|----------|
| StrutFoot Flat Roof Support Systems | 1 |
| StrutFoot Flat Roof Support Systems Drawings | 2 |
| StrutFoot Base & Plus | 3 |
| StrutFoot Base & Plus Drawings | 4 |
| StrutFoot HD Frames | 5 |
| H Frame Kits | 6 |
| SFR Range | 7, 8 & 9 |
| StrutFoot Duct Adjuster | 10 |
| StrutFoot Beam | 11 |
| StrutFoot Quad | 12 |
| StrutFoot Access | 13 |
| StrutFoot StepOver Drawing | 14 |

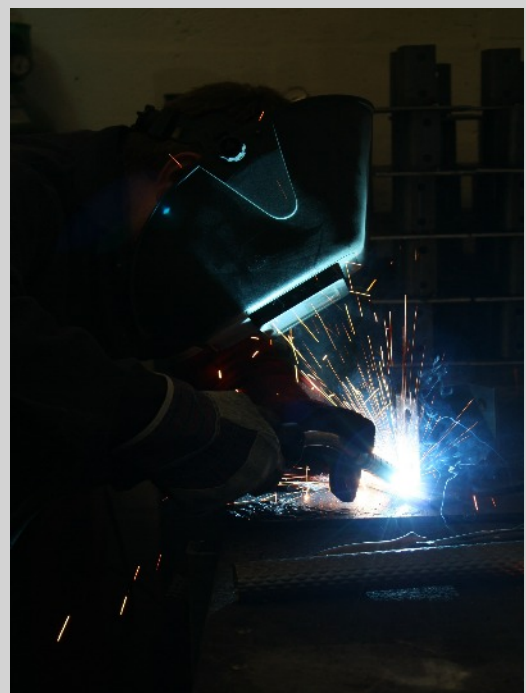

MEF Ltd

Call or e-mail for pricing and information:

Scotland & UK 0131 448 2525

Ireland & Northern Ireland 028 258 22877

Email: sales@mef.co.uk

StrutFoot



The **StrutFoot**TM Flat Roof Support System, offering total flexibility for design, layout & installation.

- UNISTRUT® Framework provides strength & convenience for cable management installation
- Cross compatibility with all Unistrut type brackets
- Fast & economical systems for mounting M&E services, Air Conditioning & Refrigeration on flat roofs
- Easy to install for individual products or complete installations
- No penetration of waterproof roof membrane
- Standard & bespoke configurations
- Anti-Vibration pads pre attached to feet
- Feet & blocks available separately



StrutFoot Support System - Technical

| Part No | Product Description | Complete Leg Assembly Supplied | Sliding Arm Supplied | Side Rails (mm) | Sliding Arms (mm) | Product Weight (kg) | Max S.W.L (kg) |
|---------|---------------------|--------------------------------|----------------------|-----------------|-------------------|---------------------|----------------|
| SF1302 | StrutFoot 2 | 4 | 2 | 1000 | 1300 | 32 | 700 |
| SF1304 | StrutFoot 4 | 6 | 4 | 2000 | 1300 | 54 | 1050 |
| SF1306 | StrutFoot 6 | 8 | 6 | 3000 | 1300 | 78 | 1400 |
| SF1308 | StrutFoot 8 | 10 | 8 | 4000 | 1300 | 101 | 1750 |
| SF1310 | StrutFoot 10 | 12 | 10 | 5000 | 1300 | 124 | 2100 |
| SF1312 | StrutFoot 12 | 14 | 12 | 6000 | 1300 | 148 | 2450 |

StrutFoot



StrutFoot 2

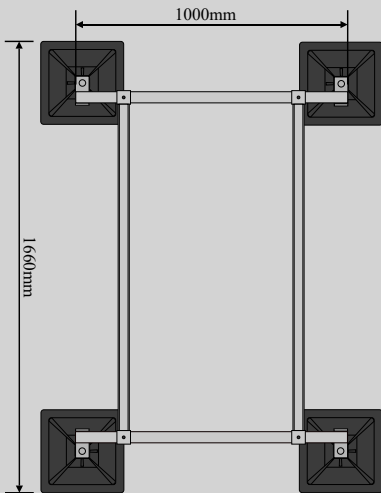

StrutFoot 4

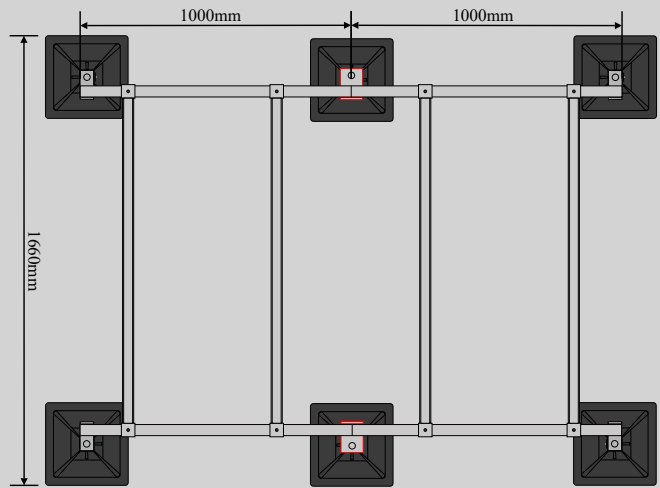

StrutFoot 6

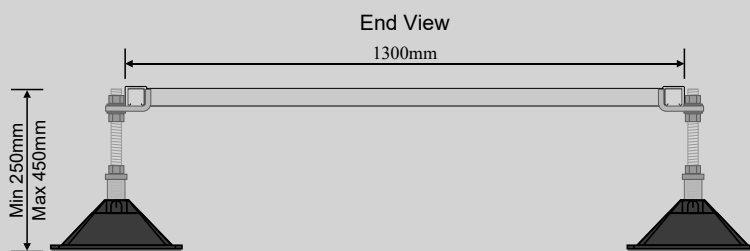
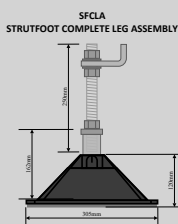
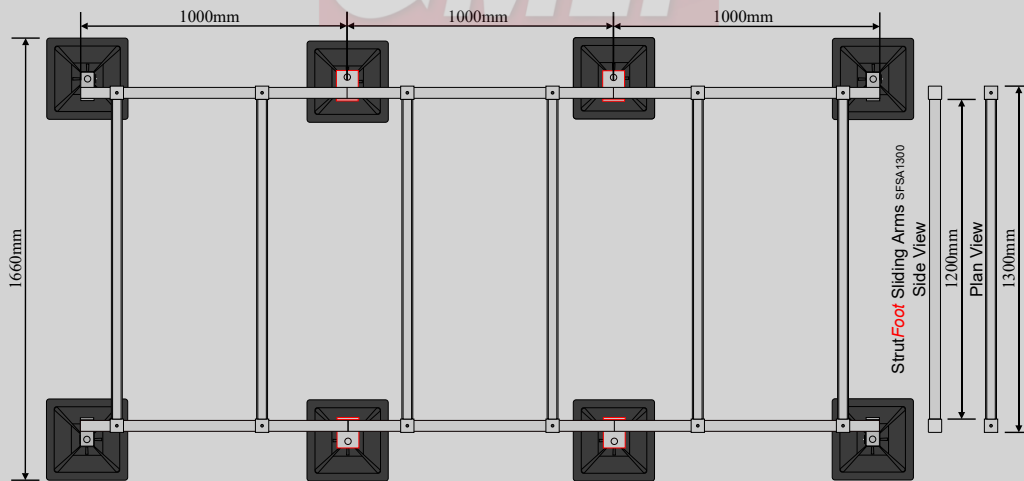

Available in 1150mm, 1300mm (shown), 1600mm & 2100mm standard lengths.

Bespoke lengths available to order

StrutFoot Base & Plus Support Systems

- Easy to adapt & extend in line or side on to suit most installations, extend to any length.
- UNISTRUT® Framework provides strength & convenience for cable management installation
- Cross compatibility with all Unistrut type brackets
- Fast & economical systems for mounting M&E services, Air Conditioning & Refrigeration on flat roofs
- Easy to install for individual products or complete installations
- No penetration of waterproof roof membrane
- Non drill system
- Anti-Vibration pads pre attached to feet



**StrutFoot Base &
StrutFoot Plus Combined**



StrutFoot Base System



StrutFoot Plus System

StrutFoot Support System - Technical Information

| Part No | Product Description | Complete Leg Assembly Supplied | Sliding Arm Supplied | Side Rails (mm) | Sliding Arms (mm) | Product Weight (kg) | Max S.W.L (kg) |
|---------|-----------------------|--------------------------------|----------------------|-----------------|-------------------|---------------------|----------------|
| SF1002 | StrutFoot Base | 4 | 2 | 1000 | 1300 | 32 | 700 |
| SF1004 | StrutFoot Plus | 2 | 2 | 1000 | 1300 | 26 | 350 |

StrutFoot

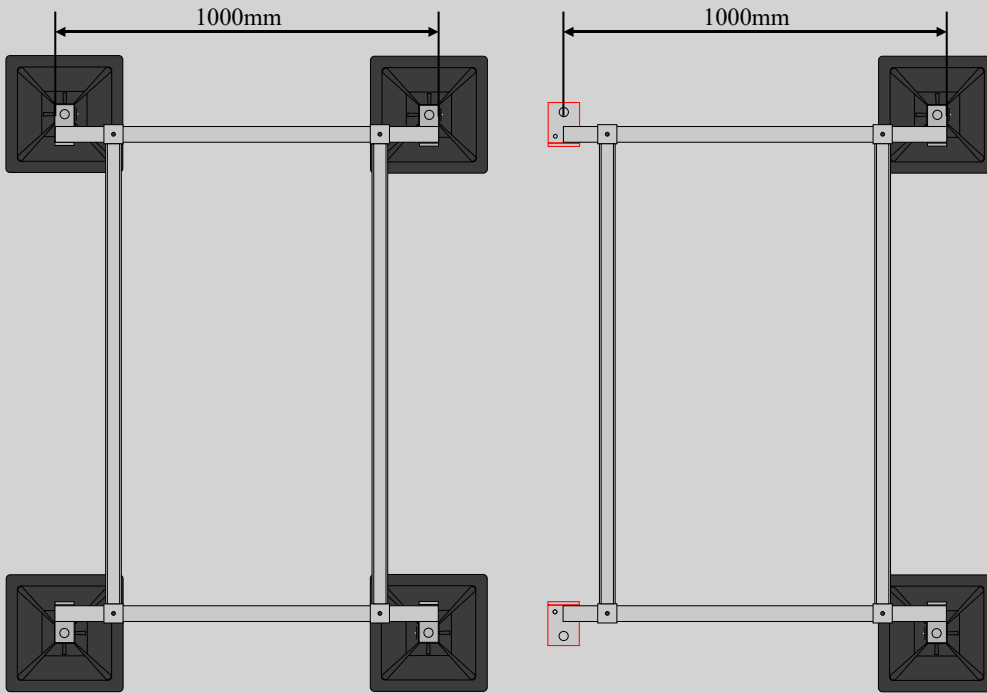

StrutFoot Sliding Arms SFSA1300

Side View

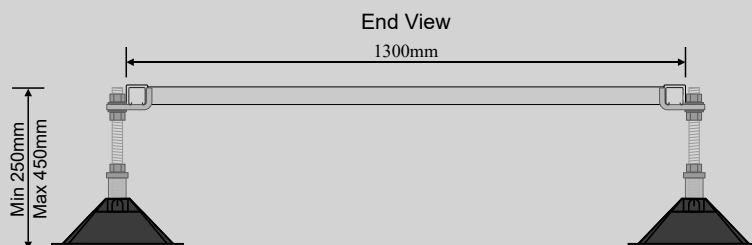
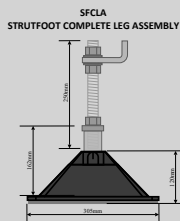
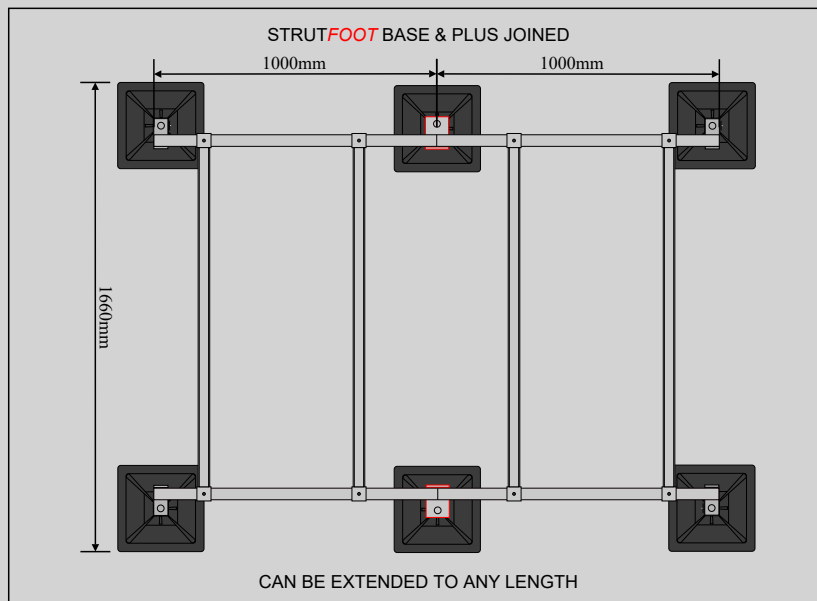
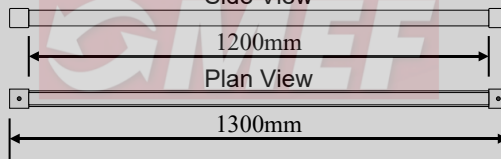

StrutFoot HD Frames

- Heavy Duty Framework
- UNISTRUT® Framework provides strength & convenience for cable management installation
- Cross compatibility with all Unistrut type brackets
- Fast & economical systems for mounting M&E services, Air Conditioning & Refrigeration on flat roofs
- Easy to install for individual products or complete installations
- No penetration of waterproof roof membrane
- Non drill system
- Bespoke configurations
- Anti-Vibration pads pre attached to feet

StrutFoot HD Example

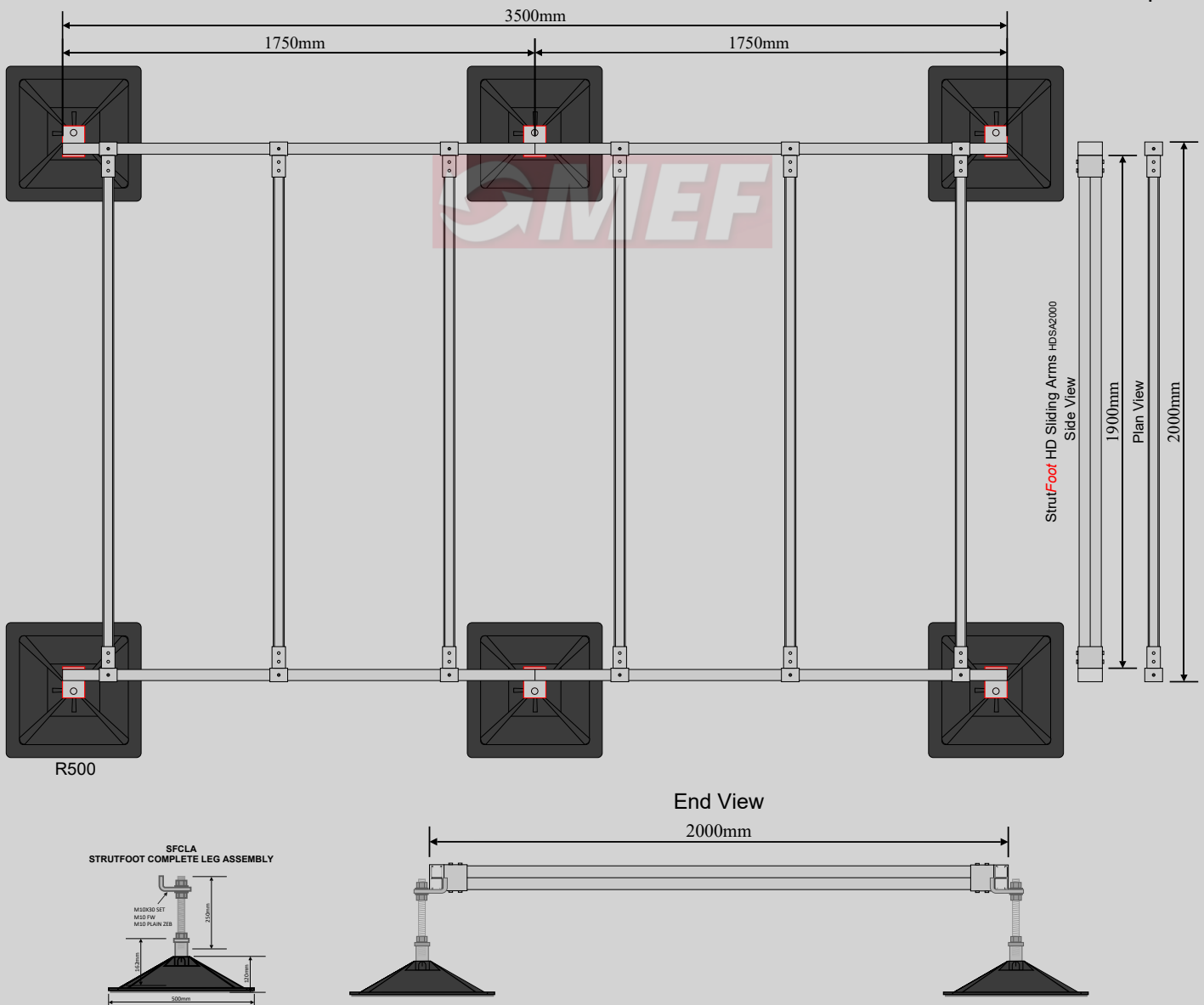

StrutFoot



H Frame Kits

The H Frame Kit is a quick and easy solution to support all cable management, ducting and pipework.

H Frames are supplied in box form.

They are designed to use UNISTRUT channel which is not supplied. As a module our manufacturing can fabricate the H Frames in house to speed up the process of installation on site.

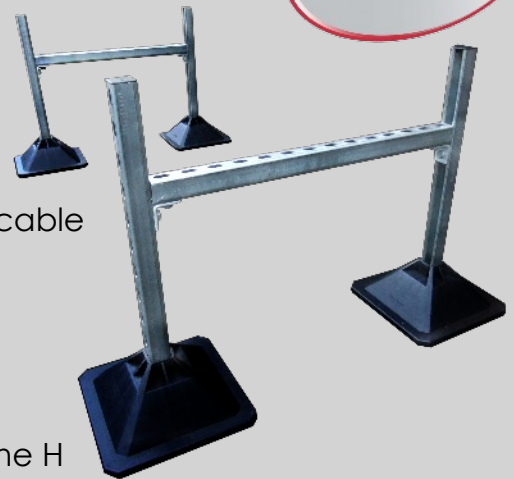

H Frame Kit Includes

| Product | Quantity |
|--------------|----------|
| Plastic Feet | x 2 |
| Fixing Kit | x 1 |

- High Density Polyethylene (HDPE)
- Designed to fit UNISTRUT channel (not supplied)
- No penetration of waterproof roof membrane
- Anti-vibration pads pre attached to feet
- Off site cutting & delivering service available
- Available in 305mm & 500mm
 - S.W.L for R305mm - 350Kg
 - S.W.L for R500mm - 500Kg

Product Information

| Part No | Feet Size (mm) | Product Weight (kg) | Frame S.W.L (kg) |
|---------|----------------|---------------------|------------------|
| SF3305 | 305 | 4.1 | 350 |
| SF3500 | 500 | 10 | 500 |



StrutFoot



SFR Range

Pipe work, Cable management

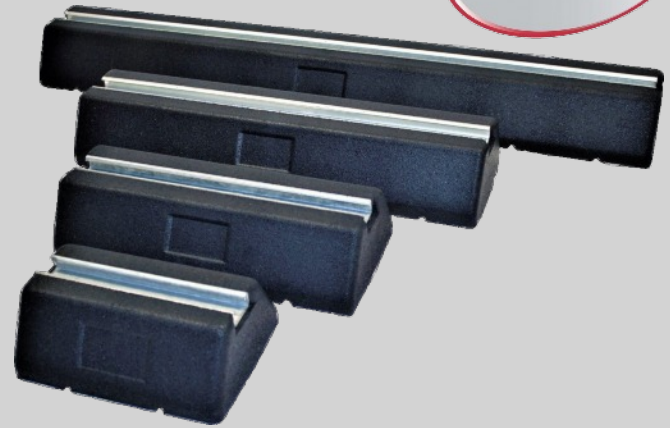

Typical Application

The 6 feet of the standard SFR range are a practical and versatile support solution for pipe work and cable trays. They can also be used for smaller outdoor condensing units or air source heat pump installations. The feet have a 41mm x 21mm 'bonded' in channel, which is recessed into the top face allowing you to use standard strut fixings to secure your services to the feet.

Our SFR range are made from Recycled SBR rubber, making them eco friendly. They also have the added advantage of vibration and noise absorption which makes them the perfect product for roof or ground level installation.



| Part No | Model | Length (mm) | Width (mm) | Height (mm) | Max Loading Per Foot (kg) |
|---------|------------|-------------|------------|-------------|---------------------------|
| SF4025 | SFR250 | 250 | 180 | 95 | 160 |
| SF4040 | SFR400 | 400 | 180 | 95 | 240 |
| SF4060 | SFR600 | 600 | 180 | 95 | 450 |
| SF4010 | SFR1000 | 1000 | 180 | 95 | 645 |
| SF4525 | SFR250 Low | 250 | 130 | 50 | 160 |
| SF4540 | SFR400 Low | 400 | 130 | 50 | 240 |

MATERIAL SPECIFICATION

SBR-Recycled Rubber. Bound using a ratio of high quality moisture curing Polyurethane Pre-Polymer.
BS7188:1989+A2:2009 and BS EN1176-7:2008

METAL PROFILE

Pre Galvanised strut 41mm x 21mm profile compatible with strut fixings.

WORKING CONDITIONS

Suitable for internal or external applications in temperatures between -40°C to +80°C. BSEN60068-2-14

MEF Ltd

Call or e-mail for pricing and information:

Scotland & UK 0131 448 2525

Ireland & Northern Ireland 028 258 22877

Email: sales@mef.co.uk

SFR Range

Pipe work, Cable management

StrutFoot SFR Mini Split Kits

Kit Includes

| | |
|-------------|-----|
| Rubber Feet | x 2 |
| Fixing Kit | x 2 |



| Part No | Description | Length (mm) | Width (mm) | Height (mm) | S.W.L per Kit (kg) | Packaged Weight (kg) |
|---------|-------------------------|-------------|------------|-------------|--------------------|----------------------|
| SF4066 | Mini-Split Kit SFR 600 | 600 | 180 | 95 | 900 | 13 |
| SF4011 | Mini Split Kit SFR 1000 | 1000 | 180 | 95 | 1290 | 21.6 |

StrutFoot SFR AV Pads

| Part No | Description | Length (mm) | Width (mm) | Height (mm) | Packaged Weight (kg) |
|---------|------------------|-------------|------------|-------------|----------------------|
| SF4081 | SFR 300mm AV Pad | 300 | 300 | 6 | 0.5 |
| SF4082 | SFR 500mm AV Pad | 500 | 500 | 6 | 0.85 |

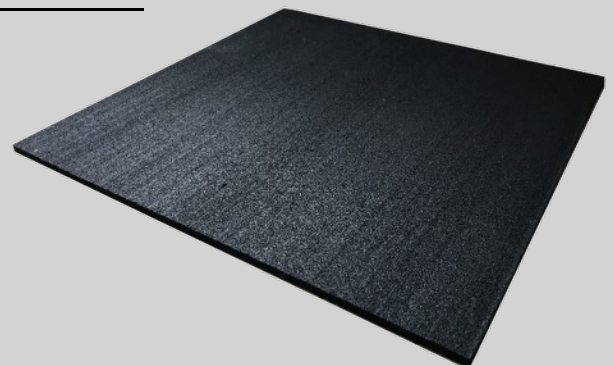

MEF Ltd

Call or e-mail for pricing and information:

Scotland & UK 0131 448 2525

Ireland & Northern Ireland 028 258 22877

Email: sales@mef.co.uk

SFR Range

Pipe work, Cable management

StrutFoot SFR Vibro Mats

| Part No | Description | Length (mm) | Width (mm) | Height (mm) | Packaged Weight (kg) |
|---------|-------------------|-------------|------------|-------------|----------------------|
| SF4091 | SFR Vibro Mat 330 | 330 | 330 | 45 | 4 |
| SF4092 | SFR Vibro Mat 500 | 500 | 500 | 45 | 7.5 |

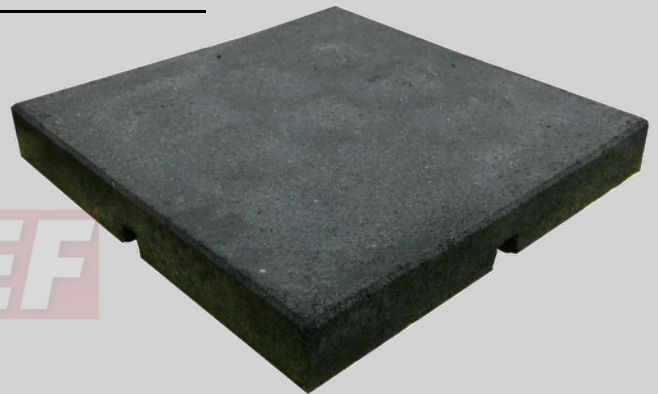

StrutFoot Angled Rubber Pads

| Part No | Description | Length (mm) | Width (mm) | Packaged Weight (kg) |
|---------|--------------------|-------------|------------|----------------------|
| SF4071 | SFR 305 2.5 Degree | 305 | 305 | 1.9 |
| SF4072 | SFR 500 2.5 Degree | 500 | 500 | 6 |
| SF4073 | SFR 305 5 Degree | 305 | 305 | 1.6 |
| SF4074 | SFR 500 5 Degree | 500 | 500 | 7.5 |

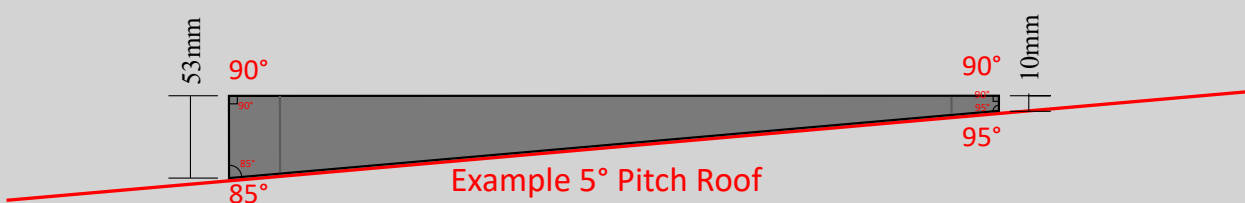

StrutFoot Duct Adjuster

StrutFoot's new adjustable ducting support offering flexibility and quick installation. The height of the duct adjuster can easily be changed using the thumb screw provided.

87% quicker than standard installations

Product Information

| Part Code | Feet Size (mm) | Quantity | Brackets Quantity | Packaged Weight (kg) |
|-----------|----------------|----------|-------------------|----------------------|
| SF5822 | 305 | x 5 | x 5 | 10 |
| SF5844 | 500 | x 2 | x 2 | 13.5 |



- Non penetrative duct support
- Quick and easy to install
- 305mm and 500mm feet available
- Feet incl. Adhered anti-vibration pad
- Comfortable height adjustment using thumb screw
- Height adjustable between 220 - 400mm
- Total height 600mm from floor
- Static max. Load 80kg
- 8mm stud for ducting support rings & clamps

Ducting and ducting clip not included



MEF Ltd

Call or e-mail for pricing and information:

Scotland & UK 0131 448 2525

Ireland & Northern Ireland 028 258 22877

Email: sales@mef.co.uk

StrutFoot



StrutFoot Beam

The **StrutFoot** Beam is an adjustable heavy duty support system. This system is typically used with heavy Air Handling Units (AHU's) or when we have to pick up existing beams on the roof.

- Adjustable heavy duty support system
- Used to pick up existing support beams
- Used to support heavy AHU's
- Supplied with fixings
- Supplied to fit required size
- Hot dip galvanised (HDG) framework
- Available in 305mm & 500mm
- S.W.L for 305mm - 350Kg
- S.W.L for 500mm - 500Kg



| Part No | Feet Size (mm) | Beam Size (mm) | Product Weight (kg) | Frame S.W.L (kg) |
|---------|----------------|----------------|---------------------|------------------|
| SF7500 | 305 | 500 | 9.5 | 350 |
| SF7010 | 305 | 1000 | 12.4 | 350 |



StrutFoot Beam Includes

| Product | Quantity |
|--------------|----------|
| Leg Assembly | x 2 |
| Beam | x 1 |
| Brackets | x 2 |



StrutFoot Quad

The quad system is a quick and easy solution to support large/heavy AHU's, chillers and plant rooms.

All the framework on each Quad system is HDG ensuring there will be no rust/corrosion when installed outside. It can be supplied using either our R305 or our R500 plastic feet.

We manufacture a welded framework for both our adjustable and fixed quad to ensure strength and minimize the deflection in the strut.

StrutFoot Quad Fixed

| Part No | Description | Feet Size (mm) | S.W.L (kg) |
|---------|---------------------------|----------------|------------|
| SF5305 | StrutFoot Quad R305 Fixed | 305 | 700 |
| SF5500 | StrutFoot Quad R500 Fixed | 500 | 1000 |

StrutFoot Quad Adjustable

| Part No | Description | Feet Size (mm) | S.W.L (kg) |
|---------|--------------------------------|----------------|------------|
| SF6305 | StrutFoot Quad R305 Adjustable | 305 | 700 |
| SF6500 | StrutFoot Quad R500 Adjustable | 500 | 1000 |



MEF Ltd

Call or e-mail for pricing and information:

Scotland & UK 0131 448 2525

Ireland & Northern Ireland 028 258 22877

Email: sales@mef.co.uk

StrutFoot Access

StrutFoot offer a full range of StepOvers to their customers. Each StepOver is complete with 1000mm wide steps, 1000x1000mm platform and the handrail.

With our in house design and manufacturing **StrutFoot** can supply and install bespoke access to meet the customer specifications.

The framework on all of our access is HDG (hot dipped galvanised) ensuring there will be no rust. All of the leg assemblies supplied with the StepOver are adjustable and supplied with our R305 plastic feet.

All of the systems below are available from stock and are easily installed.

StrutFoot StepOver's

| Part No | Description | Foot Size (mm) | Platform Size (mm) |
|---------|------------------------|----------------|--------------------|
| SF8010 | SFA111 - 1 Step System | 305 | 1000x1000 |
| SF8020 | SFA212 - 2 Step System | 305 | 1000x1000 |
| SF8030 | SFA313 - 3 Step System | 305 | 1000x1000 |
| SF8040 | SFA414 - 4 Step System | 305 | 1000x1000 |

StrutFoot Platform

| Part No | Description | Foot Size (mm) | Platform Size (mm) |
|---------|------------------------------------|----------------|--------------------|
| SF8050 | SFA555 - StrutFoot Platform | 305 | 1000x1000 |

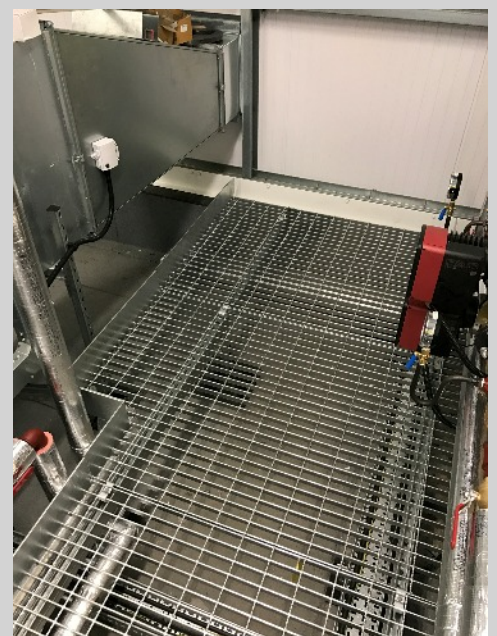

StrutFoot



StrutFoot StepOver Drawing

Example of an SFA111

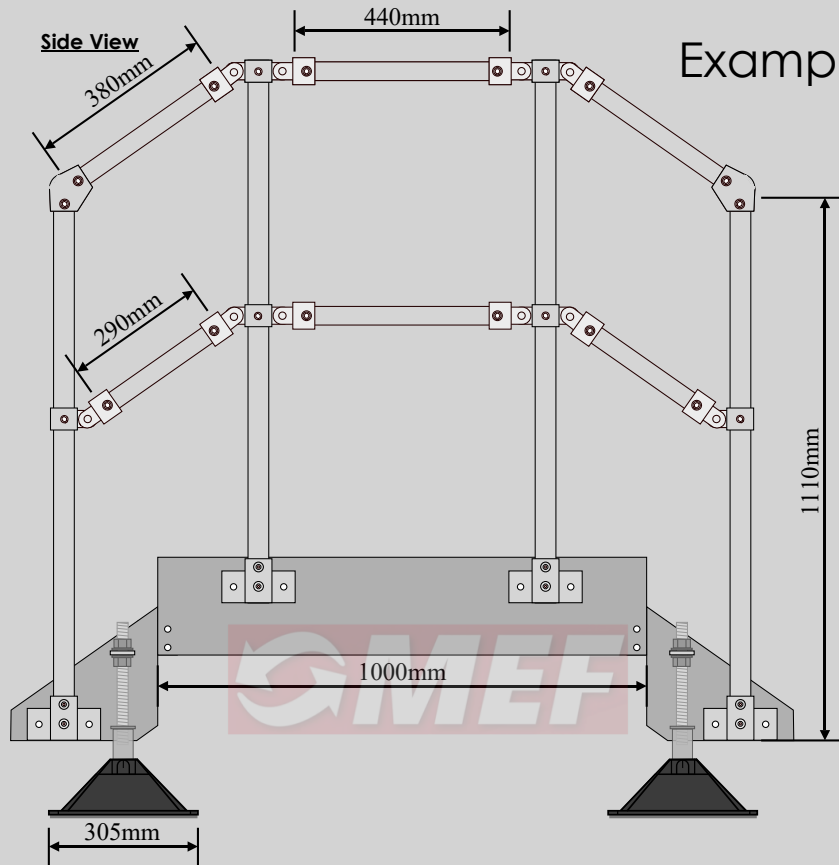

Plan View

