



Kerf Cutter Valve Box Repair Tool Manual

Questions about Operation?
952-484-8610

www.HydroVerge.com

July 2017

There are a four steps to replacing a broken valve box:

1. Measure
2. Cutting
3. Extraction
4. Insertion

1. Measuring

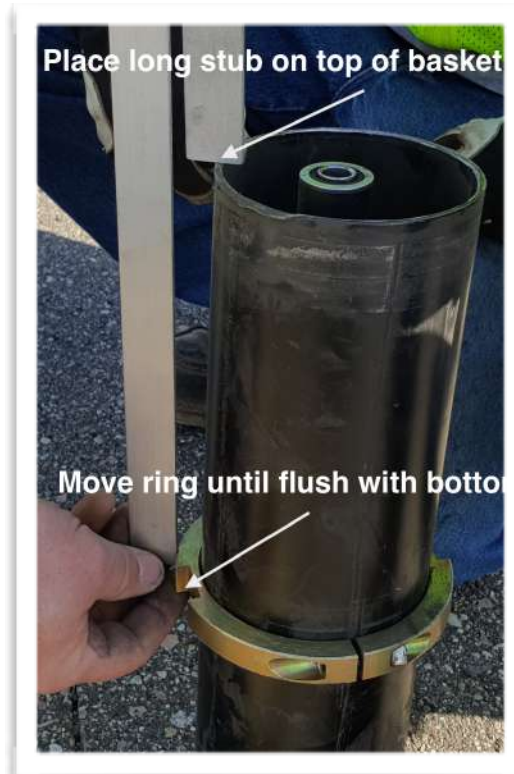
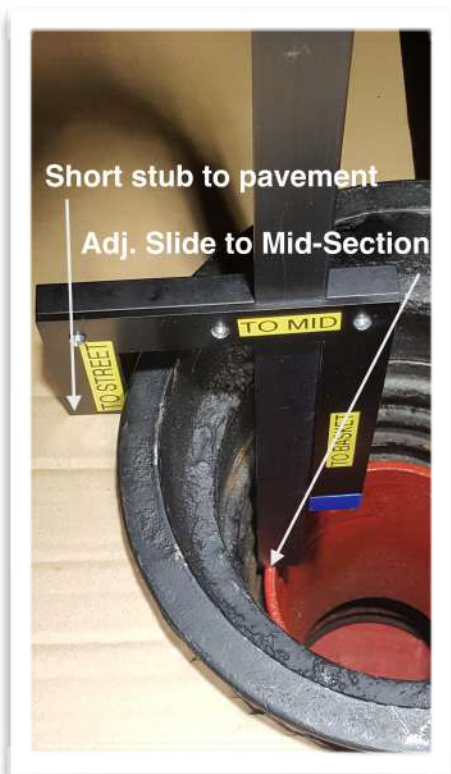

Place depth gauge into the valve box with the adjustable slide on top of the interior mid-

section. Slide handle until the short stub hits the surface. (The new insert will sit about 1/2" below wherever the short stub is measured) Lock thumb screw and transfer the measurement to the Basket.

2. Cutting:

Place cutting wheel onto Adapter then washer then threaded nut and turn until hand tight.

Once cutting wheel is properly attached place the Basket with the proper depth adjusted to the Ring. Place Basket into



hole. Insert Adapter into the Spring loaded shaft inside the Basket. Place Motor onto the Adapter making sure the keystone tab is aligned properly. Plug in Motor. Begin cutting the valve box by applying very little pressure, let the tool do the work. Cut the area where the blade passes over the thread of the valve

box. If this is not done properly you will break many blades as the cutter will want to follow the pitch of the thread making an uneven cut. Make small U shaped cuts following the path the blade has cut. Once the paths connect keep cutting until you have plunged through the valve box.



3. Extraction

Once valve box is cut completely tap the valve box with a hammer to loosen it up. Thread the puller into the valve box making sure not to thread past the cut line in the valve box. If no threads are visible pry the top from the exterior with a rock bar. Use a pry bar and jack stand if the top does not come out by hand.



4. Insertion

Once the valve box has been cut and removed clean up the area where you will insert the ST2 Valve box repair top. Try dry fitting the top into the hole. If the top does not fit properly attach grinding bit to the end of the tool and remove areas where it is binding the



repair top. Once the top fits apply the gasket to the bottom of the valve box repair top to seal out debris. Apply a line of sealant

around the exterior of the valve box. Insert the top into the hole and seal the gap with sealant.



Maintenance:

Lubricate threads and connecting parts with Included lubricant making sure to remove debris in the basket and adapter

Warranty:

3 years parts and labor. Please ship product to us or local dealer with return postage paid and we will repair your tool free of charge.