

STEP
1

MAKE A SKETCH OF THE YARD

Draw the yard to scale in order to obtain a good overview. Also indicate the location of certain elements (table, pond, tree, steps, etc.).

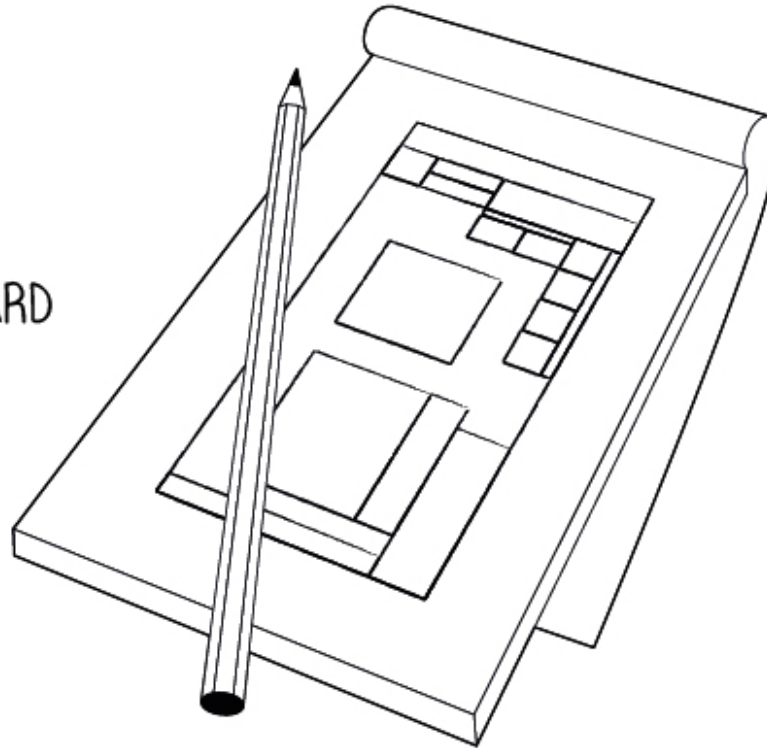

STEP
2

FIGURE OUT WHICH ELEMENTS YOU WANT TO LIGHT UP

What do you consider important to be seen during the evening? Don't just consider elements such as steps or a patio, but also nice corners or exceptional shapes that look better when illuminated.

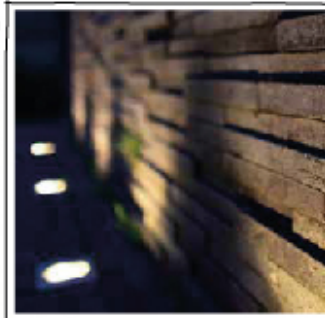

STEP 3

DETERMINE THE LIGHT SIZE FOR EACH ELEMENT

in-lite has divided light into three 'sizes': Small, Medium and Large. These stand for light intensity and reach. Small light is suitable for outlining a patio or a border, while Large light is ideal for illuminating a large tree or an exterior wall.

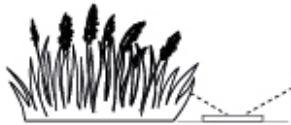

SMALL

- Low intensity
- Reach of up to 1.5 meters
- For highlighting a pathway, driveway, deck, pond edge, border, low wall, step, recessed sitting area or fence



MEDIUM

- Medium-high intensity
- Reach of 1.5 to 3 meters
- For highlighting a statue, shrub, small tree, garden wall or fence

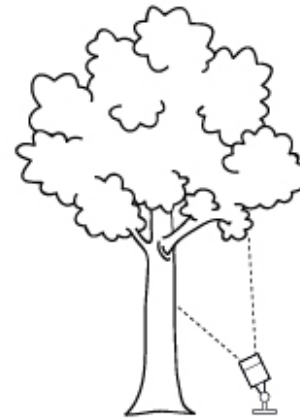

LARGE

- High intensity
- Reach of over 3 meters
- For highlighting an outer wall, large statue, bush or tree

STEP
4

SELECT THE DIRECTION OF THE LIGHT

Integrated lighting (1) shines from the ground up. Above ground fixtures (2) light the area all around them. Wall lighting (3) can shine all round as well as project light downwards, while the light from spotlights (4) comes from below. Align the direction of the light with the element you want to illuminate.

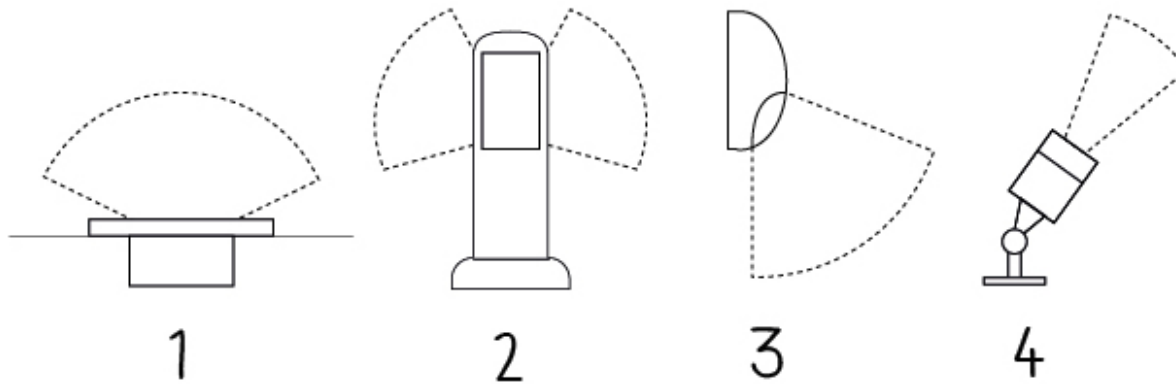

STEP
5

CHOOSE A FIXTURE

After the light size and the desired product group have been selected, choose the fixture. The external appearance plays a key role in this respect; however, also take particular note of the type of lamp (LED, halogen or the traditional bulb) and the light's color (warm or cool light).

