

# RECTANGULAR DROP IN PAN & SWITCHBACK BULLET BURNER MATCH LIT IGNITION

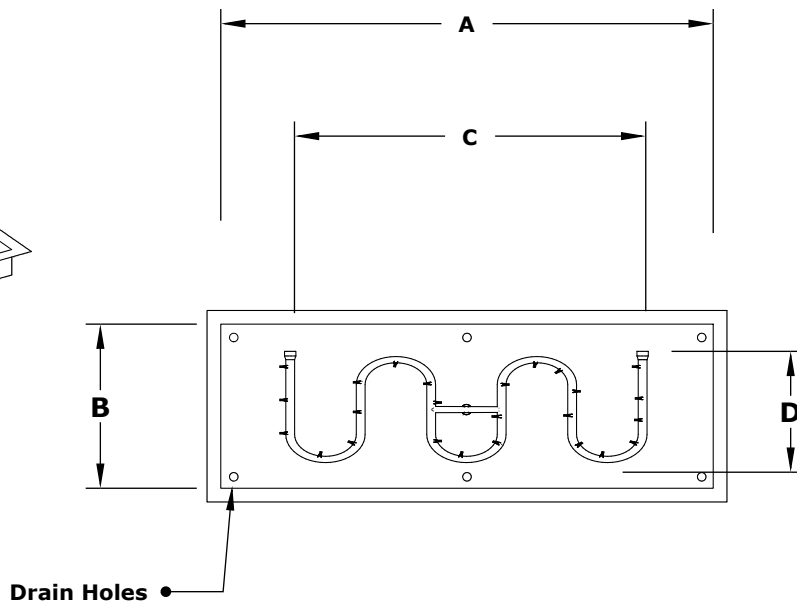

**ISOMETRIC VIEW**

**TOP VIEW**

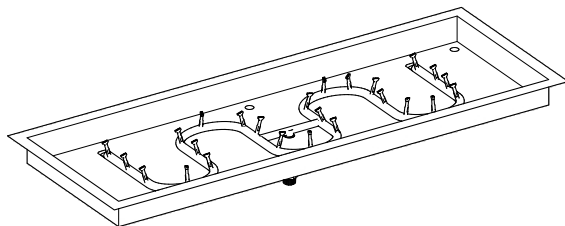
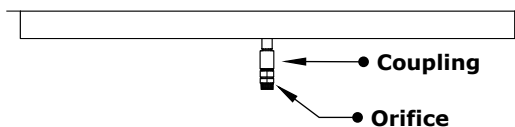
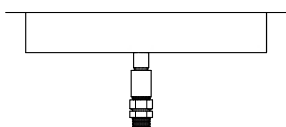

**RIGHT SIDE VIEW**

**FRONT SIDE VIEW**

| SKU             | A   | B   | C       | D  | INLET | BTU     |
|-----------------|-----|-----|---------|----|-------|---------|
| OPT-BP1224SBDSS | 24" | 12" | 18"     | 6" | 1/2"  | 70,000  |
| OPT-BP1236SBDSS | 36" | 12" | 30"     | 6" | 1/2"  | 90,000  |
| OPT-BP1248SBDSS | 48" | 12" | 42"     | 6" | 3/4"  | 125,000 |
| OPT-BP1260SBDSS | 60" | 12" | 48"     | 6" | 3/4"  | 165,000 |
| OPT-BP1272SBDSS | 72" | 12" | 60" (M) | 6" | 3/4"  | 200,000 |
| OPT-BP1284SBDSS | 84" | 12" | 72" (M) | 6" | 3/4"  | 240,000 |
| OPT-BP1296SBDSS | 96" | 12" | 84" (M) | 6" | 3/4"  | 360,000 |

Pan Material: Aluminum  
Burner Material: Brass / Stainless Steel  
Ignition Type: Match Lit

Includes: Pan, Burner, Electronic Valve.

M = Manifold

# RECTANGULAR DROP IN PAN & SWITCHBACK BULLET BURNER 12V ELECTRONIC IGNITION

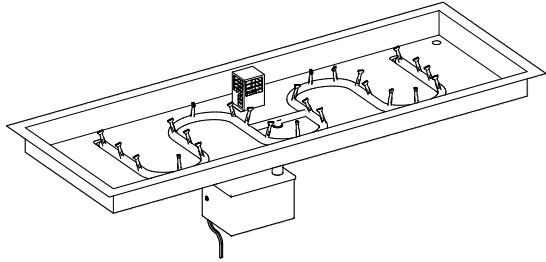

**ISOMETRIC VIEW**

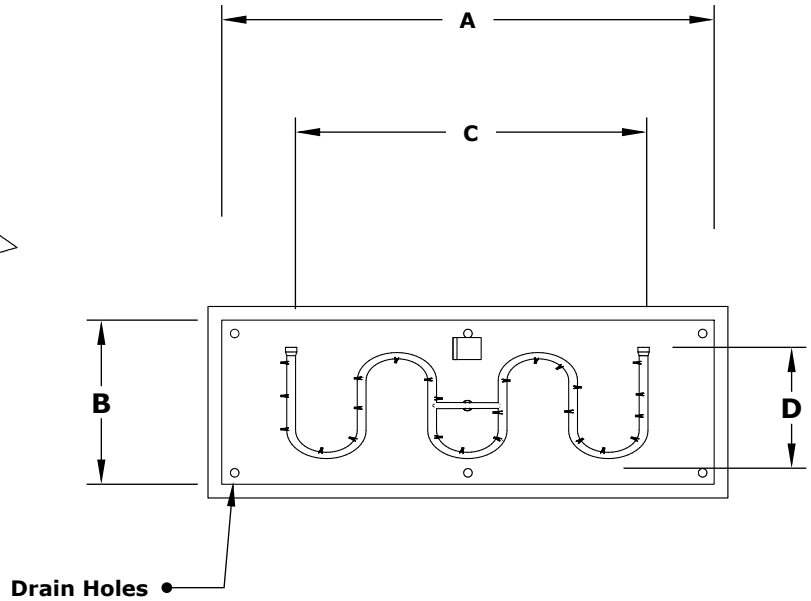

**TOP VIEW**

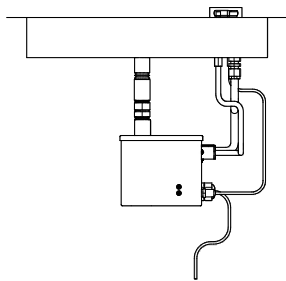

**RIGHT SIDE VIEW**

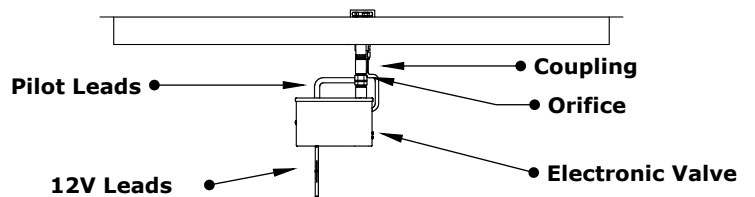

**FRONT SIDE VIEW**

| SKU                | A   | B   | C       | D  | INLET | BTU     |
|--------------------|-----|-----|---------|----|-------|---------|
| OPT-BP1224SBDSSE12 | 24" | 12" | 18"     | 6" | 1/2"  | 70,000  |
| OPT-BP1236SBDSSE12 | 36" | 12" | 30"     | 6" | 1/2"  | 90,000  |
| OPT-BP1248SBDSSE12 | 48" | 12" | 42"     | 6" | 3/4"  | 125,000 |
| OPT-BP1260SBDSSE12 | 60" | 12" | 48"     | 6" | 3/4"  | 165,000 |
| OPT-BP1272SBDSSE12 | 72" | 12" | 60" (M) | 6" | 3/4"  | 200,000 |
| OPT-BP1284SBDSSE12 | 84" | 12" | 72" (M) | 6" | 3/4"  | 240,000 |
| OPT-BP1296SBDSSE12 | 96" | 12" | 84" (M) | 6" | 3/4"  | 360,000 |

M = Manifold

Pan Material: Aluminum  
Burner Material: Brass / Stainless Steel  
Ignition Type: 12V Electronic Ignition  
(12V Transformer Included)



**12V ELECTRONIC IGNITION**  
ANSI Z21.97-(2017) / CSA 2.41-(2017)

Includes: Pan, Burner, Electronic Valve,  
Pilot Igniter, 12V Transformer.

# RECTANGULAR DROP IN PAN & SWITCHBACK BULLET BURNER 110V ELECTRONIC IGNITION

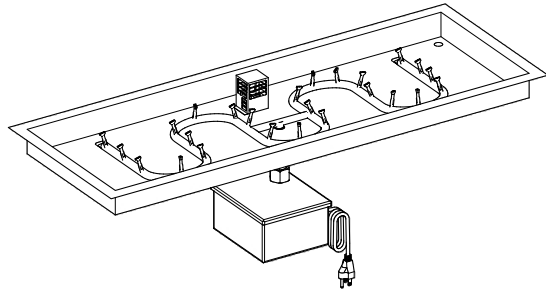

**ISOMETRIC VIEW**

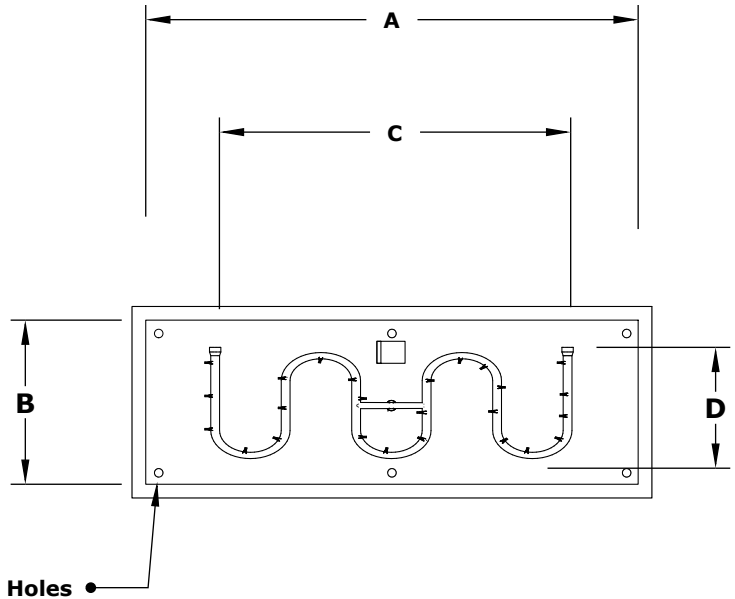

**TOP VIEW**

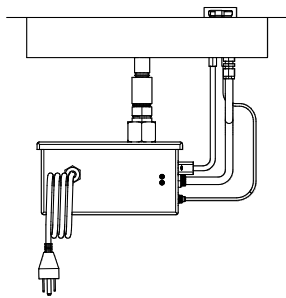

**RIGHT SIDE VIEW**

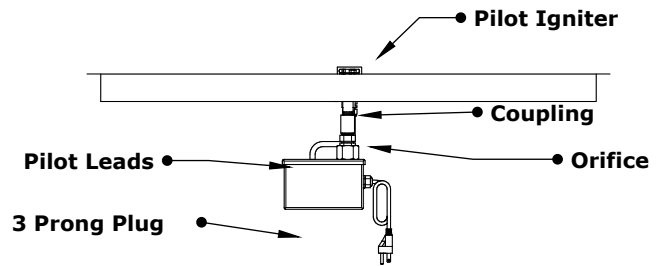

**FRONT SIDE VIEW**

| SKU                | A   | B   | C       | D  | INLET | BTU     |
|--------------------|-----|-----|---------|----|-------|---------|
| OPT-BP1224SBDSE110 | 24" | 12" | 18"     | 6" | 1/2"  | 70,000  |
| OPT-BP1236SBDSE110 | 36" | 12" | 30"     | 6" | 1/2"  | 90,000  |
| OPT-BP1248SBDSE110 | 48" | 12" | 42"     | 6" | 3/4"  | 125,000 |
| OPT-BP1260SBDSE110 | 60" | 12" | 48"     | 6" | 3/4"  | 165,000 |
| OPT-BP1272SBDSE110 | 72" | 12" | 60" (M) | 6" | 3/4"  | 200,000 |
| OPT-BP1284SBDSE110 | 84" | 12" | 72" (M) | 6" | 3/4"  | 240,000 |
| OPT-BP1296SBDSE110 | 96" | 12" | 84" (M) | 6" | 3/4"  | 360,000 |

M = Manifold

Pan Material: Aluminum  
Burner Material: Brass / Stainless Steel  
Ignition Type: 110V Electronic Ignition  
(110V Transformer Included)



**110V ELECTRONIC IGNITION**  
ANSI Z21.97-(2017) / CSA 2.41-(2017)

Includes: Pan, Burner, Electronic Valve,  
Pilot Igniter, 110V Transformer.