

VENTED

BEDROCK BURNER

CONTEMPORARY DROP-IN BURNER



Available in sizes 24", 36", 48", 60", 72", 84", and 96"

VENTED LINEAR DROP-IN BURNER

Operated with an SIT Proflame II control system including convenient flame modulation on a sleek hand held remote. The Bedrock Burner is also the **FIRST** vented Drop-in burner system featuring IC controlled LED lighting that operates with a remote or easy to use App. The main flame and LED lighting are independently controlled and operated. Available in 6 convenient sizes, install indoors or under a covered patio & add 1/2" reflective glass to finish off.

- Install in Trough or Open Face Wood Burning Fireplace
- Install Indoors or Under Covered Patio
- 110v System with Plug or Hard Wire Ready
- Gas Specific, Non-Field Convertible
- BTU Output Equals 15K BTUs Per Foot
- 5 Flame Height Adjustments
- Integrated LED Lights w/ App controls
- Designed with 1/2" Reflective Fireglass

OPTIONAL MEDIA



Cannonballs



Driftwood Logs

QUICK SPECS

Designed For Indoor or Covered Patios

FLAME ADJUSTMENT .. Five Flame Settings
INSTALLATION Trough or Open Hearth
FUEL Natural Gas or Propane
ELECTRICAL 120VAC, 60Hz
CONTROLS SIT Proflame II Controller
IGNITION Direct Spark

VENTED BEDROCK BURNER

NATURAL GAS MODELS

	Rated High	Rated Low	Rated Manifold Pressure	Rated Inlet min	Rated Inlet max
NG MODELS	High	Low	Pressure	min	max
LDB24L-EN	30000	20000	3.5	5	10.5
LDB36L-EN	45000	30000	3.5	5	10.5
LDB48L-EN	60000	40000	3.5	5	10.5
LDB60L-EN	75000	50000	3.5	7	10.5
LDB72L-EN	90000	60000	3.5	7	10.5
LDB84L-EN	105000	70000	3.5	7	10.5
LDB96L-EN	120000	80000	3.5	7	10.5

LIQUID PROPANE MODELS

	Rated High	Rated Low	Rated Manifold Pressure	Rated Inlet min	Rated Inlet max
LP MODELS	High	Low	Pressure	min	max
LDB24L-EP	30000	15000	10	11	14
LDB36L-EP	45000	20000	10	11	14
LDB48L-EP	60000	30000	10	11	14
LDB60L-EP	75000	40000	10	11	14
LDB72L-EP	90000	50000	10	11	14
LDB84L-EP	105000	55000	10	11	14
LDB96L-EP	120000	60000	10	11	14

Sizing Chart

NG/LP	Min. Fire Box Size			
	Front	Rear	Depth	Height
LDB24	24	24	15	20
LDB36	36	36	15	20
LDB48	48	48	15	20
LDB60	60	60	15	20
LDB72	72	72	15	20
LDB84	84	84	15	20
LDB96	96	96	15	20

- A. Handles
- B. Case
- G. IFC Board
- H. ProFlame Receiver
- K. Multifunction Burner Remote
- C. Burner
- D. Gas Valve
- E. Gas Valve Cover
- I. Pilot
- L. LED Remote
- M. LED Lights
- F. Base
- J. Power Cord

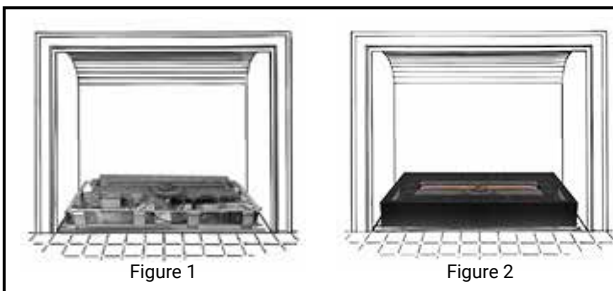
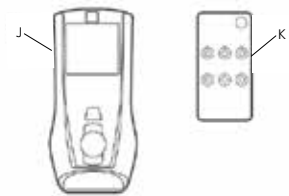
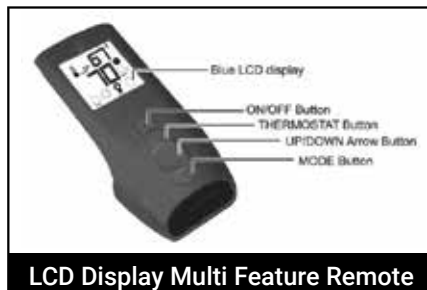
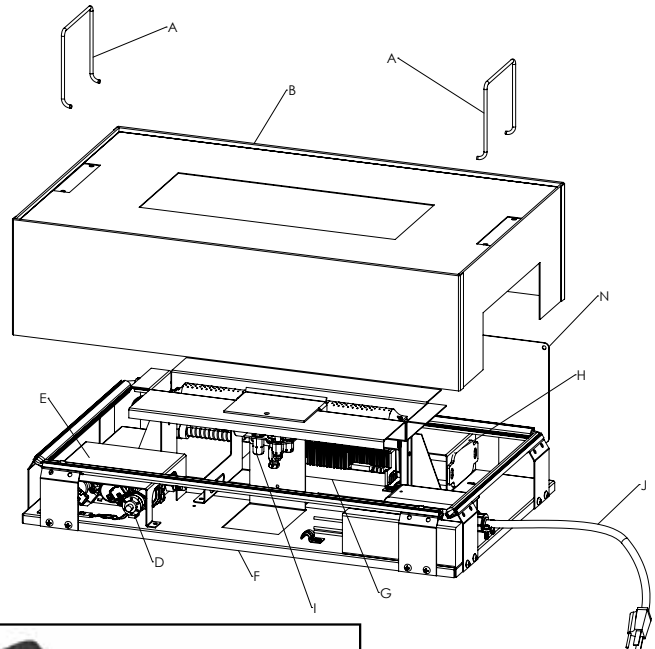

Place Bedrock burner in your fireplace centering the base front to back and side to side. Centering the base allows the case to easily slide over the top of the base. (Figure 1)

Pull up on the handles located on the left and right side of the case. Lift the case and carefully place the case in the fireplace covering the base. Larger units may require two people to install. (Figure 2)

Reflective glass measurements for unit size

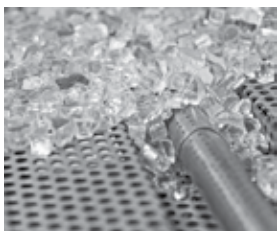

Burner Size	LBS Glass Media Used	Burner Size	LBS Glass Media Used
24"	10 lbs.	72"	30 lbs.
36"	15 lbs.	84"	35 lbs.
48"	20 lbs.	96"	40 lbs.
60"	25 lbs.		