



# OWNER'S MANUAL

DRINK DIFFERENT™



# INTRODUCTION

## Welcome to KUL!

Thank you for joining our mission to build a healthier planet with healthier people.

Please read and follow these instructions carefully and pay attention to the warnings and use of the appliance, especially for the extremely hot water that is dispensed.

If you have young children, pay careful attention to ensure there is always adult supervision and that you are using the safety door lock and parental settings that help keep little hands safe.

If you have questions at any time, we're here to help you. In the USA, call toll-free at 1-833-866-0560. Outside of the USA, dial +1-815-324-4445.

From everyone here at our factory outside of Chicago, we thank you again for your support and wish you the very best of health.

Team KUL



## TABLE OF CONTENTS

<u>Introduction</u>	2
<u>Important Safeguards</u>	4
<u>Requirements</u>	5
<u>Getting to know KUL</u>	6-7
<u>Installation</u>	8-12
<u>Cleaning</u>	13
<u>Replacing Filter</u>	14
<u>Replacing CO2</u>	15
<u>Transporting/Storing KUL</u>	16-17
<u>Warranty</u>	18-19

### ADULT SUPERVISION REQUIRED. SAVE THESE INSTRUCTIONS.



**WARNING:** Do not attempt to repair this appliance without prior contact with KUL Technical Support. Only remove panels when instructed, and only after unplugging the appliance.

- **Choose location with caution – do not place on carts with wheels or light furniture.**
- Always place on secure, flat countertop for stable support of weight.
- **KUL weighs 62 lbs when full.** Check weight limit of furniture before placement.
- **Close supervision is necessary when KUL appliance is used near children.**
- Do not use appliance in any location or manner other than recommended by KUL.
- **Ventilation required.** Leave 2" at sides and top for airflow. Do not enclose in cabinetry.
- Do not place KUL appliance on or near a stove or other hot surfaces.
- **Do not use KUL appliance outdoors;** only use indoors with ambient temperature of 40°F-100°F (4,5°C-37°C).
- **Do not allow the KUL appliance to freeze,** as permanent damage to plumbing and filters will occur.
- Always unplug KUL appliance from the electrical outlet when not in use and before cleaning.
- **Do not clean any KUL parts with anything other than mild soap and water** and a non-abrasive cloth.
- Do not place cloth or other materials under or around the KUL appliance.
- Only use replacement parts, including filters and CO2, from KUL.
- The use of any accessory part not authorized by KUL may cause personal injury and/or damage to the KUL appliance, and will void warranty.
- **Do not use with water that is microbiologically unsafe** or of unknown quality without adequate disinfection before or after the system.
- Systems certified for cyst reduction may be used on disinfected waters that may contain filterable cysts.
- The term "bacteriostatic" indicates that the system limits the passage or growth of bacteria that may already exist in the incoming water. It does not mean that the water leaving the system is safer to drink than the water entering the system.
- Do not operate KUL appliance with a damaged cord or plug.
- **Do not let power cords or plumbing tubing hang over the edge of tables, counters, or touch hot surfaces.**
- To protect against electric shock, do not place the cord, plug, or KUL appliance in water or other liquids.
- Avoid contact with moving parts.
- Make certain that installation complies with all state and local laws and regulations.
- **In the event of any damage, failure or malfunction, contact customer service immediately.**



### **DANGER – PERSONAL INJURY HAZARD** **EXTREME CAUTION should be used regarding HOT WATER.**

- Hot water up to 200° F (96° C) and/or steam can dispense onto hands and/or body, including the face, causing permanent personal injury.
  - Do not dispense hot water with the Faucet Cover removed as scalding may occur.
  - All units are shipped from the factory with a hot safety device which requires two buttons to be pressed in sequence in order to dispense hot water.
  - Use caution when adjusting hot temperature in areas of high elevation, because water will boil at a lower temperature.
  - Optional parental controls and safety door lock available to reduce risk to children.
- CONTACT KUL WITH ANY QUESTIONS AT 1-833-866-0560 (int'l +1-815-324-4445)**

## REQUIREMENTS

### ELECTRICAL & PLUMBING REQUIREMENTS

	USA/CANADA	Export models
Voltage	120VAC, 60hz	230VAC, 60hz
Max amp	10 amps	5 amps
Water supply flow rate*	1.0 gpm	3.8 lpm
Water supply pressure*	35 - 85 psi	2.4 - 5.9 bar
Incoming Temperature	40° - 100° F	4.4° - 37° C

\* for plumbed water supply connections only

### POWER SUPPLY CORD

A short power supply cord is provided to reduce the risks that result from becoming entangled in or tripping over a longer cord.

Longer extension cords may be used if care is exercised in their use. If a long extension cord is used, the marked electrical rating of the extension cord must be at least as great as the electrical rating of the KUL. Also, the longer cord should be arranged so that it does not drape over the countertop or tabletop where it can be pulled on by children or tripped over.

The power supply cord has a polarized plug (one blade is wider than the other). To reduce the risk of electrical shock, this plug will fit into a polarized, grounded outlet only one way. If the plug does not fit fully into the outlet, reverse the plug. If it still does not fit, contact a qualified electrician. Do not modify the plug in any way.

### OPERATING NOTICE & PRECAUTIONS

Carefully fill glasses, cups, and other containers to avoid spillage, either at the KUL or while carrying water to another location.

GETTING TO KNOW KUL

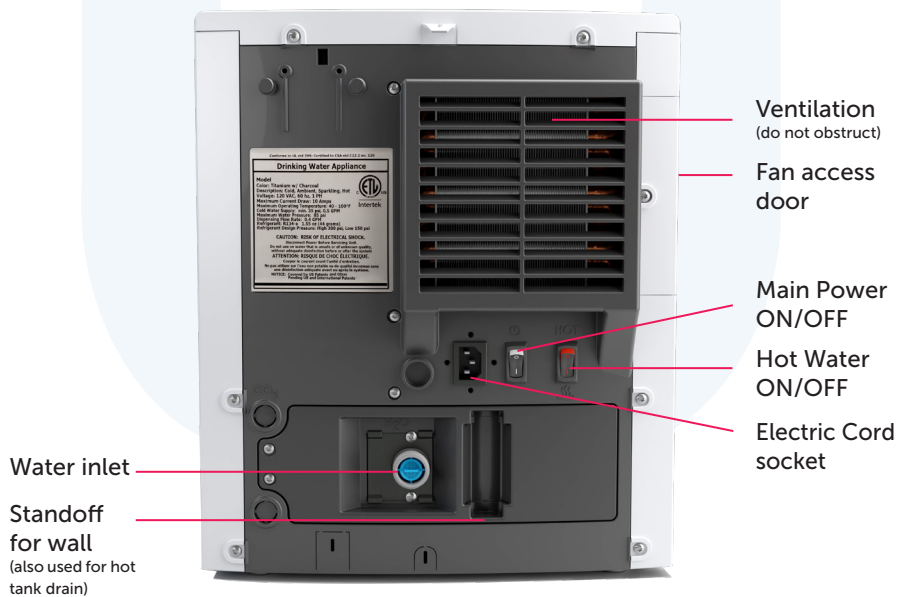

## TOUCH DISPLAY

Quickly get to know some of the unique features that come loaded with your KUL! Explore the different settings and customize KUL to your desired preferences.

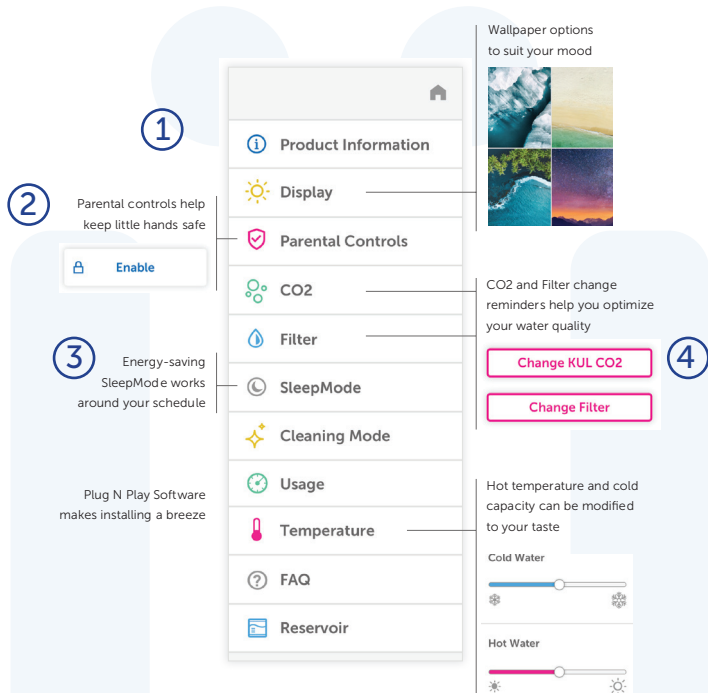

- ① Access serial number and manufacturer information. Forget your passcode? Press and hold the KUL logo in this setting to easily reset your passcode.
- ② With small children around you can never be too careful. Turn on parental controls and kids will not be able to dispense hot water without entering a specially designated passcode.
- ③ Be kind to our planet! Use SleepMode to power down KUL during evenings and/or weekends and save energy. If you're away for extended periods of time, use VacationMode to save even more energy.
- ④ Easily reset timers for filter and CO2 usage.

## INSTALLATION

### LOCATION OF APPLIANCE:

- Place on secure, flat countertop for stable support of weight.
- Do not place on light furniture or carts with or without wheels. Do not place on unstable furniture.
- 36" surface height recommended.
- Refrigeration system requires adequate airflow. Allow 2" on both sides and top of appliance for ventilation. DO NOT enclose appliance inside cabinetry.

### CHOOSE WATER SUPPLY METHOD:



# A

#### SIDEKICK RESERVOIR



Watch  
Install  
Video

**NO PLUMBING REQUIRED  
FOLLOW INSTRUCTIONS  
INSIDE SIDEKICK PACKAGE**



# B

#### PLUMBING CONNECTION

Locate the nearest water supply, consider countertops and required route for water tubing.



Watch  
Install  
Video

**GO TO THE NEXT PAGE FOR  
WATER SUPPLY - PLUMBING  
CONNECTION**

**INSTALLATION VIDEOS ALSO AVAILABLE AT [VERYKUL.COM](http://VERYKUL.COM)**



# WATER SUPPLY - PLUMBING CONNECTION

## TOOLS THAT MAY BE REQUIRED



**IMPORTANT:** A hole may need to be drilled through your countertop for the tubing to connect the appliance to your water supply (under your sink, for example).

**CAUTION:** Identify your countertop material and contact the supplier for advice on drilling or cutting holes. Proceed with caution. If not done correctly, permanent damage may occur to your countertops.

## DIAGRAM OF TYPICAL UNDERSINK INSTALLATION

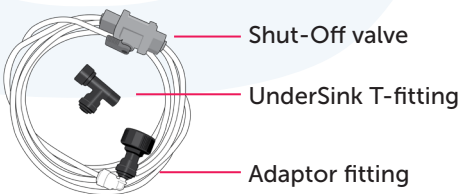
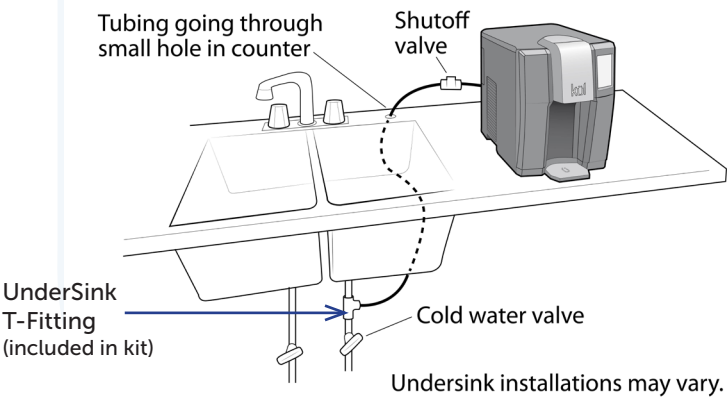

Plumbing install kit  
(included with KUL)

### PLUMBING CONNECTION:

1. Locate nearest cold water supply and plan out your installation (refer to diagram on previous page).
2. Connect adaptor fitting to back of KUL appliance as shown. Hand tighten only, no tools.
3. Thread  $\frac{1}{4}$ " plastic tubing through countertop or to nearest Cold Water Supply Valve.

### BACK VIEW OF KUL

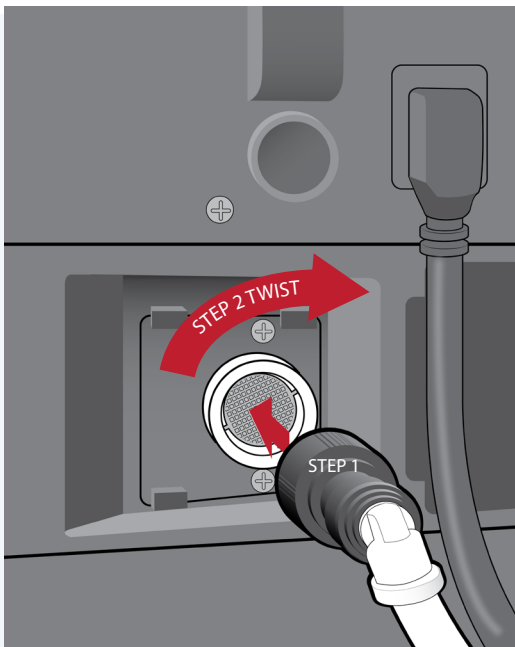

4. Turn off Cold Water Supply Valve and remove Faucet Hose.
5. Connect UnderSink T-Fitting (from kit) to Cold Water Supply Valve.
6. Connect  $\frac{1}{4}$ " plastic tubing to UnderSink T-Fitting (push tubing all the way into the fitting).
7. Turn on Cold Water Supply Valve and check for leaks.

After the water supply is ready, KUL just needs the electric connection and the Plug N Play software takes care of everything else.

### ELECTRIC CONNECTION:

1. Connect the female end of the Electric Power Cord to the back of the KUL.
2. Connect the other end of the Electric Power Cord into a grounded, GFI 120 VAC electrical outlet, or 230 VAC for export models.
3. Turn the Main Power Switch "ON".

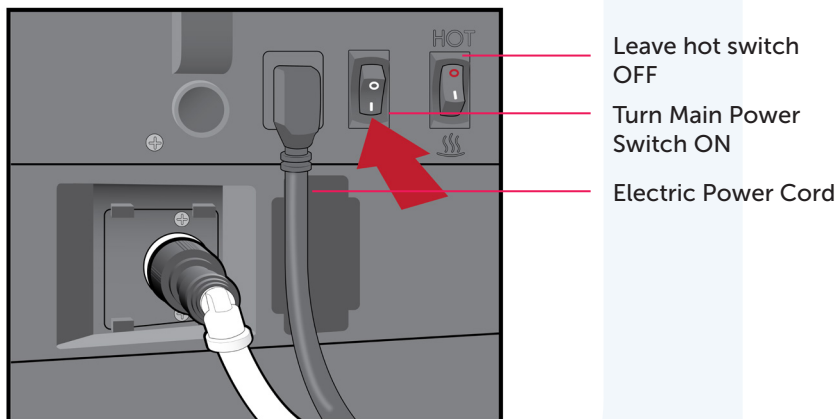

**CAUTION:** Leave Hot Water Switch in OFF position until instructed later in startup.

**NOTE:** It is normal to hear water flowing inside the cooler during the Plug N Play startup sequence.

**CAUTION:** Do NOT leave KUL unattended. If you see a leak or waterflowing OUTSIDE the appliance, disconnect Electrical Power cord immediately and call customer service.

# PLUG N PLAY STARTUP

These are a few of the screens that appear during the startup.

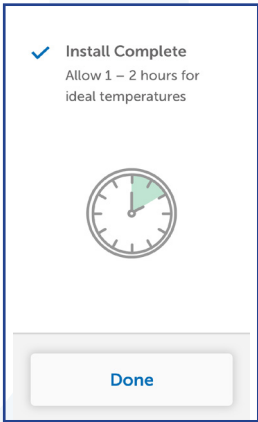
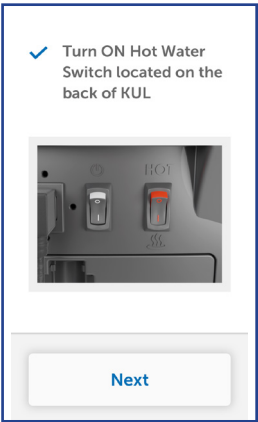
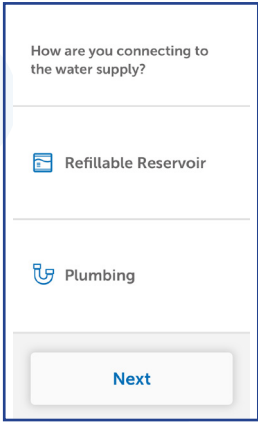
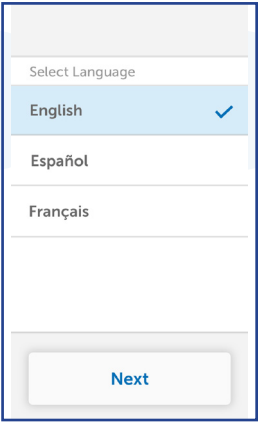
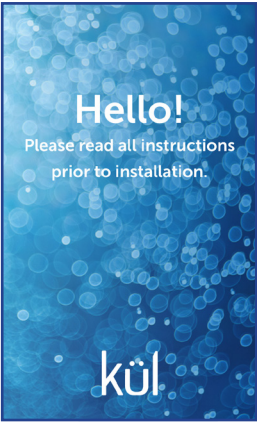

TIP: Make sure to continue to check for any drips or leaks under the sink and behind KUL during setup. Check all tubing connections to ensure a tight fit.  
Never leave KUL unattended while startup is in process.

## THIS CONCLUDES THE INSTALLATION OF KUL

## CLEANING

KUL is designed to be cleaned with mild soap and water only. Do NOT use chemicals or abrasive cleaners as they may damage the finish.

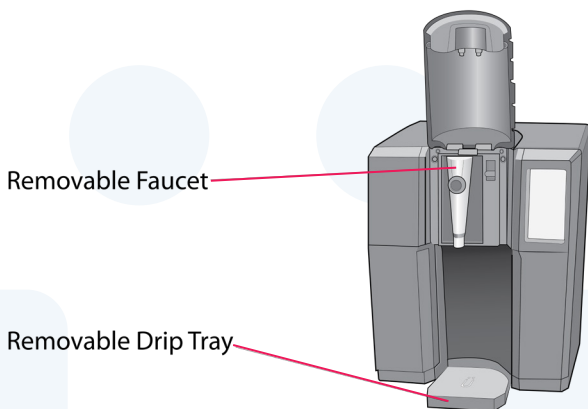

### CLEANING THE FAN

Periodically, you may need to clean the fan, especially if KUL is in a dusty environment.



**CAUTION:** Failure to clean the fan could result in temperature loss or mechanical failure or damage.

**CAUTION:** Turn Main Power Switch OFF - or disconnect Electric Power Cord - before removing panel to clean fan.

The following illustration is provided to indicate the fan location. Go online at [verykul.com](http://verykul.com) for more information and quick video instructions.

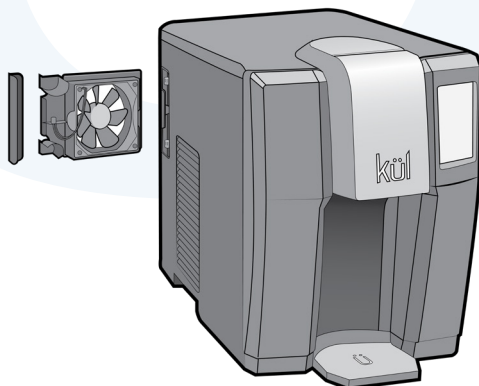

## REPLACING FILTER

KUL tracks your water usage and notifies you when to change the filter.



TIP: Before removing filter, place a towel on the counter just below the filter door.

### REMOVE OLD FILTER

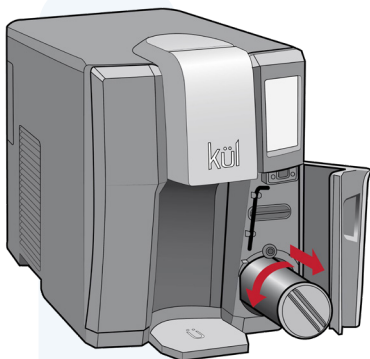

Twist left and pull outward to remove.

Hold filter upright, then place in sink upside down to drain all water.

### INSTALL NEW FILTER

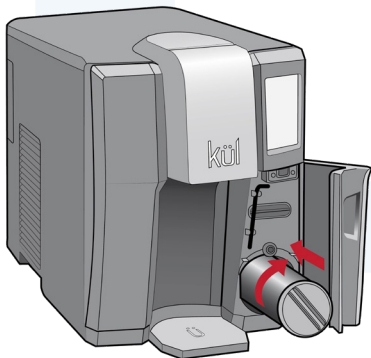

Twist right and push inward to install.

Always flush 1 gallon of water from new filter, by pressing Ambient Water on Touch Display.

Go to Settings/Filter on Touch Display to reset timer.

## REPLACING CO2

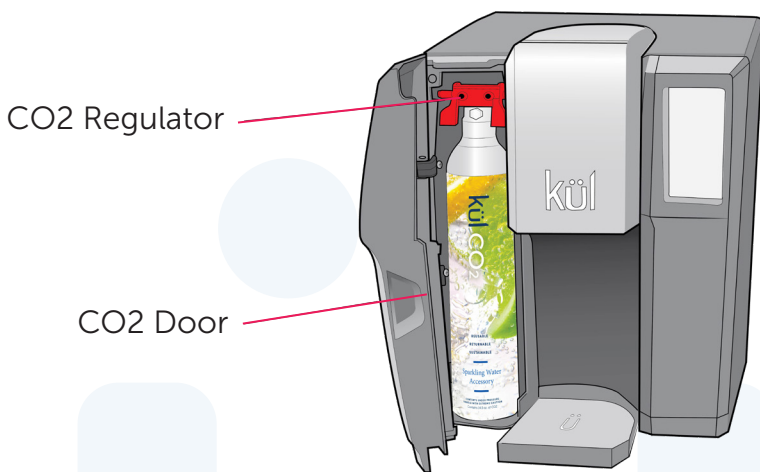

1. Lift Red Regulator Bracket UP.
2. Insert top of CO2 Cartridge into Regulator and firmly twist to the right (clockwise).
3. If turning slowly, you may see and hear some gas escaping. Continue turning to the right until the hissing stops.



**WARNING: DO NOT OVERTIGHTEN. DO NOT use tools or force. Contact technical support immediately with any questions.**



### SAFETY WARNINGS

**DANGER: CONTAINS CO2 UNDER HIGH PRESSURE. MAY EXPLODE IF HEATED.**

- DO NOT expose the cartridge to heat above 110°F/45°C.
- KEEP OUT OF REACH OF CHILDREN.
- INSPECT the cartridge and valve before use for any damage.
- DO NOT USE IF DAMAGED. Return any damaged cartridge to KUL for refund and/or replacement.
- DO NOT TAMPER with this cartridge in any way, including puncturing, incinerating, or removing the valve.
- DO NOT DISPOSE in waste receptacles.
- DO NOT USE with other sparkling water devices or other equipment requiring CO2.
- USE ONLY WITH KUL WATER APPLIANCES according to instructions provided or available online at [verykul.com](http://verykul.com).

## TRANSPORTING/STORING KUL



**WARNING:** Before moving or lifting KUL, you need to drain the water to avoid damage. KUL weighs 62 lbs when full and contains up to 1.5 gallons of water.

Failure to properly drain the KUL before transporting/storing may cause damage, especially in cold climates/seasons where water can freeze.



**TIP:** Instruction videos available at [verykul.com](http://verykul.com)



Hot Water Drain  
**DANGER:** See  
instructions on  
next page

T20 tool      Cold Water  
Drain





To drain all the water from the cooler, you'll need:

- Large bucket
- Towel
- ¼" OD drain tubing (supplied with KUL)

1. Turn the Hot Water Switch OFF on back of appliance. Leave Main Power Switch ON.
2. Press Hot Water on Touch Display to dispense about 0.5 gallons (2 liters) of hot water, until water from faucet is cool indicating no further hot water is inside hot tank.
3. Turn Water Shutoff Valve to OFF position.
4. Press Sparkling Water until no water is dispensed from faucet.
5. Press Cold & Ambient until no water is dispensed from faucet.
6. Turn Electric Power Switch OFF.
7. Remove CO2 cartridge from appliance.
8. Remove filter from appliance.



**TIP :** Before using T20 tool and removing drain plug, place towel and bucket directly below the appliance. Arrange ¼" drain tubing with one end in the bucket and the other end ready to insert into drain connection.

9. Remove Cold Water Drain Plug with T20 tool and quickly insert ¼" tubing into drain opening.

**Note:** There may be up to 1.5 gallons (5 liters) of water draining into bucket.

10. Replace Cold Water Drain Plug.
11. Remove Hot Water Drain Plug and quickly insert ¼" tubing into drain opening to drain water into bucket.
12. Replace Hot Water Drain Plug.

END OF PROCEDURE



**DANGER:** DO NOT remove hot water drain plug without first turning Hot Water Switch OFF on back of appliance, and then pressing Hot Water on the Touch Display to dispense about 0.5 gallons (1.9 liters) of hot water, until water from faucet is cool and no further hot water is inside hot tank.

# LIMITED WARRANTY

## YOU'RE PART OF OUR FAMILY

Thank you for choosing KUL products. We work hard to provide the highest quality products while also ensuring the highest customer satisfaction. However, if you do experience a problem, we're here to help.

## LIMITED WARRANTY

**Our Commitment to You:** KUL warrants all parts to the original purchaser to be free of defects in materials and workmanship under normal use and within the operating specifications of the products, for a period of one (1) year. For KUL drinking water appliances, we provide an additional three (3) year limited warranty on the hot water system, and a five (5) year limited warranty on the sealed refrigeration system. This limited warranty covers defective parts only.

**How to Get Assistance:** If the product fails to perform correctly, and service is required call us at 1-833-866-0560 (internationally at +1-815 324-4445) and our trained technical support team will help you resolve the issue over the phone. When you call, please be ready to provide the serial number of the product. Depending on the problem, we can ship replacement parts and repair instructions direct to your location.

**What's Not Covered:** Replacement filters and maintenance parts; all labor charges, including but not limited to, services related to installation, adjustment, removal, replacement, maintenance, and/or repair of the product or its components; and incidental and consequential damages (see below).

Do not use with water that is microbiologically unsafe or of unknown quality without adequate disinfection before or after the system. The manufacturer does not know the characteristics of your incoming water supply. The quality of your water supply varies over time and with different geography.

This limited warranty does not cover malfunctions of products due to tampering, misuse, alteration, lack of regular maintenance, misapplication, fouling due to local water supply characteristics, scaling from hardness minerals, improper plumbing external to the product, or use of unauthorized accessories.

## LIMITED WARRANTY

In addition, damage to the product due to fire, flood, accident, negligence, act of god, or events beyond the control of the manufacturer are not covered by this limited warranty.

**Incidental and consequential damages limitation:** The manufacturer will not be responsible for any incidental or consequential damages as a result of the failure of this product to comply with express or implied warranties or any defect in the unit, including but not limited to, lost time, inconvenience, damage to personal property, loss of revenue, commercial losses, postage, travel, telephone expenses, or other similar losses. Some states do not allow the exclusion or limitation of incidental or consequential damages, so this exclusion may not apply to you.

**Owner's warranty responsibilities:** As a condition of this limited warranty, the owner must ensure the product is installed in accordance with the installation instructions provided. In addition, the owner is responsible for periodic maintenance of the product as described in the literature enclosed with the product – i.e. replacing filters, cleaning fans, etc. Neglect, improper maintenance, abuse, modification or alteration of the product will invalidate this warranty.

**State laws:** This limited warranty gives you specific rights, you may also have other rights which vary from state to state. Some states do not allow the exclusion or limitation of incidental or consequential damages, so the above may not apply to you.

No other warranty or guarantee is made by KUL Refreshment, Inc. Any implied warranty of merchantability is limited to the duration of the express limited warranty and thereafter is disclaimed. KUL Refreshment, Inc. expressly disclaims any implied warranty of fitness for a particular purpose.

No dealer or reseller is authorized to modify the terms of this limited warranty. Any additional warranty offered by a dealer or reseller is the sole responsibility of the dealer or reseller. This warranty is offered to the first purchaser and is not valid for subsequent purchasers and owners.



This warranty and UL/ANSI/ETL Electrical Safety listing are automatically voided if the product is altered, modified, or combined with any other product or device. Alteration or modification of the product can cause serious flooding and/or hazardous shock or fire.



# kül™

**Customer Service** +1-815-324-4445 | **Technical Support** +1-833-866-0560

[www.verykul.com](http://www.verykul.com)

