

ETOE



Projector A1172 User Manual



- Quick Guide
- Kurzanleitung
- Guida rapida
- Guida rapide
- Guía de inicio rápido
- クイックガイド

🔍 : etoeofficial.com/pages/guide



- Please contact us via:
- Veuillez nous contacter via:
- Si prega di contattarci tramite:
- Bitte nehmen Sie Kontakt mit uns durch:
- Póngase en contacto con nosotros a través de:
- 次の方法でお問い合わせください:

🔍 : etoeofficial.com/pages/contact

✉ : support@etoeofficial.com

Safety Instructions

Read all instructions before you use this device. Do not make any changes that are not described in this manual. If physical injury, loss of data, or damage is caused by failure to follow instructions, the warranty does not apply.

Setup

- To reduce the risk of fire and/or electric shock, do not expose the device to rain or moisture, and objects filled with liquids, such as vases, should not be placed on the device.
- Do not place the device on soft surfaces such as tablecloths or carpets as doing so could be a fire-hazard.
- Do not place the device in areas susceptible to excessive dust and dirt or near any appliance generating a strong magnetic field.
- To prevent overheating, do not block or clog the ventilation openings. Never place the device in a confined space. Always leave enough space around the device for ventilation.
- Protect the device against direct sunlight, heat, large temperature fluctuations and moisture.
- When the device runs for a long period of time and the surface becomes hot, shut it down and unplug the power cord. Resume operation only after the device has cooled.
- Always handle the device with care. Avoid touching the lens.
- Never place heavy or sharp objects on the device or the power cord. To avoid electric shock, do not disassemble.
- Only use attachments or accessories specified by the manufacturer. Avoid extreme vibration. It may damage the internal components. Do not allow children to handle the device without supervision.
- Under the following conditions, a layer of moisture can appear inside the device which can lead to malfunctions:
 - a) if the device is moved from a cold to a warm area;
 - b) after a cold room is heated;
 - c) when the device is placed in a damp room.To avoid any moisture, seal the device in a plastic bag before moving it to another room, and wait for one to two hours before you take it out of the bag.

Power Supply

- Use only the provided power adapter.
- Power off the device before removing the power supply from the socket.
- Protect the power cord from being walked on or pinched, particularly at plugs, convenience receptacles, and the point where they exit from this device.
- Unplug this device if there are lightning storms or when unused for a long period of time.
- Where the power plug or an appliance coupler is used as the disconnect device, the disconnect device shall remain readily operable.
- Before you make or change any connections, ensure that all devices are disconnected from the power outlet.
- Do not touch the power cable or the power connector with wet hands.

Hearing Safety

To avoid hearing damage, do not listen for extended periods at high volume. Set the volume at a safe level.

Cleaning

- Power off the device and remove it from the power supply before cleaning the surface.
- Use a soft, lint-free cloth. Never use liquid, gaseous, or easily flammable cleansers (like sprays, abrasives, polishes, and alcohol). Wipe over the surfaces gently. Be careful that you do not scratch the surfaces.
- Do not use any liquid cleaning agents to clean the lens as they may damage the protective coating on the lens. Use lens cleaning paper to clean the lens of the projector.

Repairs

- Do not make any repairs to the device by yourself. Only have your device repaired by an authorized service center.
- Improper maintenance can result in injuries or damage to the device.
- Refer all servicing to qualified service personnel.

Caution

- Do not stare at operating beam. The bright light may hurt your eyes.

What's included

Projector x 1



Adapter x 1



Adapter AC cord x 1



Remote control x1



User manual x 1

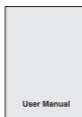

Overview

Front View

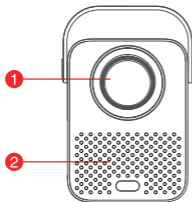

Rear View

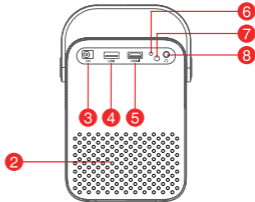

- ① Lens
- ③ DC in
- ⑤ HDMI 1.4 port
- ⑦ IR receiver
- ⑨ Power
- ⑪ Pads

- ② Air ventilation (outlet)
- ④ USB 2.0 port.
- ⑥ Indicator
- ⑧ 3.5mm AUX
- ⑩ Focus adjusting knob
- ⑫ Tripod screw hole

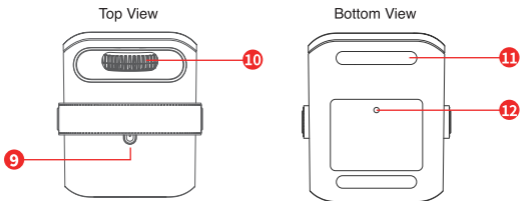

Attention:



- Please do not look into the lens directly to avoid harm for your eyes.
- Please do not block the air ventilation (outlet).

Remote Control

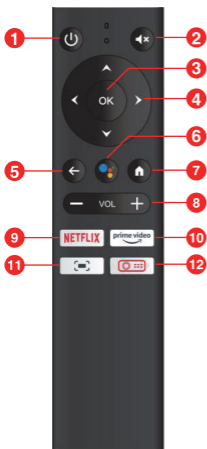

- Press the button once: power on
 - Press the button twice: power off
- Mutes the projector's audio
- OK**
Press to confirm a selection or entry
- ▲▲▼▼**
Navigate menus or adjust the selected content
- ←**
Return to the previous menu
- Activate Google assistant, Google's voice-powered virtual assistant service
- 🏠**
Press the button for once, go to Android TV homepage
- +**
Volume down / up
- NETFLIX**
Preset Netflix button
- prime video**
Preset Prime Video button
- []**
Press to launch the shortcut menu
- 🏠**
Press the button once, go to projector Homepage

Get Started

Placement

- ① Place the projector right towards the projection surface to get a rectangle picture.
- ② The distance between the projector and the projection surface determines the picture size.
- ③ Check the projection distance and screen size on specifications part.

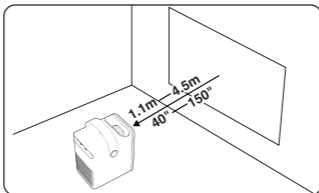

Prepare the Remote Control

Install the remote control batteries (batteries not included).

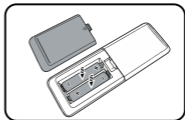
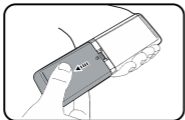

- ① Press and open the battery cover, as illustrated.
- ② Install two AAA batteries. Make sure that the positive and negative ends are positioned correctly, as illustrated.
- ③ Place the battery cover back until it clicks into place.

Power On

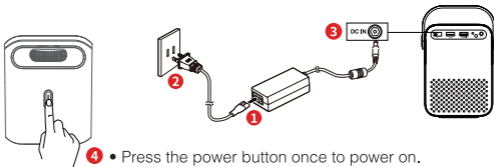

- Press the power button once to power on.
- Press the power button twice to power off.

Focus

- ① Place the projector towards a suitable projection surface or wall, adjust the distance for a proper size of picture.
- ② Scroll the [Focus Adjusting Knob] left or right until the picture is crystal clear.

Note: The projection distance must be between 1.1m to 5.4m

Select Your Language

When start the projector for the first time, you will be guided to a page to select language, use remote control ▲ or ▼ to select your language. Then press the right button ► and select "Complete" to enter the next page.

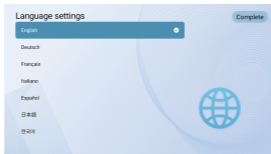

Pair Remote Control in Bluetooth Mode

After selecting a language, you will be at a Bluetooth remote pairing page, follow the instructions on the page.

- ① Please hold the remote near the projector.
- ② Press the [Volume-] and [OK] keys together for about 10 seconds.
- ③ When the screen shows "**Connected**", your remote LED indicator turn to blue, and the remote control is paired



Set up Android TV

Follow the setup wizard on Android TV, select your language, set up a Wi-Fi connection, sign in to a Google account, and carry out other related procedures.

When you complete the Android TV setup wizard, the Android TV home screen will appear. Now you can start watching your favorite shows by downloading streaming apps.

Settings

Go through the set-up process when you turn on the projector for the first time.

Android TV Setting

Bluetooth pairing

If you want to connect to Bluetooth speakers/headphones on the Android TV interface, select **Settings**→**Remotes&Accessories**→**Add accessory**, then select the device to be connected. Bluetooth connection only works while on the Android TV system.

Android TV Remote App

The Android TV system could be controlled by downloading the remote app on a smartphone.

Make sure your device is connected to the same Wi-Fi network as the projector, Bluetooth is turned on, and your Android/iOS device is updated to the newest version.

- **Android devices:**

Download the "Android TV Remote" app from Google Play, open the app, choose "HAKO mini" from Remote tab, click "connect", enter the verification code displayed on the projector screen.

- **iOS devices:**

Download the "Android TV" app from the App Store, open the app, allow it to use the local network to set up and control your connected devices, choose "HAKO mini" from Remote tab, click "connect", enter the verification code displayed on the projector screen.

Adding Accounts

For new Google users, sign up for a new Google account using the TV for easier login and payment security. Add an account or switch accounts under Accounts in the Settings Menu.

Dolby Audio not supported

the projector does not support Dolby Audio. If you are watching videos with Dolby Audio, please turn off all Dolby Digital-related output on your video resource.

Projection settings

Press the button  on the remote control, go to projector homepage, and select **Settings**.

Projection mode



Desktop Front Projection



Ceiling Front Projection



Desktop Rear Projection



Ceiling Rear Projection

Zoom in/out

Use the remote control to resize the picture size from 50% to 100% without moving the projector.

Keystone correction

- Digital Keystone Correction

The keystone effect refers to when the projected image is noticeably wider at one side. It occurs when the projector is not perpendicular to the screen. To correct the keystone effect, press the button  to go to projector homepage, and select **Settings** → **Projection Settings** → **Vertical Correction/Horizontal Correction** to adjust.

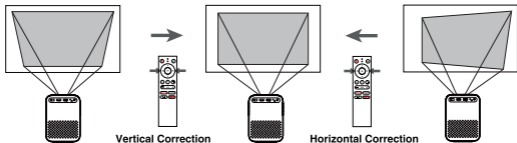

- **Four Point Correction**

If the projected image is stretched or distorted along both axes due to the angle of the projection, select **Settings** → **Four Point Correction**, choose the corner you want to adjust, and follow the on-screen instructions to correct the image.



Keystone correction reset

To restore the default settings, select **Keystone Correction Reset** and press "OK".

Other settings

Screen Saver

The screen saver automatically starts whenever your projector sits idle for the default time. You could change the default time or turn it off.

Screensaver Video

Select default screen saver video.

Screensaver Timeout Shutdown

Set the shutdown timer for the projector.

Language Settings

Select an on-screen display language.

Restore Factory Settings

Reset your device and restore factory setting.

Chromecast (wireless connection)

The Chromecast feature only works while you are in the Android TV system.

- **Cast from Chromecast-enabled sites/apps (for Android/iOS devices)**

- ① Make sure your device and the Android TV (HAKO mini) are connected to the same Wi-Fi network, and that you are running the latest version of the Chromecast-enabled app.
- ② Launch the Chromecast-enabled site/app.
- ③ Tap the cast button  and choose the "HAKO mini".

- **Cast from Chrome browser tab (for computers)**

- ① Connect your computer and projector to the same Wi-Fi network.
- ② Click "Cast" at the top right  of the Chrome browser tab, and then choose from the sources whether you want to cast the tab or the screen.
- ③ Choose the "HAKO mini" to cast.

- **Mirror from Android devices**

- ① Make sure your Android device is on the same Wi-Fi network as your Android TV (HAKO mini) .
- ② Download the "Google Home" app  on your Android device.
- ③ Open the "Google Home" app, choose "HAKO Mini".
- ④ Tap "Cast my screen".

- **Mirror from iOS devices**

- ① Make sure your iOS device is connected to the same Wi-Fi network as your Android TV (HAKO mini) .
- ② Download the "AirScreen" app  from the Google Play Store of Android TV system.
- ③ Open the "AirScreen" app and follow the on-screen instructions on AirScreen.

Wired Connections

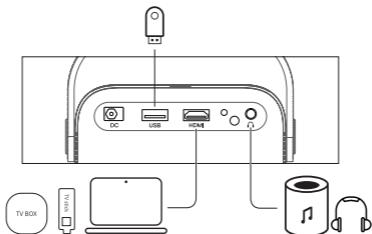

1. Connect to an HDMI playback device

This projector supports connections with various HDMI playback devices such as PC, TV stick, TV box, DVD player, set-top box (STB), game console or other devices.

- ① Connect this projector to an HDMI playback device with an HDMI cable (not provided).
- ② Press the button  on remote control to go to projector homepage, select **[HDMI]**, and press **[OK]**.

2. Connect to a flash drive

With this projector, you can enjoy music, video, and pictures, that are stored on a USB storage device.

- ① Plug in the USB storage device.
- ② Press the button  on remote control to go to projector homepage, select **[USB]**, and press **[OK]**.
- ③ Select the file you plan to play from the file and folder menu.
- ④ Press **[OK]** to start playing.

3. Connect to a headphone via AUX cable

You can connect a headphone or speaker to ETOE Projector via AUX cable as well.

- ① Plug in the 3.5mm AUX cable connector to ETOE projector AUX port.
- ② Plug the other connector of the 3.5mm AUX cable to your headphone or speaker.
- ③ Play your media on projector.

Shortcut Menu

Long-press the [■] button to pop up the shortcut menu

- Press navigation button to select the option
- Press ► button to go to the next page
- Press ◀ or ▶ button to adjust parameter
- Press "OK" button to save

Image Mode	Standard	Keeps natural looking colors with a balance of warm and cool tones
	Light	Provides more picture details and color sharpness
	Soft	Provides warm colors with lower light
	Personal	Manually set the Brightness, contrast, Saturation, Sharpness and Hue
Color Temp	Cold	Provides cold color temp
	Normal	Provides normal temp
	Warm	Provides warm temp
	Personal	Manually set the Red, Green and Blue
Sound Mode	Standard	Provides standard tones
	Music	Provides more detailed tone
	Movie	Provides home theater-style sound
	Personal	Manually set the sound of each frequency band
Projection Setting	Zoom In/Out	Zoom in or out of the projection image
	Vertical Correction	Perform keystone correction
	Horizontal Correction	
	Four Point Correction	
Keystone Correction Reset	Reset keystone correction	

Specifications

Specifications

CPU: ARM Quad 64-bit Cortex-A53
 Android OS: Android™ 10.0
 Bluetooth: Bluetooth 5.1
 Wi-Fi: 2.4G/5 G Hz 802.11a/b/g/n/ac
 Native Resolution: 1920*1080
 Throw Ratio: 1.22
 Contrast Ratio: 3000:1
 Aspect Ratio: 16:9/4:3 Adaptive
 Speaker: 3W*2 Stereo Speaker
 Connection Port: HDMI*1; USB*1; AUX*1
 Projection Size: 40"-150"
 Zoom: 50%-100%
 Keystone Correction: ±45°
 Recommended Ambient: 41°F to 95°F/5°C to 35°C
 Relative Humidity: 15%~85% (non-condensing)
 Warranty: 12-Month

Warranty

30-Day Money-Back Guarantee for Any Reason

You may return your undamaged product within 30 days of the date of purchase to receive a full refund for any reason.

For non-quality related warranty claims, the buyer is responsible for shipping costs.

12-Month Warranty for Quality-Related Issues

Every ETOE product comes with one year of quality-related issues coverage.

If you submit a claim to our support mail, ETOE will, at its option:

1. Replace the ETOE Product with a replacement product of the same model and cover any return shipping costs.
2. Exchange the ETOE Product for a refund of your purchase price.

Projection distance and Screen Size

Screen size (inch)	Width (inch)	Width (cm)	Height (inch)	Height (cm)	Distance (cm)	Distance (ft)
40	34.9	88.6	19.6	49.8	108.0	3.5
60	52.3	132.8	29.4	74.7	162.1	5.3
80	69.7	177.1	39.2	99.6	216.1	7.1
100	87.2	221.4	49.0	124.5	270.1	8.9

FCC Notice

This device complies with the FCC rules, Part 15. Operation is subject to the following two conditions: (1) This device may not cause harmful interference, and (2) This device must accept any interference received, including interference that may cause undesired operation.

Warning: Changes or modifications not expressly approved by the party responsible for compliance could void the user's authority to operate the equipment.

Note: This equipment has been tested and found to comply with the limits for a Class B digital device, pursuant to part 15 of the FCC Rules.

These limits are designed to provide reasonable protection against harmful interference in a residential installation.

This equipment generates, uses and can radiate radio frequency energy and, if not installed and used in accordance with the instruction energy and, if not installed and used in accordance with the instruction manual, may cause harmful interference to radio communications.

However, there is no guarantee that interference will not occur in a particular installation. If this equipment does cause harmful interference to radio or television reception, which can be determined by turning the equipment off and on, the user is encouraged to try to correct the interference by one or more of the following measures:

- Reorient or relocate the receiving antenna.
- Increase the separation between equipment and receiver.
- Connect the equipment into an outlet on a circuit different from that to which the receiver is connected.
- Consult the dealer or an experienced radio / TV technician for help.

RF Exposure Warning Statements

This equipment complies with FCC radiation exposure limits set forth for an uncontrolled environment. This equipment should be installed and operated with minimum distance 20cm between the radiator & your body.

ETOE

Model: A1172

© ETOE Technology Limited.

All rights reserved. ETOE and the ETOE logo are trademarks of ETOE Technology Limited, which is registered in the United States and other countries. All other trademarks are the property of the irrespective owners.

Manufacturer: HUNAN ETOE Technology Co., Ltd

Address: Room 603, Building 3, Zone A, Jindaoyuan, NO.169, Huizhi Zhong Road, High-tech District, Changsha

E-mail: support@etoeofficial.com

Made in China

