

Max. Amp: 12V - 5A / 24V - 4A

Wire Gauge: 18 AWG - 20 AWG

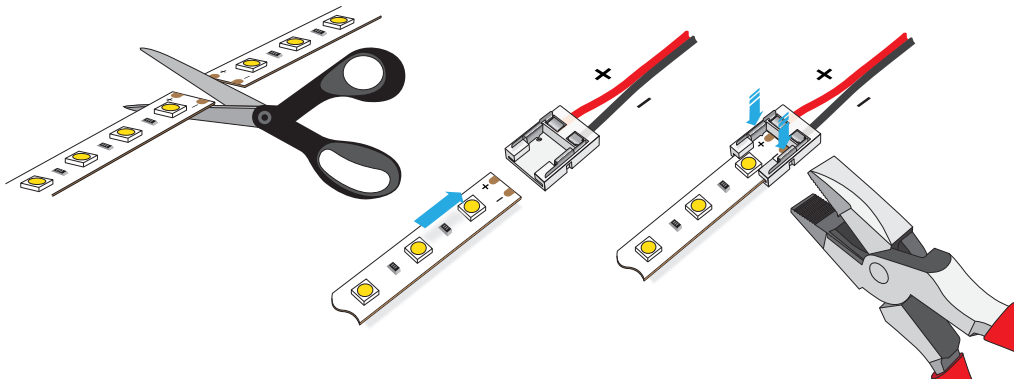

**1** CUT STRIP LIGHT  
AT CUTTING POINT

**2** INSERT STRIP LIGHT  
INTO THE CONNECTOR

**3** PUSH DOWN METAL PLATES  
ON BOTH SIDES TO SECURE  
THE CONNECTION