

## ST0130KWH - ST0130KBK Horizontal LED Step Lights

This 120V voltage recessed LED step light is ideal for walls or in steps. Recessed lights in those areas provide edge lighting that adds sleek sophistication to contemporary and modern staircases. The air gap between the housing can and the light fixture creates an insulating effect that keeps the outer can cooler.

### SPECIFICATIONS



<b>Voltage:</b>	120V AC
<b>Wattage:</b>	5W
<b>Color Temperature:</b>	3000K (Warm White)
<b>Brightness:</b>	75 Lumens
<b>Rendering Index:</b>	CRI>90
<b>LED Type:</b>	Integrated LED
<b>Engine Material:</b>	PVC
<b>Face Plate Material:</b>	Die-Cast Aluminum
<b>Available Face Plate Colors:</b>	Matte Black and White
<b>Rated Life:</b>	50,000 Hours
<b>Dimmable:</b>	Yes (Triac Dimming)
<b>Installation:</b>	Outlet Box Recessed
<b>IP Rating:</b>	IP65 (Wet Locations)
<b>Outer Dimensions:</b>	120 x 80 x 13 mm x (4.7 x 3.16 x 0.5 in)
<b>Outlet Box Dimensions:</b>	46 x 46 x 28 mm (1.8 x 1.8 x 1.1 in)
<b>Package Dimensions:</b>	135 x 87 x 50 mm (5.3 x 3.4 x 2 in)
<b>Package Weight:</b>	0.250 Kg
<b>Certification:</b>	FCC/ETL/Energy Star/RoHS

Name: \_\_\_\_\_

Quantity: \_\_\_\_\_

Phone: \_\_\_\_\_

Email: \_\_\_\_\_



Model: ST0130KWH

SKU: 666561426590



Model: ST0130KBK

SKU: 666561426606

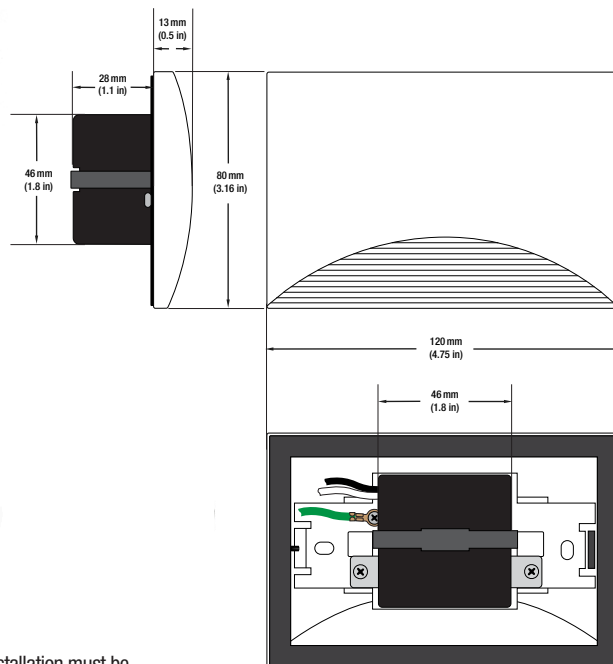
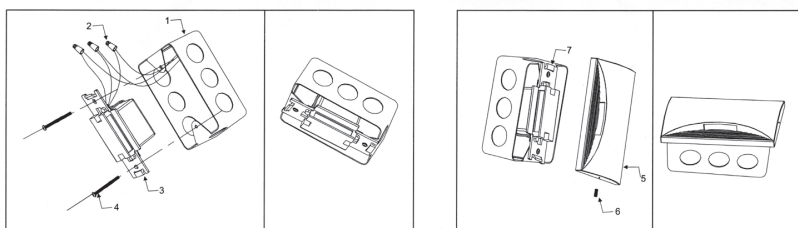

### Included Content:

- 1x Step Light (Black or White)
- 1x Installation Instruction Manual
- 3x Wire Connectors
- 2x Mounting Screws
- 1x Hexagon Socket Screw
- 1x Allen Key



### Safety and Warning

The fixture must be wired in accordance with local and national electrical codes and standards. And all the installation must be done by a certified electrician. Please be sure the main power switch is OFF before the installation, inspection, or removal. It is strictly necessary to ground the outlet box properly. Furthermore, the integrated LEDs in the light fixture can not be replaced.