

SKU NUMBER:: K-GTS1BK1

COLOR: BLACK

kaja audio

GO-TO'S USER MANUAL

PACKAGE CONTENTS

- 1 PAIR OF EARBUDS (INSIDE CHARGING CASE)
(SIZE MEDIUM SILICONE EAR-TIPS ARE PRE-INSTALLED)

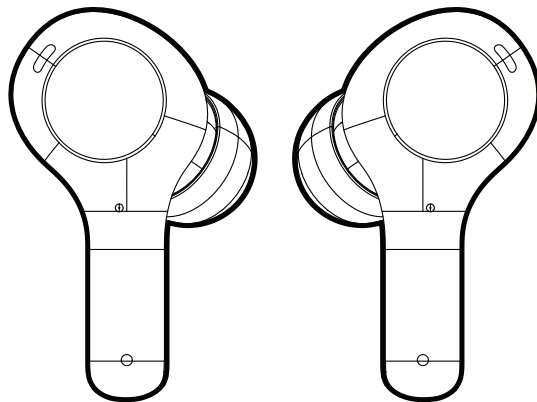

- 1 CHARGING CASE

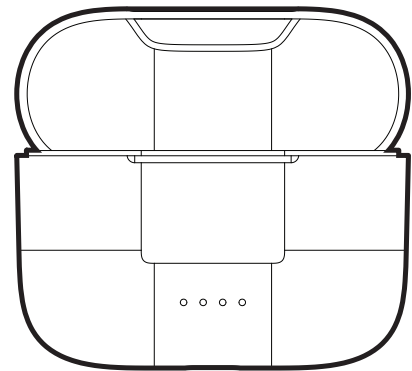

- 2 PAIRS OF EXTRA SILICONE EAR-TIPS
(INSIDE SEALED BAG)

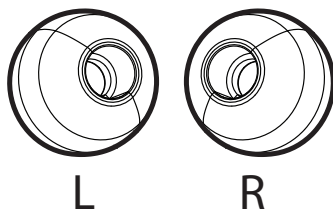

- 1 USB-C CHARGING CABLE

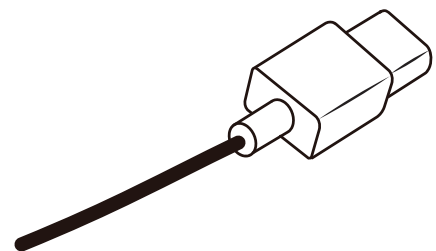

1 USER MANUAL (ALSO ACCESSIBLE ONLINE AT KAJAAUDIO.COM)

PRODUCT OVERVIEW

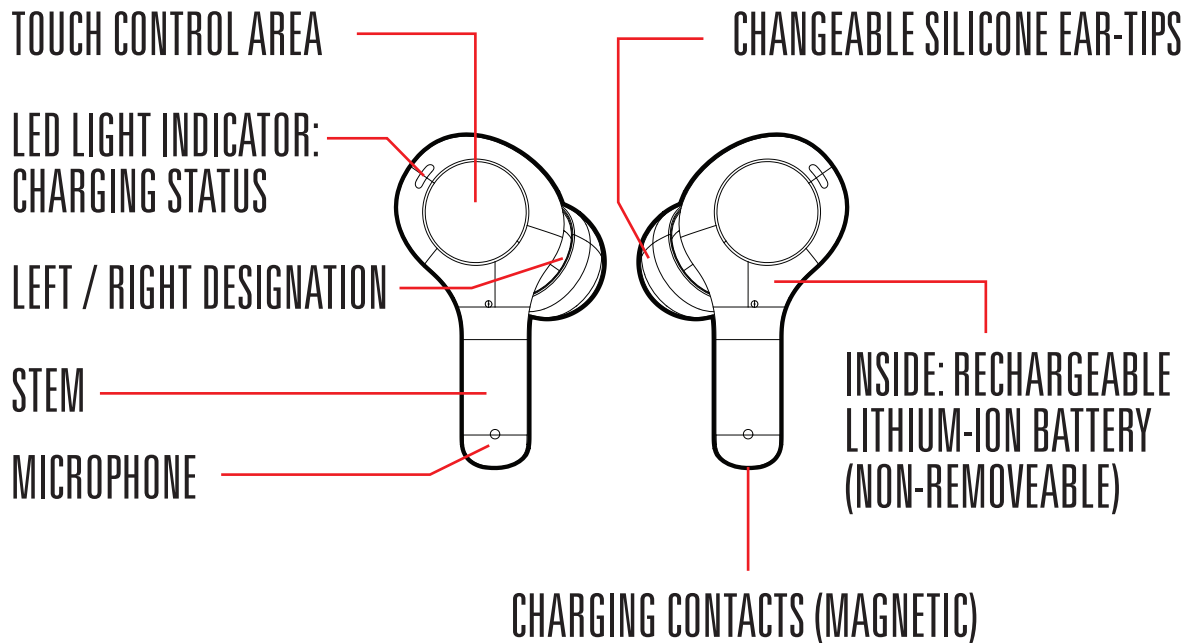
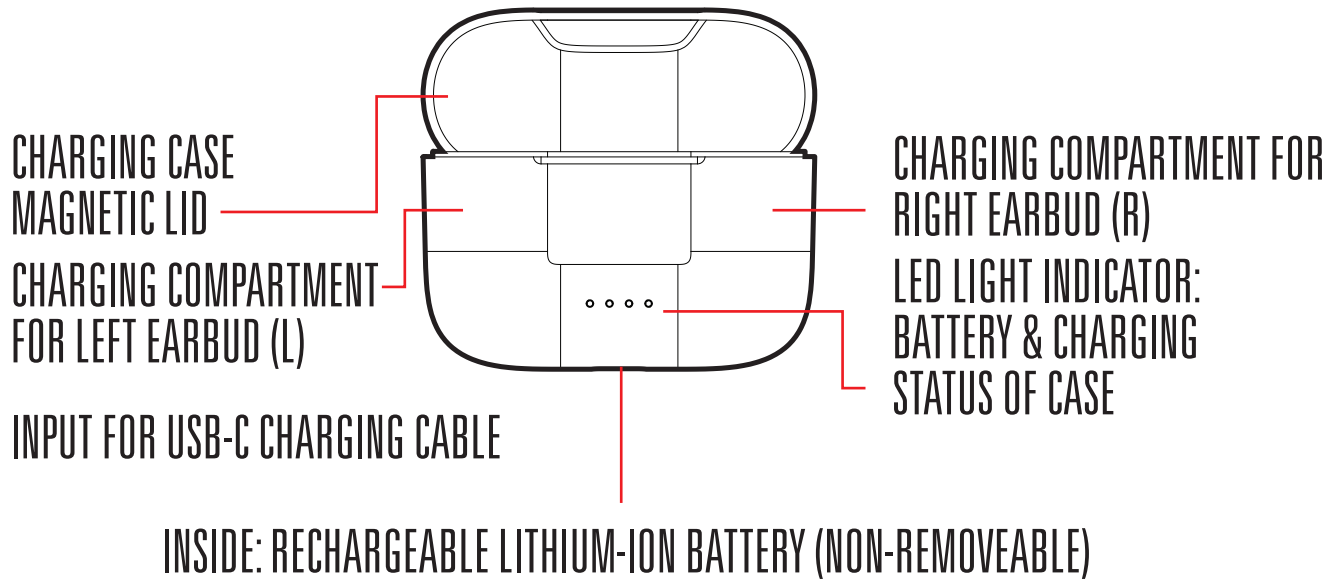

FINDING THE BEST FIT

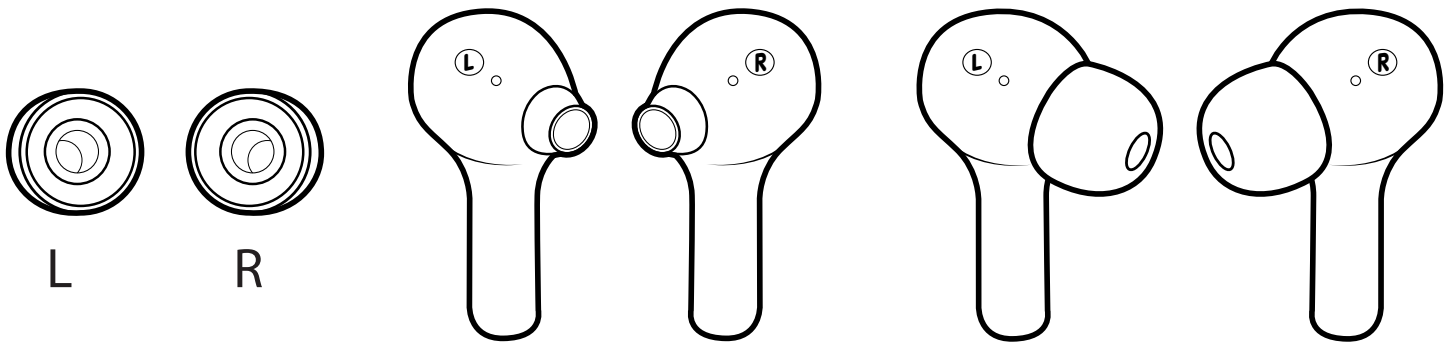

CHOOSE THE PAIR OF EAR-TIPS THAT BEST FIT YOU: SIZE SMALL (S), MEDIUM (M), OR LARGE (L). (NOTE THAT SIZE MEDIUM EAR-TIPS ARE PRE-INSTALLED ON THE EARBUDS, AND THAT EACH PAIR OF EAR-TIPS ARE IDENTICAL AND THUS INTERCHANGEABLE BETWEEN THE LEFT AND RIGHT EARBUDS.)

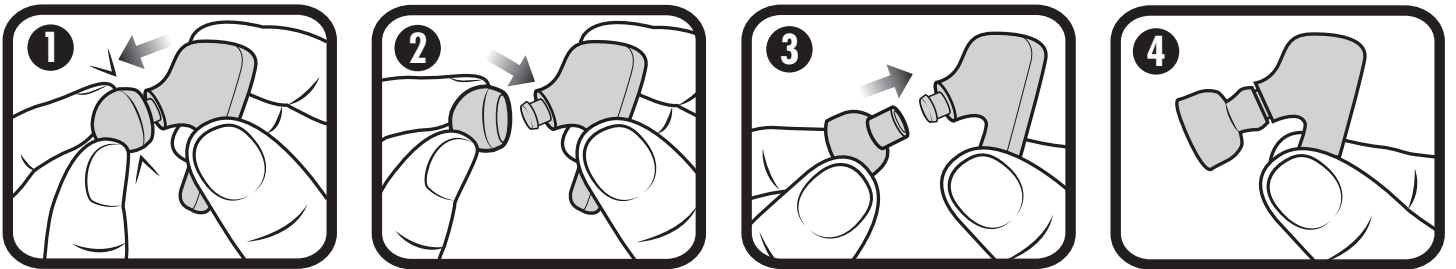

HOW TO CHANGE EAR-TIPS:

- STEP 1: REMOVE BY PINCHING THE INSTALLED EAR-TIP AND PULLING IT OFF THE EARBUD.
- STEP 2: TAKE THE DESIRED EAR-TIP, FLIP ITS HEAD INSIDE-OUT, AND LINE THE BACK OF IT UP TO THE EARBUD'S CONNECTOR.
- STEP 3: GENTLY PUSH THE EAR-TIP UNTIL IT'S SITTING FLUSH WITH THE CONNECTOR. YOU MAY NEED TO ROTATE THE EAR-TIP AS YOU PUSH.
- STEP 4: FLIP THE EAR-TIP HEAD BACK TO ITS ORIGINAL SHAPE. NOW THE EARBUD IS READY TO USE.

HOW TO WEAR

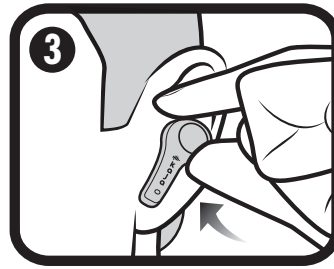
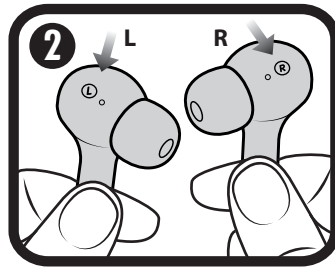
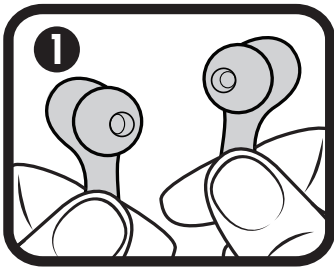

TO ACHIEVE THE BEST LISTENING EXPERIENCE:

- STEP 1: MAKE SURE EAR-TIPS ARE INSTALLED PROPERLY ON BOTH EARBUDS.
- STEP 2: IDENTIFY LEFT EARBUD (L) AND RIGHT EARBUD (R).
- STEP 3: INSERT EACH EARBUD AT A SLIGHT ANGLE INTO THE CORRESPONDING EAR. THE STEM OF EACH EARBUD SHOULD BE ANGLED TOWARDS YOUR JAWLINE (NOT POINTING DIRECTLY TOWARDS THE GROUND).
- STEP 4: TWIST EACH EARBUD SLIGHTLY INTO THE EAR CANAL UNTIL IT SITS COMFORTABLY AND SECURELY.

NOTE THAT PERCEIVED SOUND QUALITY, BASS PERFORMANCE, AND ENVIRONMENTAL NOISE CANCELLATION ALL LARGELY DEPEND ON THE BEST FIT, PROPER WEARING POSITION, AND PROPER USAGE OF THE EARBUDS.

POWERING EARBUDS ON & OFF

POWERING ON:

WHEN OPENING THE CHARGING CASE AND TAKING OUT THE EARBUDS, THE EARBUDS WILL AUTOMATICALLY TURN ON AND START PAIRING. (IF THEY DO NOT AUTOMATICALLY TURN ON, CHECK IF THE CHARGING CASE NEEDS TO BE RECHARGED.)

POWERING OFF:

WHEN PLACING THE EARBUDS BACK INSIDE THE CHARGING CASE, THE EARBUDS WILL AUTOMATICALLY TURN OFF AND BEGIN CHARGING.











BT PAIRING











- STEP 1: ENSURE THAT THE DEVICE YOU WISH TO PAIR WITH THE EARBUDS IS BT ENABLED.
- STEP 2: GO TO "SETTINGS" ON YOUR DEVICE AND ENSURE THE BT TOGGLE IS ON.
- STEP 3: WEAR THE EARBUDS AND SELECT "KAJA GO-TO'S" ON YOUR DEVICE SCREEN TO BEGIN PAIRING.
- STEP 4: PAIRING IS COMPLETE WHEN YOU HEAR THE VOICE PROMPT, "CONNECTED."

TOUCH CONTROL GUIDE

PHONE CALLS

ANSWER 	→	TAP ONCE (L/R)	→	
REJECT 	→	LONG-PRESS (L/R) 2 SEC	→	
HANG UP 	→	DOUBLE-TAP (L/R)	→	
ACTIVATE SIRI 	→	TRIPLE-TAP (L/R)	→	

MUSIC

PLAY/PAUSE 	→	TAP ONCE (L/R)	→	
PREVIOUS TRACK 	→	DOUBLE-TAP (L)	→	
NEXT TRACK 	→	DOUBLE-TAP (R)	→	
VOLUME UP 	→	LONG-PRESS (R)	→	
VOLUME DOWN 	→	LONG-PRESS (L)	→	

LED LIGHT INDICATOR GUIDE

EARBUDS

- **PAIRING =**
WHEN PAIRING IS SUCCESSFUL, THE LED LIGHTS ON THE EARBUDS WILL FLASH RED AND WHITE FOR 2 SECONDS.
- **INSIDE CHARGING CASE =**
WHEN THE EARBUDS ARE PLACED INSIDE THE CHARGING CASE, THE LED LIGHTS ON THE EARBUDS WILL FLASH RED AND WHITE ONCE, THEN TURN SOLID RED FOR 5 SECONDS TO INDICATE SUCCESSFUL CONTACT AND THAT CHARGING HAS BEGUN.

CHARGING CASE

- **BATTERY STATUS =**
WHEN THE EARBUDS ARE PLACED INSIDE THE CHARGING CASE, THE FOUR LED LIGHTS ON THE FRONT OF THE CHARGING CASE WILL TURN ON BRIEFLY TO SHOW THE CURRENT BATTERY LIFE STATUS OF THE CHARGING CASE.
- **CHARGING STATUS =**
WHEN THE CHARGING CASE BATTERY IS LOW OR EMPTY, CONNECT THE USB-C CHARGING CABLE TO THE CHARGING CASE, AND ENSURE THE USB END OF THE CABLE IS CONNECTED TO A POWER SOURCE. WHILE CHARGING, THE CHARGING CASE LED LIGHTS WILL TURN ON TO INDICATE THE CURRENT BATTERY STATUS.
WHEN THE LED LIGHTS STOP FLASHING, THIS INDICATES THAT THE CHARGING CASE IS FULLY CHARGED. NOTE THAT THE CHARGING CASE CAN ALSO BE CHARGED BY PLACING IT ON A COMPATIBLE WIRELESS CHARGER (NOT PROVIDED).

GENERAL SAFETY INSTRUCTIONS

1. THIS PRODUCT CONTAINS PARTS THAT MAY BE CHOKING HAZARDS. KEEP ALL PARTS IN A SAFE, DRY AREA OUT OF REACH OF CHILDREN AND PETS.
2. THIS PRODUCT IS NOT INTENDED FOR CHILDREN AGES 12 OR YOUNGER.
3. WHEN THE EARBUDS ARE POWERED ON AND READY FOR USE, ENSURE THAT THE VOLUME IS AT A MODERATE LEVEL BEFORE INITIATING ANY CALLS/MUSIC/ETC, TO PREVENT POTENTIAL HEARING DAMAGE THAT MAY OCCUR FROM A SUDDEN INFLUX OF HIGH VOLUME.
4. USING THE EARBUDS AT HIGH VOLUME LEVELS FOR EXTENDED PERIODS OF TIME MAY RESULT IN HEARING DAMAGE. IT IS ADVISED TO KEEP THE VOLUME AT MODERATE OR LOW LEVELS FOR LONG-TERM SAFETY.
5. DO NOT WEAR/USE THE EARBUDS WHEN OPERATING VEHICLES/MACHINERY OR PERFORMING ACTIVITIES THAT REQUIRE HEARING THE SURROUNDING ENVIRONMENT. (ENSURE THAT YOU CHECK AND ADHERE TO LOCAL LAWS REGARDING EARBUD USAGE WHILE DRIVING.)
6. WHEN CLEANING & MAINTAINING THE PRODUCT, DO NOT USE LIQUIDS, SOLVENTS, CLEANING AGENTS, OR ANY OTHER POTENTIALLY ABRASIVE SOLUTION. ONLY CLEAN THE CHARGING CASE WITH A SOFT, DRY CLOTH. ONLY CLEAN THE EARBUDS WITH A SLIGHTLY DAMP CLOTH. ONLY CLEAN THE SILICONE EAR-TIPS (AFTER TAKING THEM OFF THE EARBUDS) WITH DAMP COTTON SWABS, THEN LET AIR DRY INDOORS AT ROOM TEMPERATURE FOR AT LEAST 12 HOURS BEFORE RE-INSTALLING ON THE EARBUDS.
7. IF THERE IS ANY DAMAGE OR BREAKAGE DETECTED ON ANY PART OF THE PRODUCT, STOP USAGE IMMEDIATELY AND CONTACT CUSTOMER SUPPORT.
8. DO NOT PLACE ANY PART OF THE PRODUCT NEAR HEAT SOURCES, WATER, OR ANY OTHER ENVIRONMENTAL ELEMENT THAT MAY CAUSE POTENTIAL DAMAGE.
9. DO NOT USE THE PRODUCT OUTDOORS DURING ADVERSE WEATHER OR DURING PERIODS OF EXTREME TEMPERATURE OR HIGH HUMIDITY, AS THIS MAY CAUSE POTENTIAL DAMAGE.

GENERAL SAFETY INSTRUCTIONS

BATTERY SAFETY INSTRUCTIONS

1. WHEN CHARGING THE CHARGING CASE, ENSURE THAT THE CASE IS NOT DANGLING OR LOOSE. THE CASE SHOULD SIT ON A FLAT, FIRM SURFACE.
2. TO PROLONG BATTERY LIFESPAN, FULLY CHARGE THE CHARGING CASE AT LEAST ONCE EVERY 3 MONTHS. (IF THE CASE IS LEFT UNCHARGED FOR OVER 3 MONTHS, THE BATTERY MAY DEGRADE, CAUSING A SHORTENED BATTERY LIFESPAN.)
3. TO AVOID ELECTRIC SHOCK OR FIRE, DO NOT TOUCH ANY ELECTRICAL PART OF THE PRODUCT WITH WET HANDS OR UNINSULATED METAL. DOING SO MAY CAUSE SHORT CIRCUITING OR PERMANENT BREAKAGE.
4. TO AVOID ELECTRIC SHOCK, DO NOT SUBMERGE, SOAK, OR WASH ANY PART OF THE PRODUCT IN ANY TYPE OF LIQUID. DOING SO MAY CAUSE SHORT CIRCUITING OR PERMANENT BREAKAGE.
5. TO AVOID ELECTRIC SHOCK OR POISONING, DO NOT OPEN OR ATTEMPT TO REMOVE ANY BATTERIES IN THE PRODUCT. THEY ARE DESIGNED TO BE NON-REMOVEABLE.

ANY DAMAGE OR LOSS OF PERFORMANCE STEMMING FROM IMPROPER USAGE OR HANDLING, OR NOT FOLLOWING THE INSTRUCTIONS IN THIS USER MANUAL, WILL VOID THE WARRANTY.

TECHNICAL SPECIFICATIONS

Model name	Go-To's
SKU number	K-GTS1BK1
BT pairing name	Kaja Go-To's
Earbud touch control enabled?	Yes
Charging cable type	USB-C
Weight of single earbud	4.6 g
Weight of earbuds + charging case	43 g
Dimensions of single earbud	3.5 x 1.8 x 2.2 cm 1.4 x 0.7 x 0.8 in
Dimensions of charging case	6.1 x 4.6 x 2.0 cm 2.4 x 1.8 x 0.8 in
Noise cancellation type	Dual-mics ENC
Transmission range	10 m = 33 ft
Frequency range	20 Hz – 20 KHz
Driver size	6 mm dynamic driver
Impedance	16Ω ± 10%
Sensitivity value	103±3 dB
Microphone sensitivity	(-42)±3 dB
Earbud shutdown current	≤12 uA
Charging case voltage	5 V ± 0.25 V
Temperature range for safe usage	0° C – 45° C 32° F – 113° F
Water-resistant level	IPX4
Max standby time	40 hrs
Max talk time	5 hrs
Max play time per single earbud charge	6 + 20 hrs (at 50% volume)
Max hours per single case charge	70 hrs
Earbud battery type	Lithium-ion battery (40 mAh)
Earbud charging time (0% to 100%)	Up to 1.5 hrs
Charging case battery type	Lithium-ion battery (400 mAh)
Charging case charging time (0% to 100%)	Up to 1.5 hrs
Total lifetime of charging case battery	Up to 500 cycles

FCC STATEMENT

FCC ID: 2A8P9-K-GTS1BK1

THIS DEVICE COMPLIES WITH PART 15 OF THE FCC RULES. OPERATION IS SUBJECT TO THE FOLLOWING TWO CONDITIONS:

- (1) THIS DEVICE MAY NOT CAUSE HARMFUL INTERFERENCE, AND
- (2) THIS DEVICE MUST ACCEPT ANY INTERFERENCE RECEIVED, INCLUDING INTERFERENCE THAT MAY CAUSE UNDESIRE OPERATION.

NOTE: THIS EQUIPMENT HAS BEEN TESTED AND FOUND TO COMPLY WITH THE LIMITS FOR A CLASS B DIGITAL DEVICE, PURSUANT TO PART 15 OF THE FCC RULES. THESE LIMITS ARE DESIGNED TO PROVIDE REASONABLE PROTECTION AGAINST HARMFUL INTERFERENCE IN A RESIDENTIAL INSTALLATION.

THE DEVICE HAS BEEN EVALUATED TO MEET GENERAL RF EXPOSURE REQUIREMENT. THE DEVICE CAN BE USED IN PORTABLE EXPOSURE CONDITION WITHOUT RESTRICTION.

THIS EQUIPMENT GENERATES, USES AND CAN RADIATE RADIO FREQUENCY ENERGY AND, IF NOT INSTALLED AND USED IN ACCORDANCE WITH THE INSTRUCTIONS, MAY CAUSE HARMFUL INTERFERENCE TO RADIO COMMUNICATIONS. HOWEVER, THERE IS NO GUARANTEE THAT INTERFERENCE WILL NOT OCCUR IN A PARTICULAR INSTALLATION.

IF THIS EQUIPMENT DOES CAUSE HARMFUL INTERFERENCE TO RADIO OR TELEVISION RECEPTION, WHICH CAN BE DETERMINED BY TURNING THE EQUIPMENT OFF AND ON, THE USER IS ENCOURAGED TO TRY TO CORRECT THE INTERFERENCE BY ONE OR MORE OF THE FOLLOWING MEASURES:

- REORIENT OR RELOCATE THE RECEIVING ANTENNA.
- INCREASE THE SEPARATION BETWEEN THE EQUIPMENT AND RECEIVER.
- CONNECT THE EQUIPMENT INTO AN OUTLET ON A CIRCUIT DIFFERENT FROM THAT TO WHICH THE RECEIVER IS CONNECTED.
- CONSULT THE DEALER OR AN EXPERIENCED RADIO/TV TECHNICIAN FOR HELP.

WARNING: CHANGES OR MODIFICATIONS NOT EXPRESSLY APPROVED BY THE PARTY RESPONSIBLE FOR COMPLIANCE COULD VOID THE USER'S AUTHORITY TO OPERATE THE EQUIPMENT.

RECYCLING

 THIS SYMBOL ON THE PRODUCT OR ON ITS PACKAGING INDICATES THAT THIS PRODUCT CANNOT BE TREATED AS EVERYDAY HOUSEHOLD WASTE.

DO NOT DISPOSE OF THE PRODUCT INTO THE TRASH OR MUNICIPAL RECYCLING BINS. INSTEAD, IT SHOULD BE TAKEN TO THE APPROPRIATE COLLECTION POINT FOR RECYCLING ELECTRONIC DEVICES.

FOR MORE INFORMATION ABOUT YOUR LOCAL ELECTRONIC WASTE COLLECTION PROGRAM, CONTACT YOUR LOCAL CERTIFIED ELECTRONICS RECYCLERS, PARTICIPATING RETAILERS AND RECYCLERS IN ELECTRONICS TAKEBACK SERVICES, OR THE RETAILER FROM WHICH YOU PURCHASED YOUR PRODUCT.

 THE LITHIUM-ION BATTERIES INSIDE THIS PRODUCT HAVE BEEN TESTED AND CERTIFIED PER UN38.3 AND IEC62133 STANDARDS.

 THIS PRODUCT MEETS ALL THE REQUIREMENTS OF THE FEDERAL COMMUNICATIONS COMMISSION OF THE UNITED STATES.

1 YEAR LIMITED WARRANTY

TO ACTIVATE THE WARRANTY, PLEASE REGISTER YOUR PRODUCT AS SOON AS POSSIBLE ON THE KAJA AUDIO WEBSITE:

WWW.KAJAAUDIO.COM/REGISTRATION

UNLESS A DIFFERENT WARRANTY PERIOD IS EXPRESSLY PROVIDED WITH YOUR KAJA AUDIO PRODUCT, KAJA AUDIO WARRANTS THAT THIS PRODUCT FOR A PERIOD OF 1 YEAR — WHEN THE PRODUCT IS DELIVERED TO YOU IN NEW CONDITION, IN ORIGINAL PACKAGING, FROM A KAJA AUDIO AUTHORIZED RESELLER AND USED IN NORMAL CONDITIONS AND AS DESCRIBED IN THE USER MANUAL — IS FREE FROM ANY DEFECTS IN MANUFACTURING, MATERIALS, AND WORKMANSHIP.

THIS WARRANTY GIVES YOU SPECIFIC RIGHTS AND YOU MAY ALSO HAVE OTHER RIGHTS, WHICH VARY FROM STATE TO STATE. KAJA AUDIO PROVIDES A LIMITED WARRANTY ON ALL ELIGIBLE KAJA AUDIO PRODUCTS PURCHASED IN THE UNITED STATES AND CANADA.

THE LIMITED WARRANTY COVERS FAILURES DUE TO DEFECTS IN MATERIAL OR WORKMANSHIP ON THE PRODUCT.

EAR-TIPS AND OTHER REPLACEABLE ACCESSORIES ARE NOT COVERED UNDER THE LIMITED WARRANTY.

THE LIMITED WARRANTY STARTS FROM THE ORIGINAL DATE OF PURCHASE AND IS ONLY APPLICABLE TO THE ORIGINAL PURCHASER OF THE PRODUCT. PROOF OF PURCHASE IS REQUIRED TO RECEIVE ANY SERVICES GUARANTEED AS PART OF THE LIMITED WARRANTY.

THE LIMITED WARRANTY DOES NOT APPLY TO REFURBISHED PRODUCTS OR PRODUCTS THAT WERE RESOLD BY UNAUTHORIZED RESELLERS.

THE LIMITED WARRANTY DOES NOT COVER DEFECTS RESULTING FROM IMPROPER OR UNREASONABLE USE OR MAINTENANCE OF THE PRODUCT, FAILURE TO FOLLOW OPERATING INSTRUCTIONS, OR UNAUTHORIZED ALTERATIONS OR MODIFICATIONS TO THE ORIGINAL PRODUCT.

THE LIMITED WARRANTY DOES NOT PROVIDE REFUNDS, RETURNS, OR EXCHANGES UNDER MOST CONDITIONS. PRODUCT REPLACED UNDER THE LIMITED WARRANTY MAY BE REPLACED WITH A BRAND NEW OR FACTORY REFURBISHED PRODUCT. IF THE DEFECTIVE PRODUCT IS DISCONTINUED, END OF LIFE, OR OUT OF STOCK, KAJA AUDIO WILL ISSUE A REPLACEMENT PRODUCT OF EQUIVALENT VALUE OR FEATURES. PRODUCT WARRANTY PERIODS DO NOT RENEW WITH REPLACEMENT PRODUCTS.

IF YOUR KAJA AUDIO PRODUCT SHOULD REQUIRE SERVICE, CONTACT CUSTOMER SUPPORT TO:

- LOCATE A KAJA AUDIO AUTHORIZED SERVICE CENTER IN YOUR AREA.
- OBTAIN INFORMATION ABOUT REPAIRS OR REPLACEMENT PARTS.
- ASK ANY QUESTIONS REGARDING THE LIMITED WARRANTY.

LIVE CHAT: WWW.KAJAAUDIO.COM

TOLL FREE NUMBER: +1-877-858-5574

EMAIL: SUPPORT@KAJAAUDIO.COM

CUSTOMER SUPPORT HOURS: MONDAY — FRIDAY, 9 A.M. — 5 P.M. U.S. PST

VISIT WWW.KAJAAUDIO.COM FOR THE LATEST NEWS, PRODUCTS & ACCESSORIES, FAQ & TROUBLESHOOTING TIPS, DIGITAL USER MANUALS, CUSTOMER SUPPORT, AND MORE!