

BUTURE

User Manual

JR700

Stick Vacuum Cleaner



Content

1. INTRODUCTION	2
2. WARNING	2
2.1 Personal Safety	2
2.2 Electrical Safety	3
2.3 Battery Safety	3
3. CONTENT OF PACKAGE	4
4. KNOW YOUR PRODUCT	5
5. CHARGING	6
6. ASSEMBLING	7
7. USING	8
8. CLEANING	9
8.1 Clean the dust cup	9
8.2 Reinstallation	10
8.3 Clean the brush	11
9. TROUBLESHOOTING	12
9.1 Blockage Protection	12
10. COMMON TROUBLE	13
11. MAINTENANCE	16
12. WARRANTY	16

1. INTRODUCTION

Thank you for purchasing BUTURE JR700 stick vacuum cleaner. Please read the user manual carefully before using the product to avoid malfunctions caused by accidental operation. If the product is given to another person, please make sure the manual is conveyed. The product provides a free 2-year warranty, please activate the warranty card in time. If you have any questions, please contact sales@ibuture.com

2. WARNING

2.1 Personal Safety

- ① Store it indoors in a dry place and out of the reach of children.
- ② This product is suitable for children 10 years old and above. Users with reduced physical functions, sensory or intellectual abilities, or lack of experience and knowledge are advised to use the product safely supervision or guidance and to be aware of the hazards involved.
- ③ Please pay attention to safety when children or pets near the vacuum cleaner.
- ④ Children should not clean or use the product without supervision.
- ⑤ Use only manufacturer's recommended attachments as described in this manual; misuse or use of any accessory or attachment other than those recommended may present a risk of personal injury.
- ⑥ Take extra care when cleaning stairs.
- ⑦ Keep the appliance and accessories away from the hot surface.
- ⑧ Do not block the appliances' openings or hinder airflow, keep openings free of any objects including dust, lint, clothing, fingers (and all parts of the body).

2.2 Electrical Safety

- ① Only use batteries and chargers supplied by the manufacturer.
- ② Never modify the charger in any way.
- ③ Do not pull the cord to disconnect it from a socket, grasp the plug and pull to disconnect it.
- ④ Keep the charger cord away from hot surfaces and sharp edges.
- ⑤ The supply cord cannot be replaced. If the cord is damaged the charger should be discarded and replaced.
- ⑥ Do not handle the charger or the appliance with wet hands.
- ⑦ Do not store, or charge the appliance outdoors.
- ⑧ The charger must be removed from the socket before removing the battery, cleaning, or maintaining the appliance.

2.3 Battery Safety

- ① This appliance includes Li-ion batteries, do not incinerate batteries or expose them to high temperatures, as they may explode.
- ② Liquid ejected from the battery may cause irritation or burns.
- ③ In an emergency contact professional help immediately.
- ④ Leaks from the battery cells can occur under extreme conditions. Do not touch any liquid that leaks from the battery. If the liquid gets on the skin, wash immediately with soap and water. If the liquid gets into the eyes, flush them immediately with clean water for a minimum of 10 minutes and seek medical attention. Wear gloves to handle the battery and dispose of it immediately in accordance with local regulations.
- ⑤ When the battery pack is not in use, keep it away from paper clips, coins, keys, nails, screws, or other small metal objects that could make a connection from one terminal to another.
- ⑥ When you dispose of the appliance remove the battery and dispose of the battery safely in accordance with local regulations.

3. CONTENT OF PACKAGE

Part Name	Quantity	Part Name	Quantity
Main Body	1	Wall Mount Stand	1
Battery Pack	1	Charger	1
Telescopic Tube	1	Small Cleaning Brush	1
Floor Brush	1	Air Filter(Installed)	1
Hard And Soft Bristle Integrated Brush (Installed)	1	Hepa Dust Filter(one is installed in the main body)	3
Crevice Nozzle	1	Screws set (Used to install wall mount stand)	1
Round Brush	1	Quick User Guide	1

4. KNOW YOUR PRODUCT

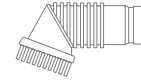
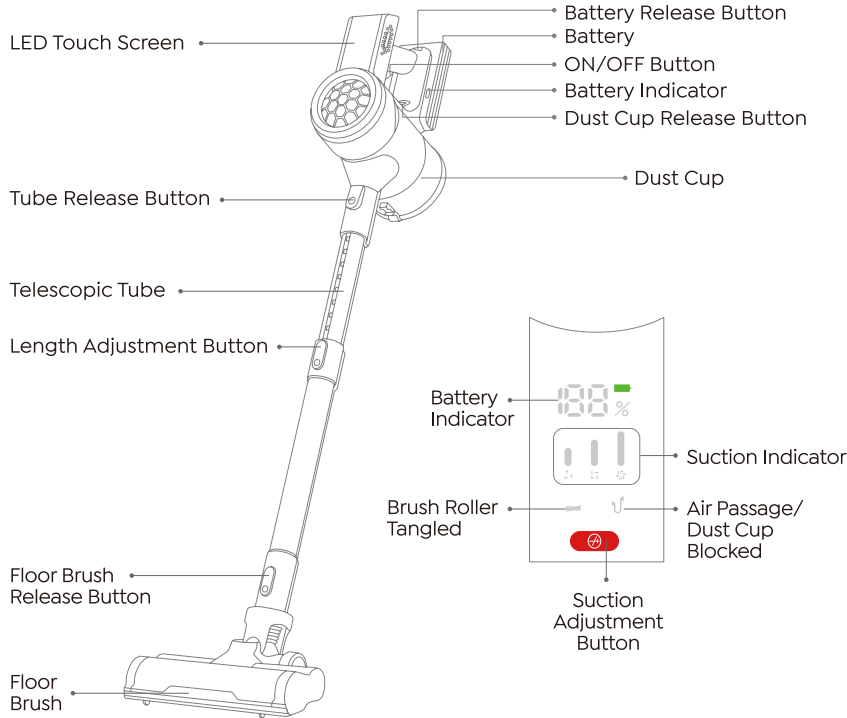

Round Brush



Wall Mount Stand



Charger



Crevice Nozzle



Hard And Soft Bristle Integrated Brush (Installed)



Small Cleaning Brush

5. CHARGING

Turn off the power before charging

- Only charge with the original charger to avoid damage to the vacuum cleaner.
 - During over-current protection and over-voltage protection, the battery indicators.
 - Flash at the same time, and the screen goes out.
- ① One end of the charger is connected to the power supply and the other end is connected to the battery charging port.

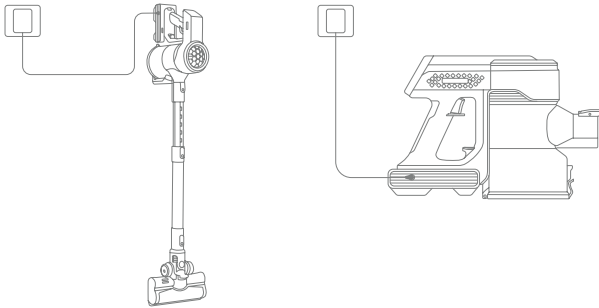

- ② During the charge if the battery indicator shows 100, means it is fully charged and ready to use.

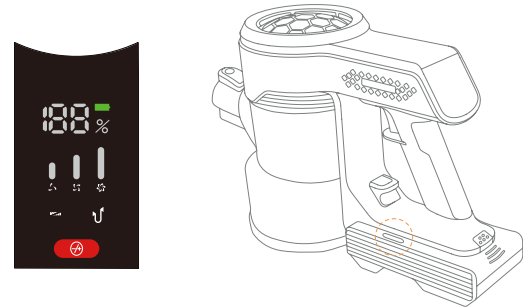

6. ASSEMBLING

- Connect the telescopic tube

Insert the telescopic tube into the main body and make sure it is secure. Press the release button, the telescopic tube can be removed.

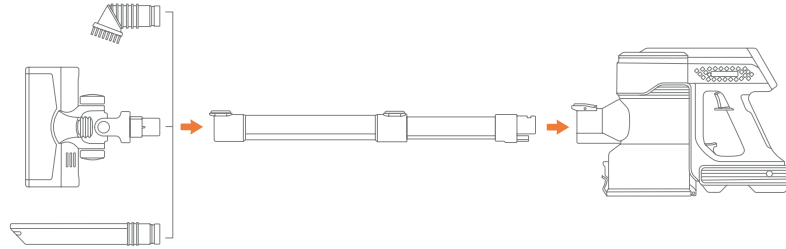

- Connect brush heads

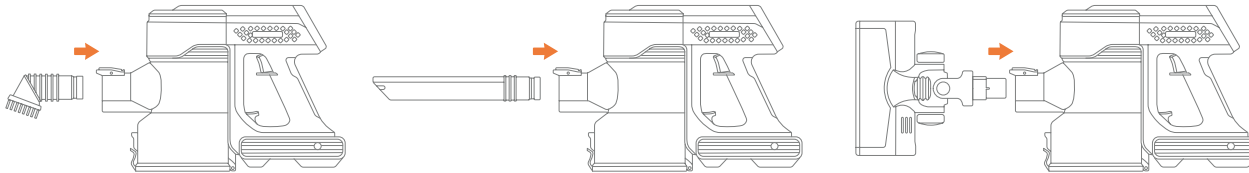

7. USING

⚠ Do not exceed the "MAX" dust collection capacity of the dust cup.

Please keep the suction nozzle unobstructed and avoid blockage. Otherwise, the motor will overheat and cause danger.

- Press the ON/OFF button to start work

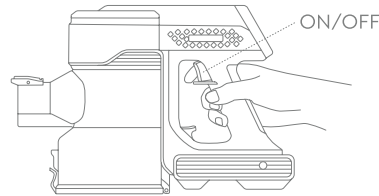

- Adjust suction power



Touch the button to adjust the suction power.

When turning on the vacuum, the green light is on, the vacuum is in ECO mode. Press the button once, the blue light is on, the vacuum is in standard mode. Press the button twice, the red light is on, the vacuum is at the max suction mode.

- According to different needs, the length of the tube can be adjusted

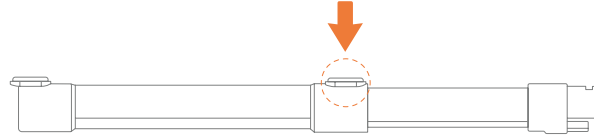

8. CLEANING

8.1 Clean the dust cup

To maintain good suction power, please empty the dust cup and clean the filter after each use.

- ① Press the release button on the dust cup to open the dust cup lid, dump out the trash.

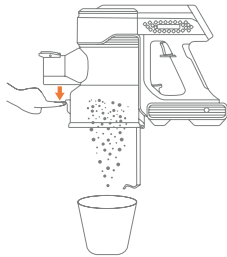

- ② Press vertically the dust cup release button of the main body, grasp the bottom of the dust cup, and take out the dust cup.



- ③ Pull out the HEPA filter. Then open the bottom cover of the dust cup, rotate the stainless steel filter and take it out.



- ④ Sweep off the dust on the HEPA filter with the cleaning brush. The stainless steel filter and dust cup can be washed by water, and shall be installed after being dried for 24 hours.
- ⚠ Do not use cleaning equipment (washing machine, etc.) to clean the filter, do not use drying equipment (dryer, iron, etc.) to dry the vacuum cleaner, natural drying only.

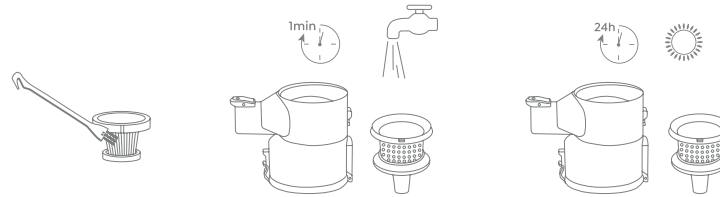

8.2 Reinstallation

Put the stainless steel filter from the bottom of the dust cup and rotate it tightly (There are 3 small protrusions on the stainless steel filter's edge corresponding to the 3 small grooves on the dust cup).

- ① Put the HEPA filter from above, and cover the dust container Bottom cover Bottom.
- ② Align the convex part of the handle with the concave part of the dust cup and insert it, and then press the release button of the dust cup to completely close the dust cup and the handle.

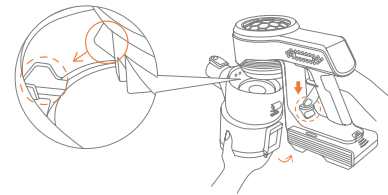
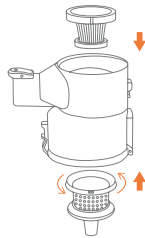

8.3 Clean the brush

⚠ Ensure the appliance is disconnected from the charger before removing the roller brush. Be careful not to pull the ON button.

- 1 Push up the switch to the “unlock” side, remove the plug, then take out the roller brush.

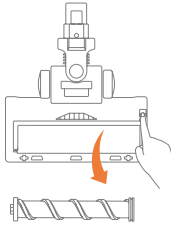

- 2 Use the small cleaning brush to sweep away the trash on the roller. The knife side used to remove the tangled hairs from brush roller.

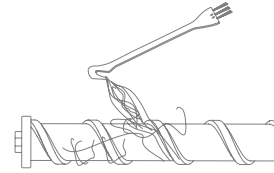

- 3 Clean the roller brush with/without water.

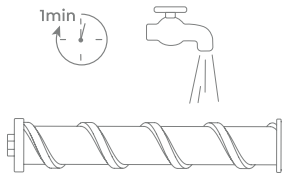

- 4 Push in gently to install the roller brush. Before replacing, make sure the brush is completely dry.

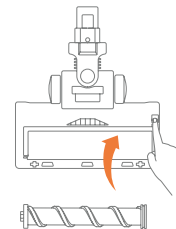

9. TROUBLESHOOTING

If there is any problem during use, please check the following troubleshooting table.
 If the problem can't be solved, please contact the after-sales email: sales@ibuture.com

⚠ Warning:

Turn off the vacuum cleaner before maintenance. Otherwise it may cause electric shock or other personal injury.

9.1 Blockage Protection

① Brush Roller Tangled

If the floor brush inhales large foreign objects or entangles too much hair, the indicator on the left flashes.

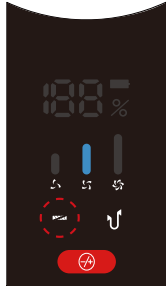

Solution: Remove the floor brush and clean up the foreign matter wrapped around the roller. Please ensure that the brush head has been detached from the main unit to prevent accidental starting of the machine and cause personal injury.

② When the air passage or dust cup is blocked, the indicator on the right will flash.

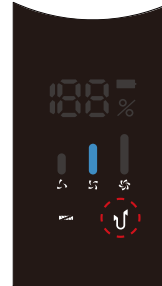

Solution: Clean the aluminum tube and the filters in the dust cup thoroughly.

10. COMMON TROUBLE

Problems	Possible Causes	Solutions
Vacuum can not work	<ol style="list-style-type: none"> 1. Low battery power. 2. The floor brush, telescopic tube, dust cup, filter are blocked by hair or other debris. 3. Does not charge with original charger. 4. The battery is not installed properly. 5. Battery damaged. 	<ol style="list-style-type: none"> 1. Charge before use. 2. Clean thoroughly blockage in brush suction inlet, extension tube, dust cup, HEPA filter and metal filter. 3. Make sure charging with the original charger. 4. Make sure the battery is in place. 5. Contact after-sales email: sales@ibuture.com.
Suction power becomes weak	<ol style="list-style-type: none"> 1. The dust cup is full. 2. Metal filter blocked by dust. 3. HEPA filter blocked by dust. 4. Low battery power. 5. Attachments such as extension tube and clean head are not installed in place to the vacuum cleaner. 6. Air outlets or inlets are blocked by rubbish. 	<ol style="list-style-type: none"> 1. Clean the dust cup. 2. Clean the metal filter. 3. Clean up/Replace the HEPA filter(Replacement HEPA filters can be purchased by contacting the after-sales email) . 4. Charge the battery . 5. Follow the instructions to reinstall. 6. Clean the floor brush and extension tube.
Insufficient running time after charging	<ol style="list-style-type: none"> 1. Insufficient charging time. 2. Battery aging. 3. The dust cup is full of dust. 4. The filters are full of dust. 5. The telescopic tube or brush inlet blocked. 6. Always use the highest speed for cleaning the whole house. 	<ol style="list-style-type: none"> 1. Recharge the battery. 2. Replace a battery. 3. Empty the dust cup. 4. Clean or change the HEAP filter. 5. Remove blockage in tube and brush inlet. 6. For simple cleaning, it is recommended to use the lowest speed or the medium speed. Only larger garbage needs the highest speed, which can effectively prolong the battery life. <p>If the house is larger, contact sales@ibuture. come to get additional spare batteries.</p>

Problems	Possible Causes	Solutions
LED indicator is not light	<ol style="list-style-type: none"> 1. The charging cable is not fully inserted into the charging socket. 2. Foreign matter on the metal contact of the charger or on the battery charging port prevent charging. 3. The charging socket is damaged. 4. Motor of vacuum cleaner damaged. 5. Battery damaged. 6. Charger damaged. 	<ol style="list-style-type: none"> 1. Make sure the charger, battery, and power socket are in good contact. 2. Make sure that the charging contact is in good condition without foreign matter or dust build-up. 3. Change another charging socket. 4. Contact sales@ibuture.com for a replacement motor. 5. Contact sales@ibuture.com for a replacement battery. 6. Contact sales@ibuture.com for a replacement charger.
Electric floor brush roller does not rotate	<ol style="list-style-type: none"> 1. The roller brush is wrapped or entangled by hair. 2. The roller brush is not installed in place. 3. The extension tube or electric floor brush is not installed in place. 4. Extension tube damaged. 5. Floor brush damaged. 	<ol style="list-style-type: none"> 1. Follow the instructions to clean the floor brush and restart the vacuum cleaner. 2. Follow the instructions to reinstall the roller brush. 3. Follow the instructions to reinstall the extension tube and floor brush. 4. Extension tube damaged, please contact the after-sales. 5. The floor brush is damaged, please contact the after-sales.
Vacuum cleaner leaks dust	<ol style="list-style-type: none"> 1. The HEPA filter is not installed or not in place. 2. The HEPA filter is full of dust. 3. The metal filter is full of dust. 4. HEPA filter damage needs to be replaced. 5. Turn off the vacuum cleaner before the rubbish come into the dust cup. 	<ol style="list-style-type: none"> 1. Check that the HEPA filter is installed in place. 2. Clean the HEPA filter. 3. Clean the metal filter. 4. Contact customer service to purchase a replacement HEPA filter. 5. Make sure all the rubbish is in the dust cup before turning off the vacuum cleaner.
The vacuum cleaner stops automatically	<ol style="list-style-type: none"> 1. Out of battery. 2. Clogged suction ports cause the vacuum cleaner to be overheated. 3. Clogged HEPA filter causes the vacuum cleaner to be overheated. 4. HEPA filter needs to be replaced. 	<ol style="list-style-type: none"> 1. Charge the battery. 2. Clean all the air inlets. Let the vacuum cleaner cool to room temperature before turning it on. 3. Clean up the HEPA filter, dust cup, floor brush and metal filter. 4. Replace the HEPA filter.

Problems	Possible Causes	Solutions
Display turns black and shows E1 in the middle	Over temperature protection	Prompt that the current battery temperature is high. Stop using/charge the vacuum cleaner until the battery temperature is normal (wait about 45 minutes).
Display turns black and shows E2 in the middle	Abnormal charger voltage	When the adapter voltage is too high or too low, the display will flash "E2" quickly, and a red light will flash quickly on the battery. The machine will automatically shut down after flashing for 10 seconds. In this case, please contact sales@ibuture.com
Display turns black and shows E3 in the middle	Battery failure	When the battery fails, the display will flash "E3" quickly, and a red light will flash quickly on the battery. The machine will automatically shut down after flashing for 10 seconds. In this case, please contact sales@ibuture.com
Display turns black and shows E4 in the middle	Negative Temperature Coefficient connection abnormal	When the Negative Temperature Coefficient is abnormal, the display will flash "E4" quickly, and the red light on the battery will flash quickly. The machine will automatically shut down after flashing for 10 seconds. In this case, please contact sales@ibuture.com
Display turns black and shows E5 in the middle	Host overcurrent protection	In order to protect the quality of the host, there is a reminder of over-current protection. When the host is used over current, the display will flash "E5" quickly, and a red light on the battery will flash quickly. At this time, temporarily stop using the vacuum cleaner and wait for a while before using it again.

11. MAINTENANCE

- ① The stainless steel filter and dust cup can be washed by water. After cleaning they must be thoroughly dried before putting it back into use. Do not immerse the HEPA filter and main unit in water or any liquid.
- ② Clean the Hoover casing only with a soft, slightly damp cloth. Do not allow any liquid substances to enter the Hoover.
- ③ Do not use any corrosive chemicals or abrasives.
- ④ It is recommended to change the HEPA filter every 2 months (depending on use) to ensure optimum performance. Do not use the filter when it is damaged or worn out.

12. WARRANTY

If there is any problem or malfunction during use, please send your question and order number to our email. We will provide you a good after-sales service within 24 hours.

E-mail: sales@ibuture.com

If you're looking forward to a longer battery life, please contact sales@ibuture.com for an additional battery.

Federal Communication Commission Interference Statement

NOTE: This equipment has been tested and found to comply with the limits for a Class B digital device, pursuant to part 15 of the FCC Rules. These limits are designed to provide reasonable protection against harmful interference in a residential installation. This equipment generates, uses and can radiate radio frequency energy and, if not installed and used in accordance with the instructions, may cause harmful interference to radio communications. However, there is no guarantee that interference will not occur in a particular installation. If this equipment does cause harmful interference to radio or television reception, which can be determined by turning the equipment off and on, the user is encouraged to try to correct the interference by one or more of the following measures:

- Reorient or relocate the receiving antenna.
- Increase the separation between the equipment and receiver.
- Connect the equipment into an outlet on a circuit different from that to which the receiver is connected.
- Consult the dealer or an experienced radio/TV technician for help.

Caution: Changes or modifications not expressly approved by the party responsible for compliance could void the user's authority to operate this equipment.

This device complies with part 15 of the FCC Rules. Operation is subject to the following two conditions:

- (1) This device may not cause harmful interference, and
- (2) This device must accept any interference received, including interference that may cause undesired operation.

Correct Disposal of this product



This marking indicates that this product should not be disposed with other household wastes throughout the EU. To prevent possible harm to the environment or human health from uncontrolled waste disposal, recycle it responsibly to promote the sustainable reuse of material resources. To return your used device, please use the return and collection systems or contact the retailer where the product was purchased. They can take this product for environmental safe recycling.

Declaration of Conformity

We (Manufacturer is responsible for this declaration)

Ekoo Electronic Co.,Ltd.

(Company name)

B09,block B,f2,bldg.b,runfeng Pioneer Park,no.973, minzhi Avenue, Minzhi St., Longhua, Shenzhen, CN.(Company address)

Declare under our sole responsibility that the product

Trade name: BUTURE

Equipment: Vacuum Cleaner

Model No. : JR700

To which this declaration relates is in conformity with the essential requirement set out in the Council Directive on the Approximation of the laws of the Member States relating to LVD Directive(2014/35/EU) & EMC Directive(2014/30/EU) & RoHS(2011/65/EU) product is responsible to affix CE marking, the following standards were applied:

EN 60335-2-2:2010+A11:2012+A1:2013

EN 60335-1:2012+A11:2014+A13:2017+A1:2019+A14:2019+A2:2019

EN 62233:2008

EN 55014-1:2021

EN 55014-2:2021

EN IEC 61000-3-2:2019+A1:2021

IEC62321-3-1:2013

IEC62321-4:2013

IEC62321-5:2013

IEC62321-6:2015

IEC62321-7-1:2015

IEC62321-7-2:2017

IEC62321-8:2017

Full Name: George.wang

Signature: George.wang

Position: Approbation Manager

Place/Date: Shenzhen,China/Jun.27-2022

