



# EVERPURE<sup>®</sup> BW-4400

Filter cartridge for premium quality water.

Reduces chlorine & odor.

Micro-filters dirt and cloudiness by mechanical means.

Reduces cysts such as *Cryptosporidium* and *Giardia* by mechanical means.

Reduces wear and abrasion on water-using equipment.

Reduces limescale formation.

# EVERPURE<sup>®</sup>

**CARTRIDGE REORDER NUMBER  
EV9668-24**

Date Installed

Next Cartridge  
Change Due

Replace cartridge when flow rate becomes inconveniently slow or before rated capacity is reached. It is recommended to replace cartridge at least once a year.

Contact your local Pentair<sup>®</sup> Everpure Distributor to reorder replacement cartridges or call Customer Service (USA):

**1.800.942.1153**

Visit our website:

**www.everpure.com**

**Everpure**

1040 Muirfield Drive  
Hanover Park, IL 60133 USA

#### OPERATING PARAMETERS:

Capacity: 12,000 gallons (45,400 L)

Working Pressure: 10 – 125 psi  
(0.7 – 8.62 bar)

Temperature: 35-100°F (2-38°C)

Flow Rate: 0.5 gpm (1.9 Lpm)

Product performance may vary according to flow rate, influent line pressure and local water conditions.

Check for compliance with state and local laws and regulations. Do not use with water that is microbiologically unsafe or of unknown quality without adequate disinfection before or after the system. The contaminants or other substances removed or reduced by this drinking water system are not necessarily in your water.

Configuration of the cartridge cap and head of this product, the silver canister color and Everpure<sup>®</sup> are registered trademarks of Pentair Filtration Solutions, LLC.

Mfg. in USA of US & imported parts.

EPA Est. No. 002623-IL-002

©2018 Pentair Filtration Solutions, LLC

**NOT FOR RESIDENTIAL USE.**

**FOR FOOD SERVICE APPLICATIONS ONLY.**

To be installed by an authorized plumber or an authorized representative of the manufacturer.

↑  
Install upward



#### Replacement Cartridge Change Instructions

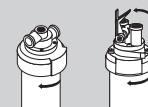

1. Shut off water and relieve line pressure. For heads with built-in shut-off valve, fully lift handle until it stops.
2. Hold head firmly. Push upward on cartridge and turn it to left 1/4 turn, until rotation stops.

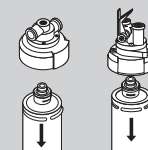

3. Pull cartridge down and out of head.

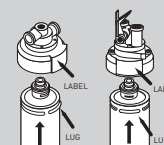

4. Align new cartridge lug with head label. Hold head firmly. Insert new cartridge into head.

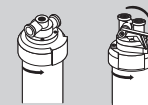

5. Turn cartridge to right 1/4 turn until rotation stops.

On multiple head systems repeat steps 2-5 for each cartridge.

6. Turn on water supply. For heads with built-in valve, lower handle.
7. **NOW FLUSH CARTRIDGE!** Run water through filter for 5 minutes.

**NOTE:** For Head with Revolving Ring, make sure the valve handle locks firmly into the ring notch.