

NEXPOW

User Manual

Simple And Safe Multi-Function Car Jump Starter

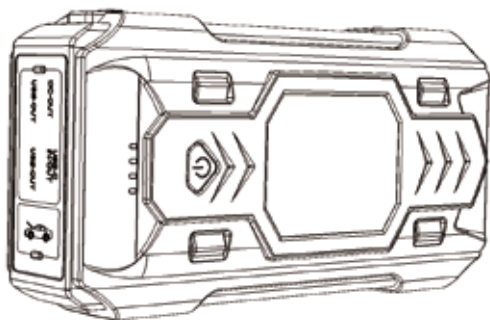

Model: Q9B

Package Contents

- 1 x NEXPOW Car Jump Starter Battery
- 1 x Jump Clamp
- 1 x User Manual
- 1 x Storage Case
- 1 x 1-In-1 Charging Cable
- 1 x Cigarette Lighter Adapter

Product Diagram

- ① Jump Clamp Port
- ② Power Switch
- ③ Type-C Input: 5V-3A/9V-2A/12V-1.5A
- ④ USB Output 1: 5V-3A/9V-2A/12V-1.5A
- ⑤ USB Output 2: 5V-2.1A
- ⑥ Power Button/Flashlight Button
- ⑦ DC Output: 12V/10A

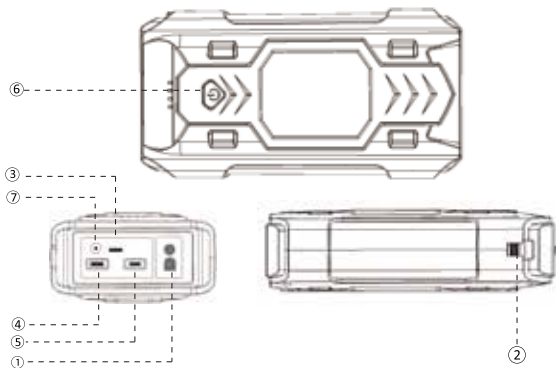

Technical Specifications

Battery Capacity	81.4Wh
Type-C Input	5V-3A/9V-2A/12V-1.5A
USB 1	5V-3A/9V-2A/12V-1.5A
USB 2	5V-2.1A
Peak Current	2500A
DC Output	12V/10A
Recharging Time	Approx.6 Hours
Operating Temperature	-10℃ ~ 60℃
Storage Temperature	-20℃ ~ 60℃
Storage Humidity	20%RH-80%RH (It can't be +40℃ when humidity is 80% RH)

Before Use

Please set the Power Switch“  ” to ON

Need to turn on the power switch“  ”

before using USB Output, DC Output, flashlight.

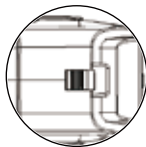

•Charge the Battery

Charging with an AC adapter. **(AC adapter, not included)**

- 1.Connect the battery input with a USB cable.
- 2.Connect the USB cable to the AC adapter .
- 3.Plug the AC adapter into a power source.

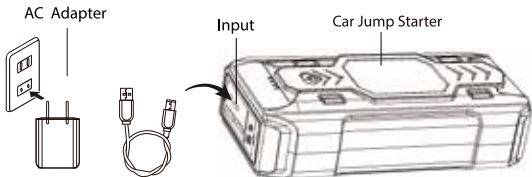

Note: The indicator lights will blink when it's charging.

And the four indicator lights will be all on when it's fully charged.

Charging Mobile Device (Charging Smartphones, Tablets Ets.)

- We recommend you use your original cables to charge your mobile devices.
- If there is an error when charging your mobile device, stop using the battery pack immediately.
- NEXPOW is not responsible for any product failure or damage caused by improper use. Use USB charging ports to charge mobile devices, such as smartphone and tablets.

1.Connect the battery pack with your mobile device by using the included USB cables.

2.Turn the battery packs power on to start charging.

(Please Set The Power Switch To ON First.)

How to Charge a Mobile Phone or Digital Products?

First Step:

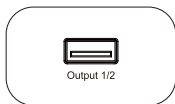

Plug the USB port of the charging cable into the product USB interface.

Second Step:

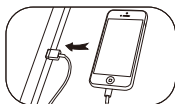

Insert the other side into the input port of the mobile phone.

Third Step:

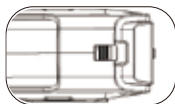

When connected OK please set the Power Switch to ON.

Fourth Step:



Press the power button to use it as your charger.

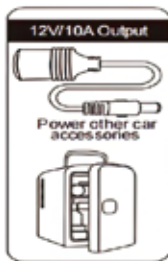
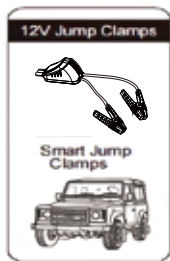

LED Flashlight

1. Set the power switch to ON, then long-press the flashlight button to turn on the flashlight.
2. When LED flashlight is on, press the button again to cycle through general lighting - blinking-SOS - strobe(blue-red alternate) and OFF mode.

- The flashlight provides more than 35 hours of continuous use when fully charged.

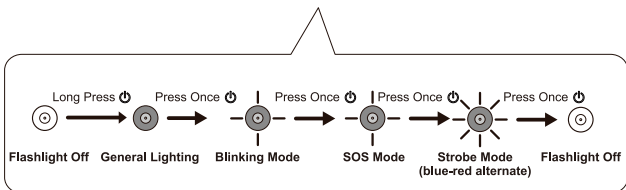
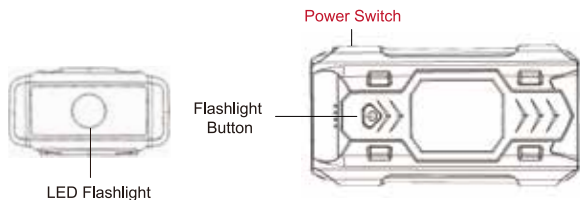

Smart Jumper Cable Instruction

1) Connect the plug fully seated into the host.



The **blue** light is on.

It means the jumper cable connected to the jump starter is correct and ready to connect to the car battery.

2) Connect the clamps to the vehicle battery. Red clamp to positive polarity (+), black clamp to negative polarity (-).



The **green** light and the **blue** light will be on.

It means all connection is correct, and you can start the engine.

3) Press the car start button or turn the ignition switch to the START position.

4) This jumper cable is designed with advanced protection of indicator light and buzzer.



The **blue** light is on.

After the car has started, remove the jumper cable.



The red light is on, the blue light is on, and the beeps for a long time.

Jump starter power is low, please recharge.

Reverse polarity connection, please reconnect correctly.

The red and black clamps are short-circuited, please reconnect correctly.

Jumper cable over temperature ($\geq 65 \pm 5 \text{ }^\circ\text{C}$), waiting to cool down ($\leq 55 \pm 5 \text{ }^\circ\text{C}$) before the next start.

How to Jump Start 12V Vehicle?

Notice:

- Gasoline-powered engine capacity up to 8L and diesel-powered engine capacity up to 8L.

Check the battery level on the LED indicator.

- 1 light stands for 25% power.

When the battery level is low, please charge the battery before using.

- Turn on the function button and make sure it is over 50% charged.

If the power is less than 50%, it may not be able to start your engine.

How to Jump Start 12V Vehicle?

Step 1

Connect the jumper cable to the jump starter. If the indicator light of jumper cable is solid blue, the clamp cable is in standby status. Now the jump starter is ready for jump-starting.

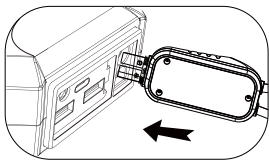

Step 2

Connect the clamp to the car battery. Connect the red clamp cable to positive and the black clamp cable to negative.

Please avoid reverse connection.

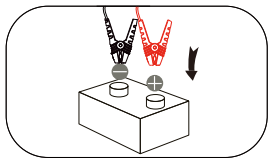

Step 3

When the indicator light of jumper cable is solid green and blue, you can try to start your vehicle.

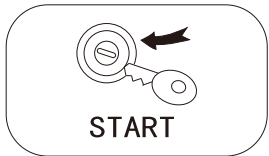

Step 4

After jump-starting the engine, remove the battery clamp from the car battery, then remove the clamp plug from the jump starter.

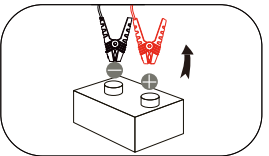

FAQ:

Q: How to turn off the device?

A: This device is equipped with an intelligent detection system and will shut down automatically in 30 seconds once there is no load or it is fully charged.

Q: How long will it take before the device is fully charged?

A: It will take about 4-5 hours with the 5V/3A wall charger.

Q: How many times can Q9B charge the cell phone?

A: It depends on the capacity of your cell phone. Taking iPhone 6 as an example, Q9B can charge it about 5 times.

Q: How many times can this device jump-start a vehicle when it is fully charged.

A: It can jump-start the vehicle about 20 times.

Q: What is the lifespan of Q9B?

A: About 3-5 years in general condition.

Q: How long can Q9B hold a charge?

A: With scientific circuit design can Q9B hold charge up to 12 months. But in order to extend the service life of the lithium battery we suggest charging it every three months.

Q: The wire clamp indicator shows red and there is a beeping alarm?

A: Red light constant with buzzing—Output has been cut due to (a) short circuit, (b) Overcurrent, (c) Overtemperature, (d) Overvoltage, (e) Reverse Connection.

Disconnect Smart Boost cable from unit and battery to reset.

If this still does not work, there maybe a damaged cable clip, in which case you should contact our after-sales team to send a replacement cable clip.

Trouble Shooting

Problem

1. Nothing happens when pressing the power button.
2. No response to charging.
3. No USB cable/damaged cable clip.

Reason

1. The voltage of Q9B is really low and triggers the low power protection to shut down the device.
2. Type-c data cable damage.
3. Missing packaging/damaged in transit.

Solution

1. Plug the wall charger into the Q9B to recharge it.
2. Replace the type-c cable and keep it charged for 4-5 hours before observing.
3. Contact our technical team for replacement.

Warning

- Please follow the local traffic safety rules and regulations when using this product on the road.
- Do not dismantle this battery pack as it may cause an electric shock or fire hazard.
- Keep away from children.
- Do not touch the product with wet hands.
- Do not scrape the product with sharp objects or contaminate the ports with the dust. Regularly clean the ports.
- Stop using right away if a bad odor or abnormal noise is detected.
- Do not leave the product or your vehicle unattended when the product is being used.
- Make sure your engine is turned off and your car is on parking brake before connecting the product.
- Please unfold the coiled/tied up cable first before using.
- Keep the black and red cable separated to prevent short circuits.
- For your safety, please wear gloves when using the product to avoid electric shocks.
- Do not use the product to jump start your vehicle when its battery is damaged or over discharged.
- Do not leave the jump cable connected to the car battery when storing.
- In case a leakage occurs or a bad odor is detected please stay away from the product. Please thoroughly rinse your eyes if the liquid enters your eyes.

Caution

- Do not drop, knock or smash the product and its accessories.
- Unplug the cables after you are done using the product.
- Keep away from fire and high temperatures. Stop using if the battery pack becomes hot or changes color.
- When jump starting your vehicles, please make sure the jump cable is firmly attached.
- Please do not use this product to repeatedly jump start your car, wait at least 30 seconds before another attempt.
- Stop using the product if you fail to jump start your car for 3 times in row.
- Do not use the product in place of car battery.
- Make sure the polarities are correct before use. A reverse connection may damage your car or cause the device to explode.
- Please connect the red cable first when connecting and remove the black cable first when disconnecting.
- Do not expose the product to water or other liquids. Do not use in humid areas.
- Please recharge the battery pack at least once every 3 months.
- Dispose of the product according to local laws and regulations.



Overcharging and
Over-discharging Protection



Fuse Protection

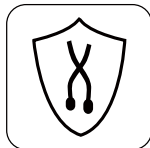

Reverse Polarity Protection



Made in China