



URINE DRUG SCREEN

Multi-Drug Urine Test Cup

MRK220005

Fully integrated, self-contained drug screen

All-in-one urine based multi-drug test solutions that can be utilized in practically any drug screening scenario. Our drug test cups can offer various customizable panels with an optional 6 specimen validity tests for urine adulteration.

ROUND CUP

16 Strips



FLAT CUP

14 Strips



TAPERED CUP

18 Strips



FEATURES

- Minimum fill volume: 30 mL
- 24-Month shelf life from date of manufacture
- On-site screening
- Internal, procedural control included
- Qualitative results in 5 minutes
- Self-contained urine drug test

BENEFITS

- 510(K) Cleared, CLIA Waived and OTC drug tests available (See Test Menu)
- Qualitative preliminary detection of numerous substances and drug metabolites in urine
- Specimen validity tests provide a semi-quantitative screen for Oxidants, Specific Gravity, pH, Nitrates, Glutaraldehyde, and Creatine in human urine, which can aid in the determination of urine specimen adulteration
- 25 Tests/Kit, 20 Kits/Case
- Custom configurations available
- OEM and Private-Label available



TEST MENU

Multi-Drug Urine Test Cup

MRK220005

510(K) Cleared, CLIA Waived, OTC	
Test	Cut-off (ng/mL)
Amphetamine (AMP)	500
	1000
Barbiturates (BAR)	300
Buprenorphine (BUP)	10
Benzodiazepines (BZO)	300
Cocaine (COC)	150
	300
Ecstasy (MDMA)	500
Marijuana (THC)	50
Methadone Metabolite (EDDP)	300
Methadone (MTD)	300
Methamphetamine (MET)	500
	1000
Morphine (MOP)	300
Opiates (OPI)	2000
Oxycodone (OXY)	100
Phencyclidine (PCP)	25
Propoxyphene (PPX)	300
Tricyclic Antidepressants (TCA)	1000

For Forensic Use Only*	
Test	Cut-off (ng/mL)
Alcohol (ALC)	0.04%
Clonazepam (CLO)	100
Cotinine (COT)	200
Ethyl Glucuronide (EtG)	300
	500
Fentanyl (FEN)	10
	20
Gabapentin (GAB)	1000
Hydrocodone (HCD)	300
Hydromorphone (HMO)	300
Ketamine (KET)	1000
Kratom (KRA)	250
LSD	20

For Forensic Use Only*	
Test	Cut-off (ng/mL)
Methaqualone (MQL)	300
Methcathinone (MTC)	300
Bath Salts (MDPV)	1000
6-Monoacetylmorphine (6-MAM)	10
AB-Pinaca (K3)	10
Pregabalin (PGB)	1000
Synthetic Marijuana (K2)	25
	50
Tramadol (TRA)	100
	200
UR-144	50
Zolpidem (ZOL)	300
Zopiclone (ZOP)	50

TEST PROCEDURE

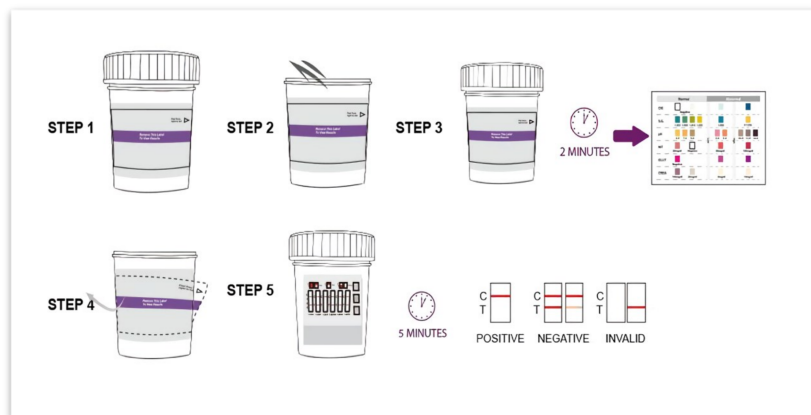

*Forensic Use Only (FUO) devices are intended for use in drugs of abuse testing for law enforcement purposes within the United States. FUO devices are not designed, tested, developed, or labeled for use in other settings, such as clinical diagnostics.