

ALPENA® MOTORLED FLOW™

PART #: 78359E

WARNING: THE FAILURE TO FOLLOW THESE INSTRUCTIONS WHEN INSTALLING THE MOTORLED FLOW MAY CAUSE ELECTRIC PROBLEMS IN YOUR VEHICLE WHICH COULD CAUSE VEHICLE DAMAGE, ELECTRICAL SYSTEM DAMAGE, FIRE, ELECTRICAL SHOCK, PERSONAL INJURY OR DEATH.

WARNING: DO NOT LOOK DIRECTLY INTO THE MOTORLED FLOW. DO NOT DRIVE OR POSITION YOUR VEHICLE NEAR ON ROAD TRAFFIC WHEN THE MOTORLED FLOW IS POWERED ON – DOING SO MAY RESULT IN VISION IMPAIRMENT AND OR VEHICULAR COLLISION. THE INTENDED USE OF THE MOTOLED FLOW IS TO PROVIDE INTERIOR MOOD LIGHTING FOR USE OFF ROAD OR WHILE THE VEHICLE IS PARKED AND STATIONARY. THIS PRODUCT IS NOT DOT APPROVED.

INSTALLATION GUIDELINE

WARNING: SAFETY GLASSES MUST BE USED WHEN INSTALLING THIS PRODUCT.

MotorLED Flow is an exterior/interior auxiliary light designed to provide mood lighting while driving off road or while the vehicle is parked and stationary. MotorLED Flow has a distinct amperage draw noted in the installation instructions. If you are not confident in your ability to install the MotorLED Flow please consult a licensed mechanic.

MotorLED Flow has specific voltage and amperage ratings for power input and amperage draw. ENSURE THESE RATINGS ARE FOLLOWED. The MotorLED Flow must be installed in a properly functioning electrical system. Do not install this product in a malfunctioning electrical system.

Test fit to ensure that the light will fit and will not be damaged from heat or moving components. Ensure wiring is long enough to be safely installed and does not obstruct any operating functions of the vehicle. These lights should not be installed where their operation hinders the visibility of the driver or other drivers.

WARNING: DURING OPERATION LIGHTING UNITS CAN GET HOT - DO NOT TOUCH WHILE OPERATIONAL OR WITHIN 30 MINUTES OF POWERING DOWN.

Before disconnecting battery terminals, please check your owner's manual for proper procedure

WARNING: Cancer and Reproductive Harm - www.P65Warnings.ca.gov

Federal Communications Commission (FCC) Interference Statement

FCC ID: 2AMN5-78355

This equipment has been tested and found to comply with the limits for a Class B digital device, pursuant to Part 15 of the FCC Rules.

These limits are designed to provide reasonable protection against harmful interference in a residential installation. This equipment generates, uses and can radiate radio frequency energy and, if not installed and used in accordance with the instructions, may cause harmful interference to radio communications.

There is no guarantee that interference will not occur in a particular installation. If this equipment does cause harmful interference to radio or television reception, which can be determined by turning the equipment off and on, the user is encouraged to try to correct the interference by one of the following measures:

- Reorient or relocate the receiving antenna
- Increase the separation between the equipment and receiver
- Connect the equipment into an outlet on a circuit different from that to which the receiver is connected
- Consult the dealer or an experienced radio/TV technician for help

This device complies with Part 15 of the FCC Rules. Operation is subject to the following two conditions:

- (1) This device may not cause harmful interference, and (2) this device must accept any interference received, including interference that may cause undesired operation.

FCC Caution: Any changes or modifications not expressly approved by the party responsible for compliance could void the user's authority to operate this equipment.

RF exposure warning

This equipment complies with FCC radiation exposure limits set forth for an uncontrolled environment. The equipment must not be co-located or operating in conjunction with any other antenna or transmitter.

ALPENA® LIMITED WARRANTY

This Limited Warranty covers defects in materials or workmanship of this product for one (1) year from the date of purchase. Normal wear and tear over time are not product defects. Product problems caused by not following the product instructions, abuse, misuse, alteration, accident and/or use beyond the product's intended purpose are not covered. This warranty is valid for the original owner and is not transferable. Proof of purchase is required.

Any implied warranties and conditions, such as merchantability and fitness for a particular purpose are hereby excluded, or if not excludable under law, are limited to one (1) year period. Some jurisdictions do not allow limitations on how long an implied warranty lasts, so this limitation may not apply to you.

NO INCIDENTAL, CONSEQUENTIAL OR SPECIAL DAMAGES ARE RECOVERABLE. SOME JURISDICTIONS DO NOT ALLOW THE EXCLUSION OF INCIDENTAL, CONSEQUENTIAL OR SPECIAL DAMAGES. SO THE ABOVE LIMITATION OR EXCLUSION MAY NOT APPLY TO YOU. THIS WARRANTY GIVES YOU SPECIFIC LEGAL RIGHTS AND YOU MAY HAVE OTHER RIGHTS WHICH VARY DEPENDING ON THE JURISDICTION.

We will replace any product we determine to be defective provided you follow our product return directions. Please note that replacement product may not be exact due to style changes to our products. We will cover the mailing expense to send you a replacement product. However, mailing costs to return to us the original product which is claimed to be defective must be paid by you. If a replacement product is not available at the time you submit your warranty request, we will issue a credit.

For warranty service, please see below.

NORTH AMERICAN
SUPPORT AVAILABLE



@AlpenaAutomotive
1-800-387-3217

GET STARTED

WARNING



BE SURE TO USE SAFETY GLASSES AT ALL TIMES WHEN INSTALLING THIS PRODUCT.

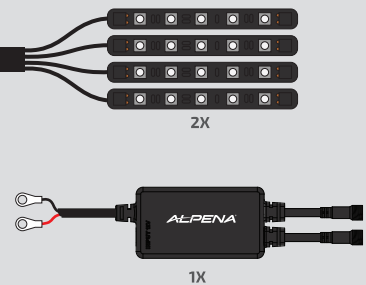

PACKAGE
CONTENTS

1. ASSEMBLY

- 1) Remove the unit from packaging, including all LED strips and the remote control.

2. MOUNTING

Select a mounting location that will not obstruct the operation of instruments or any vehicle functions, and will safely hold the body of the LED strip in place. Clean mounting surfaces with isopropyl alcohol (70%) and wait for the surface to dry before proceeding.

- 1) IDENTIFY AREAS THAT YOU WANT TO LIGHT UP WITH THE MOTORLED FLOW WITHOUT COMPROMISING THE LED STRIP. AVOID HEAT SOURCES LIKE EXHAUST, MOTOR, AND MOVING PARTS WHEN PICKING STRIP AND CONTROL BOX MOUNTING LOCATIONS.
- 2) SEPARATE THE LED STRIPS FROM THE HUB BY TURNING THE LOCKING RING COUNTER CLOCKWISE. THIS WILL HELP WITH RUNNING THE WIRES THROUGH TIGHT AREAS. (FIG. 2)
- 3) LOCATE A SECURE AND DRY PLACE FOR THE CONTROL BOX THAT SAFELY ROUTES WIRING (ENSURING ALL WIRING DOES NOT INTERFERE WITH VEHICLE FUNCTIONS) AND CLEAN THE SURFACE.
- 4) PEEL THE RED BACKING FROM THE CONTROL BOX ADHESIVE PAD AND STICK IT FIRMLY ON THE SURFACE.

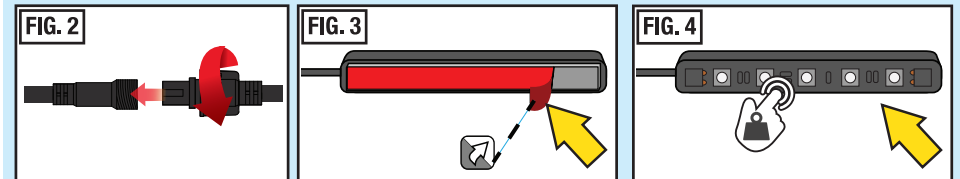

- 5) PEEL THE RED BACKING FROM THE ADHESIVE PAD FROM EACH LED STRIP AND PRESS THE LED UNITS FIRMLY ON TO THE MOUNTING LOCATION OR SURFACE. (FIG. 3 & FIG. 4)
- 6) RECONNECT THE CONNECTOR FROM STRIPS TO THE CONTROL HUB IF YOU SEPARATED THEM. TURN THE BARREL CONNECTOR CLOCKWISE TO LOCK.

3. WIRING

MAXIMUM POWER DRAW AT 12V DC 1.33A @ 12V DC

IMPORTANT – BEFORE REMOVING ADHESIVE BACKING OR WIRING TO A POWER SOURCE, TEST FIT AND TEST ROUTE ALL WIRING TO ENSURE IT DOES NOT ENCOUNTER ANY MOVING PARTS, IMPAIR ANY VEHICLE FUNCTIONS, OR POSE A RISK OF DRAGGING ON THE GROUND OR CATCHING A FOREIGN OBJECT

- 1) Prepare your vehicle by disconnecting the battery or power source. Follow the procedure in your owner's manual and always disconnect the ground (black or '-') first, followed by the positive (red or '+') wire
- 2) Connect the positive or red wire from the control box to the positive or red battery terminal or a safe, fused 12V DC power source.
- 3) Connect the negative or black wire from the control box to a safe, to battery or clean chassis ground location. See FIG. 5 below.

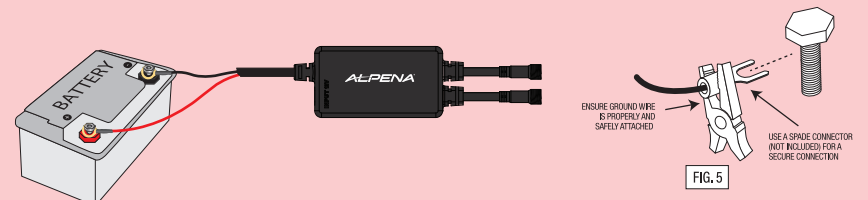

4. OPERATION

REMOTE BATTERY – CR2032 (ONLY REPLACE THE BATTERY IN THE REMOTE WITH THE EXACT MODEL SPECIFIED)

PAIR FUNCTION:

(FOR NEW OR EXTRA REMOTES)

ADD AND SYNC REMOTE:
1) PRESS THE 'PAIR' BUTTON FOR 5 SECONDS, ALL LEDES WILL TURN BRIGHT GREEN TO INDICATE THE REMOTE IS SUCCESSFULLY PAIRED TO THIS KIT - ONLY THIS REMOTE WILL OPERATE THE KIT NOW.

CANCEL PAIRED REMOTE:

1) PRESS THE 'PAIR' BUTTON FOR 3 SECONDS, THEN ALL LEDES WILL TURN BRIGHT RED AND INDICATE ANY REMOTE CAN NOW BE USED TO OPERATE THE KIT.

ON/OFF

Test operation by powering on the device – either by reconnecting the power source or activating power using a switch (depends on installation)

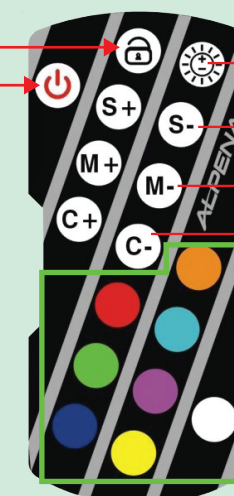

BRIGHTNESS LEVEL BRIGHT TO DIM
100% -> 75% -> 40%

SPEED CONTROL (S+ / S-): 5 SPEED MODES

FLOW PATTERNS (M+ / M-): PROGRAMMED 156 FLOW MODES

COLORS (C+ / C-): PROGRAMMED 54 COLOR OPTIONS, INCLUDING SINGLE COLORS

PRESET COLORS: 8 PROGRAMED SOLID COLORS