

ALPENA® 48 FLOGLO COMMAND INT

PART #: 77980E

WARNING: THE FAILURE TO FOLLOW THESE INSTRUCTIONS WHEN INSTALLING THE 48 FLOGLO COMMAND INT MAY CAUSE ELECTRICAL PROBLEMS IN YOUR VEHICLE WHICH COULD CAUSE VEHICLE DAMAGE, ELECTRICAL SYSTEM DAMAGE, FIRE, ELECTRICAL SHOCK, PERSONAL INJURY OR DEATH.

WARNING: DO NOT LOOK DIRECTLY INTO THE 48 FLOGLO COMMAND INT. DO NOT DRIVE OR POSITION YOUR VEHICLE NEAR ON ROAD TRAFFIC WHEN THE 48 FLOGLO COMMAND INT IS POWERED ON - DOING SO MAY RESULT IN VISION IMPAIRMENT AND OR VEHICULAR COLLISION. THE INTENDED USE OF THE 48 FLOGLO COMMAND INT IS TO PROVIDE INTERIOR AUXILIARY OR MOOD LIGHTING FOR USE OFF ROAD OR WHILE THE VEHICLE IS PARKED AND STATIONARY. THIS PRODUCT IS NOT DOT APPROVED.

INSTALLATION GUIDELINE

WARNING: SAFETY GLASSES MUST BE USED WHEN INSTALLING THIS PRODUCT.

48 Floglo Command Int is an interior auxiliary light designed to provide auxiliary or mood lighting while driving off road or while the vehicle is parked and stationary. 48 Floglo Command Int has a distinct amperage draw noted in the installation instructions. If you are not confident in your ability to install the 48 Floglo Command Int please consult a licensed mechanic.

48 Floglo Command Int has specific voltage and amperage ratings for power input and amperage draw.

ENSURE THESE RATINGS ARE FOLLOWED. The 48 Floglo Command Int must be installed in a properly functioning electrical system. Do not install this product in a malfunctioning electrical system.

Select a mounting location that will not obstruct the operation of instruments or any vehicle functions

Clean mounting surfaces with isopropyl alcohol (70%) and wait for the surface to dry before proceeding.

Before permanently mounting to vehicle, test fit to ensure wiring is long enough to be safely installed and does not obstruct any operating functions of the vehicle. These lights should not be installed where their operation hinders the visibility of the driver or other drivers

WARNING: DURING OPERATION LIGHTING UNITS CAN GET HOT - DO NOT TOUCH WHILE OPERATIONAL OR WITHIN 30 MINUTES OF POWERING DOWN

Before disconnecting battery terminals, please check your owner's manual for proper procedure

WARNING: Cancer and Reproductive Harm - www.P65Warnings.ca.gov

ALPENA® LIMITED WARRANTY

This Limited Warranty covers defects in materials or workmanship of this product for one (1) year from the date of purchase. Normal wear and tear over time are not product defects. Product problems caused by not following the product instructions, abuse, misuse, alteration, accident and/or use beyond the product's intended purpose are not covered. This warranty is valid for the original owner and is not transferable. Proof of purchase is required.

Any implied warranties and conditions, such as merchantability and fitness for a particular purpose are hereby excluded, or if not excludable under law, are limited to one (1) year period. Some jurisdictions do not allow limitations on how long an implied warranty lasts, so this limitation may not apply to you

NO INCIDENTAL, CONSEQUENTIAL OR SPECIAL DAMAGES ARE RECOVERABLE. SOME JURISDICTIONS DO NOT ALLOW THE EXCLUSION OF INCIDENTAL, CONSEQUENTIAL OR SPECIAL DAMAGES, SO THE ABOVE LIMITATION OR EXCLUSION MAY NOT APPLY TO YOU. THIS WARRANTY GIVES YOU SPECIFIC LEGAL RIGHTS AND YOU MAY HAVE OTHER RIGHTS WHICH VARY DEPENDING ON THE JURISDICTION.

We will replace any product we determine to be defective provided you follow our product return directions. Please note that replacement product may not be exact due to style changes to our products. We will cover the mailing expense to send you a replacement product. However, mailing costs to return to us the original product which is claimed to be defective must be paid by you. If a replacement product is not available at the time you submit your warranty request, we will issue a credit.

For warranty service, please contact us at feedback@alpenna.com

NORTH AMERICAN SUPPORT AVAILABLE | @AlpenaAutomotive | 1-800-387-3217

GET STARTED

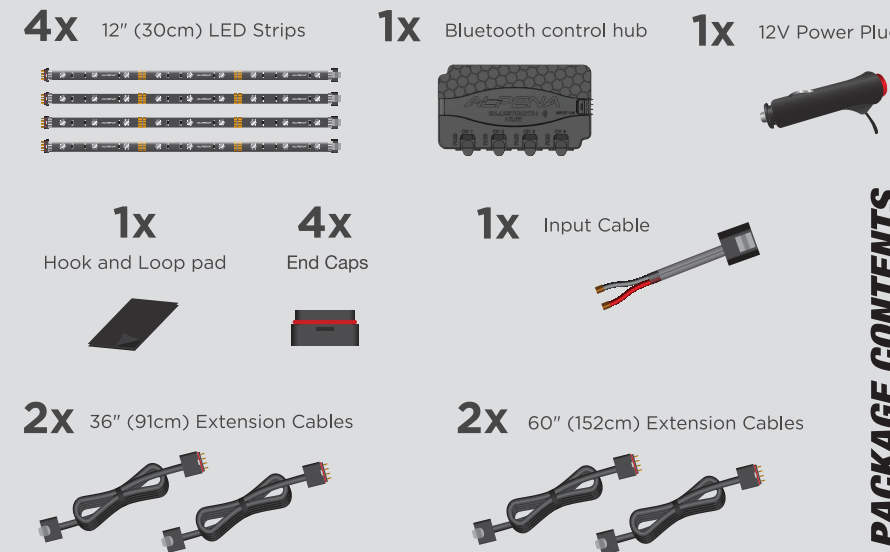

PACKAGE CONTENTS

1. ASSEMBLY

REMOVE THE UNIT FROM PACKAGING, INCLUDING ALL MOUNTING HARDWARE AND WIRING

2. WIRING

MAX. AMOUNT OF STRIPS CONNECTED - 3 PER CHANNEL
MAX POWER DRAW @ 12V DC - 0.62

IMPORTANT - BEFORE REMOVING ADHESIVE BACKING OR WIRING TO ANY EXISTING FLOGLO PRODUCT, TEST FIT AND TEST ROUTE ALL WIRING TO ENSURE IT DOES NOT ENCOUNTER ANY MOVING PARTS, IMPAIR ANY VEHICLE FUNCTIONS

IF YOU WISH TO CUT AND SHORTEN THE STRIP, CUT ALONG THE SCISSOR MARKINGS ON THE STRIP AND SEAL THE END WITH WATERPROOF

AUTOMOTIVE SILICONE. STRIPS CANNOT BE RE-CONNECTED TO ANY OTHER PRODUCT ON THE CUT AND SEALED END.

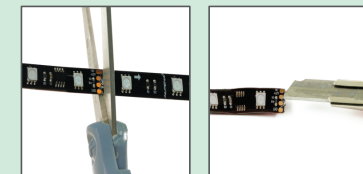

12V ADAPTER INSTRUCTIONS

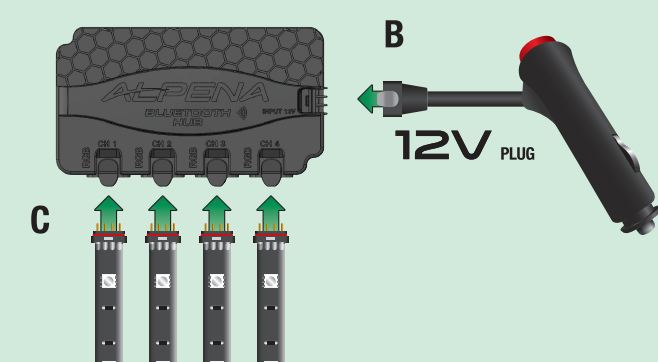

THE ALPENALINK™ POWER ADAPTER CAN BE USED ON ANY 12V DC POWER OUTLET OR CIGARETTE LIGHTER SOCKET ENSURE THE OUTLET IS PROPERLY FUNCTIONING BEFORE INSTALLING OR USING THIS ADAPTER

- PLUG THE POWER ADAPTER INTO THE DESIRED POWER SOCKET, MAKING SURE THE RED BUTTON IS NOT ON POWER IS NOT TOGGLED 'ON'
- CAREFULLY PLUG THE FEMALE ALPENALINK™ CONNECTOR ON THE END OF THE ADAPTER INTO THE MALE ALPENALINK™ CONNECTOR ON THE BLUETOOTH HUB MARKED 'INPUT 12V' - EXTENSIONS MAY BE USED BETWEEN THE POWER ADAPTER AND THE BLUETOOTH HUB.
- CONNECT A SINGLE OR BOTH FLOGLO STRIPS TO AN OUTPUT CHANNEL (MARKED CH1, CH2, CH3, CH4) ON THE BLUETOOTH HUB. TAKING CARE TO SECURE THE CLIPS WITHOUT DAMAGE TO THE PINS. NOTE - SEE STRIP COMPATIBILITY CHART TO FIND OUT HOW MANY STRIPS AND WHAT EXTENSION STRIPS ARE COMPATIBLE WITH THIS PRODUCT - THE INCLUDED EXTENSIONS AND COMPATIBLE ALPENALINK™ EXTENSIONS MAY BE USED BETWEEN FLOGLO STRIPS OR BETWEEN THE BLUETOOTH HUB AND FLOGLO STRIPS
- CHECK TO MAKE SURE ALL ALPENALINK™ CONNECTIONS ARE SECURE.
- SWITCH POWER ON BY PRESSING DOWN ON THE RED BUTTON ON THE POWER ADAPTER, AND BY PRESSING THE POWER BUTTON ON THE REMOTE - THE STRIPS SHOULD NOW FLASH IN A DEMONSTRATION SEQUENCE

COMPATIBILITY



WARNING: DO NOT USE FLOGLO™ LED STRIPS WITH MAX LED STRIPS TOGETHER. DO NOT USE MAX LED™ STRIPS WITH THIS CONTROLLER.

HARDWARE INSTRUCTIONS

- PREPARE YOUR VEHICLE BY DISCONNECTING THE BATTERY OR POWER SOURCE. FOLLOW THE PROCEDURE IN YOUR OWNER'S MANUAL AND ALWAYS DISCONNECT THE GROUND (BLACK OR '-') FIRST, FOLLOWED BY THE POSITIVE (RED OR '+') WIRE
- STRIP AWAY THE PROTECTIVE SHIELD ON THE RED AND BLACK LEADS ON THE PIGTAIL (COMING FROM THE ALPENALINK™ CONNECTOR WHICH IS CONNECTED TO THE CONTROL BOX)
- CONNECT THE POSITIVE OR RED WIRE FROM THE CONTROL BOX TO THE POSITIVE OR RED BATTERY TERMINAL OR A SAFE, FUSED 12V DC POWER SOURCE
- CONNECT THE NEGATIVE OR BLACK WIRE FROM THE CONTROL BOX TO A SAFE, CLEAN CHASSIS GROUND LOCATION
- CONNECT THE ALPENALINK™ END OF THE HARDWIRE PIGTAIL TO THE ALPENALINK™ MARKED '12V INPUT' ON THE BLUETOOTH HUB

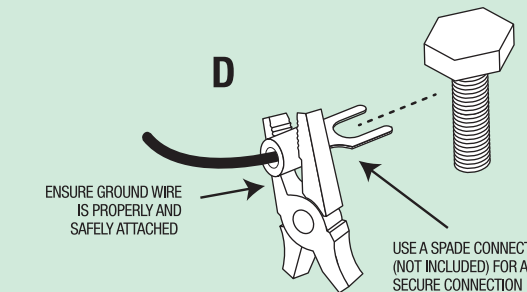
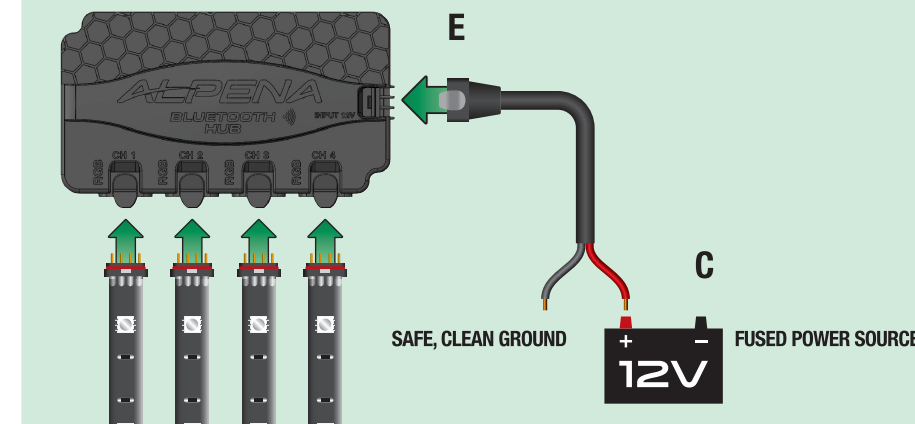

3. MOUNTING

FOR BEST RESULTS, TEMPERATURE AT INSTALLATION SHOULD BE BETWEEN 65-90°F (18-32°C)

- ENSURE MOUNTING SURFACE IS PROPERLY CLEANED AND IS ABSENT OF WATER, OILS, WAX, SEALANT AND OTHER SURFACE COATINGS. SURFACE MUST BE COMPLETELY CLEAN AND DRY DURING INSTALLATION FOR ADHESIVE TO FUNCTION
- TO ATTACH THE ADHESIVE BACKING ON EACH LED STRIP, GENTLY PEEL THE RED BACKING AWAY FROM THE ADHESIVE PAD AND FIRMLY BUT GENTLY PRESS THE GREY SIDE ON TO THE MOUNTING SURFACE - DO NOT APPLY PRESSURE DIRECTLY TO THE LED CHIPS.
- WHEN EACH STRIP IS ATTACHED, SAFELY SECURE THE WIRING TO MAKE SURE IT DOES NOT COME INTO CONTACT WITH ANY ROTATING ASSEMBLIES, DOES NOT COME LOOSE AND CATCH FOREIGN OBJECTS, AND DOES NOT INTERFERE WITH ANY VEHICLE FUNCTIONS
- HARDWIRE INSTALL ONLY** - RECONNECT THE BATTERY TERMINALS OR POWER SOURCE. NEGATIVE (BLACK OR '-') FIRST, FOLLOWED BY POSITIVE (RED OR '+') MAKING SURE ALL CONNECTIONS ARE SAFE AND SECURE
- WHEN THE CONTROL BOX HAS POWER, THE STRIPS SHOULD NOW FLASH IN A DEMONSTRATION SEQUENCE

4. OPERATION

THE LED LIGHTING SYSTEM SHOULD BE IN 'DEMO' MODE, DISPLAYING COLOR. IF YOUR KIT IS TURNED OFF, CHECK:

- POWER SOURCE TO SEE IF THERE IS CURRENT FLOW
 - THE MASTER POWER SWITCH
 - WIRING CONNECTIONS BETWEEN THE HUB AND STRIPS
- FOLLOW THE ALPENA APP GUIDE (INCLUDED) AND ENJOY!

1. GET THE APP

Download the Alpena Auto application on the Apple App Store or Google Play Store!

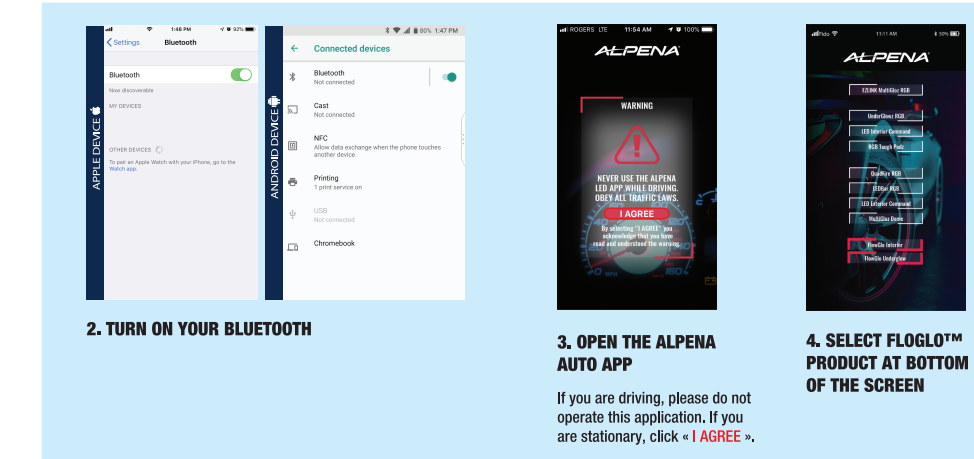
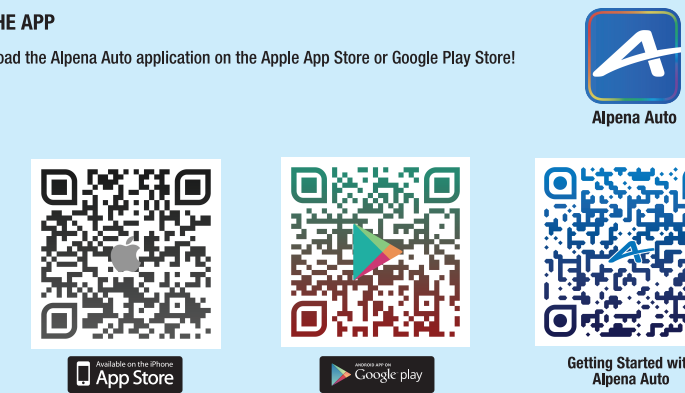

Federal Communications Commission (FCC) Interference Statement

FCC ID: 2AMN5-77980

This equipment has been tested and found to comply with the limits for a Class B digital device, pursuant to Part 15 of the FCC Rules.

These limits are designed to provide reasonable protection against harmful interference in a residential installation. This equipment generates, uses and can radiate radio frequency energy and, if not installed and used in accordance with the instructions, may cause harmful interference to radio communications.

There is no guarantee that interference will not occur in a particular installation. If this equipment does cause harmful interference to radio or television reception, which can be determined by turning the equipment off and on, the user is encouraged to try to correct the interference by one of the following measures:

- Reorient or relocate the receiving antenna
- Increase the separation between the equipment and receiver
- Connect the equipment into an outlet on a circuit different from that to which the receiver is connected
- Consult the dealer or an experienced radio/TV technician for help

This device complies with Part 15 of the FCC Rules. Operation is subject to the following two conditions:

- (1) This device may not cause harmful interference, and
- (2) this device must accept any interference received, including interference that may cause undesired operation.

FCC Caution: Any changes or modifications not expressly approved by the party responsible for compliance could void the user's authority to operate this equipment.

RF exposure warning

This equipment complies with FCC radiation exposure limits set forth for an uncontrolled environment. The equipment must not be co-located or operating in conjunction with any other antenna or transmitter.

The Bluetooth® word mark and logos are registered trademarks owned by the Bluetooth SIG, Inc. and any use of such marks by Marklyn Group Inc. is under license. Other trademarks and trade names are those of their respective owners.

Compatible with phones with Android™ 9 or higher. Note: Not all Android™ phones are equipped with Bluetooth® Smart v4.0 required for this application. Android, Google Play, and the Google Play logo are trademarks of Google Inc.

Compatible with iPhone 6 and higher, iPad 5th Gen or newer, iPad Air, iPad Mini, and iPad Pro. Requires iOS 8.0 or higher. Apple, iPhone, iPad, iPad Air, iPad Mini, and the Apple logo are trademarks of Apple Inc. App Store is a service mark of Apple Inc.

3MTM is a trademark of 3MTM Company
Patent: US836,071S / US1044383B1

Marklyn Group Inc. 753011 2nd line EHS Mono, ON, Canada L9W 5W4
Alpena® is a registered trademark of Marklyn Group Inc. © Copyright 2022
Made in China