



LED HiLITZ™

PART #: 77679

⚠ WARNING: THE FAILURE TO FOLLOW THESE INSTRUCTIONS WHEN INSTALLING THE LED HiLITZ MAY CAUSE ELECTRIC PROBLEMS IN YOUR VEHICLE WHICH COULD CAUSE VEHICLE DAMAGE, ELECTRICAL SYSTEM DAMAGE, FIRE, ELECTRICAL SHOCK, PERSONAL INJURY OR DEATH.

⚠ WARNING: DO NOT LOOK DIRECTLY INTO THE LED HiLITZ. DO NOT DRIVE OR POSITION YOUR VEHICLE NEAR ONCOMING TRAFFIC WHEN THE LED HiLITZ IS POWERED ON – DOING SO MAY RESULT IN VISION IMPAIRMENT AND OR VEHICULAR COLLISION. THE INTENDED USE OF THE LED HiLITZ IS TO PROVIDE EXTERIOR AUXILIARY LIGHTING FOR OFF ROAD USE ONLY. THIS PRODUCT IS NOT DOT APPROVED.

YOU MUST CONSULT YOUR VEHICLE OWNER'S MANUAL TO DETERMINE THE LOCATION OF AIRBAG SENSORS BEFORE INSTALLATION. THE MANUFACTURER OR THE RETAILER IS NOT RESPONSIBLE FOR INFLATION OF AIRBAGS OR DAMAGE TO AIRBAG SENSORS DUE TO THE INSTALLATION OF THIS PRODUCT.

INSTALLATION GUIDELINE

⚠ WARNING: SAFETY GLASSES MUST BE USED WHEN INSTALLING THIS PRODUCT.

LED HiLitz is an auxiliary light designed to provide exterior auxiliary and accent lighting while driving off road. LED HiLitz has a distinct amperage draw below in the installation instructions. If you are not confident in your ability to install the DashLitz please consult a licensed mechanic.

LED HiLitz has specific voltage and amperage ratings for power input and amperage draw. ENSURE THESE RATINGS ARE FOLLOWED. The LED HiLitz must be installed in a properly functioning vehicle electrical system. Do not install this product in a malfunctioning vehicle electrical system.

Select a mounting location that will not obstruct the operation of the driver

Clean mounting surfaces before installing units using water or a 50/50 mix of water and rubbing alcohol.

Before permanently mounting to vehicle, test fit to ensure wiring is long enough to be safely installed and does not obstruct any operating functions of the vehicle. These lights should not be installed where their operation hinders the visibility of the driver or other drivers

⚠ WARNING: DURING OPERATION LIGHTING UNITS CAN GET HOT - DO NOT TOUCH WHILE OPERATIONAL OR WITHIN 30 MINUTES OF POWERING DOWN.

Before disconnecting battery terminals, please check your owner's manual for proper procedure.

ALPENA® LIMITED WARRANTY

This Limited Warranty covers defects in materials or workmanship of this product for one (1) year from the date of purchase. Normal wear and tear over time are not product defects. Product problems caused by not following the product instructions, abuse, misuse, alteration, accident and/or use beyond the product's intended purpose are not covered. This warranty is valid for the original owner and is not transferable. Proof of purchase is required.

Any implied warranties and conditions, such as merchantability and fitness for a particular purpose are hereby excluded, or if not excludable under law, are limited to one (1) year period. Some jurisdictions do not allow limitations on how long an implied warranty lasts, so this limitation may not apply to you

NO INCIDENTAL, CONSEQUENTIAL OR SPECIAL DAMAGES ARE RECOVERABLE. SOME JURISDICTIONS DO NOT ALLOW THE EXCLUSION OF INCIDENTAL, CONSEQUENTIAL OR SPECIAL DAMAGES, SO THE ABOVE LIMITATION OR EXCLUSION MAY NOT APPLY TO YOU. THIS WARRANTY GIVES YOU SPECIFIC LEGAL RIGHTS AND YOU MAY HAVE OTHER RIGHTS WHICH VARY DEPENDING ON THE JURISDICTION.

We will replace any product we determine to be defective provided you follow our product return directions. Please note that replacement product may not be exact due to style changes to our products. We will cover the mailing expense to send you a replacement product. However, mailing costs to return to us the original product which is claimed to be defective must be paid by you. If a replacement product is not available at the time you submit your warranty request, we will issue a credit.

For warranty service, please see below.

Problems? We can solve them!
1-800-387-3217
feedback@alpena.ca
www.alpena.ca



AlpenaAutomotive

GET STARTED

⚠ WARNING



BE SURE TO USE SAFETY GLASSES AT ALL TIMES WHEN INSTALLING THIS PRODUCT.



2X

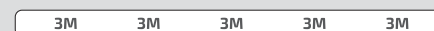

2X

PACKAGE CONTENTS

2. PLACEMENT

SEE DIAGRAM FOR TYPICAL MOUNTING LOCATIONS / PRODUCT PLACEMENT

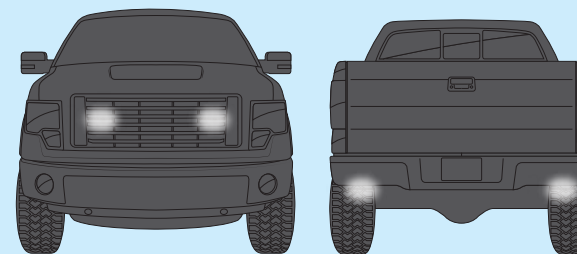

3. WIRING

MAX. POWER REQUIREMENTS 0,3A @ 12V DC 0,15A @ 24V DC

ATTACH POSITIVE WIRE SECURELY TO A 12V DC FUSED POWER SOURCE. EXTENSION OF THE WIRING MAY BE NECESSARY. CAN BE WIRED INTO A SWITCH THAT WILL SUPPORT THE 0,3A DRAW AT 12V DC / 0,15A DRAW AT 24V DC.

ATTACH BLACK GROUND WIRE TO A SAFE, CLEAN GROUND LOCATION SUCH AS A CHASSIS GROUND POINT

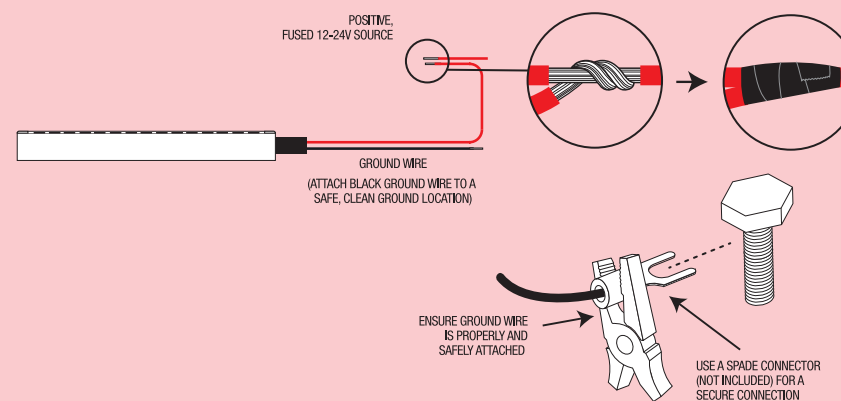

4. MOUNTING

SELECT A MOUNTING LOCATION, ENSURE WIRING IS LONG ENOUGH, DOES NOT INTERFERE WITH ANY VEHICLE FUNCTIONS AND DOES NOT PLACE THE WIRING OR UNITS IN AREAS OF EXTREME HEAT. THE LIGHT CAN BE MOUNTED IN EITHER A VERTICAL OR HORIZONTAL ORIENTATION.

CLEAN MOUNTING SURFACES OF ALL CONTAMINANTS BEFORE ADHERING 3M TAPE – CONSULT DIAGRAMS FOR DIFFERENT MOUNTING STYLES

