

ALPENA® 24IN STARTER KITS - ULTRA

⚠ WARNING: THE FAILURE TO FOLLOW THESE INSTRUCTIONS WHEN INSTALLING THE LED STRIPS MAY CAUSE ELECTRIC PROBLEMS IN YOUR VEHICLE WHICH COULD CAUSE VEHICLE DAMAGE, ELECTRICAL SYSTEM DAMAGE, FIRE, ELECTRICAL SHOCK, PERSONAL INJURY OR DEATH.

INSTALLATION GUIDELINE

This product has a distinct amperage draw and power input rating below in the installation instructions. THIS RATING MUST BE FOLLOWED. If you are not confident in your ability to install the Alpena® LED strips (the "product"), please consult a licensed mechanic.

The product must be installed in a properly functioning vehicle electrical system. Do not install this product in a malfunctioning vehicle electrical system. Do not modify the product in a way that is not intended in the instructions below.

The intended use of these strips is to provide accent & auxiliary lighting for off road use only. This product is not DOT approved.

⚠ WARNING: Safety glasses must be used when installing this product

Strip Modification (diagram)

1. If you wish to cut the strip down to a specific size or to utilize the contact points to join two sections use a pair of scissors along the section of the LED, between the bronze contact points, and cut right on the scissors marking.
2. If you wish to join two cut sections of LED strip, carefully use a hobby knife to remove the clear protective coating above the bronze contact points in the LED strip – DO NOT DAMAGE THE CONTACT POINTS.
3. Use either a section of the included power wire or automotive wire of the similar size and gauge to join strips and heat shrink tubing to seal connections.
4. Solder stripped ends of the wire to the bronze contact points ensuring the positive and negative contacts correspond to the right wires.
5. Seal the connection with heat shrink tubing using a hair dryer or a heat gun on a low setting.

INSTALLATION INSTRUCTIONS

12 VOLT USE ONLY

For best results, temperature at installation should be between 65-90°F (18-32°C).

1. Clean mounting surfaces with isopropyl alcohol (70%) and wait for the surface to dry before proceeding
2. Test fit into intended location
3. Carefully remove adhesive back and firmly press into intended location
4. The clear protective surface of LED strips are temperature sensitive and in cold weather the LED strip or installation surface should be warmed with a hairdryer
5. The black with grey stripe is the 12V + positive and the black solid wire is ground wire
6. Before connecting to power, ensure all strips are connected and secure

WARRANTY

The manufacturer warrants the UltraGlowz™ products when they are properly installed, connected, and operated, for a period of 1 year from the date of purchase. The warranty is void and neither the manufacturer nor the retailer is responsible for any product failure, damage, or injury if these instructions are not strictly followed.

⚠ WARNING: Cancer and Reproductive Harm - www.P65Warnings.ca.gov

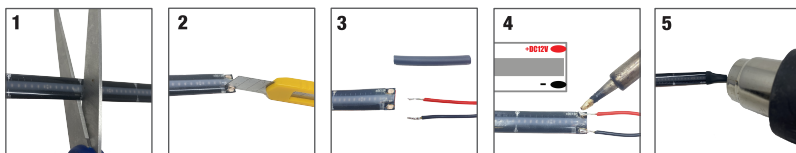

MAXIMUM POWER REQUIREMENT CHART

PART #	PRODUCT NAME	VOLTAGE	Amp @ 12V DC	Watts @ 12V DC
78440	24in Starter Kits - Ultra Blue	12-24V DC	2.05A	24.6W
78441	24in Starter Kits - Ultra White	12-24V DC	4.85A	58.2W
78444	24in Starter Kits - Ultra Red	12-24V DC	7.91A	95W
78445	24in Starter Kits - Ultra Purple	12-24V DC	11.6A	140W
78448	24in Starter Kits - Ultra Green	12-24V DC	3.75A	45W
78450	24in Starter Kits - Ultra Fuchsia	12-24V DC	5.84A	70W
78451	24in Starter Kits - Ultra Amber	12-24V DC	8.33A	100W

3M™ is a trademark of 3M™ Company

Marklyn Group Inc. 753011 2nd line EHS Mono, ON, Canada L9W 5W4
Alpena® is a registered trademark of Marklyn Group Inc. © Copyright 2022
Made in China



NOTE: Do not bend the LED strips in a radius of less than 5/8" (15mm) or circuit traces will be damaged and void warranty.



NOTE: Do not bend LED strips on horizontal plane, this will damage circuit traces and void warranty.

NORTH AMERICAN
SUPPORT AVAILABLE



@AlpenaAutomotive
1-800-387-3217