

QUICK START

Shokz Loop110 USB-A/USB-C Bluetooth® Adapter

Model CL110A, CL110C

ENGLISH

Pairing

1. Put the Shokz headset in pairing mode, just like when pairing with other mobile devices. It will say "Pairing", and the headset's LED light will alternately flash red and blue.
2. Plug the USB adapter into a USB port on your PC.

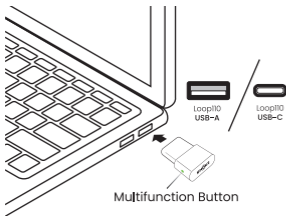

3. Connection is established when Audrey says "Connected" or beeps, and the LED on the USB adapter is solid blue.

Configure

To play music or take calls on the headset, please ensure that "Shokz Loop110" is both identified as the default input and output devices in your operating system's audio settings.

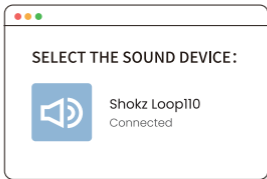

Multifunction Button

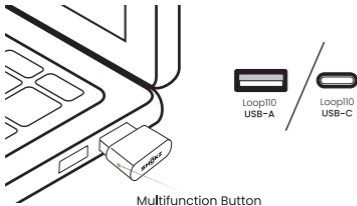

Pair to a headset:

Press and hold for 2 seconds







LED: Flashes red and blue alternatively

Reconnect to the last connected headset:

Click once

LED: Flashes blue every second

LED on the bluetooth adapter

-  **Pairing Mode:** Flashes red and blue alternatively
-  **Reconnect Mode:** Flashes blue every second
-  **Standby Mode:** Flashes blue every five seconds and stop flashing in one minute
-  **Bluetooth Connection:** Solid blue
-  **Streaming Music/Media:** Solid blue
-  **On a call:** Solid green
-  **Mute during a call:** Solid red