

Ushering in a New Era of Garden Tidy

NaTiddy

20V String Trimmer/Edger

Instruction Manual

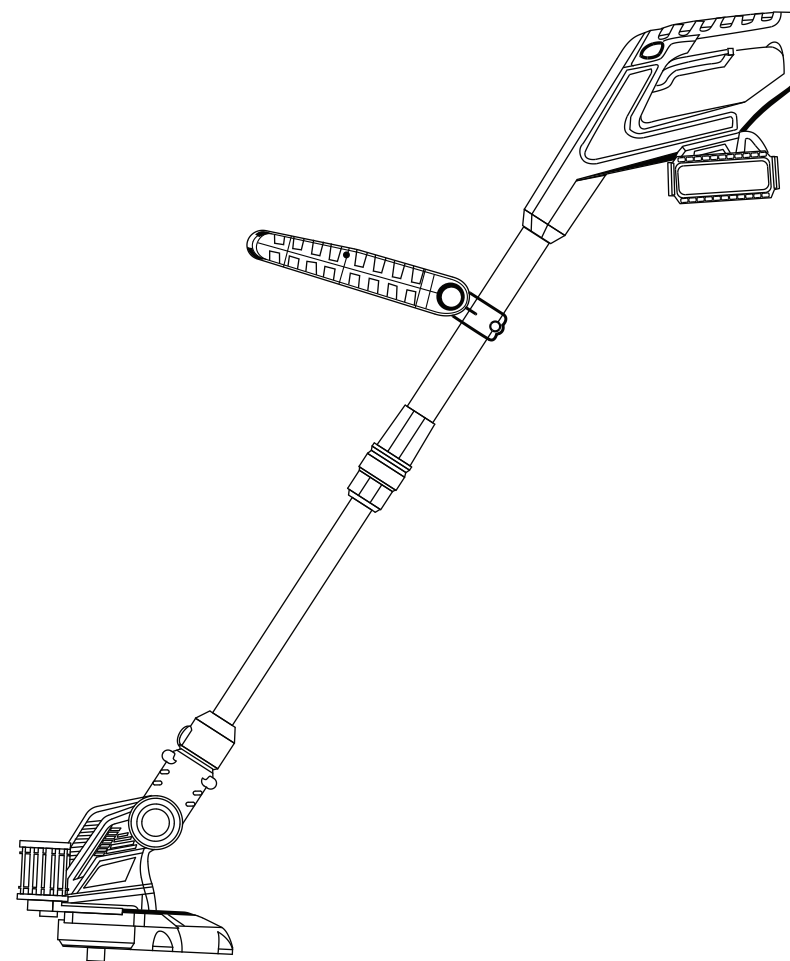

Contents

1. Safety Instructions.....	3
2. Product Specifications.....	9
3. Relevant Symbols.....	10
4. Charging Procedure.....	11
5. Major Parts of the Grass Trimmer.....	13
6. Assembly Tips.....	14
7. Operation.....	16
8. Maintenance, Storage and Disposal.....	18

1. Safety Instructions

--General Safety Instructions



WARNING! Read all safety warnings and all instructions.

Failure to follow the warnings and instructions may result in electric shock, fire and/or serious injury.

Save all warnings and instructions for future reference.

The term "power tool" in the warnings refers to your mains-operated (corded) power tool or battery pack-operated (cordless) power tool.

- This product is not intended for use by persons (including children) with reduced physical, sensory or mental capabilities, or who lack experience and knowledge, unless they have been given supervision or instruction concerning the use of the appliance by a person responsible for their safety.
- Only use the product in the manner and for the functions described in these instructions.

Work Area Safety

- Keep work area clean and well lit. Cluttered or dark areas may invite accidents.
- Do not operate power tools in explosive atmospheres, such as in the presence of flammable liquids, gases or dust. Power tools will spark normally, which may ignite the dust or fumes.
- Keep children and bystanders away while operating a power tool. Distractions can cause you to lose control.

Electrical Safety

- Power tool plugs must match the outlet. Never modify the plug in any way. Do not use any adapter plugs with earthed (grounded) power tools. Unmodified plugs and matching outlets will reduce the risk of electric shock.
- Do not expose power tools to rain or wet conditions. Water entering a power tool will increase the risk of electric shock.
- Do not abuse the cord. Never use the cord for carrying, pulling or unplugging the power tool. Keep cord away from heat, oil, sharp edges or moving parts. Damaged or entangled cords increase the risk of electric shock.
- When operating a power tool outdoors, use an extension cord suitable for outdoor use. Use of a cord suitable for outdoor use reduces the risk of electric shock.
- If the supply cord is damaged, it must be replaced by the manufacturer, its service agent or similar qualified persons in order to avoid hazards.
- It is recommended that the appliance should be supplied via a residual current device (RCD) with a tripping current of not more than 30mA.

Personal Safety

- Stay alert, watch what you are doing and use common sense when operating a power tool. Do not use a power tool while you are tired or under the influence of drugs, alcohol or medication. A moment of inattention while operating power tools may result in serious personal injury.
- Use personal protective equipment. Always wear eye protection. Protective equipment such as dust mask, non-skid safety shoes, hard hat, or hearing protection used for appropriate conditions will reduce personal injuries.
- Prevent unintentional starting. Ensure the switch is in the off-position before connecting to power source and/or battery pack, picking up or carrying the tool. Carrying power tools with your finger on the switch or energizing power tools that have the switch on invites accidents.
- Remove any adjusting key or wrench before turning the power tool on. A wrench or a key left attached to a rotating part of the power tool may result in personal injury.
- Do not overreach. Keep proper footing and balance at all times. This enables better control of the power tool in unexpected situations.
- Dress properly. Do not wear loose clothing or jewelry. Keep your hair, clothing and gloves away from moving parts. Loose clothes, jewelry or long hair can be caught in moving parts.

Use and Care of Power Tool

- **Do not force the power tool.** Use the correct power tool for your application. The correct power tool will do the job better and more safely at the rate for which it was designed.
- **Do not use the power tool if the switch cannot turn it on and off.** Any power tool that cannot be controlled with the switch is dangerous and must be repaired.
- **Disconnect the plug from the power source and/or the battery pack from the power tool before making any adjustments, changing accessories, or storing power tools.** Such preventive safety measures reduce the risk of starting the power tool accidentally.
- **Store idle power tools in a place out of the reach of children and do not allow persons unfamiliar with the power tool or these instructions to operate the power tool.** Power tools are dangerous in the hands of untrained users.
- Maintain power tools. Check for alignment or binding of moving parts, breakage of parts and any other condition that may affect the power tool's operation. If damaged, have the power tool repaired before use. Many accidents are caused by poorly maintained power tools.

- **Keep cutting parts sharp and clean.** Properly maintained cutting tools with sharp cutting edges are less likely to bind and are easier to control.

- Use the power tool, accessories and tool bits etc. in accordance with these instructions and take into account the working conditions and the work to be performed. Use of the power tool for operations different from those intended could result in a hazardous situation.

Service

Have your power tool serviced by a qualified repair person using only identical replacement parts. This will ensure that the safety of the power tool is maintained.

Additional Safety Warnings Important

Read carefully before use

Keep for future reference

Training

- Read the instructions carefully. Be familiar with the controls and the proper use of the appliance.

- Never allow children to use the product.

- Never allow people unfamiliar with these instructions to use the appliance. Local regulations may restrict the age of the operator.

- Never operate the appliance while people, especially children, or pets are nearby.

- The operator or user is responsible for accidents or hazards happening to other people or their property.

Preparation

- Wear safety goggles and ear muffs while operating.

- Always wear substantial footwear and long trousers. Do not operate the equipment when you are barefoot or wearing open sandals.

- Always wear suitable working clothes during working, which allow freedom of movement.

- Never operate the appliance which is damaged, incomplete or changed without approval of the manufacturer.

Operation

- Disconnect the battery from the product: whenever you leave the product, before clearing a blockage, before checking, cleaning or working on the product, if the product starts to vibrate abnormally.

- Operate the product only in daylight or in good artificial light.

- Do not overreach and keep your balance at all times.

- Always be sure of your footing on slopes.

- Walk, never run.

Maintenance and Storage

- 1). Keep all nuts, bolts and screws tight to make sure that the product is in safe working condition.

- 2). Check the collection bag frequently for wear or deterioration.

- 3). Replace worn or damaged parts.

- 4). Store the product only in a dry place.

- 5). Only use spare parts and accessories approved by the manufacturer.

Residual Risks

Even if you are operating this product in accordance with the provisions, residual risks will always still remain. The following dangers can arise in connection with the structure and design of this product:

- 1). Health defects resulting from vibration emission if the product is being used over longer period of time or not adequately managed and properly maintained.

2). Injuries and damage to property due to broken accessories or hidden objects that are suddenly dashed.

3). Injuries and damage to property due to thrown and fallen objects.

WARNING! This product produces an electromagnetic field during operation! This field may interfere with active or passive medical implants under some circumstances! To reduce the risk of serious or fatal injury, we recommend persons with medical implants to consult their physicians and the manufacturer of medical implant before operating this product !

Vibration and Noise Reduction

To reduce the impact of noise and vibration emission, limit the time of operation, use low-vibration and low-noise operating modes as well as wear personal protective equipment.

Emergency

Familiarise yourself with the use of this product by means of this instruction manual. Memorise the safety directions and follow them to the letter. This will help to prevent risks and hazards.

1). Always be alert when using this product, so that you can recognize and handle risks early. Fast intervention can prevent serious injury and damage to property.

2). Stop the motor and disconnect the battery from the product if there is any malfunction. Have the product checked by a qualified professional and repaired, if necessary, before you put it into operation again.

Safety Warnings and Instructions: Batteries

- Do not disassemble or open, drop (mechanical abuse), crush, bend or deform, puncture, or shred the battery/tool.
- Do not modify or remanufacture the battery or tool, attempt to insert foreign objects into the battery, immerse or expose to water or other liquids, or expose to fire and excessive heat including soldering irons, or put in microwave oven.
- Only use the battery/tool with a charging system specified by the manufacturer/-supplier.
- Do not short-circuit a battery or allow metallic or conductive objects to contact both battery terminals simultaneously.
- Dispose of used batteries promptly according to the manufacturer/supplier's instructions.
- Improper battery/tool use may result in a fire, explosion, or other hazards.
- Battery/tool usage by children should be supervised.

Safety Warnings and Instructions: Charging

1. This manual contains important safety and operating instructions.

2. Before using battery charger, read all instructions and cautionary warnings on battery charger and product using battery. **CAUTION:** To reduce the risk of injury, use this charger only with this product. Batteries in other products may burst, causing personal injury or damage.

3. Do not expose charger to rain or snow.

4. Use of an attachment not recommended may result in the risk of fire, electric shock, or injury to persons.

5. To reduce the risk of damage to electric plug and cord, pull plug rather than cord when disconnecting charger.

6. Make sure that the cord is located so that it will not be stepped on, tripped over, or subject to damage or stress.

7. An extension cord should not be used unless absolutely necessary. Improper use of extension cord could result in a risk of fire, electric shock or electrocution.

a. An extension cord must have adequate wire size (AWG or American Wire Gauge) for safety, and to prevent loss of power and overheating. The smaller the gauge number of the wire, the greater the capacity of the cable; that is, 16 gauge has more capacity than 18 gauge. When using more than one extension to make up the total length, make sure that each extension cord contains at least the minimum wire size.

Chart for Minimum Wire Size (AWG) of Extension Cords

Nameplate Rating AMPS-0- 10.0

Total Extension Cord Length (ft)	0-25	26-50	51-100	101-150-25
	(0-7.6m)	(7.6-15.2m)	(15.2-30.4m)	(30.4-45.7m)
Wire Gauge	18	16	16	14

8. Use only the supplied charger when charging your tool. The use of any other charger could damage the tool or create a hazardous condition.

9. Use only one charger when charging.

10. Do not attempt to open the charger. There are no customer serviceable parts inside. Return to any authorized service center.

11. DO NOT incinerate the tool or batteries even if they are severely damaged or completely worn out. The batteries can explode in a fire. Toxic fumes and materials are created when lithium ion battery packs are burned.

12. Do not charge or use battery in explosive atmospheres, such as in the presence of flammable liquids, gases or dust. Inserting or removing the battery from the charger may ignite the dust or fumes.

13. If battery contents come into contact with the skin, immediately wash the area with mild soap and water. If battery liquid gets into the eye, rinse water over the open eye for three minutes or until irritation ceases. If medical attention is needed, the battery electrolyte is composed of a mixture of liquid organic carbonates and lithium salts.







WARNING: Burn hazard. Battery liquid may be flammable if exposed to spark or flame.

2. Product Specifications

Model	GB-ST002
Rated Voltage	20V DC
No Load Speed	8500rpm
Cutting Device	Trimmer Line
Cutting Swath Diameter	12inch(300mm)
Weight (with battery pack)	2.4kg/5.29lbs
Guaranteed sound power level	92dB(A)
Battery Pack	Lithium Ion - 4.0Ah
Battery Charger	Output 2000mA

These instructions should be read in conjunction with the instruction manual for the battery pack and charger.

3. Relevant Symbols

	Warning, safety alert.
	Read and follow all safety precautions in the owner manual.
	Protective goggles/visor, protective helmet & hearing protection.
	Do not expose to rain.
	Beware of thrown or flying objects to bystander. Keep bystanders a safe distance away from the machine.
	Thrown objects can ricochet and result in personal injury or property damage. Wear protective clothing and boots.
	Beware of falling objects. Keep bystanders away.

4. Charging Procedure

IMPORTANT: The battery pack is not fully charged at the factory. Before attempting to charge them, thoroughly read all of the safety instructions.

- (1) To assure that the charger you use are applicable to the battery pack.
- (2) Plug the charger plug into the charging hole of the battery pack.
- (3) Plug the charger into any suitable standard outlet.
- (4) Let the battery pack charge initially with the green light twinkling. If the power green lights are lighting for a long time, the battery pack is fully charged.

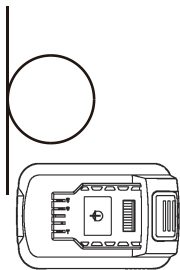

Recharge discharged batteries as soon as possible after use or battery life may be greatly diminished. For longest battery life, do not discharge batteries fully.

It is recommended that the batteries should be recharged after each use.

WARNING: Fire Hazard. When unplug the output plug from the charging hole, be sure to unplug the charger from the outlet first and then disconnect the charger output plug from the charging hole.

Important Charging Notes

1. Your tool is sent from the factory in an uncharged condition. Before attempting to use it, it must be charged.
2. **CAUTION:** To reduce the risk of damage to the batteries, NEVER charge them in an air temperature below 40°F (4.5°C) or above 105°F (40.5°C). Also, NEVER charge them if the battery temperature is below 40°F (4.5°C) or above 105°F (40.5°C). Longest life and best performance can be obtained when batteries are charged with an air temperature of approximately 75° F (24° C). **NOTE:** The tool will not charge if the tool temperature is below approximately 32 ° F (0°C) or above 113° F (45° C).
3. While charging, the charger may hum and become warm to touch. This is a normal phenomenon and does not indicate a problem.

4. If the batteries do not charge properly—(1) Check current at the receptacle by plugging in a lamp or other appliances. (2) Check if receptacle is connected to a light switch which turns power off when you turn out the lights. (3) Move charger and tool to a location where the surrounding air temperature is 40°F (4.5°C) to 105°F (40.5°C). (4) If the receptacle and temperature are OK, but you do not get proper charging, take or send the tool and charger to your local service center. See Electric Tools in yellow pages.

5. The tool should be recharged when it fails to produce sufficient power on jobs which were easily done previously. Battery life may be greatly diminished if batteries are discharged deeply. **DO NOT CONTINUE** to use product with its batteries in a depleted condition. Recharge discharged batteries promptly.

6. To maximize battery life:
 - a. Do not fully discharge batteries.
 - b. Fully recharge batteries after each use.
 - c. Store tool in a location where the surrounding air temperature is approximately 40°F -75°F (4.5°C-24°C).
 - d. Disconnect charger from tool after charging is complete.

WARNING: Fire Hazard. When disconnecting the charger from the tool, be sure to unplug the charger from the outlet first, and then disconnect the charging cord from the tool.

5. Major Parts of the Grass Trimmer

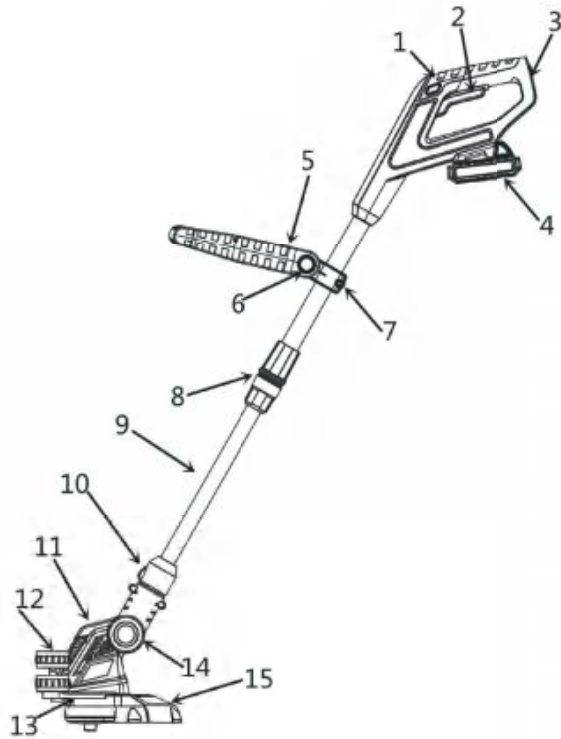

- | | |
|---------------------|--|
| 1. Unlock Knob | 2. Switch Handle |
| 3. Main Handle | 4. Battery Pack |
| 5. Auxiliary Handle | 6. Handle Lock Nut |
| 7. Handle Support | 8. Locking Sleeve (Length Adjustment) |
| 9. Telescopic Pole | 10. Lock Sleeve and Edging Function Button |
| 11. Trimmer Head | 12. Edging Function Wheel |
| 13. Flower Guard | 14. Head Rotary Button |
| 15. Safety Guard | |

Scope of Delivery

- 1 x Grass Trimmer
- 1 x Battery Pack
- 1 x Charger
- 1 x Safety Guard
- 5 x Trimmer Lines (One was pre-installed in the machine)
- 1 x User Manual

6. Assembly Tips

Warning! Remove the battery pack before cleaning or maintaining the tool, fitting the plant guard or making any adjustments to the tool, especially around the string head. Remove battery pack before transporting or storing the tool.

Replacing the Line

Warning! Remove the battery pack before attempting to replace string spool. (Fig.1—Fig.4)

- During use, the tips of the lines will become frayed and worn even fracture. Change line quickly and easily with pre-cut pieces.
- When the line is too short to be used or fracture, remove the battery pack and turn the machine upside down so that you are looking down at the cap.
- Press the tabs and remove the cap from the housing in the trimmer head.
- Grasp the used line with one hand and take it out.
- Grasp the end of new line and guide the line into the eyelet, and then push the new line onto the head until it's fully inserted.
- Align the tabs on the cap with the slots in the housing.
- Push the cap onto the housing until it snaps securely into place.

Please note that when you install the replacement thread, you will feel that the thread is loose and worry that the thread will fall off. Please rest assured that the thread fixed by rivets will automatically close to the edge of the spool and work normally during the use of the product.

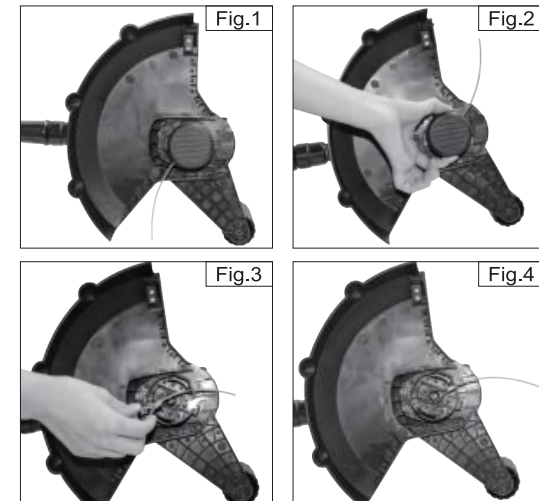

Fitting the guard

WARNING: Remove the battery pack before attempting to attach the guard. Never operate the tool without the guard firmly in place. The guard must always be on the tool to protect the user.

- Push the Head Rotation Pedal to rotate the cutting head to a vertical position, and then rotate the Flower Guard (13) forward to working position.
- Insert the Safety Guard (15) to fix. When you hear the click sound, it means that it's already fixed.

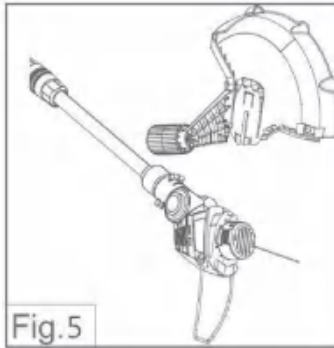

Fitting and Removing the Battery (Fig.6—Fig.7)



! The battery should always be removed whenever you are not using the tool and especially when you are adjusting or transporting the tool to avoid accidental operation.

To insert the battery, slide it into the grass trimmer until it latches into place. Check that the battery is securely locked into place (Fig.6-7).

To remove the battery, press and hold the button on the two side of the battery pack and slide the battery away from the trimmer.

7. Operation



BEFORE OPERATING THIS TOOL, ENSURE THAT THE GUARD IS FITTED TO THE HEAD OF THE MACHINE. NEVER USE THE MACHINE WITHOUT THE GUARD.

(1). Starting/Stopping the Trimmer

To switch the trimmer on, first press the Unlock Knob(1) and then press the Switch Handle(2); the trimmer is running. You can release the unlock knob.

To switch the trimmer off, release the switch handle. Be aware that the blade will continue to rotate for a short period.

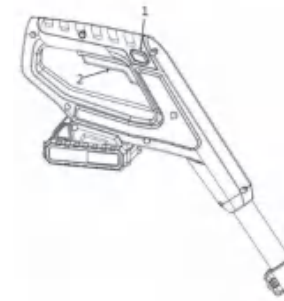

Trimming Tips

- Keep the trimmer tilted toward the area being cut; this is the most efficient cutting area.
- The string trimmer cuts when moving the unit from left to right. This will avoid throwing debris at the operator.
- Use the tip of the string to do the cutting, do not force string head into uncut grass.
- Wire and picket fences cause extra string wear, and breakage. Stone and brick walls, curbs, and wood may fray string rapidly.
- Avoid trees and shrubs. Tree bark, wood moldings, siding, and fence posts can easily be damaged by the strings.

(2). Converting to Edging Mode

- Hold the Main Handle, pull the button on the tube end backwards and rotate the tube by 90°.
- Release the button to fix edging mode and position the trimmer with flower Guard to operate as a maintenance edger.
- Restart the machine after a complete stop.
- Return to the trimming position by reverse rotation after pulling the button backwards.

NOTE: The cutting line will wear faster and require replaced if the cutting or edging is done along sidewalks or other abrasive surfaces or if heavier weeds are being cut.

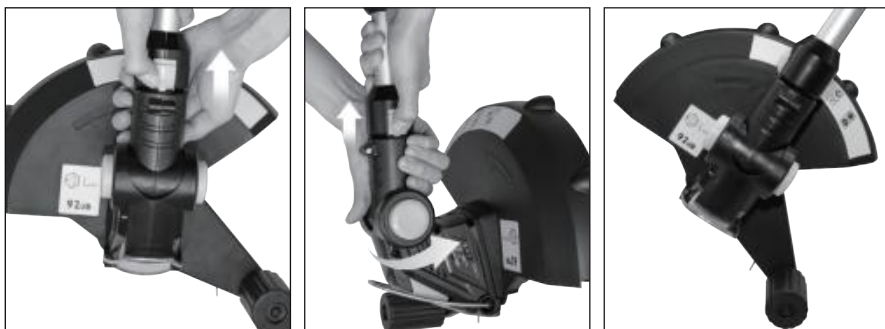

Setting the Handle length

Turn the lock sleeve towards the 'unlock' symbol about half a turn. Slide the lower part of the trimmer up or down to the desired length. Lock it in position by turning the lock sleeve towards the 'lock' symbol.



(3). Adjusting the cutting head

-Push the Head Rotation Pedal to rotate the cutting head to cut the grass under a bush or tree.

-Push the Head Rotation Pedal to rotate the cutting head back to trimming position.



(4). Adjusting the handle angle

-Anticlockwise rotate the handle lock nut to loosen it.

-Adjust the handle up or down to the desired angle.

-Lock it in position by clockwise rotating the handle lock nut.

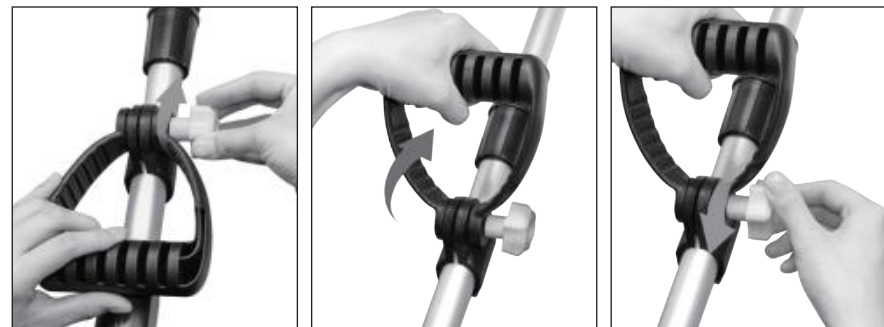

8. Maintenance, Storage and Disposal

1. Disconnect the battery pack from the machine before carrying out maintenance or cleaning.
2. When not in use, store the machine in a place out of the reach of children.
3. Use only manufacturer recommended replacement parts and accessories.
4. To clean the tool, remove battery pack and use only mild soap and a damp cloth to clean the tool. Do not immerse tool in water or spray with a hose. Do not allow any liquid to get inside it. Do not clean with a pressure washer.
5. Inspect and maintain the machine regularly. Have the machine repaired only by an authorized repairer.
6. The battery must be removed from the appliance before it is scrapped.
7. The appliance must be disconnected from the supply mains when removing the battery.

The battery is to be disposed of safely.

Environmental Protection



We are certain that you share our love of nature, and that you have already devoted some thought to ways of protecting the environment. It may well be that you are already familiar with some of the following recommendations and view them as a matter of course. However, the list doubtless includes some helpful suggestions which are new to you, and which you could put to good use.

Original Instruction

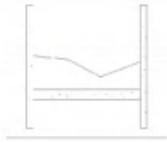

Please observe the usual periods of rest.
Do not trim grass at lunchtime, at night or on Sundays and holidays.
Please also consult the relevant publications in your community.
Under no circumstances put the grass clipping in the dustbin.



Put the grass clippings onto the compost heap alternating with other garden waste.
They make a very good "mulch". Grass clippings can be spread under bushes or trees; they are a natural means for preventing the growth of weeds and they protect the ground from drying up.



Protect your little neighbors.
A garden is inhabited by small animals such as beetles and frogs. Try to drive off any animals before trimming and allow them to find a temporary retreat. An island in the garden looks attractive and also offers animals a refuge. Allow plants to finish blooming, and then they will flower even better the following year.



After-Sales Email Address: service@natiddy.com