



Twist Dynamics Seat Set Installation Instructions



What you'll need:

- (4) Factory Bolts
- (4) 7/16 – 20 Poly-Lock Nuts
- (4) 7/16 – 20 Hex Cap Bolt
- (2) 10 x 20 Hex Cap Bolt
- (2) 10 x 20 Zinc Flat Washer
- (4) ¼ - 20 x ¾ Bolts
- (4) ¼-20 Poly-lock nuts.

Socket Wrench

Note: Taller Seatbelt mount indicates drivers side bracket.

Step 1: Remove your stock seats.

Using a 15mm socket, remove 4 factory bolts from seat brackets (2 in front, 2 in back). Keep factory bolts to use to remount driver's seat.





Unclip the seatbelt warning harness underneath the seat. Do this before you remove seat.



Remove seatbelt latch bolted to the seat using socket wrench.



Now repeat the process on passenger side.

Step 2: Mount Seat Belt Bracket to Main Seat Frame

Using (2) $\frac{1}{4}$ - 20 x $\frac{3}{4}$ Hex Cap Bolts and (2) $\frac{1}{4}$ - 20 Polylock Nuts, start by taking new seat mounting base and attaching seat belt brackets to base making sure that brackets face out as shown using the nuts & bolts provided. Also, seat belt brackets & seat mounts are left & right.





Step 3: Mount slide bar to slider track on seat.

Flip seat over and attach seat adjuster bar by inserting pins into the holes of bar by pressing inwards and inserting it into the tabs.



Step 4: Mounting Seat Brackets to Seat*

Recline seat to a flat position to make it easier to mount seat brackets.



***Making sure seats are on the proper side, matching seat mounts.**

Step 5: Install Seat Bracket to seat tracks using bolts & washer & nuts supplied and mount as shown. Align holes in seat brackets with holes on tracks. Attach Seat Brackets to seat using (4) Seat Bolt Washers & Lock Nuts (per seat). Insert carriage bolt into seat track through bottom seat mount, add washer and lock nut. Make sure when installing seat, you install correct seat to base; seatbelt mount should be on the side where the recliner is.

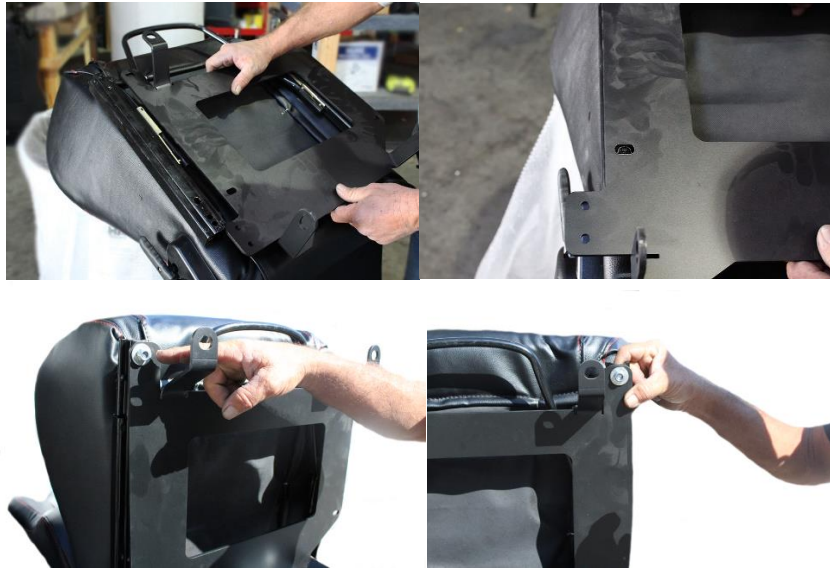

Step 6: Repeat for other seat. Reattach seat belts to seat frame as shown with nuts and bolts.

Note: for the passenger seat, you will need different nuts and bolts, which have been provided for you. Now you should have something that looks like this:



Step 7: Using factory seat bolts, reattach seat to floor.

Step 8: Re-check all nuts & bolts for proper torque.

Step 9: Re-clip seatbelt warning switch under seat and zip-tie it to bottom of new bracket. Be sure to take care when performing this task. Mounting wire/plug incorrectly can result in shearing/cutting plug when using adjustable slider.

All done! Enjoy your new seats.

If you have any questions, comments, or concerns about this product, please contact Twist Dynamics directly at: (941) 323 – 5912 or sales@twistdynamics.com and we will be happy to help.