

## Water Tank Operation

The water tank component can be applied to A80 Max, and if there is a demand for the mop, it is recommended to clean the area with the dustbin first. Then change the dustbin to the water tank components to carry out the mop work.

❗ \* If during the mopping process the robot is stopped to either add water or clean the mop, the robot will reset and plan a new path way from where it is started. In order to achieve a better cleaning, it is recommended for single room use.

\* When cleaning a second room, it is recommended to manually move the robot to the corresponding room and add water and clean the cloth as needed.

🔔 \* Please do not use the water tank components on the carpet or rugs. Please fold the edge of the rugs or block carpet areas to avoid cleaning them during the mopping mode during the mopping mode.

\* Please pay attention during the mopping mode, timely add water or clean the mopping pad. The water tank needs to be removed when adding water.

\* Be sure to remove the water tank components when charging.

### 1 Add Water

Open the water injection cap, fill the water with the water cup, and pour the water slowly into the tank.

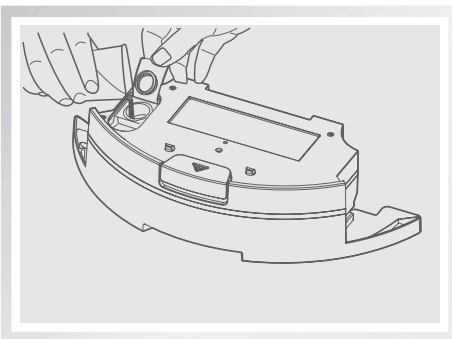

## Water Tank Operation

### 2 Place The Mop Cloth

Close the water injection cap tightly, put on the mop cloth and strap the two elastic bands.

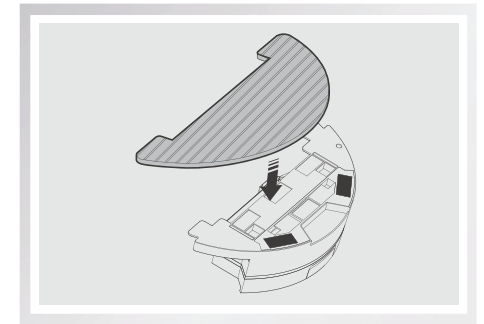

### 3 Install Water Tank Components

Press the button at the end of the dustbin, remove the dustbin, and replace it with the water tank components.

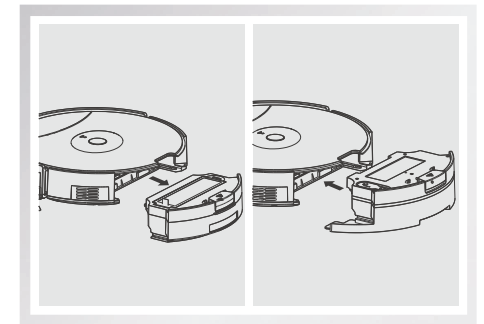

### 4 Mop The Floor

Start any cleaning mode on demand, and the robot will perform mopping.

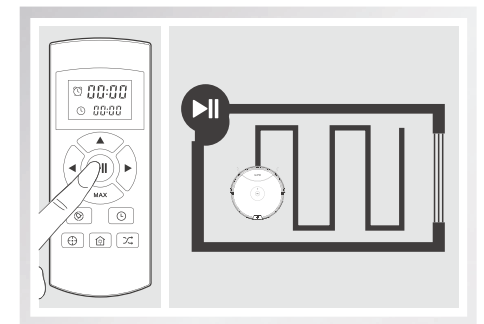

## Cleaning of Water Tank Components

### ① Clean The Mop Cloth

**Remove:**

after mopping, please remove the water tank components and the mop cloth.

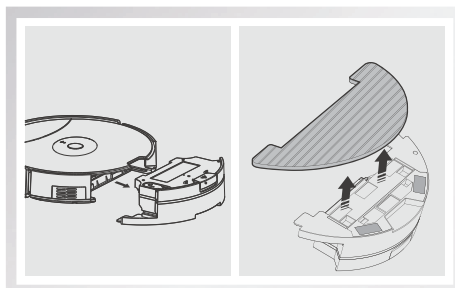

**Maintenance:**

rinse and air dry the mop cloth.

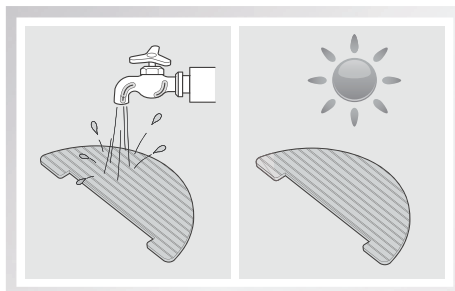

### ② Clean The Water Tank

**Remove:**

after mopping, remove the mop cloth and the components, drain the remaining water in the water tank.

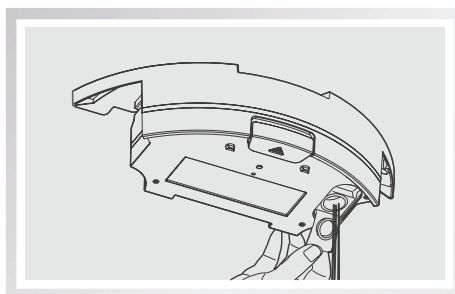

**Maintenance:**

dry the water tank by hand and then air dry it.

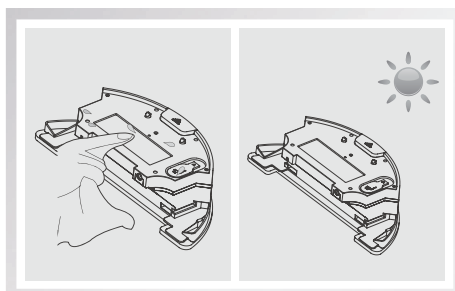

## A80 Max | Water Tank Quick Start Guide

