

Product Function Introduction

By connecting to your car's USB port, your factory wired CarPlay can be upgraded to wireless CarPlay/Android Auto.

Connection Diagram

○ CarPlay connection (Wired / Wireless Connection)



○ Android Auto connection (Wired / Wireless Connection)



LED Light Description

- Red status: power indication
- Green / Blue: successful connection

Product Specifications

- Power input: 5V=1A
- Power output: 5V=1A
- Power consumption: 0.75W
- Compatible resolution: adaptive

Supported Vehicles & Mobile Phones

- iPhone: iPhone 6 and above, applicable to iOS 10 and above version
- Android phone: Android 10.0 and above, some require Android 11.0 and above version
- Supported car models: Car with factory wired CarPlay
Specific model query: <https://www.apple.com.cn/ios/carplay/available-models/>

Wireless CarPlay / Android Auto Connection Steps

1. Insert the adapter into the car's USB port
2. Turn on the WiFi and Bluetooth of the iPhone/Android phone
3. Enter the Bluetooth interface of the iPhone/Android phone, and search for the Bluetooth name displayed on the car screen
4. Click to connect

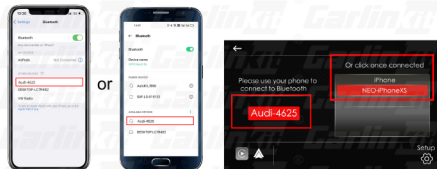

List Management

- Select your phone name in the list to connect
- Long press your phone name in the list to delete pairing

Update Version Online / Report Issues

- Procedure: Enter the Background
 1. Insert the adapter into the car's USB port
 2. Mobile phone connects to the adapter's WiFi
 3. iPhone: Scan the QR code with the camera, or enter 192.168.50.2 using the browser that comes with your iPhone



Android phone: Scan the QR code with the camera, or use any browser to enter 192.168.50.2
(Note: please make sure your phone is connected to the mobile network)

- Click "Check Update" (Picture 1)
 1. You can check whether it is the latest version
 2. You can upgrade and update the latest version online**(Note: Please contact customer service for version upgrade, self-upgrade may cause product damage)**
- Click "Feedback" (Picture 1)
 1. Enter your car's brand + model + year and report any product usage issues. (Picture 2)
 2. Send the screenshot of the contents to customer service personnel.
 3. Once submitted, a technician will follow up and fix the problem

Take the iPhone as an example

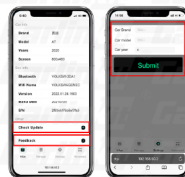

(Picture 1)

(Picture 2)

Android Auto UI Interface Display

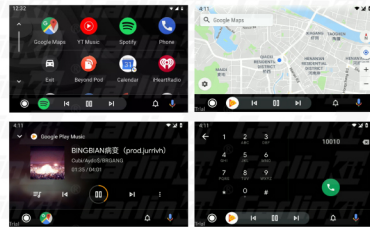

Android Auto Considerations

- Download and install the Android Auto app from Google Play on your Android phone
- Check if your phone supports wireless Android Auto

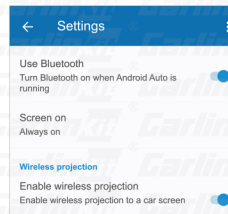

After-sales service

Dear user, thank you for using this product. In order to protect your rights and interests, we will provide you with high-quality after-sales service. You can enjoy one-year warranty service from the date of purchase (under normal use, the product itself is a failure caused by quality problems).

Please keep this card properly, as the necessary proof of warranty service, the company reserves the right to interpret the after-sales service of this product.

Warranty Card

Name	Purchase date
Phone number	E-Mail
Address	
Dealer's name(stamped)	
Warranty content	

