

# DUTCH BRAID

Designed by Elise Lea for RK  
[www.robertkaufman.com](http://www.robertkaufman.com)

Featuring ARTISAN  
BATIKS

## Bubble Blues 1

Ten Square  
Friendly



Finished quilt measures: 60" x 74"





Difficulty Rating: **Intermediate**

**ROBERTKAUFMAN**  
F A B R I C S

For questions about this pattern, please email [Patterns@RobertKaufman.com](mailto:Patterns@RobertKaufman.com).

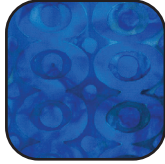
## Fabric and Supplies Needed

Fabric amounts based on yardage that is 42" wide.

Color	Fabric	Name/SKU	Yardage	Color	Fabric	Name/SKU	Yardage
		TEN-1114-42 BUBBLE BLUES	One Ten Square pack		C	AMD-21250-361 CAPRI	1-1/8 yard
	A	AMD-7000-9 NAVY	1-1/4 yard		Binding*	AMD-21246-243 CERULEAN <i>*Also included in the Ten Square Pack</i>	1/2 yard
	B	AMD-7000-65 POWDER	1-3/8 yard	<div style="background-color: #cccccc; padding: 10px; border: 1px solid #ccc;"> <p>You will also need: 4 yards for backing</p> </div>			

Copyright 2022, Robert Kaufman

For individual use only - Not for resale

## Notes Before You Begin

- Read through all of the instructions before beginning.
- All of the seam allowances are 1/4" unless otherwise noted.
- Press seam allowances open unless otherwise noted.
- Width of fabric (WOF) is equal to at least 42" wide.
- Right sides together has been abbreviated to RST.
- Remember to measure twice and cut once!

## Cutting Instructions

### From each square in the Ten Square pack, cut:

four 5" squares\*

\*Note: twenty-eight will be extra. You will use one hundred forty 5" squares.

### From Fabric A, cut:

ten 2-3/4" x WOF strips. Subcut:

one hundred forty 2-3/4" squares. Mark a diagonal line of the back of each square.

seven 2" x WOF strips. Subcut:

one hundred forty 2" squares. Mark a diagonal line of the back of each square.

### From Fabric B, cut:

ten 2-3/4" x WOF strips. Subcut:

one hundred forty 2-3/4" squares. Mark a diagonal line of the back of each square.

thirteen 1-1/2" x WOF strips. Sew together, end-to-end, then trim:  
 six 1-1/2" x 63-1/2" column sashing strips  
 two 1-1/2" x 51-1/2" top/bottom inner borders

**From Fabric C, cut:**

seven 5" x WOF strips. Sew together, end-to-end, then trim:  
 two 5" x 65-1/2" side outer borders  
 two 5" x 60-1/2" top/bottom outer borders

**From the Binding Fabric, cut:**

seven 2-1/2" x WOF strips

Assemble the Blocks

**Step 1:** Gather four 5" squares use for Block 1. Orient them as shown in the Quilt Assembly Diagram.

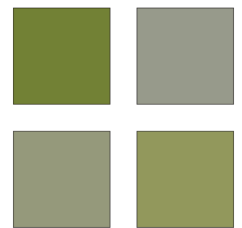

Place a 2-3/4" Fabric A square in the upper right corner of the upper left square, right sides together. Note the orientation of the marked diagonal line. Sew on the marked line, then trim away the excess fabric, leaving a 1/4" seam allowance. Press.



Repeat on the lower left corner with the 2-3/4" Fabric B square, and on the lower right corner with the 2" Fabric A square.

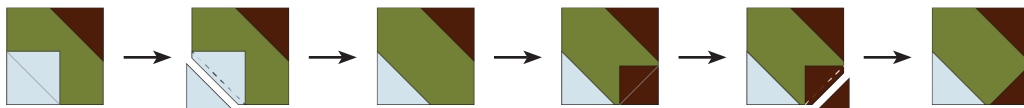

**Step 2:** Repeat the process from Step 1 with the remaining three 5" squares, noting the different placements of the A and B squares.

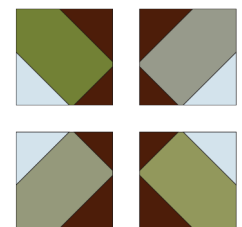

**Step 3:** Sew the four units into two rows of two, pressing the seams in opposite directions. Sew the two rows together, nesting the seams and pressing the seam to one side. The resulting Block 1 should measure 9-1/2" square.

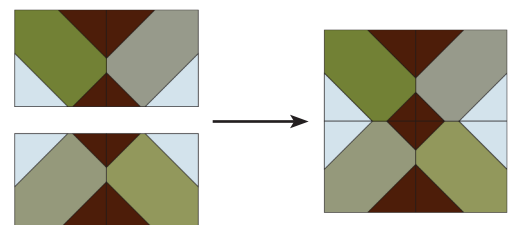

Repeat Steps 1-3 to make thirty-five Blocks. Refer to the Quilt Assembly Diagram for fabric placement and orientation.

## Assemble the Quilt

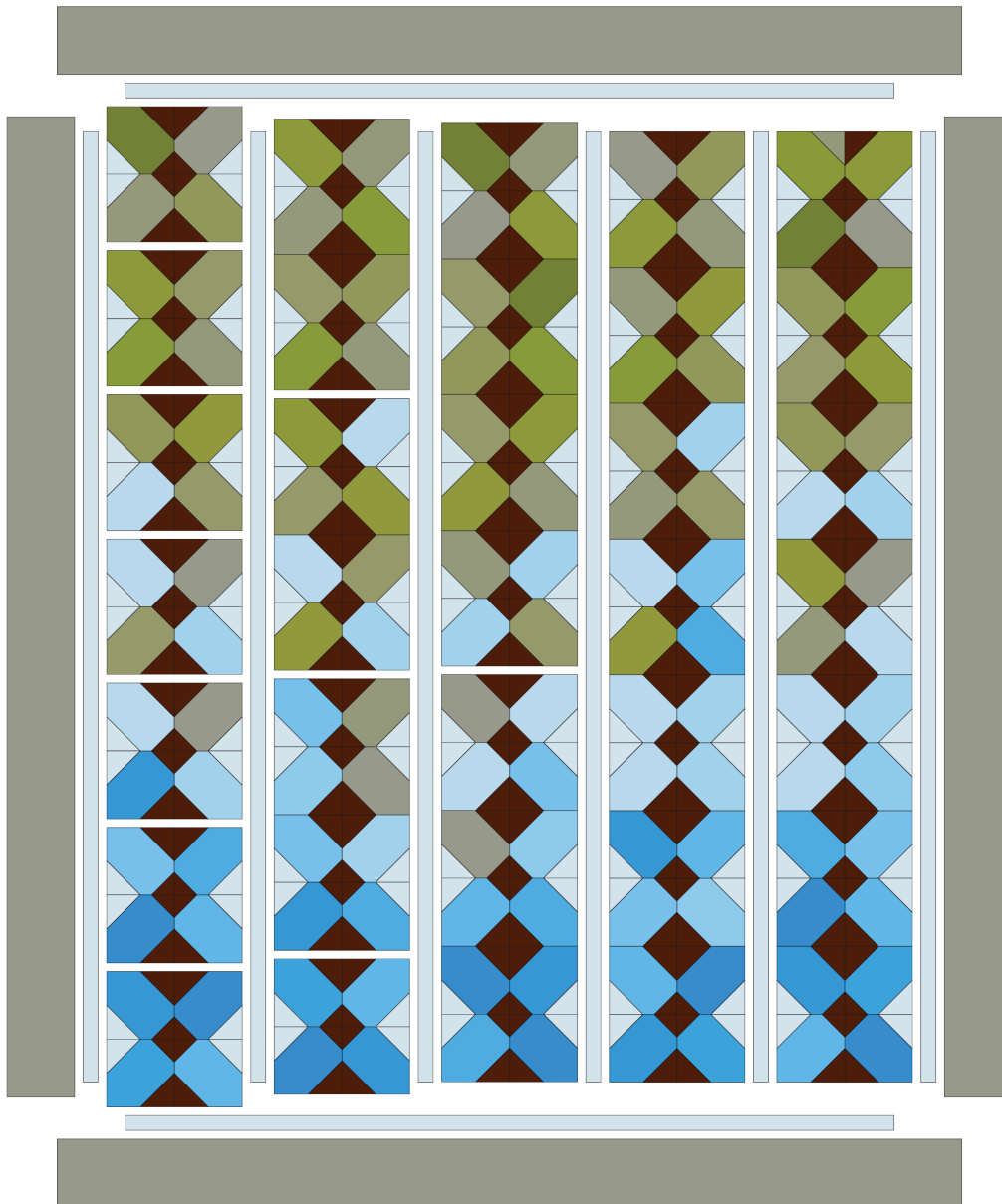

**Step 4:** Arrange the Blocks together in five columns of seven, as indicated in the Quilt Assembly Diagram. Sew each column together. Press the seams in one direction.

**Step 5:** Sew the column sashing (including the sashing on the outer left and right) and block columns together. Press seams open or to the sashing.

**Step 6:** Sew the top and bottom inner borders to the quilt center. Press toward the borders.

**Step 7:** Sew the side outer borders to the sides of the quilt center. Press toward the borders. Sew the top and bottom outer borders to the quilt center. Press toward the borders.

Your quilt top is complete! Baste, quilt, bind and enjoy!

This pattern may be used for personal purposes only and may not be reproduced in any form without the express permission from Robert Kaufman Fabrics. This pattern is not for resale. All patterns, unless otherwise attributed, are © Robert Kaufman Co., Inc. 2005-2022. All rights reserved.