

PREPARING THE LUMINAIRE

SURFACE MOUNT LUMINAIRE WS-BL344

SAVE THIS INSTRUCTIONS

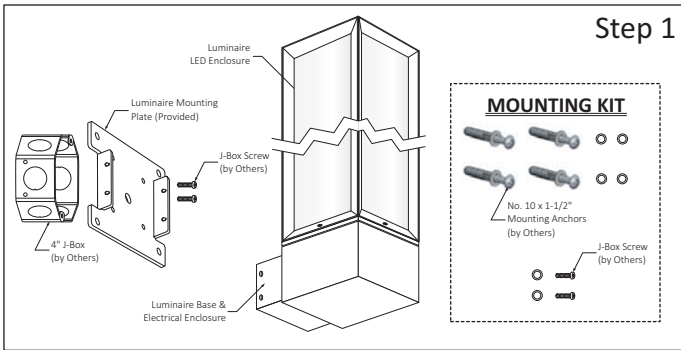

Step 1 - Get Luminaire and proper Parts for Installation:
 a.- Prepare all parts as needed for water-tight Installation.

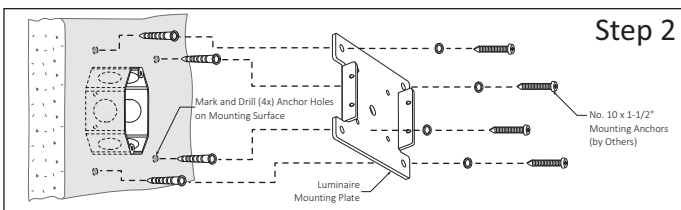

Step 2 - Mark and Drill Holes on Mounting Surface:
 a.- Remove the Mounting Plate from the Luminaire Base.
 b.- Center the J-Box with Luminaire Plate, mark and drill Holes.
 c.- Install the Plug for Mounting Kit (by others).

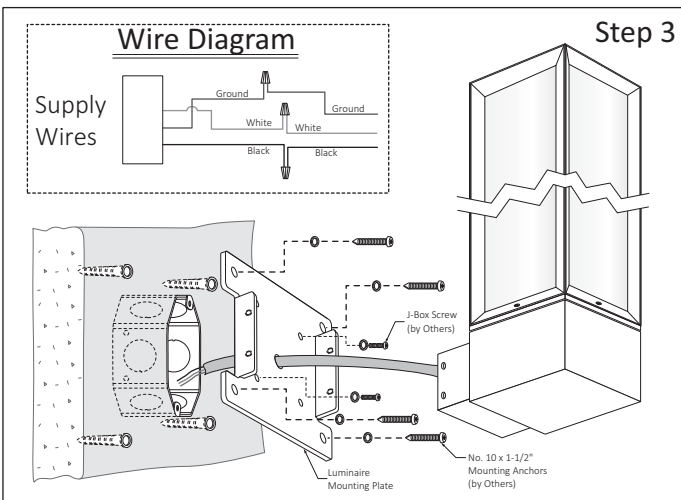

Step 3 - Install Mounting Plates to J-Box:
 a.- Place Luminaire Base close to Mounting Surface.
 b.- Run Power Cord through Center Hole of Mounting Plates and make electrical connection, see Wire Diagram.
 c.- Install Mounting Plate to J-Box by using the Anchor Kit (by others).

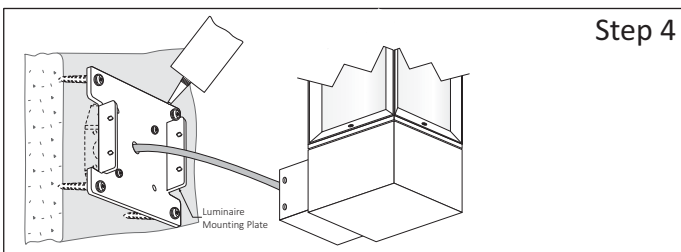

Step 4 - Seal the Luminaire Mounting Plate:
 a.- Apply Sealant all around the Luminaire Mouting Plate for water tight.

READ AND UNDERSTAND ALL INSTRUCTIONS BEFORE INSTALLATION. IF YOU ARE NOT FAMILIAR WITH THE NATIONAL ELECTRICAL CODE (NEC), CONTACT A QUALIFIED ELECTRICIAN TO INSTALL THIS LUMINAIRE.

WARNING.- Before installing this luminaire or doing any maintenance, turn off the power supply at the circuit breaker or fuse box. Turning the power off using the light switch is not sufficient to prevent electrical shock.

NOTE:

To re-lamp, replacement parts or additional information, contact or visit manufacturer at www.lumux.net

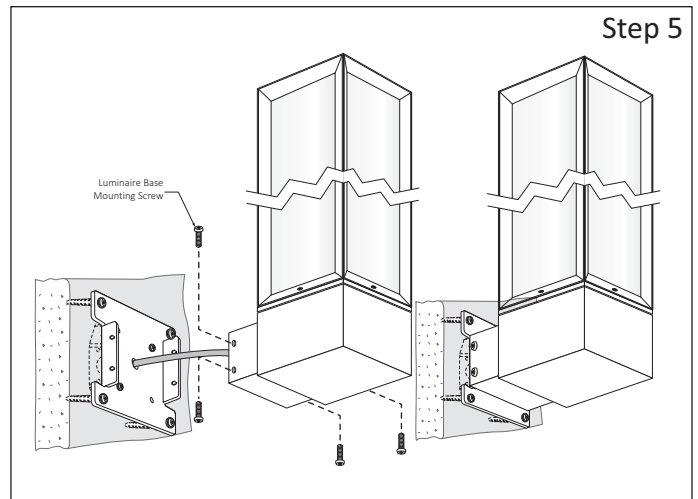

Step 5 - Install Luminaire:
 a.- Push the Cord into the J-Box allowing the base to touch the surface.
 b.- Align the base holes with Mounting Plate and fasten using the four mounting screws (provided).

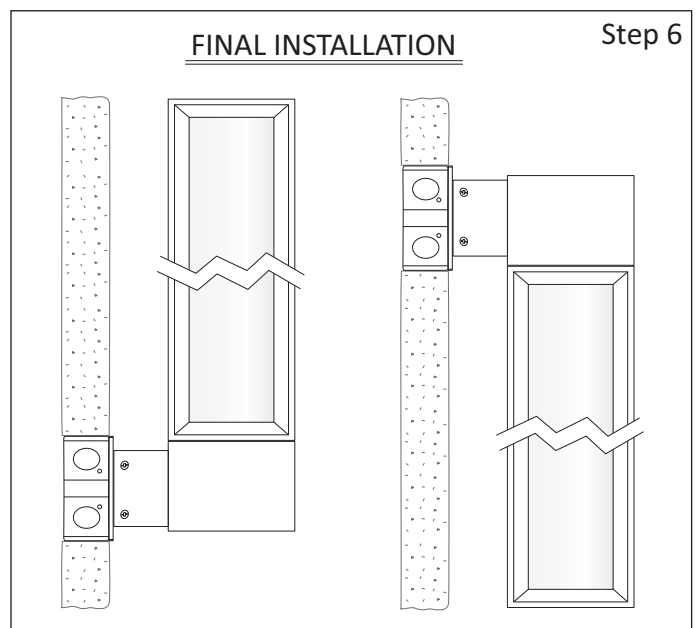

Step 6 - Final Installation: